

- NOTES:**
- SEE MCC #1A, #1B SINGLE LINE DIAGRAM AND DP-A11 & DP-A12 POWER DISTRIBUTION FOR 600V POWER REQUIREMENT.
  - ALL 120V AND 208V LOADS ARE FED FROM LP-A11.

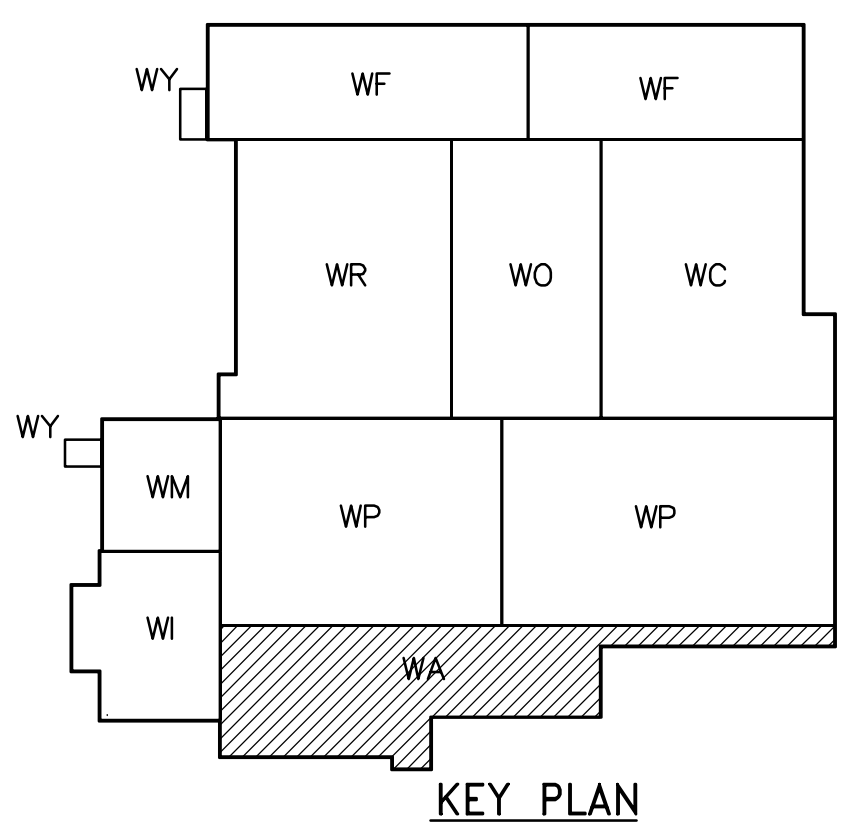

**LOWER LEVEL PROCESS PLAN**  
1:100

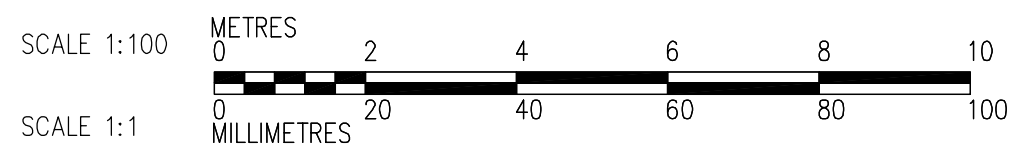

<p><b>APEGN</b> Certificate of Authorization CH2M HILL Canada Ltd. No. 1441 Expiry: April 30, 2007</p>	<p>Frederickson Cooper ARCHITECTS</p>		<p>EarthTech A Tyco International Ltd. Company</p>		ENGINEER'S SEAL  ORIGINAL SIGNED BY L.D. LLEWELLYN 2006/03/29	<p><b>THE CITY OF WINNIPEG</b> WATER AND WASTE DEPARTMENT ENGINEERING DIVISION</p>	WATER TREATMENT PLANT ADMINISTRATION MECHANICAL AND ELECTRICAL	CITY FILE NUMBER SHEET OF
	DESIGNED BY JT CHECKED BY ND		DRAWN BY KJ APPROVED BY AHL		CONSULTANT DRAWING NO. WA-E0102		CITY DRAWING NUMBER 1-0601A-A-E0102-001-02D	
	SCALE: 1:100 RELEASED FOR CONSTRUCTION BY: R. SOROKOWSKI		DATE 2005/08/18 DATE 2006/03/29					
	NO. REVISIONS DATE BY		NO. REVISIONS DATE BY					