

- NOTES:**
- SEE MCC #1A & #1B SINGLE LINE DIAGRAM FOR 600V POWER DISTRIBUTION.
 - ALL 120V AND 208V LOADS ARE FED FROM LP-M11.
 - PROVIDE TRANSFORMER GROUNDING TO THE REQUIREMENT OF MANITOBA HYDRO. REFER TO DETAIL WB-E0456 FOR MINIMUM REQUIREMENT.
 - SEE CBD-M-4 FOR MISCELLANEOUS COMMUNICATION NET WORK WIRING BETWEEN SWITCHGEAR, MCC'S, AND LCP'S.

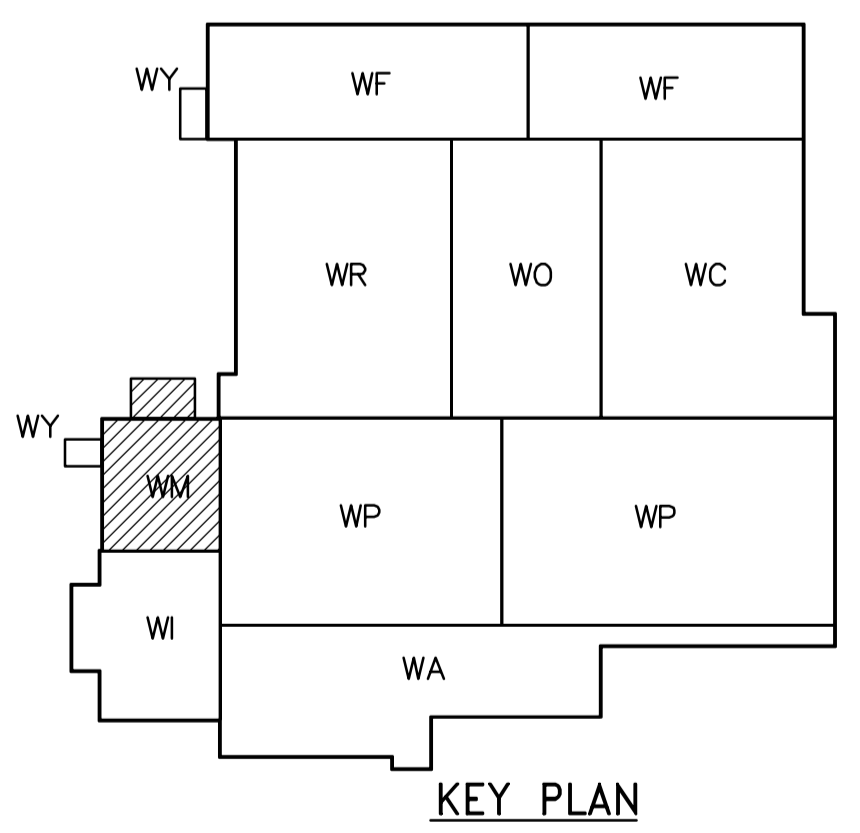

FIRST FLOOR PROCESS PLAN
1:100

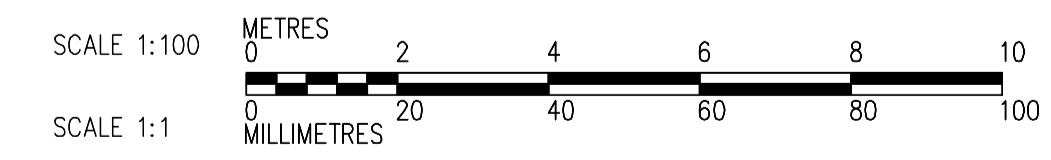

<p>APEGN Certificate of Authorization CH2M HILL Canada Ltd. No. 1441 Expiry: April 30, 2007</p>	B.M. ELEV.	<p>Frederickson Cooper ARCHITECTS</p>	<p>EarthTech A Tyco International Ltd. Company</p>	ENGINEER'S SEAL	<p>THE CITY OF WINNIPEG WATER AND WASTE DEPARTMENT ENGINEERING DIVISION</p>	
				DESIGNED BY: JT		CHECKED BY: ND
		02 742-2005 ADDENDUM 4 06/05/12 LL	DRAWN BY: KJ	APPROVED BY: AHL		2006/03/29
		01 742-2005-ADDENDUM 3 06/05/05 LL	SCALE: 1:100	RELEASED FOR CONSTRUCTION BY: R. SOROKOWSKI		CONSULTANT DRAWING NO. WM-E0112
	00 ISSUED FOR TENDER 06/03/29 LL	DATE 2005/06/30	DATE 2006/03/29		<p>WATER TREATMENT PLANT GENERAL PLANT SERVICES/MISCELLANEOUS MECHANICAL AND ELECTRICAL</p>	
	NO. REVISIONS	DATE	BY		<p>ELECTRICAL ELECTRICAL ROOM AREA FIRST FLOOR PROCESS PLAN</p>	
					<p>CITY FILE NUMBER SHEET OF CITY DRAWING NUMBER 1-0601M-A-E0112-001-02D</p>	