

THIRD FLOOR POWER AND LIGHTING PLAN (AREA 2)
1:100

- NOTES:
1. ALL 120V AND 208V LOADS ARE FED FROM LP-H31
 2. EMERGENCY LIGHTING EM-X-1 ARE FED FROM BATTERY PACK EM-X.
 3. MOUNT TYPE A LUMINAIRE AT 3.0m ABOVE THE FLOOR
 4. SEE DWG WB-E0401 FOR TYPE A FIXTURE MOUNTING DETAILS
 5. SEE DWG WB-E402 DET 2 FOR TYPE J FIXTURE MOUNTING DETAILS

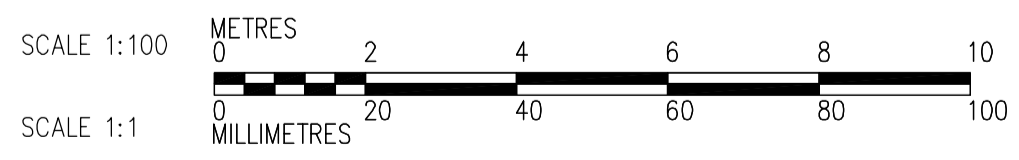
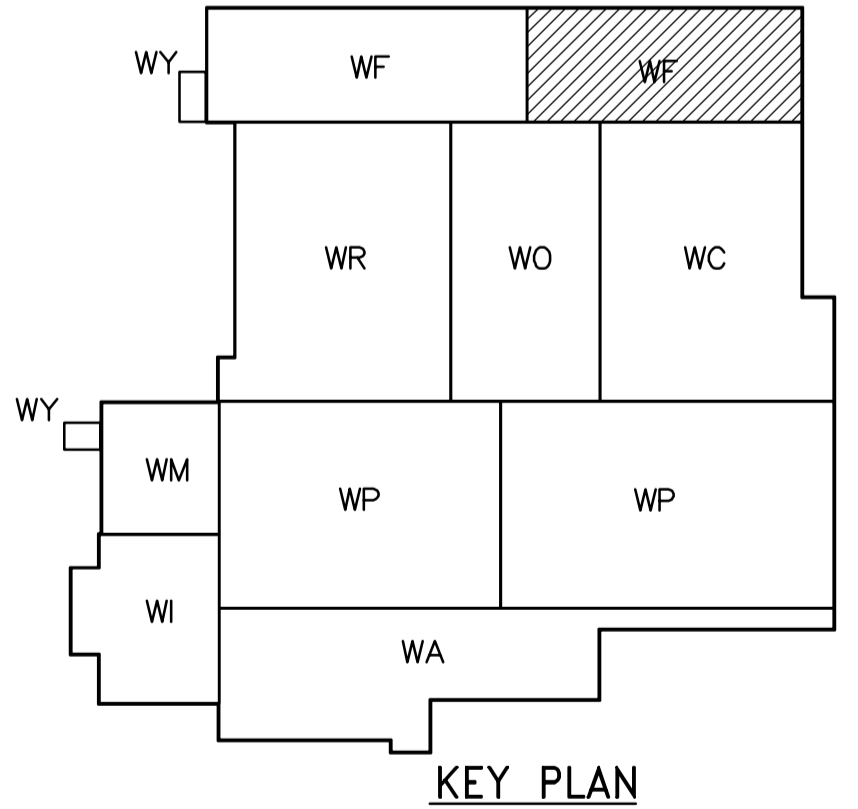

<p>APEGN Certificate of Authorization CH2M HILL Canada Ltd. No. 1441 Expiry: April 30, 2007</p>	<table border="1"> <tr> <th>B.M.</th> <th>ELEV.</th> </tr> <tr> <td> </td> <td> </td> </tr> <tr> <td> </td> <td> </td> </tr> <tr> <td> </td> <td> </td> </tr> </table>	B.M.	ELEV.							<p>Frederickson Cooper ARCHITECTS</p>	<p>EarthTech A Tyco International Ltd. Company</p>	ENGINEER'S SEAL	<p>THE CITY OF WINNIPEG WATER AND WASTE DEPARTMENT ENGINEERING DIVISION</p>
		B.M.	ELEV.										
DESIGNED BY LL	CHECKED BY ND	ORIGINAL SIGNED BY L.D. LLEWELLYN											
DRAWN BY TL	APPROVED BY AHL	2006/03/29											
SCALE: 1:100	RELEASED FOR CONSTRUCTION BY: R. SOROKOWSKI	CONSULTANT DRAWING NO. WF-E0136											
NO. REVISIONS	DATE BY	DATE 2005/07/13	DATE 2006/03/29	WATER TREATMENT PLANT FILTRATION MECHANICAL AND ELECTRICAL	CITY FILE NUMBER								
				ELECTRICAL FILTRATION AREA 2 THIRD FLOOR POWER AND LIGHTING PLAN	SHEET OF								
					CITY DRAWING NUMBER 1-0601F-A-E0136-001-02D								