

- NOTE:**
1. FCV-P100A, FCV-P200A, FCV-P300A, FCV-P400A, FCV-P500A, FCV-P600A, FCV-P700A AND FCV-P800A ARE LOCATED AT PLATFORM WALKWAY AT ELEVATION 242.00
  2. SEE MCC #1A & #1B SINGLE LINE DIAGRAM DP-P11 & DP-P12 POWER DISTRIBUTION FOR 600V POWER REQUIREMENT.
  3. SEE LP-A11 FOR 120/208V POWER DISTRIBUTION

**FIRST FLOOR PROCESS PLAN**  
1:100

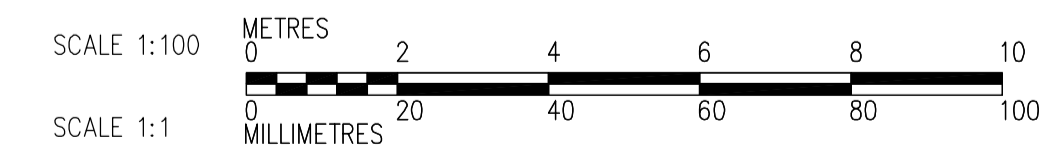
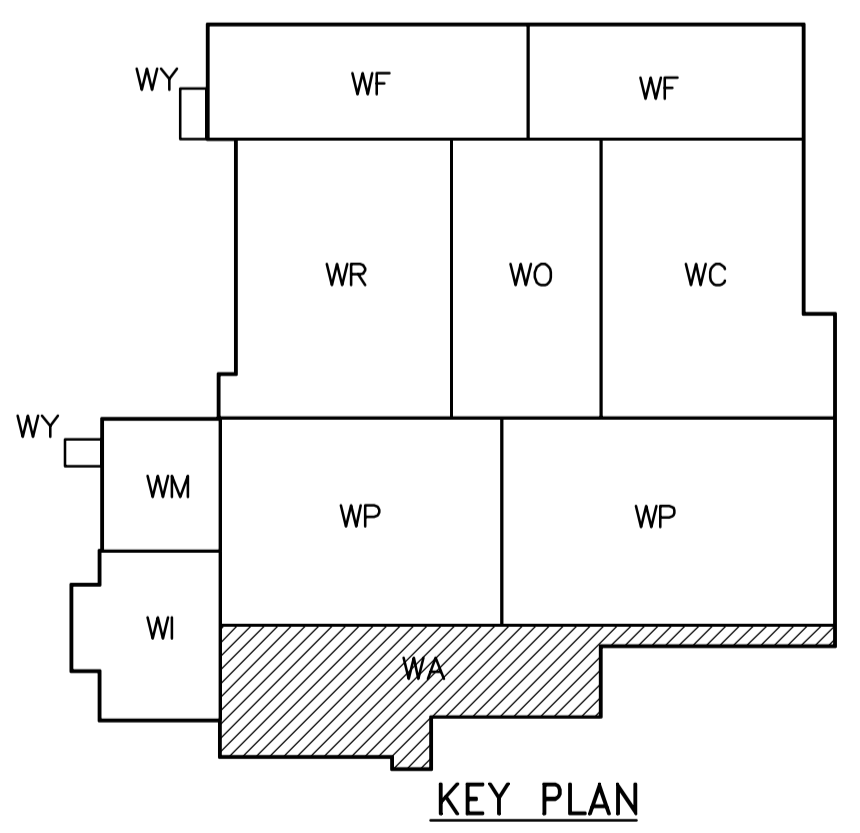

<p><b>APEGN</b> Certificate of Authorization CH2M HILL Canada Ltd. No. 1441 Expiry: April 30, 2006</p>	<p>Frederickson Cooper ARCHITECTS</p>	<p>EarthTech A Tyco International Ltd. Company</p>	ENGINEER'S SEAL  ORIGINAL SIGNED BY L.D. LLEWELLYN 2006/03/29	<p><b>THE CITY OF WINNIPEG</b> WATER AND WASTE DEPARTMENT ENGINEERING DIVISION</p>
			DESIGNED BY: JT CHECKED BY: ND DRAWN BY: KJ APPROVED BY: AHL SCALE: 1:100 RELEASED FOR CONSTRUCTION BY: R. SOROKOWSKI 2006/03/29	
B.M. ELEV.			WATER TREATMENT PLANT ADMINISTRATION MECHANICAL AND ELECTRICAL	
00 ISSUED FOR TENDER 06/03/29 LL NO. REVISIONS DATE BY DATE 2005/08/18 DATE 2006/03/29			CITY FILE NUMBER SHEET OF CITY DRAWING NUMBER 1-0601A-A-E0112-001-000	