

SECOND FLOOR PLAN  
1:100

Heat Pump Outside Air Flow Rates	
Heat Pump Systems	Airflow [L/s]
HP-H090	58
HP-H089	65
HP-H095	58
HP-H092	78
HP-H091	129
HP-H094	24
HP-H093	36
HP-H099	69

- NOTES:
- REFER TO ARCHITECTURAL REFLECTED CEILING PLAN FOR EXACT LOCATION OF CEILING DIFFUSERS AND GRILLES. REFLECTED CEILING PLAN TO BE PROVIDED LATER BY CONTRACT ADMINISTRATOR.
  - PROVIDE A BALANCING DAMPER AT EACH OUTSIDE AIR DUCT TO HEAT PUMP UNIT.
  - ROUTE ALL CONDENSATE DRAIN PIPES WITHIN CEILING SPACE AND TERMINATE AT CLOSEST FUNNEL FLOOR DRAINS OR INDIRECT DRAIN PIPE PROVIDED. REFER TO PLUMBING AND DRAINAGE DRAWINGS FOR LOCATION OF FUNNEL FLOOR DRAINS AND INDIRECT DRAIN PIPE.

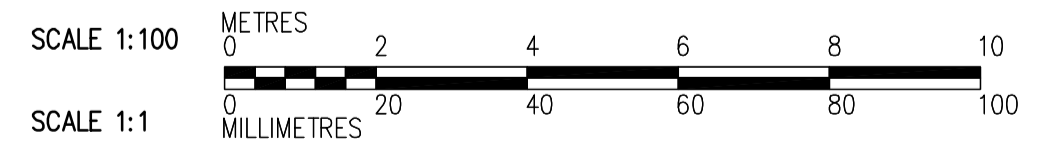
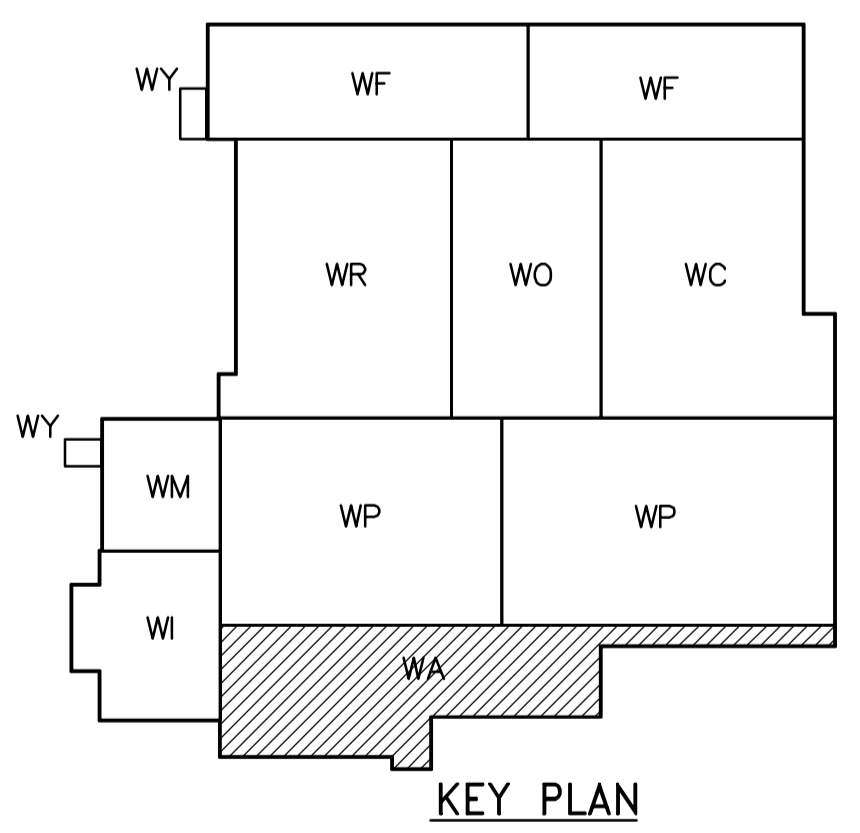

<p>Certificate of Authorization CH2M HILL Canada Ltd. No. 1441 Expiry: April 30, 2006</p>	<p>Frederickson Cooper ARCHITECTS</p>	<p>A Terra International Ltd. Company</p>	ENGINEER'S SEAL	<p>THE CITY OF WINNIPEG WATER AND WASTE DEPARTMENT ENGINEERING DIVISION</p>
			<p>DESIGNED BY TT</p> <p>DRAWN BY AM</p> <p>SCALE: 1:100</p>	
<p>00 ISSUED FOR TENDER 06/03/29 TT</p> <p>NO. REVISIONS DATE BY DATE 2005/07/04 DATE 2006/03/29</p>			<p>CONSULTANT DRAWING NO. WA-H0121</p>	<p>CITY FILE NUMBER</p> <p>SHEET OF</p> <p>CITY DRAWING NUMBER 1-0601A-A-H0121-001-000</p>