

SECOND FLOOR LAYOUT  
1:100

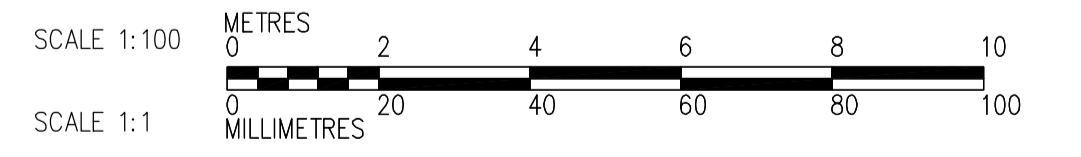
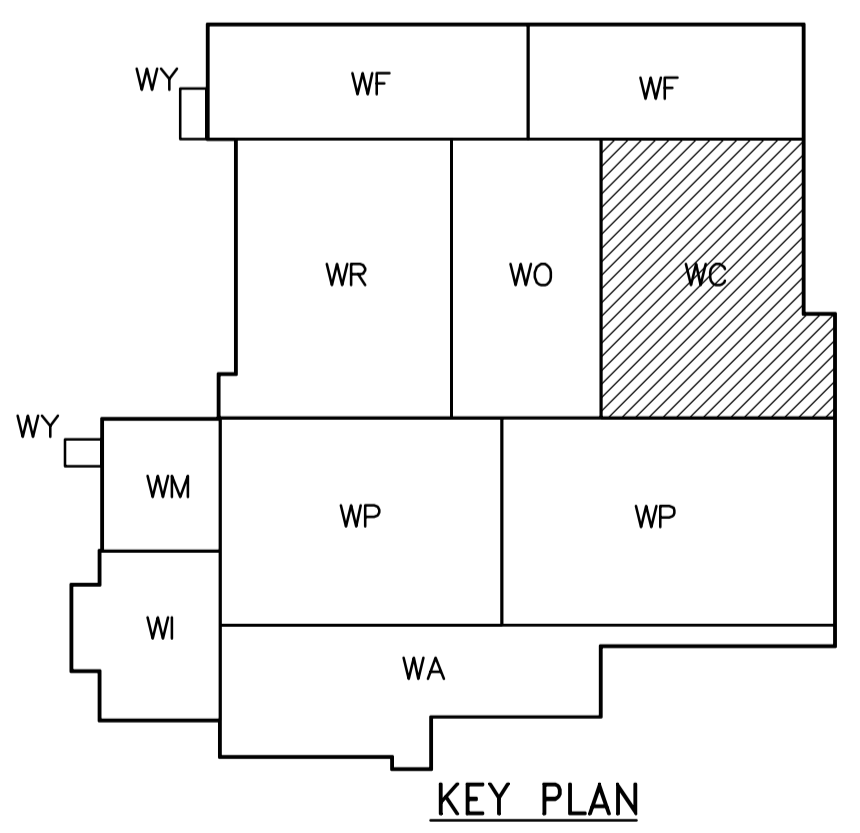

|  |   |  |  |  |   |  |
|--|---|--|--|--|---|--|
| <p><b>APEGN</b><br/>Certificate of Authorization<br/>CH2M HILL Canada Ltd.<br/>No. 1441 Expiry: April 30, 2006</p> | <p>Frederickson Cooper<br/>ARCHITECTS</p> |  | <p>EarthTech<br/>A Tyco International Ltd. Company</p> |  | ENGINEER'S SEAL<br><br>ORIGINAL SIGNED BY<br>J.W. SINCLAIR<br>2006/03/29    | <p><b>THE CITY OF WINNIPEG</b><br/>WATER AND WASTE DEPARTMENT<br/>ENGINEERING DIVISION</p> |
|  | DESIGNED BY: KS<br>CHECKED BY: NN         |  | DRAWN BY: YFS<br>APPROVED BY: AHL                      |  | CONSULTANT DRAWING NO.<br>WC-M0121  |  |
|  | SCALE: 1:100                              |  | RELEASED FOR CONSTRUCTION BY:<br>R. SOROKOWSKI         |  |   |  |
|  | 00 ISSUED FOR TENDER 06/03/29 KS          |  | 2005/10/31 2006/03/29                                  |  | WATER TREATMENT PLANT<br>CHEMICAL FEED SYSTEMS<br>MECHANICAL AND ELECTRICAL |  |
| PROCESS MECHANICAL<br>CHEMICAL AREA<br>SECOND FLOOR LAYOUT   |   |  |  |  | CITY DRAWING NUMBER<br>1-0601C-A-M0121-001-000                              |  |