

- NOTES:**
1. ALL 120V AND 208V LOADS ARE FED FROM LP-P11.
 2. EMERGENCY LIGHTING EM-X-1, -2 ETC ARE FED FROM BATTERY PACK EM-X.

FIRST FLOOR POWER AND LIGHTING PLAN (AREA 1)
1:100

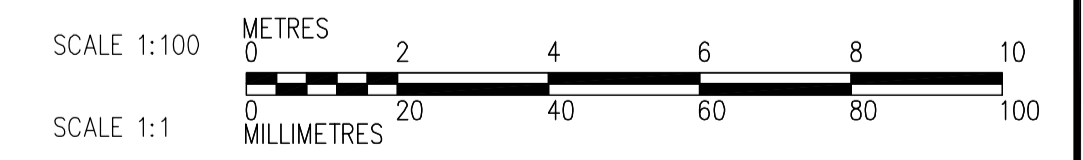
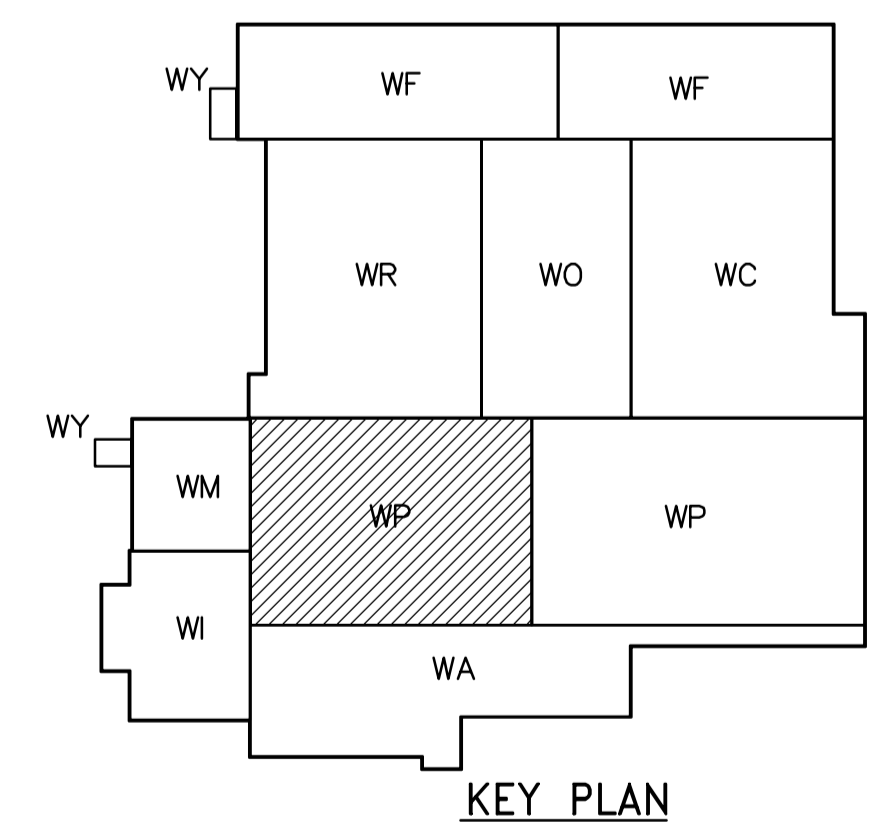

<p>APEGN Certificate of Authorization CH2M HILL Canada Ltd. No. 1441 Expiry: April 30, 2006</p>	<p>Frederickson Cooper ARCHITECTS</p>	<p>EarthTech A Tyco International Ltd. Company</p>	ENGINEER'S SEAL ORIGINAL SIGNED BY L.D. LLEWELLYN 2006/03/29	<p>THE CITY OF WINNIPEG WATER AND WASTE DEPARTMENT ENGINEERING DIVISION</p>
			DESIGNED BY: JT CHECKED BY: ND DRAWN BY: KJ APPROVED BY: AHL SCALE: 1:100 RELEASED FOR CONSTRUCTION BY: R. SOROKOWSKI	
B.M. ELEV.			WATER TREATMENT PLANT FLOCCULATION AND DAF MECHANICAL AND ELECTRICAL	
NO. REVISIONS DATE BY			CITY FILE NUMBER SHEET OF	
00 ISSUED FOR TENDER 06/03/29 LL			CITY DRAWING NUMBER 1-0601P-A-E0115-001-000	
DATE: 2005/07/12 DATE: 2006/03/29			ELECTRICAL FLOC/DAF AREA 1 FIRST FLOOR POWER AND LIGHTING PLAN	