

- NOTES:
1. ALL 120V AND 208V LOADS ARE FED FROM LP-R31 UNLESS OTHERWISE NOTED.
  2. EMERGENCY LIGHTING EM-X-1 ARE FED FROM BATTERY PACK EM-X.
  3. MOUNT TYPE LUMINARIES AT 2.4m ABOVE THE FLOOR.

- LC-R31
- DP-R31
- LP-R31
- XFMR-LP-R31
- HCP-H020

THIRD FLOOR POWER AND LIGHTING PLAN  
1:100

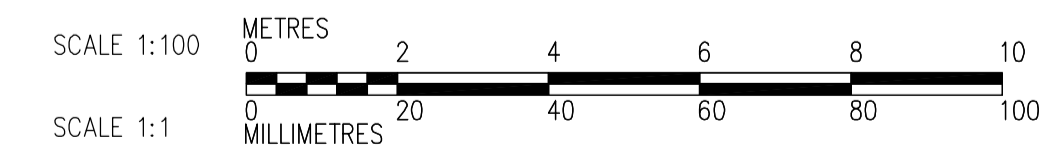
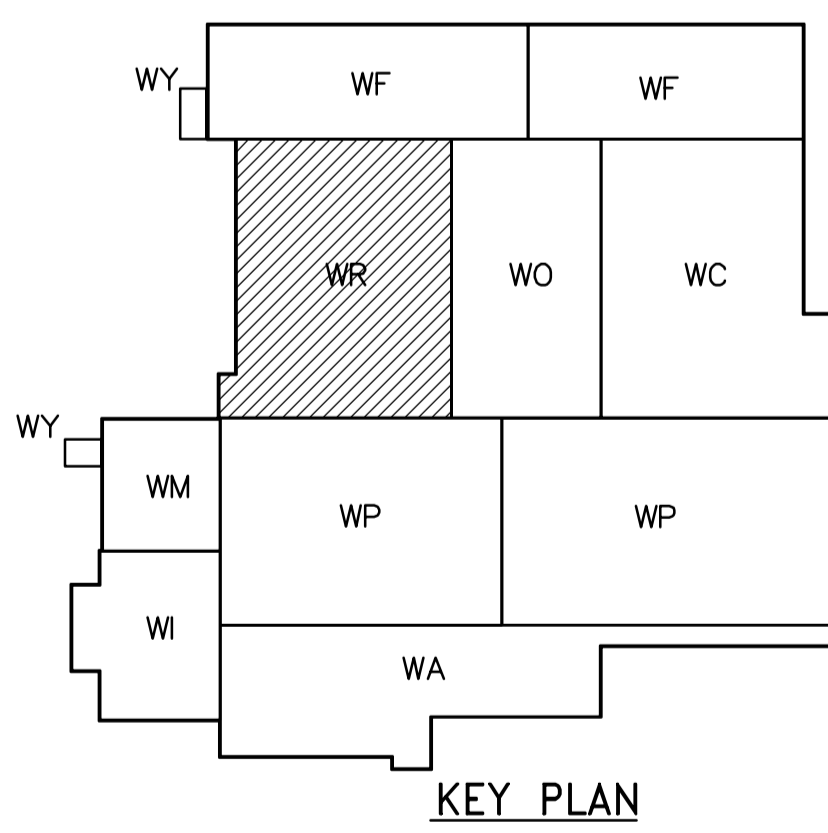

 <b>APEGN</b> Certificate of Authorization CH2M HILL Canada Ltd. No. 1441 Expiry: April 30, 2006	B.M. ELEV.	 Frederickson Cooper ARCHITECTS	 A Terra International Ltd. Company	ENGINEER'S SEAL  ORIGINAL SIGNED BY L.D. LLEWELLYN 2006/03/29	 <b>THE CITY OF WINNIPEG</b> WATER AND WASTE DEPARTMENT ENGINEERING DIVISION
	DESIGNED BY: LL CHECKED BY: ND DRAWN BY: TL APPROVED BY: AHL SCALE: 1:100 RELEASED FOR CONSTRUCTION BY: R. SOROKOWSKI DATE: 2005/07/12 DATE: 2006/03/29	CONSULTANT DRAWING NO. WR-E0133	WATER TREATMENT PLANT RESIDUALS HANDLING MECHANICAL AND ELECTRICAL	ELECTRICAL RESIDUALS HANDLING AREA THIRD FLOOR POWER AND LIGHTING PLAN	CITY FILE NUMBER SHEET OF CITY DRAWING NUMBER 1-0601R-A-E0133-001-000