

NOTE:
STATIONS FOR ALL UNDERGROUND
BASED ON SOUTH CONTROL LINE.

- NOTES:
1. ALL CATCH BASINS INSTALLED IN MEDIAN DITCH TO BE SD-025, SEE DETAIL DWG. D-8631.
 2. DOUBLE INLETS TO BE SD-023 AND SD-024 WITH SD-108 COVER, SEE DETAIL DWG. D-8631.
 3. ALL INLETS TO HAVE 250mm INTER CONNECTION PIPING AND 300 LEADS TO MAIN LINE, SEE DETAIL DWG. D-8631.
 4. 1800 AND 900 LDS PIPES UNDER EXISTING SHALLOW UTILITIES (GAS/HYDRO) SHALL BE INSTALLED BY TRENCHLESS METHODS IF POSSIBLE, OTHERWISE OPEN TRENCH WITH CLASS 2 BACKFILL.
 5. FUTURE WM AND WWS SHOWN FOR INFORMATION PURPOSES. FINAL DESIGN TO BE CONFIRMED BY CITY OF WINNIPEG, WATER AND WASTE DEPT.

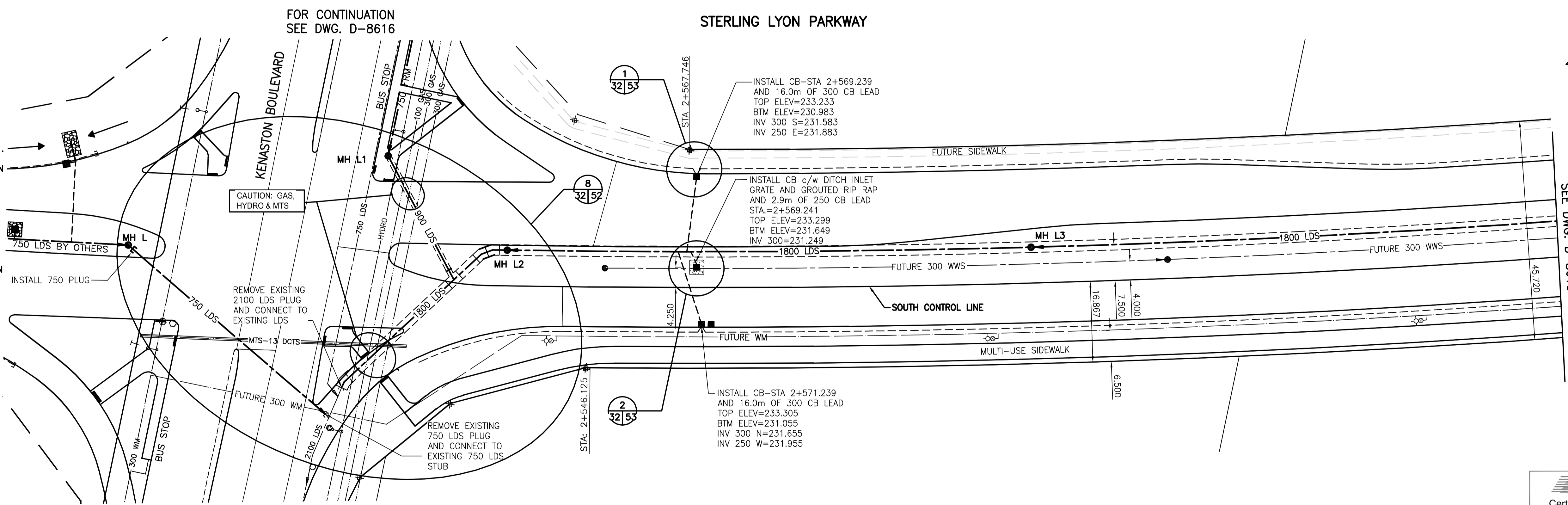

METRIC
WHOLE NUMBERS INDICATE MILLIMETRES
DECIMALIZED NUMBERS INDICATE METRES

WARNING

IF POWER EQUIPMENT OR EXPLOSIVES ARE TO BE USED FOR EXCAVATION ON THIS PROJECT THE CONTRACTOR MUST:
1) NOTIFY THE GAS COMPANY OF THE PROPOSED LOCATION OF EXCAVATION.
2) TAKE PRECAUTION TO AVOID DAMAGE TO GAS COMPANY INSTALLATIONS.
SEE PROVINCIAL REGULATION 140/92 FOR DETAILS

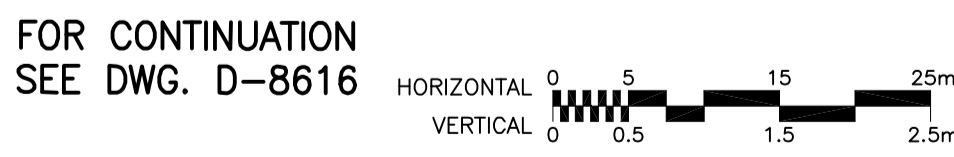

BENCH MARK: BOLT IN 12.5m CONC. PILE, 2.4m N. OF S.L. OF WILKES AVE. (FENCE LINE), & 7m E. OF E. FACE OF 2nd TOWER W. OF THE MOST ELY. SET OF TRACKS OF C.P.R. LA RIVIERE SUBD.

○	GAS	○	MANHOLE	●	HYDRANT
□	MTS	□	CATCH BASIN/CATCH PIT	⊕	WATERMAIN VALVE
△	HYDRO	△	C & G INLET WITH BOX	+	GAS LINE MARKER
◇	VIDEO	◇	TREE	⊕	LIGHT STANDARD
—	TRAFFIC SIGNALS	⊕	TEST HOLE	—	GUY WIRE
—	LAND DRAINAGE SEWER	—	PROPERTY LINE	⊕	TRAFFIC SIGNAL
—	SANITARY/COMBINED SEWER	—	SURVEY BAR	⊕	SIGN
—	CATCHBASIN LEAD	⊕	GEODETIC MONUMENT	⊕	SIGNAL PIT
—	WATERMAIN	⊕	FENCE	⊕	HYDRO MARKER
—	SUBDRAIN	⊕	BACK OF CURB	⊕	BOLLARD
—	DITCH	⊕	ELEVATION	⊕	FORCEMAIN
—	EXISTING	—	LEGEND - PLAN	—	EXISTING
—	NEW	—	LEGEND - PLAN	—	NEW

LOCATION APPROVED UNDERGROUND STRUCTURES

SUPV. U/G STRUCTURES COMMITTEE DATE

NOTE:
LOCATION OF UNDERGROUND STRUCTURES AS SHOWN ARE BASED ON THE BEST INFORMATION AVAILABLE BUT NO GUARANTEE IS GIVEN THAT ALL EXISTING UTILITIES ARE SHOWN OR THAT THE GIVEN LOCATIONS ARE EXACT. CONFIRMATION OF EXISTENCE AND EXACT LOCATION OF ALL SERVICES MUST BE OBTAINED FROM THE INDIVIDUAL UTILITIES BEFORE PROCEEDING WITH CONSTRUCTION.

B.M. ELEV.	66-001	233.425m
NO.	REVISIONS	DATE BY
1	ISSUED FOR TENDER	05.03.29 GWM
0	ISSUED FOR CLIENT REVIEW	05.02.28 AJR

Stantec Consulting Ltd.
905 Waverley Street, Winnipeg, Manitoba
Tel 204-489-5900 Fax 204-453-9012

DESIGNED BY	JKH	CHECKED BY	AJR
DRAWN BY	TAG	APPROVED BY	GWM
AUTHORIZED BY:	R. FINGAS, P. ENG.	DATE	05.03.24

HOR. SCALE: 1:500
VERTICAL: 1:50

ENGINEER'S SEAL

ORIGINAL SEALED BY
A.J. RAPOSO
P. ENG.
05.03.24

CONSULTANT DRAWING NO.
I13703042-U02

THE CITY OF WINNIPEG
PUBLIC WORKS DEPARTMENT
ENGINEERING DIVISION

Winnipeg

KENASTON UNDERPASS
STERLING LYON PARKWAY (EAST)

LAND DRAINAGE SYSTEM
KENASTON BOULEVARD TO STA 2+750

SHEET 32 OF 60
CAD FILE DRAWING NUMBER slpe-ug.dwg
CITY DRAWING NUMBER D-8617

APEGM
Certificate of Authorization
Stantec Consulting Ltd.
No. 1301 Expiry: April 30, 2005