

NOTE:  
STATIONS FOR ALL UNDERGROUND  
BASED ON SOUTH CONTROL LINE.

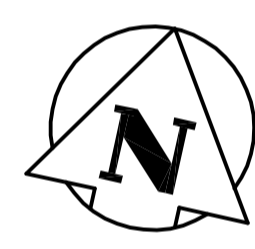
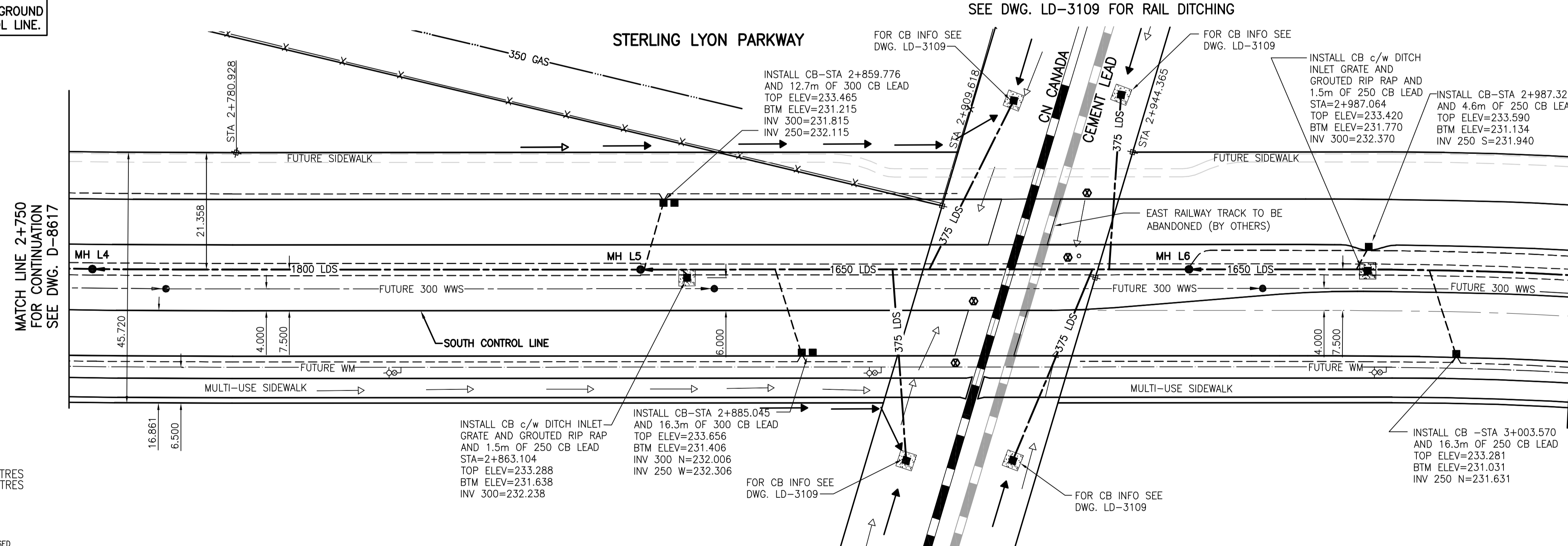

- NOTES:
1. ALL CATCH BASINS INSTALLED IN MEDIAN DITCH TO BE SD-025, SEE DETAIL DWG. D-8631.
  2. DOUBLE INLETS TO BE SD-023 AND SD-024 WITH SD-108 COVER, SEE DETAIL DWG. D-8631.
  3. ALL INLETS TO HAVE 250mm INTER CONNECTION PIPING AND 300 LEADS TO MAIN LINE, SEE DETAIL DWG. D-8631.
  4. FUTURE WM AND WWS SHOWN FOR INFORMATION PURPOSES. FINAL DESIGN TO BE CONFIRMED BY THE CITY OF WINNIPEG, WATER AND WASTE.

**METRIC**  
WHOLE NUMBERS INDICATE MILLIMETRES  
DECIMALIZED NUMBERS INDICATE METRES

**WARNING**  
IF POWER EQUIPMENT OR EXPLOSIVES ARE TO BE USED FOR EXCAVATION ON THIS PROJECT THE CONTRACTOR MUST:  
1) NOTIFY THE GAS COMPANY OF THE PROPOSED LOCATION OF EXCAVATION.  
2) TAKE PRECAUTION TO AVOID DAMAGE TO GAS COMPANY INSTALLATIONS.  
SEE PROVINCIAL REGULATION 140/92 FOR DETAILS

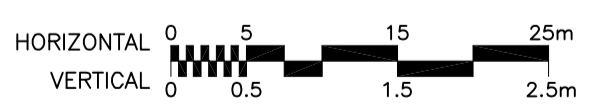

SEE DWG. LD-3109 FOR RAIL DITCHING

BENCH MARK: BOLT IN 12.5m CONC. PILE, 2.4m N. OF S.L. OF WILKES AVE. (FENCE LINE), & 7m E. OF E. FACE OF 2nd TOWER W. OF THE MOST ELY. SET OF TRACKS OF C.P.R. LA RIVIERE SUBD.

—	GAS	○	MANHOLE	●	◇	HYDRANT	⊕
—	MTS	□	CATCH BASIN/CATCH PIT	■	⊕	WATERMAIN VALVE	⊕
—	HYDRO	△	C & G INLET WITH BOX	▲	+	GAS LINE MARKER	+
—	VIDEO	⊙	TREE	⊙	+	LIGHT STANDARD	+
—	TRAFFIC SIGNALS	⊙	TEST HOLE	⊙	+	GUY WIRE	+
—	LAND DRAINAGE SEWER	—	PROPERTY LINE	—	+	TRAFFIC SIGNAL	+
—	SANITARY/COMBINED SEWER	—	SURVEY BAR	—	+	SIGN	+
—	CATCHBASIN LEAD	—	GEODETIC MONUMENT	—	+	SIGNAL PIT	+
—	WATERMAIN	—	FENCE	—	+	HYDRO MARKER	+
—	SUBDRAIN	—	BACK OF CURB	—	+	BOLLARD	+
—	DITCH	—	ELEVATION	—	+	FORCEMAIN	+
—	EXISTING	—	LEGEND - PLAN	—	+	LEGEND - PLAN	+
—	NEW	—	EXISTING	—	+	NEW	+

**LOCATION APPROVED UNDERGROUND STRUCTURES**

SUPV. U/G STRUCTURES COMMITTEE DATE

NOTE:  
LOCATION OF UNDERGROUND STRUCTURES AS SHOWN ARE BASED ON THE BEST INFORMATION AVAILABLE BUT NO GUARANTEE IS GIVEN THAT ALL EXISTING UTILITIES ARE SHOWN OR THAT THE GIVEN LOCATIONS ARE EXACT. CONFIRMATION OF EXISTENCE AND EXACT LOCATION OF ALL SERVICES MUST BE OBTAINED FROM THE INDIVIDUAL UTILITIES BEFORE PROCEEDING WITH CONSTRUCTION.

B.M. ELEV.	66-001	233.425m		
NO.	REVISIONS	DATE	BY	DATE
1	ISSUED FOR TENDER	05.03.29	GWM	
0	ISSUED FOR CLIENT REVIEW	05.02.28	AJR	

**Stantec Consulting Ltd.**  
905 Waverley Street, Winnipeg, Manitoba  
Tel 204-489-5900 Fax 204-453-9012

DESIGNED BY	JKH	CHECKED BY	AJR
DRAWN BY	TAG	APPROVED BY	GWM
AUTHORIZED BY:	R. FINGAS	DATE:	05.03.24

HOR. SCALE: 1:500  
VERTICAL: 1:50

R. FINGAS, P. ENG.  
BRIDGE PROJECTS ENGINEER

ENGINEER'S SEAL

ORIGINAL SEALED BY  
A.J. RAPOSO  
P. ENG.  
05.03.24

CONSULTANT DRAWING NO.  
**I13703042-U03**

**THE CITY OF WINNIPEG**  
PUBLIC WORKS DEPARTMENT  
ENGINEERING DIVISION

**Winnipeg**

**KENASTON UNDERPASS**  
STERLING LYON PARKWAY (EAST)

LAND DRAINAGE SYSTEM  
STA 2+750 TO STA 3+025

SHEET **33** OF **60**  
CAD FILE DRAWING NUMBER  
slp-ug.dwg  
CITY DRAWING NUMBER  
**D-8618**

**APEGM**  
Certificate of Authorization  
Stantec Consulting Ltd.  
No. 1301 Expiry: April 30, 2005