

NOTE: STATIONS FOR ALL UNDERGROUND BASED ON SOUTH CONTROL LINE.

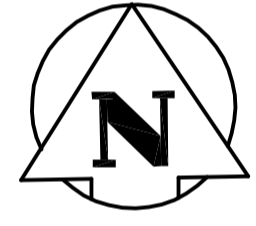
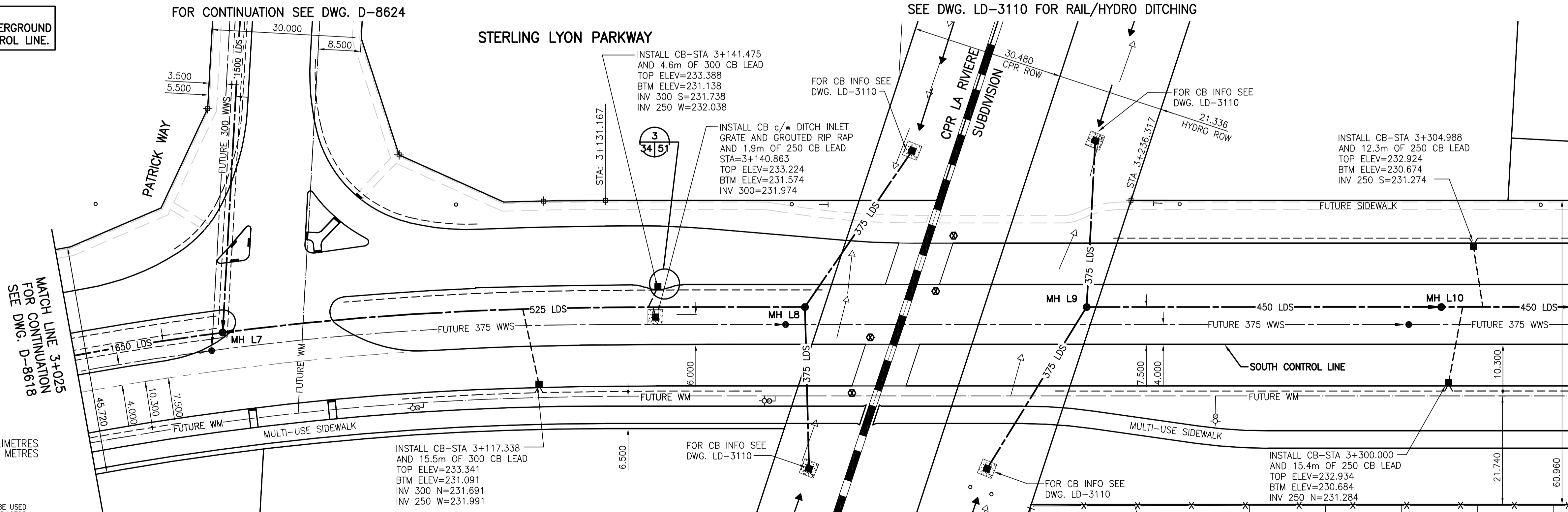

- NOTES:
1. ALL CATCH BASINS INSTALLED IN MEDIAN DITCH TO BE SD-025, SEE DETAIL DWG. D-8631.
 2. DOUBLE INLETS TO BE SD-023 AND SD-024 WITH SD-108 COVER, SEE DETAIL DWG. D-8631.
 3. ALL INLETS TO HAVE 250mm INTER CONNECTION PIPING AND 300 LEADS TO MAIN LINE, SEE DETAIL DWG. D-8631.
 4. FUTURE WM AND WWS SHOWN FOR INFORMATION PURPOSES. FINAL DESIGN TO BE CONFIRMED BY THE CITY OF WINNIPEG, WATER AND WASTE DEPT.

METRIC
WHOLE NUMBERS INDICATE MILLIMETRES
DECIMALIZED NUMBERS INDICATE METRES

WARNING
IF POWER EQUIPMENT OR EXPLOSIVES ARE TO BE USED FOR EXCAVATION ON THIS PROJECT THE CONTRACTOR MUST:
1) NOTIFY THE GAS COMPANY OF THE PROPOSED LOCATION OF EXCAVATION.
2) TAKE PRECAUTION TO AVOID DAMAGE TO GAS COMPANY INSTALLATIONS.
SEE PROVINCIAL REGULATION 140/92 FOR DETAILS

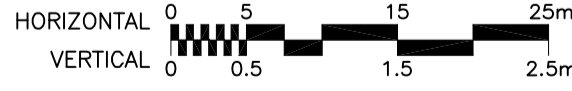

SEE DWG. LD-3110 FOR RAIL/HYDRO DITCHING

BENCH MARK: BOLT IN 7.3m CONC. PILE, 880m WEST OF WAVERLY ST., 0.6m N. OF N.L. OF WILKES AVE. & 2.6m E. OF W.L. OF CAMPBELL ST. N. OF WILKES AVE.

LOCATION APPROVED UNDERGROUND STRUCTURES

○	MANHOLE	⊕	HYDRANT
□	CATCH BASIN/CATCH PIT	⊕	WATERMAIN VALVE
△	C & G INLET WITH BOX	+	GAS LINE MARKER
⊙	TREE	⊕	LIGHT STANDARD
⊙	TEST HOLE	⊕	GUY WIRE
⊙	PROPERTY LINE	⊕	TRAFFIC SIGNAL
⊙	SURVEY BAR	⊕	SIGN
⊙	GEODETIC MONUMENT	⊕	SIGNAL PIT
⊙	FENCE	⊕	HYDRO MARKER
⊙	BACK OF CURB	⊕	BOLLARD
⊙	ELEVATION	⊕	FORCEMAIN

NOTE: LOCATION OF UNDERGROUND STRUCTURES AS SHOWN ARE BASED ON THE BEST INFORMATION AVAILABLE BUT NO GUARANTEE IS GIVEN THAT ALL EXISTING UTILITIES ARE SHOWN OR THAT THE GIVEN LOCATIONS ARE EXACT. CONFIRMATION OF EXISTENCE AND EXACT LOCATION OF ALL SERVICES MUST BE OBTAINED FROM THE INDIVIDUAL UTILITIES BEFORE PROCEEDING WITH CONSTRUCTION.

B.M.	66-002
ELEV.	232.810m

DESIGNED BY	JKH	CHECKED BY	AJR
DRAWN BY	TAG	APPROVED BY	GWM
AUTHORIZED BY	R. FINGAS	DATE	05.03.24

NO.	REVISIONS	DATE	BY	DATE
1	ISSUED FOR TENDER	05.03.24	GWM	
0	ISSUED FOR CLIENT REVIEW	05.02.28	AJR	

Stantec Consulting Ltd.
905 Waverley Street, Winnipeg, Manitoba
Tel 204-489-5900 Fax 204-453-9012

ENGINEER'S SEAL
ORIGINAL SEALED BY A.J. RAPOSO P. ENG. 05.03.24

CONSULTANT DRAWING NO. I13703042-U04

THE CITY OF WINNIPEG
PUBLIC WORKS DEPARTMENT
ENGINEERING DIVISION

Winnipeg

KENASTON UNDERPASS
STERLING LYON PARKWAY (EAST)

LAND DRAINAGE SYSTEM
STA 3+025 TO STA 3+325

SHEET 34 OF 60
CAD FILE DRAWING NUMBER slp-ug.dwg
CITY DRAWING NUMBER D-8619