

KENASTON INTERMODAL LTD.

KENASTON INTERMODAL LTD.

KENASTON BOULEVARD

STERLING LYON PARKWAY

BUS STOP

BUS STOP

LIMIT OF CONTRACT

WEST CONTROL LINE

LIMIT OF CONTRACT

EAST CONTROL LINE

LIMIT OF CONTRACT
0+685.069

MATCH LINE

CIRCULAR CURVE TABLE				
CURVE	RADIUS	LENGTH	TANGENT	DELTA
C85	25.000	4.996	2.506	11°28'59"
C86	165.000	14.556	7.283	5°03'16"
C87	4991.200	12.532	6.266	0°08'38"
C88	165.000	13.078	6.542	4°32'29"
C89	5011.800	75.454	37.728	0°51'45"
C90	165.000	16.598	8.306	5°45'48"
C91	800.000	77.114	38.587	5°31'22"
C92	165.000	13.718	6.863	4°45'49"
C93	165.000	13.718	6.863	4°45'49"
C100	4993.000	43.251	21.626	0°29'47"

FOR GEOMETRY ON STERLING LYON PARKWAY (EAST) SEE DWG P-3258-05

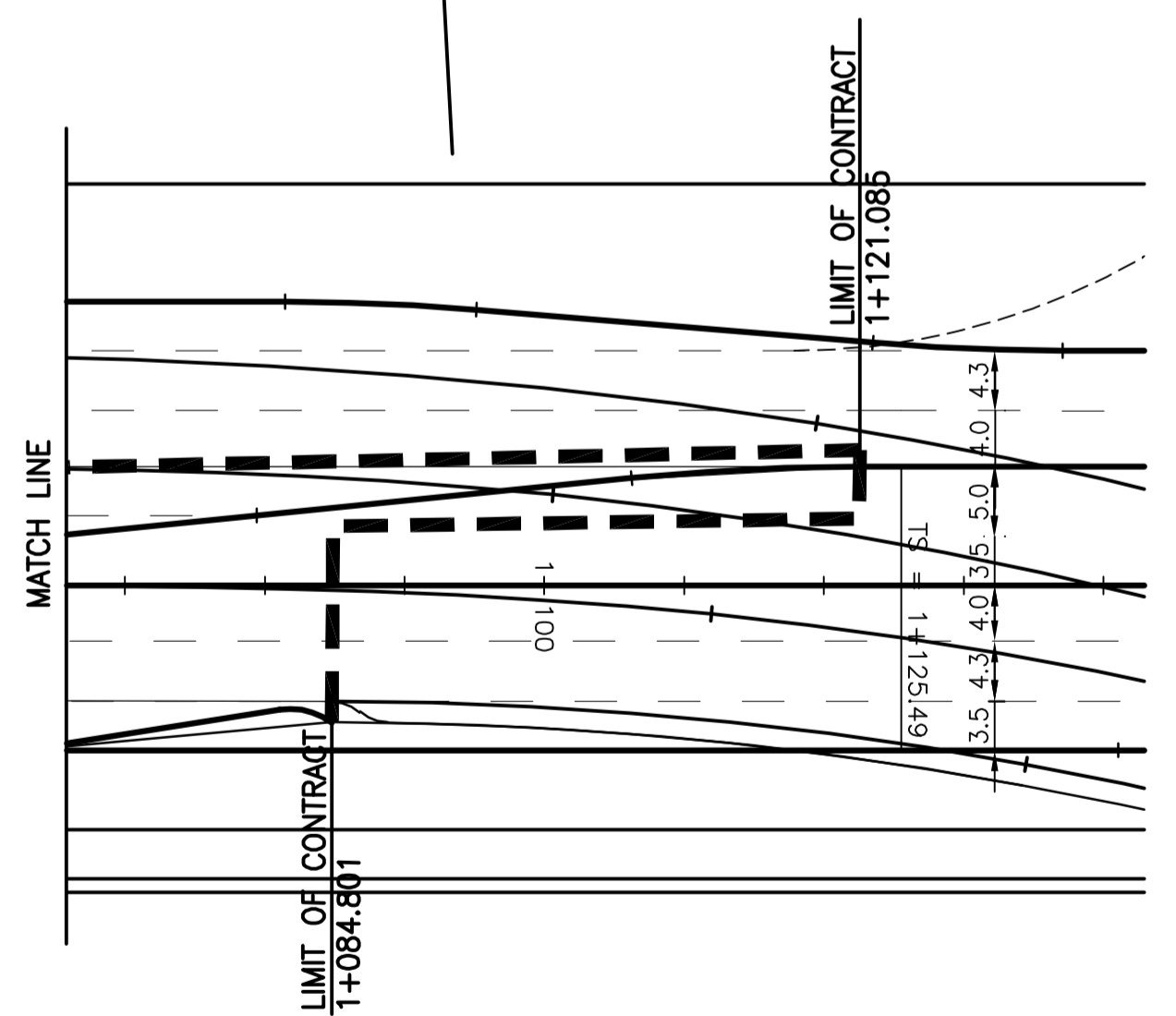

METRIC

WHOLE NUMBERS INDICATE MILLIMETRES
DECIMALIZED NUMBERS INDICATE METRES

WARNING

IF POWER EQUIPMENT OR EXPLOSIVES ARE TO BE USED FOR EXCAVATION ON THIS PROJECT THE CONTRACTOR MUST:
1) NOTIFY THE GAS COMPANY OF THE PROPOSED LOCATION OF EXCAVATION.
2) TAKE PRECAUTION TO AVOID DAMAGE TO GAS COMPANY INSTALLATIONS.
SEE PROVINCIAL REGULATION 140/92 FOR DETAILS

NOTE:
ALL STATIONS WEST OF R.O.W. CENTRELINE, BASED ON WEST CONTROL LINE.
ALL STATIONS EAST OF R.O.W. CENTRELINE, BASED ON EAST CONTROL LINE.
ONLY SURVEY BARS WITH NUMBER AND COORDINATES SHALL BE USED FOR LAYOUT PURPOSES.

BENCH MARK: BOLT IN 12.5m CONC. PILE, 2.4m N. OF S.L. OF WILKES AVE. (FENCE LINE), & 7m E. OF E. FACE OF 2nd TOWER W. OF THE MOST ELY. SET OF TRACKS OF C.P.R. LA RIVIERE SUBD.

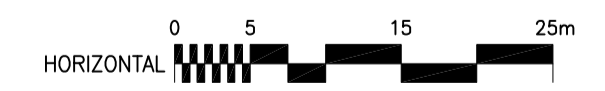

APEGM
Certificate of Authorization
Stantec Consulting Ltd.
No. 1301 Expiry: April 30, 2005

<p>DESIGNED BY: TAS</p> <p>CHECKED BY: TAS, WKB</p>		<p>ENGINEER'S SEAL</p> <p>ORIGINAL SEALED BY: G.W. MOURANT P. ENG. 05.03.24</p>		<p>THE CITY OF WINNIPEG PUBLIC WORKS DEPARTMENT ENGINEERING DIVISION</p>	
<p>DRAWN BY: TAG</p> <p>APPROVED BY: GWM</p>		<p>AUTHORIZED BY: R. FINGAS P. ENG. 05.03.24</p> <p>R. FINGAS, P. ENG. BRIDGE PROJECTS ENGINEER</p>		<p>KENASTON UNDERPASS STERLING LYON PARKWAY (EAST)</p>	
<p>HOR. SCALE: 1:500</p> <p>VERTICAL: N/A</p>		<p>CONSULTANT DRAWING NO. I13703042-H02</p>		<p>HORIZONTAL GEOMETRY STA 0+685 069 TO STA 1+062 085</p>	
<p>NO. REVISIONS</p> <p>DATE</p> <p>BY</p>		<p>DATE</p> <p>BY</p>		<p>SHEET 4 OF 60</p> <p>CAD FILE DRAWING NUMBER ken-geom.dwg</p> <p>CITY DRAWING NUMBER P-3258-04</p>	

V:\113703042 - Kenaston IP DESIGN\A040\DWG-SET\CONTRACT\KIP005-KEN-GEOM.dwg
 2005-03-24 10:03AM By: tjpi