

CHAINAGE ALONG NORTH MEDIAN CONTROL LINE FOR WESTBOUND PROFILES

WESTBOUND

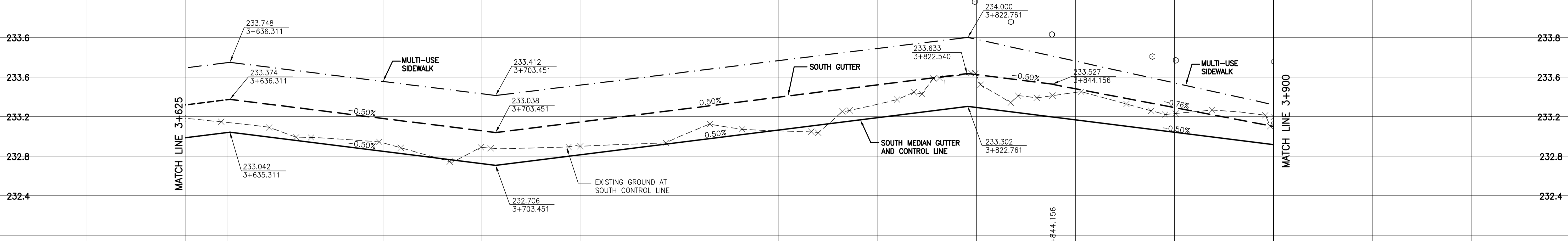

CHAINAGE ALONG SOUTH MEDIAN CONTROL LINE FOR EASTBOUND PROFILES

EASTBOUND

NOTE:  
ALL STATIONS NORTH OF R.O.W. CENTRELINE, BASED ON NORTH CONTROL LINE.  
ALL STATIONS SOUTH OF R.O.W. CENTRELINE, BASED ON SOUTH CONTROL LINE.

- NOTES:
- FOR LANDSCAPING DETAILS REFER TO DWGS P-3258-32 TO P-3258-38.
  - MULTI-USE SIDEWALK PROFILE WILL BE ADJUSTED AS PER FIELD CONDITIONS.

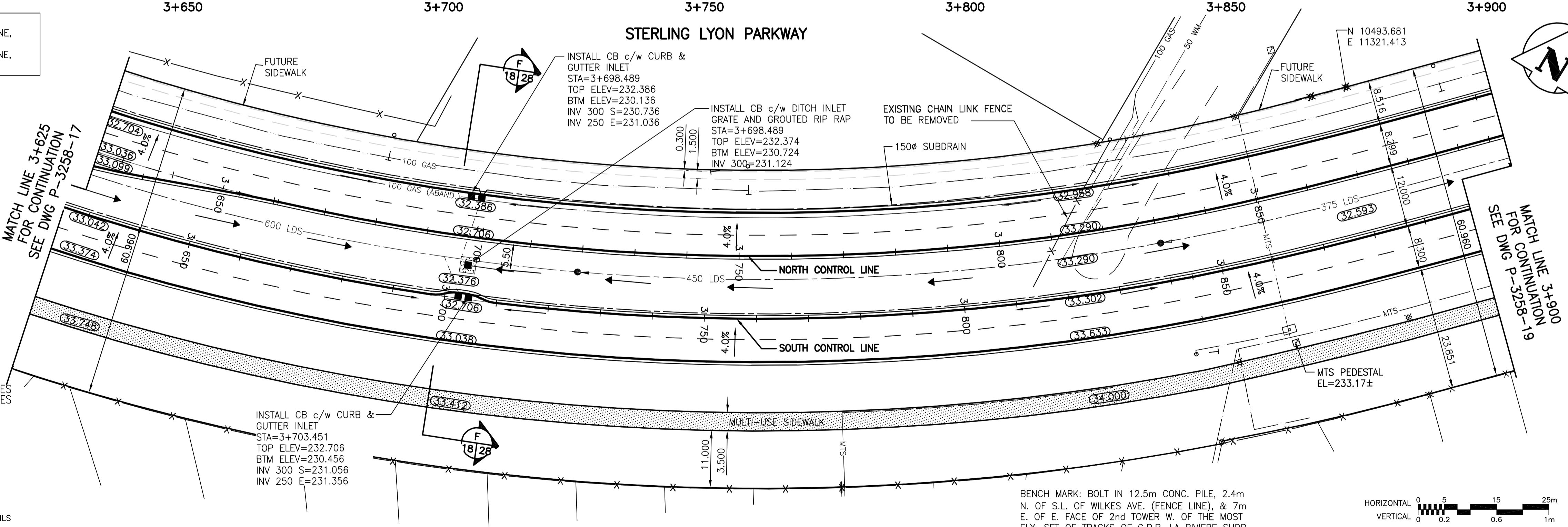

**METRIC**  
WHOLE NUMBERS INDICATE MILLIMETRES  
DECIMALIZED NUMBERS INDICATE METRES

**WARNING**  
IF POWER EQUIPMENT OR EXPLOSIVES ARE TO BE USED FOR EXCAVATION ON THIS PROJECT THE CONTRACTOR MUST:  
1) NOTIFY THE GAS COMPANY OF THE PROPOSED LOCATION OF EXCAVATION.  
2) TAKE PRECAUTION TO AVOID DAMAGE TO GAS COMPANY INSTALLATIONS.  
SEE PROVINCIAL REGULATION 140/92 FOR DETAILS

BENCH MARK: BOLT IN 12.5m CONC. PILE, 2.4m N. OF S.L. OF WILKES AVE. (FENCE LINE) & 7m E. OF E. FACE OF 2nd TOWER W. OF THE MOST ELY. SET OF TRACKS OF C.P.R. LA RIVIERE SUBD.

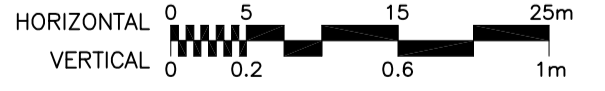

—○—	GAS	○	MANHOLE	■	CONCRETE PAVEMENT
—□—	MTS	□	CATCH BASIN/CATCH PIT	▨	ASPHALT PAVEMENT
—△—	HYDRO	△	C & G INLET WITH BOX	▩	CONC. SIDEWALK/MED. SLAB
—◇—	VIDEO	◇	TREE	▧	PAVING STONE
—◇—	TRAFFIC SIGNALS	⊙	TEST HOLE	▦	TOPSOIL & SOD
—◇—	LAND DRAINAGE SEWER	⊙	PROPERTY LINE	▥	GRAVEL
—◇—	SANITARY/COMBINED SEWER	⊙	SURVEY BAR	▤	RAMP CURB
—◇—	CATCHBASIN LEAD	⊙	GEODETTIC MONUMENT	▣	REMOVAL
—◇—	WATERMAIN	⊙	FENCE	◇	NORTH OR WEST R.
—◇—	SUBDRAIN	⊙	BACK OF CURB	○	SOUTH OR EAST R.
—◇—	DITCH	⊙	ELEVATION	×	NORTH OR SOUTH C.L.
—◇—	EXISTING	—◇—	LEGEND - PLAN	—◇—	EXISTING
—◇—	NEW	—◇—	LEGEND - PLAN	—◇—	NEW

**LOCATION APPROVED UNDERGROUND STRUCTURES**  
SUPV. U/G STRUCTURES COMMITTEE DATE  
NOTE:  
LOCATION OF UNDERGROUND STRUCTURES AS SHOWN ARE BASED ON THE BEST INFORMATION AVAILABLE BUT NO GUARANTEE IS GIVEN THAT ALL EXISTING UTILITIES ARE SHOWN OR THAT THE GIVEN LOCATIONS ARE EXACT. CONFIRMATION OF EXISTENCE AND EXACT LOCATION OF ALL SERVICES MUST BE OBTAINED FROM THE INDIVIDUAL UTILITIES BEFORE PROCEEDING WITH CONSTRUCTION.

B.M. ELEV.	66-001 233.425m
DESIGNED BY	TAS, TAG
CHECKED BY	CLD, VM
DRAWN BY	TAG
APPROVED BY	GWM
AUTHORIZED BY	R. FINGAS
DATE	05.03.24
NO. REVISIONS	0
DATE	05.02.28
BY	TAS

**Stantec Consulting Ltd.**  
905 Waverley Street, Winnipeg, Manitoba  
Tel 204-489-5900 Fax 204-453-9012

DESIGNED BY: TAS, TAG  
CHECKED BY: CLD, VM  
DRAWN BY: TAG  
APPROVED BY: GWM  
AUTHORISED BY: R. FINGAS  
DATE: 05.03.24  
R. FINGAS, P. ENG.  
BRIDGE PROJECTS ENGINEER

ENGINEER'S SEAL  
ORIGINAL SEALED BY G.W. MOURANT P. ENG. 05.03.24  
CONSULTANT DRAWING NO. I13703042-T06

**THE CITY OF WINNIPEG**  
PUBLIC WORKS DEPARTMENT  
ENGINEERING DIVISION

**Kenaston Underpass**  
STERLING LYON PARKWAY (EAST)

HORIZONTAL & VERTICAL ALIGNMENT  
STA 3+625 TO STA 3+900

SHEET 18 OF 60  
CAD FILE DRAWING NUMBER sipe-grade.dwg  
CITY DRAWING NUMBER P-3258-18

**APEGM**  
Certificate of Authorization  
Stantec Consulting Ltd.  
No. 1301 Expiry: April 30, 2005