

NOTE: CHAINAGES SHOWN ARE ALONG S. R. OF PANDORA AVE.

PANDORA AVENUE (WEST)

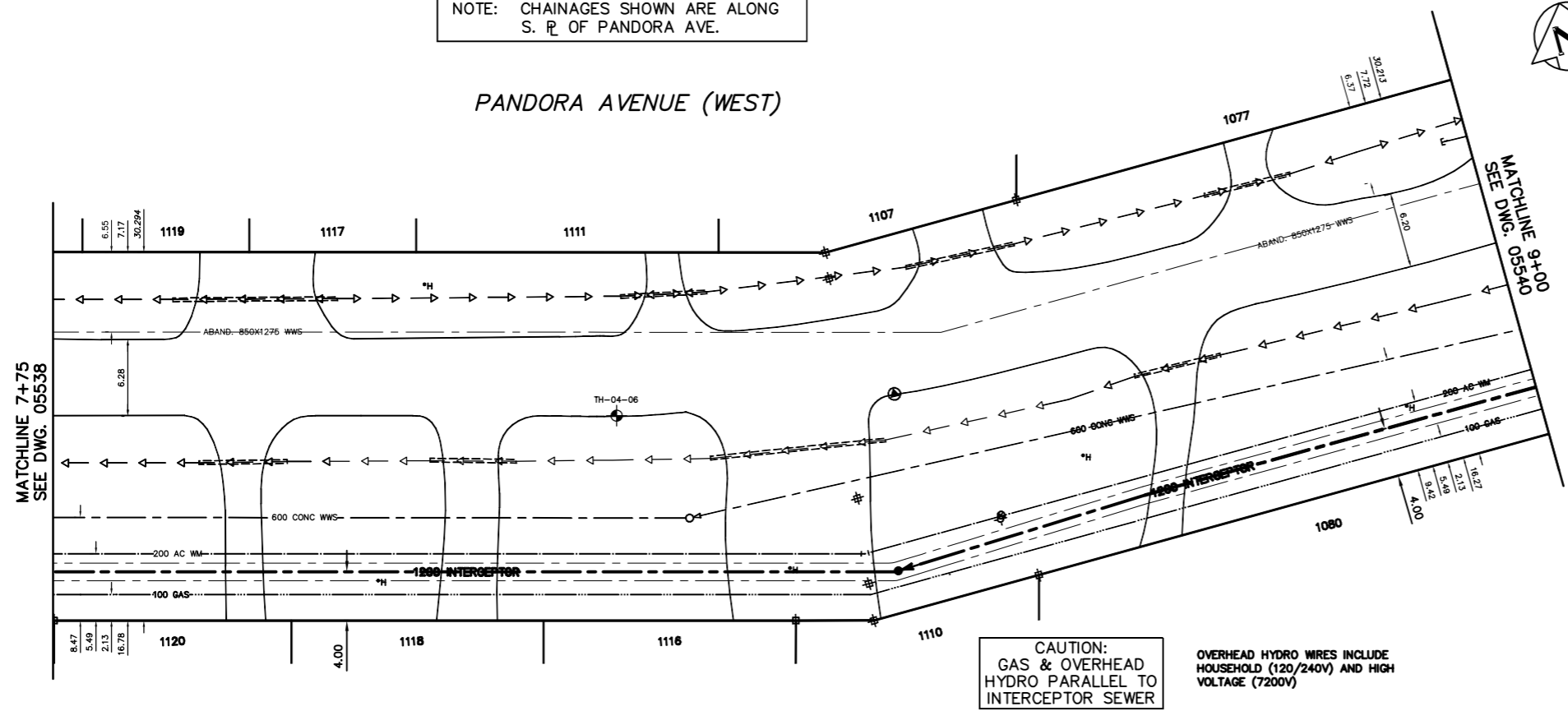

SEWER SERVICE INFORMATION		
ADDRESS	SIZE	€ DIST JUNCTION TIE
1077 PANDORA AVE	4.70 WEL HSE	4.70 E 1ST MH W OWENS
RESIDENTIAL	46.30 E 1ST MH W OWENS	
1080 PANDORA AVE	6.50 WEL HSE	45.80 E 1ST MH W OWENS
RESIDENTIAL	14.50 E 1ST MH W OWENS	
1107 PANDORA AVE	3.80 WEL HSE	14.50 E 1ST MH W OWENS
RESIDENTIAL	15.10 E 1ST MH W OWENS	
1110 PANDORA AVE	5.0 WEL HSE	15.10 E 1ST MH W OWENS
RESIDENTIAL	1.1 EWL HSE	79.0 E 2ND MH E STARLIGHT
1111 PANDORA AVE	79.0 E 2ND MH E STARLIGHT	
RESIDENTIAL	2.9 EWL HSE	79.60 E 2ND MH E STARLIGHT
1116 PANDORA AVE	79.60 E 2ND MH E STARLIGHT	
RESIDENTIAL	1.3 EWL HSE	62.10 E 2ND MH E STARLIGHT
1117 PANDORA AVE	62.10 E 2ND MH E STARLIGHT	
RESIDENTIAL	6.0 WEL HSE	61.50 E 2ND MH E STARLIGHT
1118 PANDORA AVE	61.50 E 2ND MH E STARLIGHT	
RESIDENTIAL	3.0 EWL HSE	37.80 E 2ND MH E STARLIGHT
1119 PANDORA AVE	37.80 E 2ND MH E STARLIGHT	
RESIDENTIAL		

FOR CONSTRUCTION NOTES SEE DRAWING 05533

METRIC
WHOLE NUMBERS INDICATE MILLIMETRES
DECIMALIZED NUMBERS INDICATE METRES

WARNING
IF POWER EQUIPMENT OR EXPLOSIVES ARE TO BE USED FOR EXCAVATION ON THIS PROJECT THE CONTRACTOR
LOCATION OF EXCAVATION:
1) NOTIFY THE GAS COMPANY OF THE PROPOSED LOCATION OF EXCAVATION.
2) TAKE PRECAUTION TO AVOID DAMAGE TO GAS COMPANY INSTALLATIONS.
SEE PROVINCIAL REGULATION 210/72 FOR DETAILS

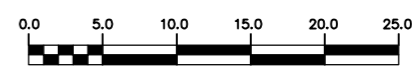

CAUTION:
GAS & OVERHEAD HYDRO WIRES INCLUDE HOUSEHOLD (120/240V) AND HIGH VOLTAGE (7200V)

200 WM	WATERMAIN	200 WM	SL, HYDRO	150 WM	WATERMAIN	150 WM
⊕	HYDRANT	⊕	MTS	⊕	HYDRANT	⊕
⊙	VALVE	⊙	TRAFFIC SIGNALS	⊙	VALVE	⊙
525 LDS	LAND DRAINAGE SEWER	525 LDS	GAS	300 LDS	LAND DRAINAGE SEWER	300 LDS
375 WWS	WASTEWATER SEWER	375 WWS	SURVEY BAR	250 WWS	WASTEWATER SEWER	250 WWS
○	MANHOLE	○	FENCE	⊕	PROFILE	⊕
□	CATCH BASIN	□	POLE - HYDRO, MTS	⊕	GROUND ABOVE PIPE	⊕
▽	CURB INLET	▽	CURB STOP	⊕	⊕ DITCH (NORTH & WEST)	⊕
⊕	JUNCTIONS	⊕	GUY ANCHOR	⊕	⊕ DITCH (SOUTH & EAST)	⊕
⊕	CULVERT	⊕	LIGHT STANDARD			
⊕	ANODE	⊕	TREE			
EXISTING	LEGEND-PLAN	PROPOSED	EXISTING	LEGEND-PLAN	PROPOSED	EXISTING
				LEGEND-PROFILE	PROPOSED	

LOCATION APPROVED UNDERGROUND STRUCTURES	B.M. ELEV.	FIELD BOOK #
SUPV. U/G STRUCTURES COMMITTEE		
DATE		
NOTE: LOCATION OF UNDERGROUND STRUCTURES AS SHOWN ARE BASED ON THE BEST INFORMATION AVAILABLE BUT NO GUARANTEE IS GIVEN THAT ALL EXISTING UTILITIES ARE SHOWN OR THAT THE GIVEN LOCATIONS ARE EXACT. CONFIRMATION OF EXISTENCE AND EXACT LOCATION OF ALL SERVICES MUST BE OBTAINED FROM THE INDIVIDUAL UTILITIES BEFORE PROCEEDING WITH CONSTRUCTION.		
NO. REVISIONS	DATE	BY

CITY OF WINNIPEG
WATER AND WASTE
ENGINEERING DIVISION

DESIGNED BY: SC
CHECKED BY: TW
DRAWN BY: CJH
APPROVED BY: KZ

HOR. SCALE: 1:250
VERTICAL: 1:50

RELEASED FOR CONSTRUCTION: 2005 03 31

ENGINEER'S SEAL
ORIGINAL SIGNED BY K.R. ZUREK
05/03/31

THE CITY OF WINNIPEG
WATER AND WASTE DEPARTMENT

NORTHEAST INTERCEPTOR
STAGE VII
PANDORA AVENUE (WEST)
130 m W OF W_R OWEN STREET TO
5 m W OF W_R OWEN STREET

SHEET 7 of 18
CITY DRAWING NUMBER 05539