

NOTE: CHAINAGES SHOWN ARE ALONG E. R. OF STRATHCONA ST.

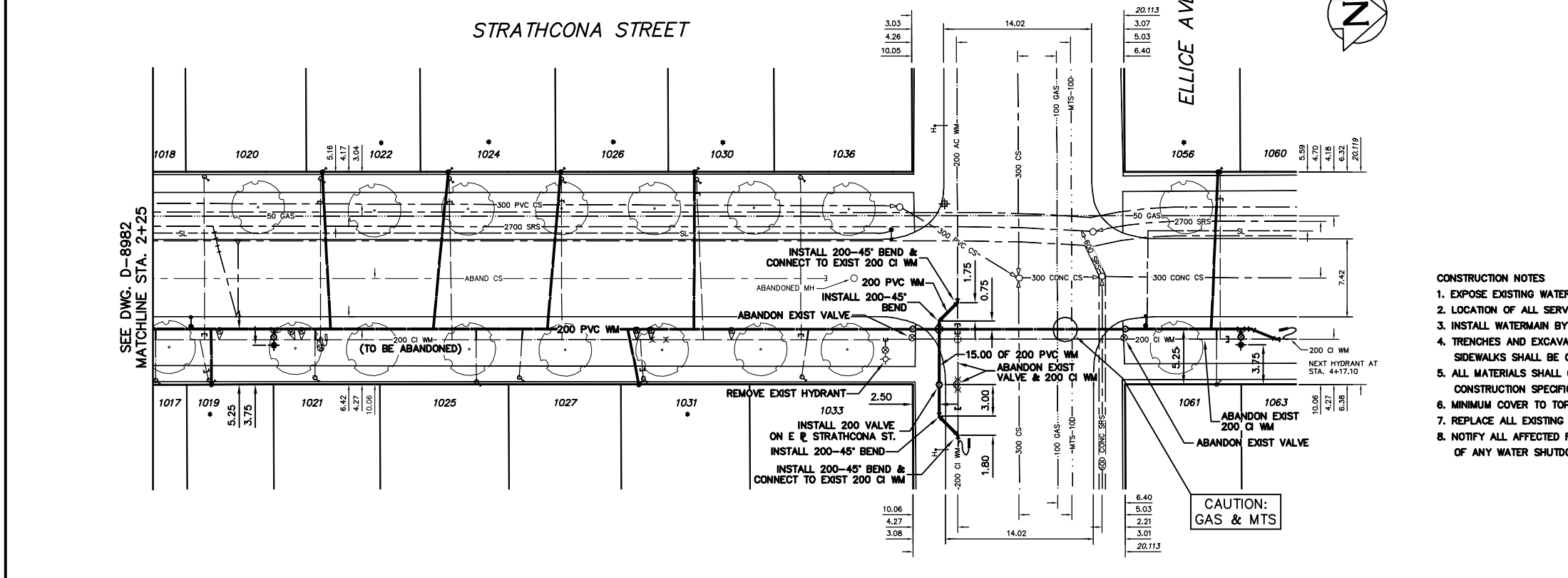

WATER SERVICE INFORMATION					
ADDRESS	SIZE (mm) & TYPE (STREET)	SIZE (mm) & TYPE (PROP)	SHORT & LONG MEASUREMENT	CORP. LOCATION	REMARKS
973 STRATHCONA ST	20	12	1.05 NSL HSE	0.30 S OF S/C	-
974 STRATHCONA ST	20	12	212.05 SSL ELLICE	0.30 S OF S/C	-
975 STRATHCONA ST	20	20	3.84 SNL BLDG	0.30 S OF S/C	-
976 STRATHCONA ST	20	20	217.22 SSL ELLICE	0.30 N OF S/C	-
977 STRATHCONA ST	20	12	1.84 NSL HSE	0.30 N OF S/C	-
978 STRATHCONA ST	20	12	209.94 SSL ELLICE	0.30 N OF S/C	-
979 STRATHCONA ST	20	12	2.23 NSL HSE	0.30 N OF S/C	-
980 STRATHCONA ST	20	12	194.70 SSL ELLICE	0.30 N OF S/C	-
981 STRATHCONA ST	20	20	0.85 NSL HSE	OPP S/C	-
982 STRATHCONA ST	20	12	208.56 SSL ELLICE	OPP S/C	-
983 STRATHCONA ST	20	12	4.53 NSL HSE	OPP S/C	-
984 STRATHCONA ST	20	12	196.55 SSL ELLICE	0.30 S OF S/C	-
985 STRATHCONA ST	20	12	0.11 NSL HSE	0.30 S OF S/C	-
986 STRATHCONA ST	20	12	189.22 SSL ELLICE	1.22 S OF S/C	-
987 STRATHCONA ST	20	12	0.40 NSL HSE	1.52 S OF S/C	-
988 STRATHCONA ST	20	20	181.87 SSL ELLICE	2.13 S OF S/C	-
989 STRATHCONA ST	20	20	0.51 NSL HSE	OPP S/C	-
990 STRATHCONA ST	20	12	181.60 SSL ELLICE	OPP S/C	-
991 STRATHCONA ST	20	12	2.69 NSL HSE	OPP S/C	-
992 STRATHCONA ST	20	20	172.80 SSL ELLICE	OPP S/C	-
993 STRATHCONA ST	20	20	2.69 NSL HSE	OPP S/C	-
994 STRATHCONA ST	20	20	164.33 SSL ELLICE	0.30 N OF S/C	-
995 STRATHCONA ST	20	12	0.62 NSL HSE	0.30 N OF S/C	-
996 STRATHCONA ST	20	12	165.56 SSL ELLICE	0.60 S OF S/C	-
997 STRATHCONA ST	20	12	0.43 NSL HSE	0.60 S OF S/C	-
998 STRATHCONA ST	20	12	158.74 SSL ELLICE	1.52 S OF S/C	-
999 STRATHCONA ST	20	12	2.07 NSL HSE	1.52 S OF S/C	-
1000 STRATHCONA ST	20	12	157.17 SSL ELLICE	OPP S/C	-
1001 STRATHCONA ST	20	12	2.89 NSL HSE	0.60 N OF S/C	-
1002 STRATHCONA ST	20	12	147.93 SSL ELLICE	0.60 N OF S/C	-
1003 STRATHCONA ST	20	12	2.46 NSL HSE	0.60 N OF S/C	-
1004 STRATHCONA ST	20	12	141.40 SSL ELLICE	OPP S/C	-
1005 STRATHCONA ST	20	20	1.51 NSL HSE	OPP S/C	-
1006 STRATHCONA ST	20	20	141.90 SSL ELLICE	OPP S/C	-
1007 STRATHCONA ST	20	20	2.29 NSL HSE	OPP S/C	-
1008 STRATHCONA ST	20	20	133.65 SSL ELLICE	0.30 N OF S/C	-
1009 STRATHCONA ST	20	20	0.33 NSL HSE	0.30 N OF S/C	-
1010 STRATHCONA ST	20	12	132.00 SSL ELLICE	OPP S/C	-
1011 STRATHCONA ST	20	12	1.02 NSL HSE	OPP S/C	-
1012 STRATHCONA ST	20	12	120.79 SSL ELLICE	OPP S/C	-
1013 STRATHCONA ST	20	12	2.70 NSL HSE	OPP S/C	-
1014 STRATHCONA ST	20	12	124.51 SSL ELLICE	OPP S/C	-
1015 STRATHCONA ST	20	12	0.38 NSL HSE	DBLE. SERV. WITH 1004	-
1016 STRATHCONA ST	20	12	106.98 SSL ELLICE	OPP S/C	-
1017 STRATHCONA ST	20	12	0.55 NSL HSE	OPP S/C	-
1018 STRATHCONA ST	20	12	117.48 SSL ELLICE	OPP S/C	-
1019 STRATHCONA ST	20	12	0.95 NSL HSE	OPP S/C	-
1020 STRATHCONA ST	20	12	106.90 SSL ELLICE	DBLE. SERV. WITH 1002	-
1021 STRATHCONA ST	20	20	2.78 NSL HSE	0.45 S OF S/C	-
1022 STRATHCONA ST	20	20	94.99 SSL ELLICE	0.60 S OF S/C	-
1023 STRATHCONA ST	20	20	0.82 NSL HSE	0.60 S OF S/C	-
1024 STRATHCONA ST	20	20	92.49 SSL ELLICE	0.30 S OF S/C	-
1025 STRATHCONA ST	20	20	2.68 NSL HSE	0.60 S OF S/C	-
1026 STRATHCONA ST	20	20	82.74 SSL ELLICE	0.60 S OF S/C	-
1027 STRATHCONA ST	20	20	2.06 NSL HSE	0.60 N OF S/C	-
1028 STRATHCONA ST	20	20	71.63 SSL ELLICE	OPP S/C	-
1029 STRATHCONA ST	20	20	3.19 NSL HSE	OPP S/C	-
1030 STRATHCONA ST	20	20	80.58 SSL ELLICE	OPP S/C	-
1031 STRATHCONA ST	20	20	0.31 NSL HSE	OPP S/C	-
1032 STRATHCONA ST	20	20	1.03 NSL HSE	0.92 S OF S/C	-
1033 STRATHCONA ST	20	20	66.58 SSL ELLICE	OPP S/C	-
1034 STRATHCONA ST	20	20	0.31 NSL HSE	OPP S/C	-
1035 STRATHCONA ST	20	20	67.07 SSL ELLICE	OPP S/C	-
1036 STRATHCONA ST	20	20	3.19 NSL HSE	OPP S/C	-
1037 STRATHCONA ST	20	20	56.83 SSL ELLICE	OPP S/C	-
1038 STRATHCONA ST	20	20	0.21 SSL HSE	OPP S/C	-
1039 STRATHCONA ST	20	20	56.06 SSL ELLICE	0.30 N OF S/C	-
1040 STRATHCONA ST	20	20	0.72 NSL HSE	0.30 N OF S/C	-
1041 STRATHCONA ST	20	20	43.84 SSL ELLICE	OPP S/C	-
1042 STRATHCONA ST	20	20	2.68 NSL HSE	OPP S/C	-
1043 STRATHCONA ST	20	20	41.27 SSL ELLICE	OPP S/C	-
1044 STRATHCONA ST	20	20	0.41 NSL HSE	OPP S/C	-
1045 STRATHCONA ST	20	20	33.23 SSL ELLICE	0.30 N OF S/C	-
1046 STRATHCONA ST	20	20	0.60 NSL HSE	0.60 N OF S/C	-
1047 STRATHCONA ST	20	20	37.18 SSL ELLICE	0.60 N OF S/C	-
1048 STRATHCONA ST	20	20	1.67 NSL HSE	0.60 N OF S/C	-
1049 STRATHCONA ST	20	20	20.40 SSL ELLICE	0.30 S OF S/C	-
1050 STRATHCONA ST	20	20	0.58 NSL HSE	0.30 S OF S/C	-
1051 STRATHCONA ST	20	20	25.53 SSL ELLICE	0.60 N OF S/C	-
1052 STRATHCONA ST	20	12	0.35 NSL HSE	0.60 N OF S/C	-
1053 STRATHCONA ST	20	12	10.47 SSL ELLICE	OPP S/C	-
1054 STRATHCONA ST	20	20	1.33 NSL HSE	OPP S/C	-
1055 STRATHCONA ST	20	20	10.54 SSL ELLICE	OPP S/C	-
1056 STRATHCONA ST	20	20	0.63 NSL HSE	OPP S/C	-
1057 STRATHCONA ST	20	20	9.10 NSL ELLICE	OPP S/C	-
1058 STRATHCONA ST	20	20	2.23 NSL HSE	OPP S/C	-
1059 STRATHCONA ST	20	20	18.24 NSL ELLICE	OPP S/C	-
1060 STRATHCONA ST	20	20	0.51 NSL HSE	OPP S/C	-
1061 STRATHCONA ST	20	20	8.71 NSL ELLICE	0.30 S OF S/C	-
1062 STRATHCONA ST	20	20	0.63 NSL HSE	0.30 S OF S/C	-
1063 STRATHCONA ST	20	20	19.53 NSL ELLICE	-	-

*SERVICES TO BE RENEWED TO R. ALL OTHERS TO BE RECONNECTED

- CONSTRUCTION NOTES**
1. EXPOSE EXISTING WATERMAIN & CONFIRM INVERTS PRIOR TO CONSTRUCTION.
 2. LOCATION OF ALL SERVICES TO BE CONFIRMED IN THE FIELD.
 3. INSTALL WATERMAIN BY TRENCHLESS METHODS.
 4. TRENCHES AND EXCAVATIONS WITHIN 1 METRE OF A PAVED AREA INCLUDING SIDEWALKS SHALL BE CLASS 3 BACKFILL.
 5. ALL MATERIALS SHALL CONFORM TO THE CITY OF WINNIPEG STANDARD CONSTRUCTION SPECIFICATIONS.
 6. MINIMUM COVER TO TOP OF WATERMAIN SHALL BE 2.4 m.
 7. REPLACE ALL EXISTING LEAD SERVICES FROM PROPOSED WATERMAIN TO R.
 8. NOTIFY ALL AFFECTED RESIDENTS AND BUSINESSES 24 HOURS IN ADVANCE OF ANY WATER SHUTDOWNS OR DISRUPTION OF SERVICE.

METRIC
WHOLE NUMBERS INDICATE MILLIMETRES
DECIMALIZED NUMBERS INDICATE METRES
NOTE: ALL VALVES TO BE INSTALLED COUNTERCLOCKWISE TO CLOSE

WARNING
IF POWER EQUIPMENT OR EXPLOSIVES ARE TO BE USED FOR EXCAVATION ON THIS PROJECT THE CONTRACTOR MUST:
1) NOTIFY THE GAS COMPANY OF THE PROPOSED LOCATION OF EXCAVATION.
2) TAKE PRECAUTION TO AVOID DAMAGE TO GAS COMPANY INSTALLATIONS.
SEE PROVINCIAL REGULATION 210/72 FOR DETAILS

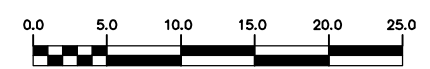

<table border="1"> <tr><td>200 WM</td><td>WATERMAIN</td><td>200 WM</td><td>SL - HYDRO</td><td>150 WM</td><td>WATERMAIN</td><td>150 WM</td></tr> <tr><td>⊕</td><td>HYDRANT</td><td>⊕</td><td>MTS</td><td>⊕</td><td>HYDRANT</td><td>⊕</td></tr> <tr><td>⊙</td><td>VALVE</td><td>⊙</td><td>TRAFFIC SIGNALS</td><td>⊙</td><td>VALVE</td><td>⊙</td></tr> <tr><td>525 LDS</td><td>LAND DRAINAGE SEWER</td><td>525 LDS</td><td>GAS</td><td>50 GAS</td><td>LAND DRAINAGE SEWER</td><td>300 LDS</td></tr> <tr><td>375 WWS</td><td>WASTEWATER SEWER</td><td>375 WWS</td><td>SURVEY BAR</td><td>250 WWS</td><td>WASTEWATER SEWER</td><td>250 WWS</td></tr> <tr><td>○</td><td>MANHOLE</td><td>○</td><td>FENCE</td><td>⊗</td><td>PROFILE</td><td></td></tr> <tr><td>□</td><td>CATCH BASIN</td><td>□</td><td>POLE - HYDRO, MTS</td><td>⊗</td><td>GROUND ABOVE PIPE</td><td></td></tr> <tr><td>▽</td><td>CURB INLET</td><td>▽</td><td>CURB STOP</td><td></td><td></td><td></td></tr> <tr><td>◁</td><td>REDUCER</td><td>◁</td><td>GUY ANCHOR</td><td></td><td></td><td></td></tr> <tr><td>X</td><td>COUPLING</td><td>X</td><td>LIGHT STANDARD</td><td></td><td></td><td></td></tr> <tr><td>⊖</td><td>ANODE</td><td>⊖</td><td>TREE</td><td></td><td></td><td></td></tr> <tr><td>EXISTING</td><td>LEGEND-PLAN</td><td>PROPOSED</td><td>EXISTING</td><td>LEGEND-PLAN</td><td>PROPOSED</td><td>EXISTING</td></tr> <tr><td></td><td>LEGEND-PROFILE</td><td></td><td></td><td>LEGEND-PROFILE</td><td></td><td></td></tr> </table>	200 WM	WATERMAIN	200 WM	SL - HYDRO	150 WM	WATERMAIN	150 WM	⊕	HYDRANT	⊕	MTS	⊕	HYDRANT	⊕	⊙	VALVE	⊙	TRAFFIC SIGNALS	⊙	VALVE	⊙	525 LDS	LAND DRAINAGE SEWER	525 LDS	GAS	50 GAS	LAND DRAINAGE SEWER	300 LDS	375 WWS	WASTEWATER SEWER	375 WWS	SURVEY BAR	250 WWS	WASTEWATER SEWER	250 WWS	○	MANHOLE	○	FENCE	⊗	PROFILE		□	CATCH BASIN	□	POLE - HYDRO, MTS	⊗	GROUND ABOVE PIPE		▽	CURB INLET	▽	CURB STOP				◁	REDUCER	◁	GUY ANCHOR				X	COUPLING	X	LIGHT STANDARD				⊖	ANODE	⊖	TREE				EXISTING	LEGEND-PLAN	PROPOSED	EXISTING	LEGEND-PLAN	PROPOSED	EXISTING		LEGEND-PROFILE			LEGEND-PROFILE			<p>LOCATION APPROVED UNDERGROUND STRUCTURES</p> <p>NOTE: LOCATION OF UNDERGROUND STRUCTURES AS SHOWN ARE BASED ON THE BEST INFORMATION AVAILABLE BUT NO GUARANTEE IS GIVEN THAT ALL EXISTING UTILITIES ARE SHOWN OR THAT THE GIVEN LOCATIONS ARE EXACT. CONFIRMATION OF EXISTENCE AND EXACT LOCATION OF ALL SERVICES MUST BE OBTAINED FROM THE INDIVIDUAL UTILITIES BEFORE PROCEEDING WITH CONSTRUCTION.</p>	<p>B.M. ELEV.</p> <p>FIELD BOOK #:</p> <p>POSTED TO LBS</p>	<p>CITY OF WINNIPEG WATER AND WASTE ENGINEERING DIVISION</p> <p>DESIGNED BY: NC CHECKED BY: TW</p> <p>DRAWN BY: CJH APPROVED BY: KZ</p> <p>HOR. SCALE: 1:250 VERTICAL: 1:50</p> <p>NO. REVISIONS: _____ DATE: _____</p>	<p>ENGINEER'S SEAL</p> <p>ORIGINAL SIGNED BY: K.R. ZUREK DATE: 06/05/02</p>	<p>THE CITY OF WINNIPEG WATER AND WASTE DEPARTMENT</p> <p>2005 WATERMAIN RENEWALS</p> <p>STRATHCONA STREET ELLICE AVENUE TO 72 S OF S R ELLICE AVENUE</p>	<p>SHEET 8 OF 8</p> <p>CITY DRAWING NUMBER: D-8983</p>
200 WM	WATERMAIN	200 WM	SL - HYDRO	150 WM	WATERMAIN	150 WM																																																																																											
⊕	HYDRANT	⊕	MTS	⊕	HYDRANT	⊕																																																																																											
⊙	VALVE	⊙	TRAFFIC SIGNALS	⊙	VALVE	⊙																																																																																											
525 LDS	LAND DRAINAGE SEWER	525 LDS	GAS	50 GAS	LAND DRAINAGE SEWER	300 LDS																																																																																											
375 WWS	WASTEWATER SEWER	375 WWS	SURVEY BAR	250 WWS	WASTEWATER SEWER	250 WWS																																																																																											
○	MANHOLE	○	FENCE	⊗	PROFILE																																																																																												
□	CATCH BASIN	□	POLE - HYDRO, MTS	⊗	GROUND ABOVE PIPE																																																																																												
▽	CURB INLET	▽	CURB STOP																																																																																														
◁	REDUCER	◁	GUY ANCHOR																																																																																														
X	COUPLING	X	LIGHT STANDARD																																																																																														
⊖	ANODE	⊖	TREE																																																																																														
EXISTING	LEGEND-PLAN	PROPOSED	EXISTING	LEGEND-PLAN	PROPOSED	EXISTING																																																																																											
	LEGEND-PROFILE			LEGEND-PROFILE																																																																																													