

NOTES:

- SPECIFIED SNOW LOAD
- SPECIFIED SERVICE LOAD = 1 kPa
- SEE DRAWING WB-S5451 FOR PRECAST DETAILS.
- SEE DETAIL 3 TO SUPPORT LIGHT FIXTURES, INSTALLED UNDER SEPARATE CONTRACT.
- PROVIDE 20mm DIA SLEEVES IN ALL DOUBLE TEE STEMS 1200mm C/C.
- PROVIDE GALVANIZED STEEL SLEEVES FOR THROUGH BOLTS.
- COORDINATE WITH CONTRACT ADMINISTRATOR LOCATION OF ALL THROUGH BOLTS (BO 742-2005)
- MISCELLANEOUS STEEL AND CRANE MANUFACTURER SHALL PROVIDE INSTALLATION TEMPLATES TO THE PRECAST MANUFACTURER.

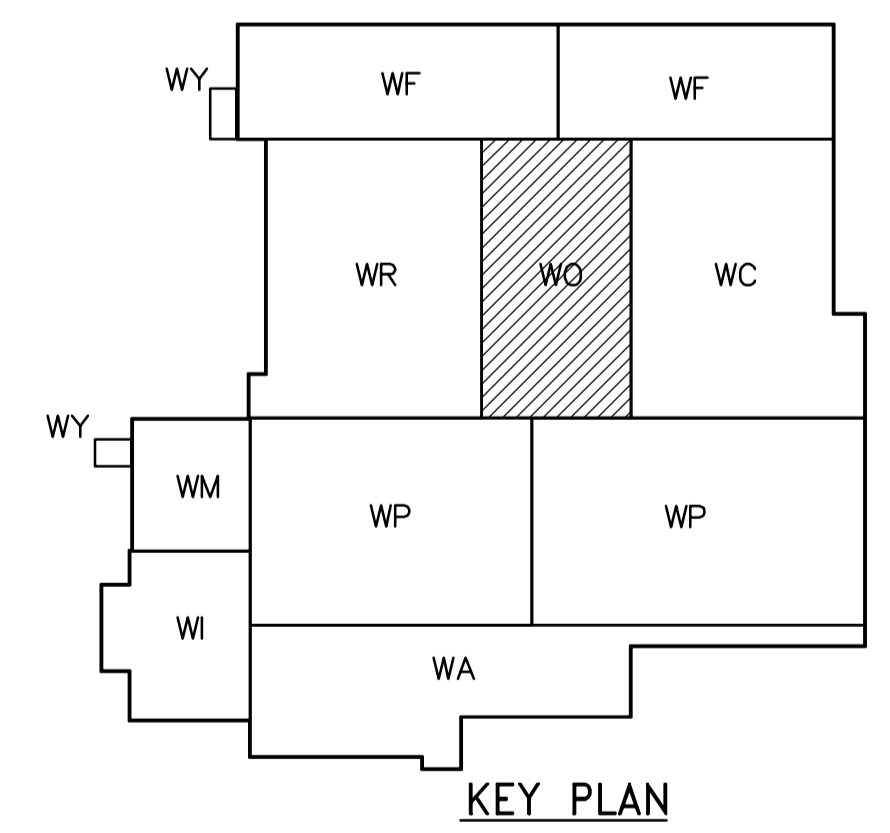

ROOF PLAN
1:100

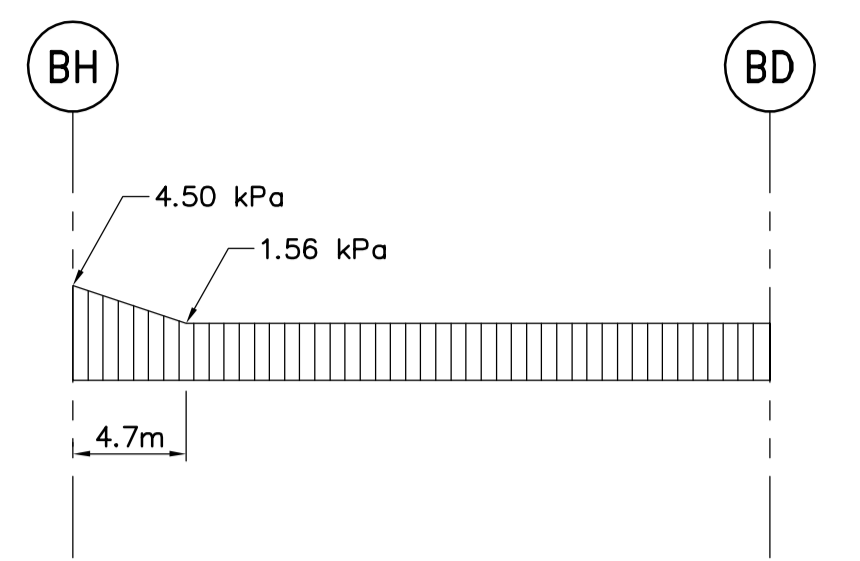
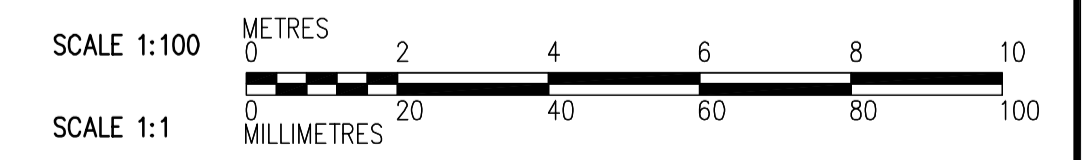

<p>APEGN Certificate of Authorization CH2M HILL Canada Ltd. No. 1441 Expiry: April 30, 2007</p>	<p>Frederickson Cooper ARCHITECTS</p>	<p>EarthTech A 100 International Ltd. Company</p>	ENGINEER'S SEAL	<p>THE CITY OF WINNIPEG WATER AND WASTE DEPARTMENT ENGINEERING DIVISION</p>
			<p>DESIGNED BY: MH</p> <p>CHECKED BY: AP</p> <p>DRAWN BY: CR</p> <p>APPROVED BY: AHL</p> <p>SCALE: 1:100</p> <p>RELEASED FOR CONSTRUCTION BY: R. SOROKOWSKI</p>	
<p>00 ISSUED FOR TENDER 06/10/11 DK</p> <p>NO. REVISIONS DATE BY DATE 2006/08/30 DATE 2006/10/11</p>	<p>CONSULTANT DRAWING NO. WO-S5146</p>		<p>STRUCTURAL OZONATION AREA ROOF PLAN</p>	<p>CITY DRAWING NUMBER 1-06010-A-S5146-001-000</p>