

CHAINAGE ALONG EAST BACK OF CURB OF RAMP

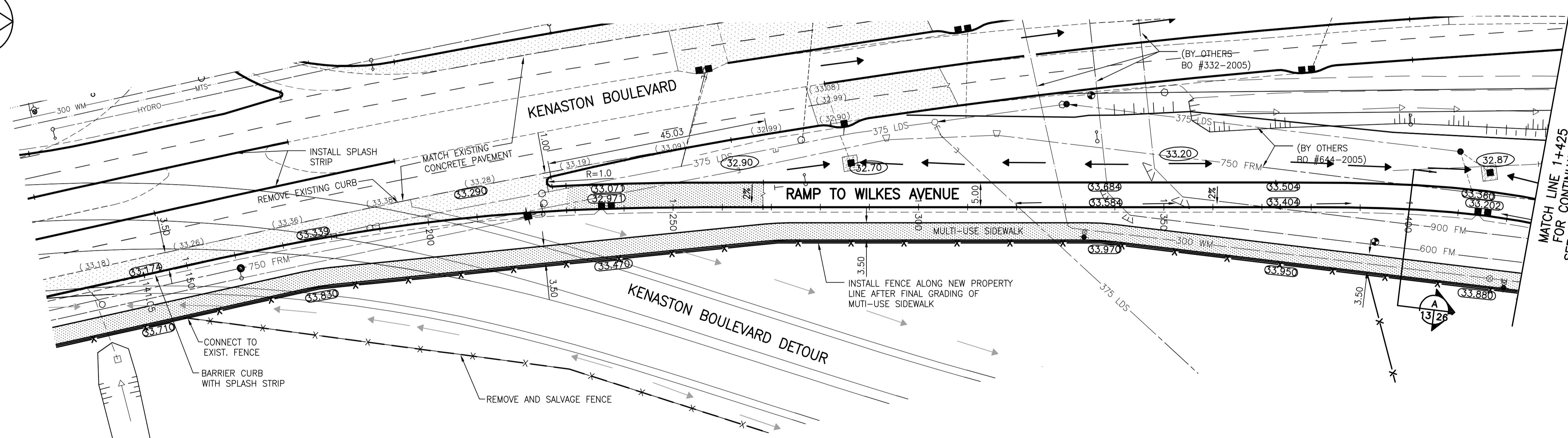
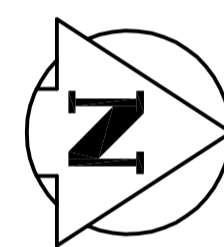

MATCH LINE 1+425 FOR CONTINUATION SEE DWG. P-3258-185

WARNING

IF POWER EQUIPMENT OR EXPLOSIVES ARE TO BE USED FOR EXCAVATION ON THIS PROJECT THE CONTRACTOR MUST:
 1) NOTIFY THE GAS COMPANY OF THE PROPOSED LOCATION OF EXCAVATION.
 2) TAKE PRECAUTION TO AVOID DAMAGE TO GAS COMPANY INSTALLATIONS.
 SEE PROVINCIAL REGULATION 140/92 FOR DETAILS

METRIC

WHOLE NUMBERS INDICATE MILLIMETRES
 DECIMALIZED NUMBERS INDICATE METRES

NOTE:
 ALL UTILITY POLES WITHIN PROPOSED ROADWAY TO BE RELOCATED (BY OTHERS)

BENCH MARK: BOLT IN 12.5m CONC. PILE, 2.4m N. OF S.L. OF WILKES AVE. (FENCE LINE), & 7m E. OF E. FACE OF 2nd TOWER W. OF THE MOST ELY. SET OF TRACKS OF C.P.R. LA RIVIERE SUB. DIV.



APEGM
 Certificate of Authorization
 Stantec Consulting Ltd.
 No. 1301 Expiry: April 30, 2006

—	GAS	○	MANHOLE	●	CONCRETE PAVEMENT	▨
—	MTS	□	CATCH BASIN/CATCH PIT	■	ASPHALT PAVEMENT	▩
—	HYDRO	△	C & G INLET WITH BOX	▲	CONC. SIDEWALK/MED. SLAB	▧
—	VIDEO	⊙	TREE	⊙	PAVING STONE	▤
—	TRAFFIC SIGNALS	⊙ TH#10	TEST HOLE	⊙	TOPSOIL & SOD	▥
—	LAND DRAINAGE SEWER	—	PROPERTY LINE	—	GRAVEL	▦
—	SANITARY/COMBINED SEWER	—	SURVEY BAR	—	RAMP CURB	▧
—	CATCHBASIN LEAD	—	GEODETTIC MONUMENT	—	REMOVAL	▨
—	WATERMAIN	—	FENCE	—	SWALE ELEVATION	(33.00)
—	SUBDRAIN	—	BACK OF CURB	—		
—	DITCH	—	ELEVATION	(33.00)		
—	EXISTING	—	LEGEND - PLAN	—	EXISTING	LEGEND - PLAN
—	NEW	—	LEGEND - PLAN	—	NEW	LEGEND - PLAN

LOCATION APPROVED UNDERGROUND STRUCTURES
 SUPV. U/G STRUCTURES COMMITTEE DATE
NOTE:
 LOCATION OF UNDERGROUND STRUCTURES AS SHOWN ARE BASED ON THE BEST INFORMATION AVAILABLE BUT NO GUARANTEE IS GIVEN THAT ALL EXISTING UTILITIES ARE SHOWN OR THAT THE GIVEN LOCATIONS ARE EXACT. CONFIRMATION OF EXISTENCE AND EXACT LOCATION OF ALL SERVICES MUST BE OBTAINED FROM THE INDIVIDUAL UTILITIES BEFORE PROCEEDING WITH CONSTRUCTION.

B.M.	66-001
ELEV.	233.425m
NO.	ISSUED FOR TENDER
DATE	06.03.03
BY	GWM
NO.	REVISIONS
DATE	06.01.08
BY	

Stantec Consulting Ltd.
 905 Waverley Street, Winnipeg, Manitoba
 Tel 204-489-5900 Fax 204-453-9012

DESIGNED BY	VMM, TAG	CHECKED BY	KAR
DRAWN BY	TAG, VMM	APPROVED BY	GWM
HOR. SCALE:	1:500	AUTHORIZED BY:	R. FINGAS
VERTICAL:	1:20	DATE	06.03.03
			R. FINGAS, P. ENG. BRIDGE PROJECTS ENGINEER

ENGINEER'S SEAL
 ORIGINAL SEALED BY
 G.W. MOURANT
 P. ENG.
 06.03.03
 CONSULTANT DRAWING NO.
I13703042-T24

THE CITY OF WINNIPEG
 PUBLIC WORKS DEPARTMENT
Winnipeg ENGINEERING DIVISION

KENASTON UNDERPASS PROJECT
 KENASTON BOULEVARD RECONSTRUCTION

RAMP TO WILKES AVENUE
 HORIZONTAL & VERTICAL ALIGNMENT
 STA 1+150 TO STA 1+425

SHEET 13 OF 52
 CAD FILE DRAWING NUMBER ku-13-14-665.dwg
 CITY DRAWING NUMBER P-3258-184