

CHAINAGE ALONG EAST AND SOUTH
BACK OF CURB OF RAMP

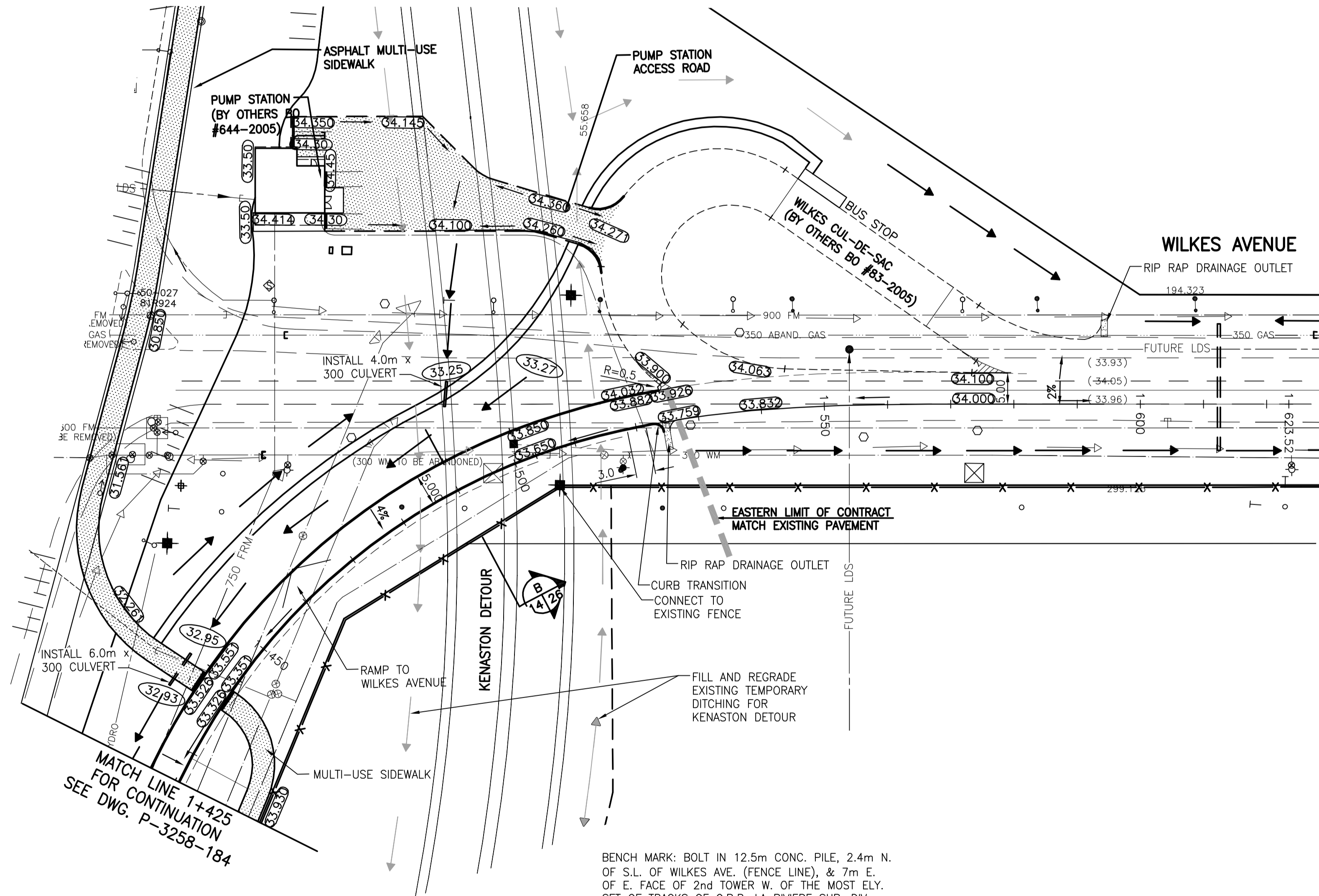

METRIC

WHOLE NUMBERS INDICATE MILLIMETRES
DECIMALIZED NUMBERS INDICATE METRES

WARNING

IF POWER EQUIPMENT OR EXPLOSIVES ARE TO BE USED FOR EXCAVATION ON THIS PROJECT THE CONTRACTOR MUST:
1) NOTIFY THE GAS COMPANY OF THE PROPOSED LOCATION OF EXCAVATION.
2) TAKE PRECAUTION TO AVOID DAMAGE TO GAS COMPANY INSTALLATIONS.
SEE PROVINCIAL REGULATION 140/92 FOR DETAILS

NOTE:
ALL UTILITY POLES WITHIN PROPOSED ROADWAY TO BE RELOCATED (BY OTHERS)

BENCH MARK: BOLT IN 12.5m CONC. PILE, 2.4m N. OF S.L. OF WILKES AVE. (FENCE LINE), & 7m E. OF E. FACE OF 2nd TOWER W. OF THE MOST ELY. SET OF TRACKS OF C.P.R. LA RIVIERE SUB. DIV.

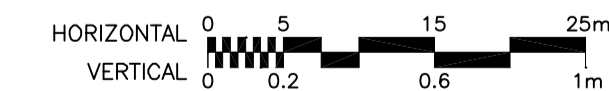

APEGM
Certificate of Authorization
Stantec Consulting Ltd.
No. 1301 Expiry: April 30, 2006

---	GAS	○	MANHOLE	●	CONCRETE PAVEMENT	▨
---	MTS	□	CATCH BASIN/CATCH PIT	■	ASPHALT PAVEMENT	▩
---	HYDRO	△	C & G INLET WITH BOX	▲	CONC. SIDEWALK/MED. SLAB	▧
---	VIDEO	⊙	TREE	⊙	PAVING STONE	▤
---	TRAFFIC SIGNALS	⊙ TH#10	TEST HOLE	⊙	TOPSOIL & SOD	▥
---	LAND DRAINAGE SEWER	---	PROPERTY LINE	---	GRAVEL	▦
---	SANITARY/COMBINED SEWER	---	SURVEY BAR	---	RAMP CURB	▧
---	CATCHBASIN LEAD	---	GEODETIC MONUMENT	---	REMOVAL	▨
---	WATERMAIN	---	FENCE	---	SWALE ELEVATION	(33.00)
---	SUBDRAIN	---	BACK OF CURB	---		
---	DITCH	---	ELEVATION	(33.00)		
---	EXISTING	---	LEGEND - PLAN	---	EXISTING	LEGEND - PLAN
---	NEW	---	LEGEND - PLAN	---	NEW	LEGEND - PLAN

LOCATION APPROVED UNDERGROUND STRUCTURES
SUPV. U/G STRUCTURES COMMITTEE DATE
NOTE:
LOCATION OF UNDERGROUND STRUCTURES AS SHOWN ARE BASED ON THE BEST INFORMATION AVAILABLE BUT NO GUARANTEE IS GIVEN THAT ALL EXISTING UTILITIES ARE SHOWN OR THAT THE GIVEN LOCATIONS ARE EXACT. CONFIRMATION OF EXISTENCE AND EXACT LOCATION OF ALL SERVICES MUST BE OBTAINED FROM THE INDIVIDUAL UTILITIES BEFORE PROCEEDING WITH CONSTRUCTION.

B.M. ELEV.	66-001 233.425m
NO.	ISSUED FOR TENDER
DATE	06.03.03
BY	GWM
DATE	06.01.08

Stantec Consulting Ltd.
905 Waverley Street, Winnipeg, Manitoba
Tel 204-489-5900 Fax 204-453-9012

DESIGNED BY	VMM, TAG	CHECKED BY	KAR
DRAWN BY	TAG, VMM	APPROVED BY	GWM
AUTHORIZED BY	R. FINGAS	DATE	06.03.03
R. FINGAS, P. ENG. BRIDGE PROJECTS ENGINEER			

ENGINEER'S SEAL
ORIGINAL SEALED BY
G.W. MOURANT
P. ENG.
06.03.03
CONSULTANT DRAWING NO.
I13703042-T25

THE CITY OF WINNIPEG
PUBLIC WORKS DEPARTMENT
ENGINEERING DIVISION

Winnipeg

KENASTON UNDERPASS PROJECT
KENASTON BOULEVARD RECONSTRUCTION

RAMP TO WILKES AVENUE
HORIZONTAL & VERTICAL ALIGNMENT
STA 1+425 TO STA 1+600

SHEET 14 OF 52
CAD FILE DRAWING NUMBER
ku-13-14-665.dwg
CITY DRAWING NUMBER
P-3258-185