

SEWER SERVICE INFORMATION			
ADDRESS	SIZE	℄ DIST	JUNCTION TIE
848 SPRUCE ST	-	-	-
RESIDENTIAL	-	12.52 S 1ST MH S OF DYSON	-
850 SPRUCE ST	-	-	-
RESIDENTIAL	-	5.53 S 1ST MH S OF DYSON	-
860 SPRUCE ST	-	-	-
RESIDENTIAL	-	77.70 S MH AT DYSON	-
862 SPRUCE ST	-	-	-
RESIDENTIAL	-	68.24 S MH AT DYSON	-
864 SPRUCE ST	-	-	-
RESIDENTIAL	-	58.55 S MH AT DYSON	-
865 SPRUCE ST	-	-	-
RESIDENTIAL	-	19.53 S 1ST MH S OF DYSON	-
866 SPRUCE ST	-	-	-
RESIDENTIAL	-	47.84 S MH AT DYSON	-
870 SPRUCE ST	-	-	-
RESIDENTIAL	-	38.38 S MH AT DYSON	-
871 SPRUCE ST	-	-	-
RESIDENTIAL	-	71.65 S MH AT DYSON	-
872 SPRUCE ST	-	-	-
RESIDENTIAL	-	28.37 S MH AT DYSON	-
875 SPRUCE ST	-	-	-
RESIDENTIAL	-	71.61 S MH AT DYSON	-
876 SPRUCE ST	-	-	-
RESIDENTIAL	-	18.65 S MH AT DYSON	-
877 SPRUCE ST	-	-	-
RESIDENTIAL	-	63.94 S MH AT DYSON	-
885 SPRUCE ST	-	-	-
RESIDENTIAL	-	56.65 S MH AT DYSON	-
889 SPRUCE ST	-	-	-
RESIDENTIAL	-	41.45 S MH AT DYSON	-
891 SPRUCE ST	-	-	-
RESIDENTIAL	-	31.73 S MH AT DYSON	-
895 SPRUCE ST	-	-	-
RESIDENTIAL	-	19.19 S MH AT DYSON	-
899 SPRUCE ST	-	-	-
RESIDENTIAL	-	10.64 S MH AT DYSON	-
900 SPRUCE ST	-	-	-
RESIDENTIAL	-	10.64 N MH AT DYSON	-
903 SPRUCE ST	-	-	-
RESIDENTIAL	-	4.37 N MH AT DYSON	-
905 SPRUCE ST	-	-	-
RESIDENTIAL	-	-	-

WATER SERVICE INFORMATION						
ADDRESS	SIZE(mm)	SIZE(mm) & TYPE (STREET)	SHORT & LONG MEASUREMENT (PROP)	CORP. LOCATION	REMARKS	
848 SPRUCE ST	20	20	3.21 NSL HSE	0.61 N OF S/C	-	-
RESIDENTIAL	COPPER	COPPER	59.85>NNL ST. MATTHEWS	-	-	-
850 SPRUCE ST	-	12	1.57 NSL HSE	-	-	-
RESIDENTIAL	-	LEAD	20.11>NNL ST. MATTHEWS	-	-	-
860 SPRUCE ST	12	20	2.69 NSL HSE	OPP S/C	-	-
RESIDENTIAL	COPPER	COPPER	79.58>NNL ST. MATTHEWS	-	-	-
862 SPRUCE ST	20	20	2.92 NSL HSE	OPP S/C	-	-
RESIDENTIAL	COPPER	LEAD	89.35>NNL ST. MATTHEWS	-	-	-
864 SPRUCE ST	20	20	3.81 NSL HSE	1.22 N OF S/C	-	-
RESIDENTIAL	LEAD	LEAD	45.34 SSSL DYSON	-	-	-
865 SPRUCE ST	20	20	2.30 NSL HSE	OPP S/C	-	-
RESIDENTIAL	COPPER	COPPER	56.28>NNL ST. MATTHEWS	-	-	-
866 SPRUCE ST	12	12	1.64 NSL HSE	0.3 N OF S/C	-	-
RESIDENTIAL	LEAD	LEAD	37.05 SSSL DYSON	-	-	-
870 SPRUCE ST	12	12	1.05 NSL HSE	3.35 N OF S/C	-	-
RESIDENTIAL	LEAD	LEAD	27.29 SSSL DYSON	-	-	-
875 SPRUCE ST	20	20	3.21 NSL HSE	0.3 S OF S/C	-	-
RESIDENTIAL	LEAD	LEAD	62.91 SSSL DYSON	-	-	-
876 SPRUCE ST	12	12	3.83 NSL HSE	0.3 N OF S/C	-	-
RESIDENTIAL	COPPER	LEAD	4.73 SSSL DYSON	-	-	-
877 SPRUCE ST	12	12	1.33 NSL HSE	0.3 N OF S/C	-	-
RESIDENTIAL	COPPER	LEAD	50.71 SSSL DYSON	-	-	-
885 SPRUCE ST	20	20	1.55 NSL HSE	OPP S/C	-	-
RESIDENTIAL	LEAD	LEAD	44.95 SSSL DYSON	-	-	-
889 SPRUCE ST	20	12	2.85 NSL HSE	0.76 N OF S/C	-	-
RESIDENTIAL	LEAD	LEAD	31.47 SSSL DYSON	-	-	-
891 SPRUCE ST	20	20	0.74 NSL HSE	0.61 N OF S/C	-	-
RESIDENTIAL	LEAD	LEAD	21.85 SSSL DYSON	-	-	-
895 SPRUCE ST	20	20	3.17 NSL HSE	OPP S/C	-	-
RESIDENTIAL	COPPER	COPPER	8.69 SSSL DYSON	-	-	-
899 SPRUCE ST	20	20	0.45 NSL HSE	0.45 N OF S/C	-	-
RESIDENTIAL	LEAD	LEAD	0.07 SSSL DYSON	-	-	-
903 SPRUCE ST	20	12	2.15 NSL HSE	OPP S/C	-	-
RESIDENTIAL	COPPER	COPPER	4.94 SSSL DYSON	-	-	-

NOTE: CHAINAGES SHOWN ARE ALONG W ℄ OF SPRUCE ST.

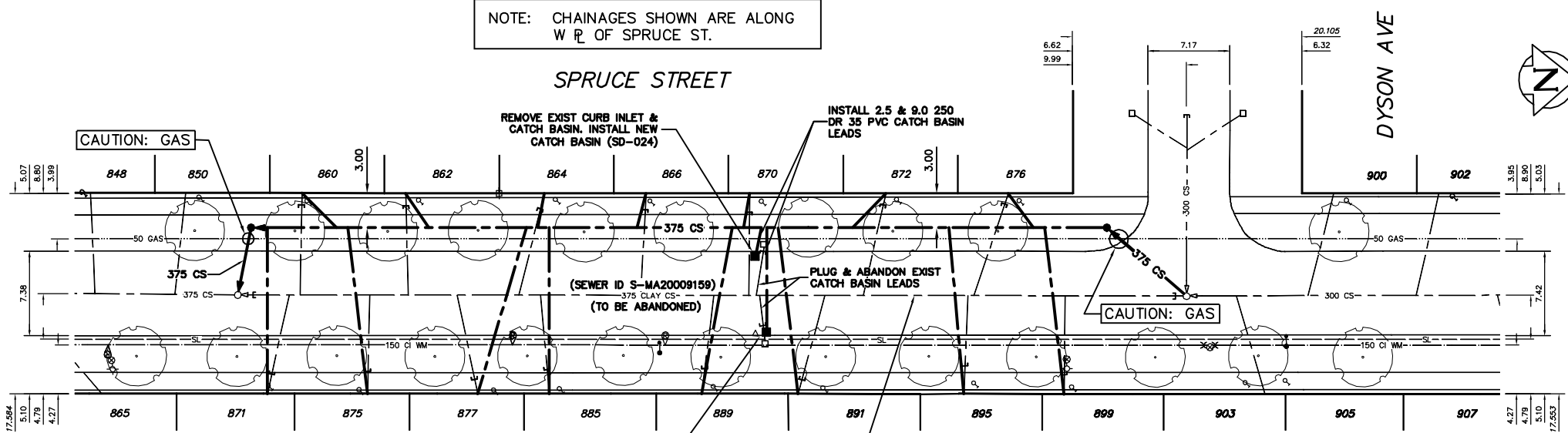

- CONSTRUCTION NOTES:
- ALL PIPE SHALL HAVE CLASS B - TYPE 2 BEDDING
 - RENEW SEWER BY TRENCHLESS METHODS.
 - CONFIRM THE LOCATION OF ALL SEWER SERVICES.
 - BACKFILL UNDER PAVEMENT, IN SIDEWALKS, & WITHIN 1.0 OF PAVEMENT TO BE CLASS 3.
 - BACKFILL IN BOULEVARD TO BE CLASS 5.
 - INSTALL CATCH BASIN LEADS AT MINIMUM 1.0% SLOPE OR AS DIRECTED BY THE CONTRACT ADMINISTRATOR.
 - RENEW SEWER SERVICES TO ℄.
 - SEWER SERVICE RISERS TO BE INSTALLED WHEN COMBINED SEWER EXCEEDS 4.25 m IN DEPTH.
 - INSTALL TEE, INCLUDING RISERS & PLUG, FOR FUTURE SERVICE CONNECTIONS OF EXISTING WYE'D SERVICES AS SHOWN ON DRAWINGS OR AS DIRECTED BY THE CONTRACT ADMINISTRATOR.

SEWER JUNCTION INFORMATION *			
SEWER ID S-MA20008452			
DISTANCE FROM MH ID S-MH20008390			
10.60	S	150#	EAST JN
11.40	S	150#	EAST JN
19.10	S	150#	WEST JN
19.90	S	150#	EAST JN
29.20	S	150#	WEST JX
32.40	S	150#	EAST JX
37.90	S	200#	EAST JX
38.60	S	200#	WEST JX
39.30	S	150#	WEST JX
48.80	S	150#	WEST JN
58.10	S	150#	EAST JN
59.60	S	150#	WEST JN
65.10	S	150#	EAST JX
69.80	S	150#	WEST JN
73.00	S	150#	EAST JX
79.00	S	150#	WEST JN
80.00	S	150#	EAST JX

* INFORMATION FROM SEWER VIDEO INSPECTION

WARNING

IF POWER EQUIPMENT OR EMPLOYEES ARE TO BE USED FOR EXCAVATION ON THIS PROJECT THE CONTRACTOR MUST:

- NOTIFY THE GAS COMPANY OF THE PROPOSED LOCATION OF EXCAVATION.
- TAKE PRECAUTION TO AVOID DAMAGE TO GAS COMPANY INSTALLATIONS.

SEE PROVINCIAL REGULATION 210/72 FOR DETAILS

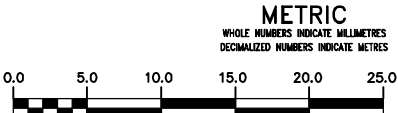

200 WM	WATERMAIN	200 WM	SL, HYDRO	150 WM	WATERMAIN	150 WM
⊕	HYDRANT	⊕	MTS	⊕	HYDRANT	⊕
⊕	VALVE	⊕	TRAFFIC SIGNALS	⊕	VALVE	⊕
525 LDS	LAND DRAINAGE SEWER	525 LDS	GAS	300 LDS	LAND DRAINAGE SEWER	300 LDS
375 WWS	WASTEWATER SEWER	375 WWS	SURVEY BAR	250 WWS	WASTEWATER SEWER	250 WWS
○	MANHOLE	○	FENCE	⊕	PROFILE	⊕
□	CATCH BASIN	□	POLE - HYDRO, MTS	⊕	GROUND ABOVE PIPE	⊕
▽	CURB INLET	▽	CURB STOP	⊕	⊕ DITCH (NORTH & WEST)	⊕
⊕	JUNCTIONS	⊕	GUY ANCHOR	⊕	⊕ DITCH (SOUTH & EAST)	⊕
⊕	CULVERT	⊕	LIGHT STANDARD	⊕	GUTTER (NORTH & WEST)	⊕
⊕	ANODE	⊕	TREE	⊕	GUTTER (SOUTH & EAST)	⊕
EXISTING	LEGEND-PLAN	PROPOSED	EXISTING	LEGEND-PLAN	PROPOSED	EXISTING

LOCATION APPROVED UNDERGROUND STRUCTURES

NO. REVISIONS: _____ DATE: _____ BY: _____

FIELD BOOK # _____

B.M. ELEV. _____

POSTED TO LBS: _____

DATE: _____

DESIGNED BY: SC CHECKED BY: TW

DRAWN BY: CJH APPROVED BY: KZ

HOR. SCALE: 1:250

VERTICAL: 1:50

RELEASED FOR CONSTRUCTION: _____

DATE: 2006 01 27

ENGINEER'S SEAL

ORIGINAL SIGNED BY S.R.J. COUNOYER 06/01/27

THE CITY OF WINNIPEG WATER AND WASTE DEPARTMENT

2005 COMBINED SEWER RENEWALS AND SEWER REPAIRS

SPRUCE STREET

MH AT DYSON AVENUE TO 1ST MH S OF DYSON AVENUE

SHEET 3 OF 14

CITY DRAWING NUMBER 05739

BID OPPORTUNITY: 25-2006

FILENAME: Spruce_N_FULL.dwg

PLOT DATE: 2006 01 27