

CHAINAGE ALONG WEST PROPERTY LINE OF ST. JEAN BAPTISTE ST.

RUE ST. JEAN BAPTISTE

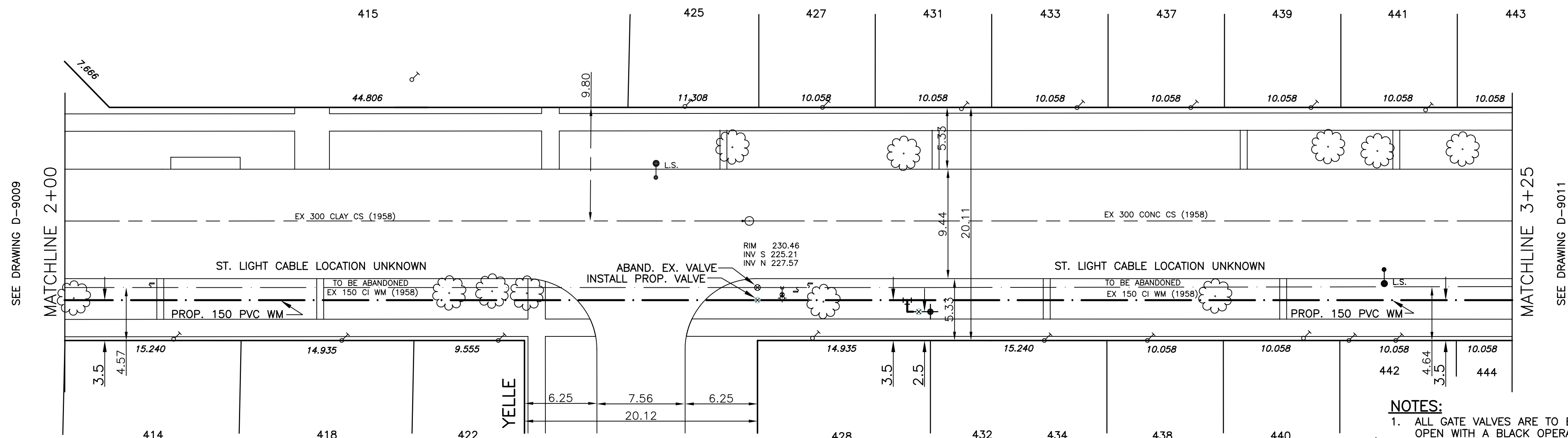
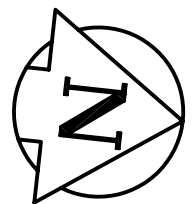

WATER SERVICE INFORMATION ADDRESS & NATURE OF SERVICE	SIZE(mm) & TYPE (STREET)	SIZE(mm) & TYPE (PROP)	SHORT & LONG MEASUREMENT	CORP LOCATION	REMARKS
414 St. Jean Baptiste St. Residential	19 Copper	19	1.8 RL CR OF HSE 87.2 S OF BERTRAND		
415 St. Jean Baptiste St. Residential	19 Copper	19	8.5 LR CR BLOCK		GRENOBLE MANOR, WEST SIDE BETWEEN DOLLARD & HAMEL
418 St. Jean Baptiste St. Residential	19 Copper	19	4.5 R/L 16.2 S/YELLE P/L		SEE PERMIT 34101 COT 3/84 N/YELLE-USED EX
422 St. Jean Baptiste St. Residential	19 Copper	19	.9 RL CR OF HSE 8.8 W OF YELLE		

- NOTES:**
- ALL GATE VALVES ARE TO BE COUNTER-CLOCKWISE TO OPEN WITH A BLACK OPERATING NUT.
 - WATERMAIN TO BE INSTALLED BY TRENCHLESS METHODS.
 - BACKFILL IS CLASS 5 WITHIN BOULEVARD AND CLASS 3 WHEN WITHIN PAVEMENT/SIDEWALK OR WHEN WITHIN 1.0m OF PAVEMENT OR SIDEWALK.
 - WATER SERVICES ARE 19mm COPPER UNLESS OTHERWISE NOTED.
 - MINIMUM COVER TO TOP OF WATERMAIN SHALL BE 2.4m.
 - LOCATION OF ALL SERVICES TO BE CONFIRMED IN FIELD.
 - EXPOSE EXISTING WATERMAIN TO CONFIRM DEPTH PRIOR TO CONSTRUCTION.
 - ALL LEAD SERVICES TO BE RENEWED.
 - SERVICES TO BE RENEWED SHALL BE REPLACED FROM WATERMAIN TO PROPERTY LINE. ALL OTHERS TO BE RECONNECTED

APEGM
Certificate of Authorization
SEG Engineering Inc.
No. 252 Expiry: April 30, 2007

METRIC
WHOLE NUMBERS INDICATE MILLIMETRES
DECIMALIZED NUMBERS INDICATE METRES

BENCHMARK:
BM 034-011
ELEV. 231.413

EXISTING	LEGEND - PLAN	PROPOSED	EXISTING	LEGEND - PLAN	PROPOSED	EXISTING	LEGEND - PROFILE	PROPOSED
---	WATERMAIN	---	---	HYDRO	---	---	WATERMAIN	---
---	HYDRANT VALVE	---	---	M.T.S.	---	---	VALVE	---
---	LAND DRAINAGE SEWER	---	---	CONCRETE	---	---	LAND DRAINAGE SEWER	---
---	WASTE WATER SEWER	---	---	ASPHALT	---	---	WASTE WATER SEWER	---
---	MANHOLE	---	---	PROPERTY LINE	---	---	JUNCTIONS	---
---	CATCH BASIN	---	---	SURVEY BAR	---	---	CULVERT	---
---	CURB INLET	---	---	CURB STOP	---	---		
---	TRAFFIC SIGNAL	---	---	C.B. LEAD	---	---		
---	GAS	---	---	SIDEWALK	---	---		

LOCATION APPROVED

SUPV.	U/G	STRUCTURES	DATE

NOTE:
LOCATION OF UNDERGROUND STRUCTURES AS SHOWN ARE BASED ON THE BEST INFORMATION AVAILABLE BUT NO GUARANTEE IS GIVEN THAT ALL EXISTING UTILITIES ARE SHOWN OR THAT THE GIVEN LOCATIONS ARE EXACT. CONFIRMATION OF EXISTENCE AND EXACT LOCATION OF ALL SERVICES MUST BE OBTAINED FROM THE INDIVIDUAL UTILITIES BEFORE PROCEEDING WITH CONSTRUCTION.

SEG ENGINEERING INC.
200 TACHE AVENUE
WINNIPEG, MANITOBA
(204)-233-2113

DESIGNED BY: DJ
CHECKED BY: SM
DRAWN BY: RH
APPROVED BY: IMck

HOR. SCALE: 1:250
VERT. SCALE: 1:50

RELEASED FOR ORIGINAL CONSTRUCTION
SIGNED BY: K. ZUREK P. ENG
DATE: May 12, 2006

ENGINEERS SEAL
I. G. McKINNON
REGISTERED PROFESSIONAL ENGINEER

THE CITY OF WINNIPEG
Winnipeg

2006 CAPITAL WORKS
WATERMAIN RENEWALS - CONTRACT 21
RUE ST. JEAN BAPTISTE
DOLLARD BOULEVARD
TO 65 M NORTH OF RUE YELLE

CITY DRAWING NO.
SHEET 2 OF 4
D-9010