

HAMEL AVE CHAINAGE ALONG NORTH PROPERTY LINE OF HAMEL AV.

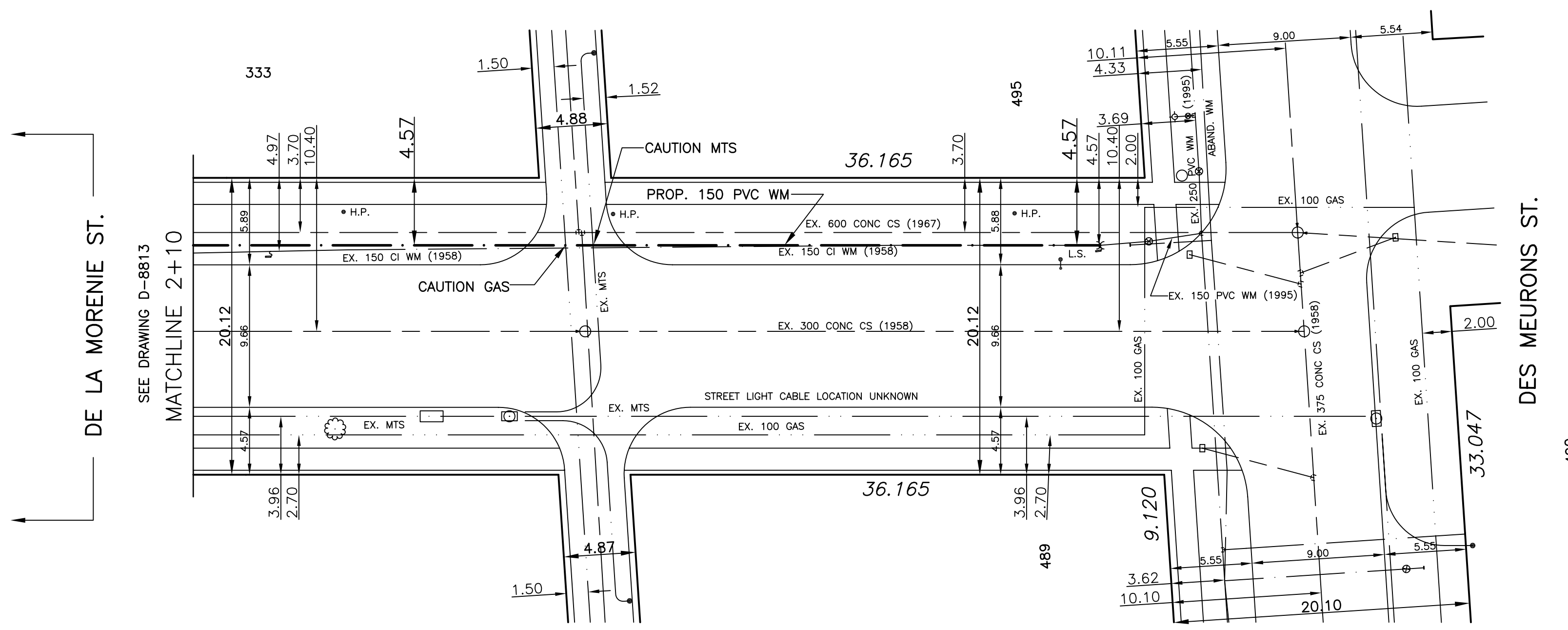
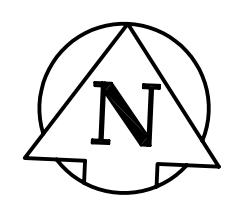

WATER SERVICE INFORMATION

ADDRESS	SIZE(mm) & TYPE	SIZE(mm) & TYPE	SHORT & LONG MEASUREMENT	CORP LOCATION	REMARKS
333 HAMEL AVE RESIDENTIAL	19 COPPER	19 COPPER	6.7 R/L		
489 DES MEURONS ST RESIDENTIAL	19 COPPER	19 COPPER	6.1 R/LHL 9.8 W OF WL DES MEURONS	6.6 N/HYD T	
490 DES MEURONS ST COMMERCIAL	50 COPPER	50 COPPER	7.9 N/S	9.2 SSL HAMEL	150mm MAIN VALVE @ TEE AND 150mm MAIN VALVE @ PL
495 DES MEURONS ST RESIDENTIAL	19 COPPER	19 COPPER	3.8 L/RHL		

METRIC  
WHOLE NUMBERS INDICATE MILLIMETRES  
DECIMALIZED NUMBERS INDICATE METRES

**APEGM**  
Certificate of Authorization  
SEG Engineering Inc.  
No. 1432 Expiry: April 30, 2006

- NOTES:**
- ALL GATE VALVES ARE TO BE COUNTER-CLOCKWISE TO OPEN WITH A BLACK OPERATING NUT.
  - WATERMAIN TO BE INSTALLED BY TRENCHLESS METHODS.
  - BACKFILL IS CLASS 5 WITHIN BOULEVARD AND CLASS 3 WHEN WITHIN PAVEMENT/SIDEWALK OR WHEN WITHIN 1.0m OF PAVEMENT OR SIDEWALK.
  - WATER SERVICES ARE 19mm UNLESS OTHERWISE NOTED.
  - MINIMUM COVER TO TOP OF WATERMAIN SHALL BE 2.4m.
  - LOCATION OF ALL SERVICES TO BE CONFIRMED IN FIELD.
  - EXPOSE EXISTING WATERMAIN TO CONFIRM DEPTH PRIOR TO CONSTRUCTION.
  - ALL LEAD SERVICES TO BE RENEWED.
  - SERVICES TO BE RENEWED SHALL BE REPLACED FROM WATERMAIN TO PROPERTY LINE. ALL OTHERS TO BE RECONNECTED.

EXISTING	LEGEND - PLAN	PROPOSED	EXISTING	LEGEND - PLAN	PROPOSED	EXISTING	LEGEND - PROFILE	PROPOSED
---	WATERMAIN	---	---	HYDRO	---	---	CENTER LINE	---
---	HYDRANT	---	---	M.T.S.	---	---	NORTH GUTTER LINE	---
---	VALVE	---	---	CONCRETE	---	---	SOUTH GUTTER LINE	---
---	LAND DRAINAGE SEWER	---	---	ASPHALT	---	---	WATERMAIN	---
---	WASTE WATER SEWER	---	---	PROPERTY LINE	---	---	VALVE	---
---	MANHOLE	---	---	SURVEY BAR	---	---	LAND DRAINAGE SEWER	---
---	CATCH BASIN	---	---	C.B. LEAD	---	---	WASTE WATER SEWER	---
---	CURB INLET	---	---	SIDEWALK	---	---	JUNCTIONS	---
---	TRAFFIC SIGNAL	---	---	SIDEWALK RAMP	---	---	CULVERT	---
---	MTS	---	---	ELEVATIONS	---	---	ANODE	---
---	GAS	---	---	ELEVATIONS	---	---	PLUG	---

**LOCATION APPROVED UNDERGROUND STRUCTURES**  
ORIGINALLY SIGNED BY  
D. A. Soedal JULY 19, 2005  
SUPV. U/G STRUCTURES COMMITTEE DATE

**NOTE:**  
LOCATION OF UNDERGROUND STRUCTURES AS SHOWN ARE BASED ON THE BEST INFORMATION AVAILABLE BUT NO GUARANTEE IS GIVEN THAT ALL EXISTING UTILITIES ARE SHOWN OR THAT THE GIVEN LOCATIONS ARE EXACT. CONFIRMATION OF EXISTENCE AND EXACT LOCATION OF ALL SERVICES MUST BE OBTAINED FROM THE INDIVIDUAL UTILITIES BEFORE PROCEEDING WITH CONSTRUCTION.

B.M. ELEV. CWM: 34-011 231.413 m

**SEG ENGINEERING INC.**  
200 TACHE AVENUE  
WINNIPEG, MANITOBA  
(204)-233-2113

DESIGNED BY: DJ  
CHECKED BY: SM  
DRAWN BY: RH  
APPROVED BY: IMck

HOR. SCALE: 1:250  
VERT. SCALE: 1:50

RELEASED FOR ORIGINAL CONSTRUCTION SIGNED BY: K. ZUREK P. ENG  
DATE: APRIL 11, 2006

1 UPDATED FOR 269-2006 APR 06 DJ  
NO. REVISIONS DATE BY



**THE CITY OF WINNIPEG**  
WATER AND WASTE DEPARTMENT

2006 CAPITAL WORKS  
WATERMAIN RENEWALS  
HAMEL AVENUE  
DE LA MORENIE STREET  
TO DES MEURONS STREET

CITY DRAWING NO.  
SHEET 2 OF 2  
D-8814

CONSULTANT DRAWING NO. 069-021-04