

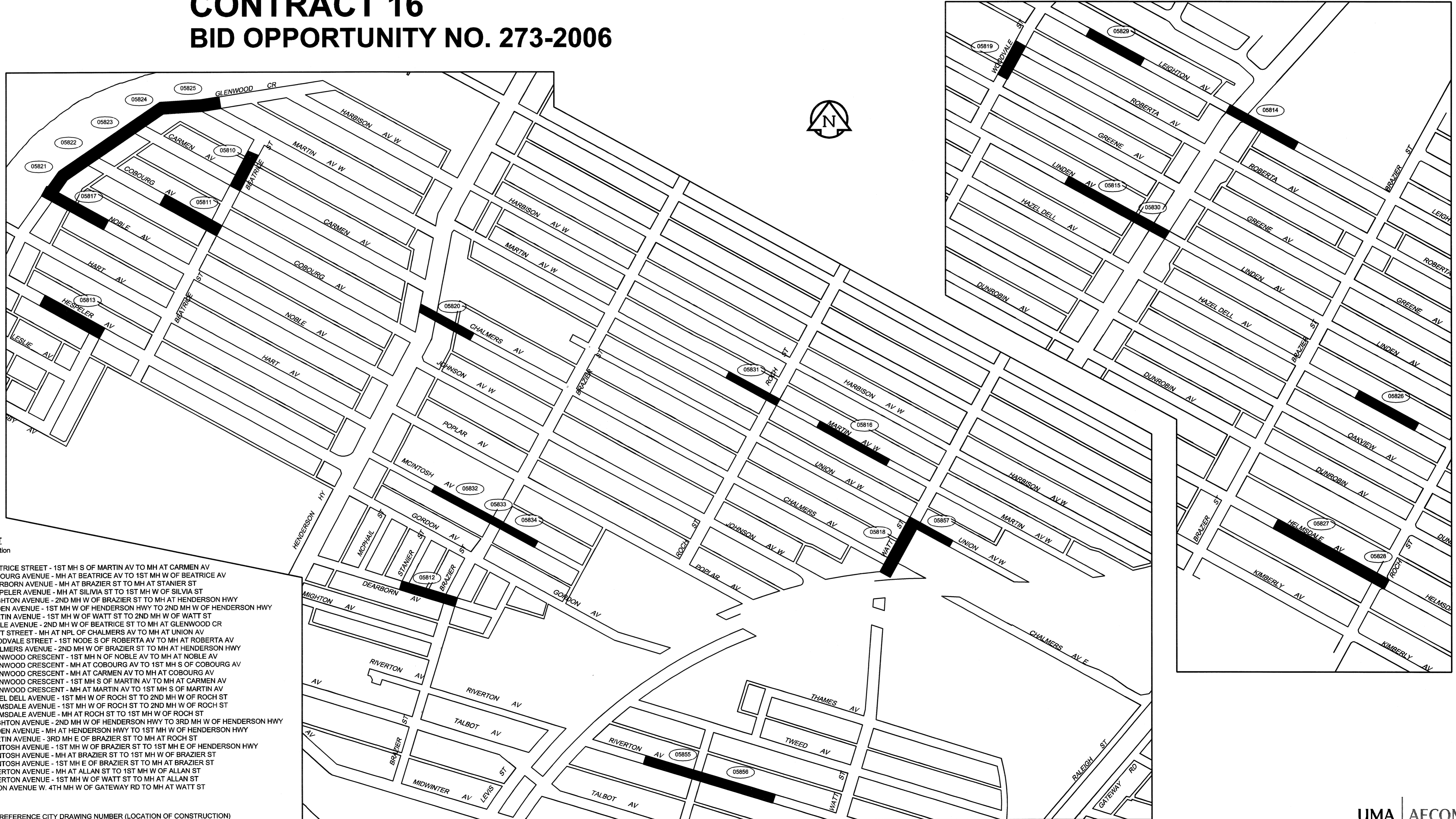

THE CITY OF WINNIPEG WATER AND WASTE DEPARTMENT

2006 COMBINED SEWER RENEWALS BY CIPP FULL SEGMENT LINING AND CIPP INTERNAL POINT REPAIRS CONTRACT 16 BID OPPORTUNITY NO. 273-2006



DRAWING LIST

City Dwg. No.	Location
05810	BEATRICE STREET - 1ST MH S OF MARTIN AV TO MH AT CARMEN AV
05811	COBOURG AVENUE - MH AT BEATRICE AV TO 1ST MH W OF BEATRICE AV
05812	DEARBORN AVENUE - MH AT BRAZIER ST TO MH AT STANIER ST
05813	HESPELER AVENUE - MH AT SILVIA ST TO 1ST MH W OF SILVIA ST
05814	LEIGHTON AVENUE - 2ND MH W OF BRAZIER ST TO MH AT HENDERSON HWY
05815	LINDEN AVENUE - 1ST MH W OF HENDERSON HWY TO 2ND MH W OF HENDERSON HWY
05816	MARTIN AVENUE - 1ST MH W OF WATT ST TO 2ND MH W OF WATT ST
05817	NOBLE AVENUE - 2ND MH W OF BEATRICE ST TO MH AT GLENWOOD CR
05818	WATT STREET - MH AT NPL OF CHALMERS AV TO MH AT UNION AV
05819	WOODVALE STREET - 1ST NODE S OF ROBERTA AV TO MH AT ROBERTA AV
05820	CHALMERS AVENUE - 2ND MH W OF BRAZIER ST TO MH AT HENDERSON HWY
05821	GLENWOOD CRESCENT - 1ST MH N OF NOBLE AV TO MH AT NOBLE AV
05822	GLENWOOD CRESCENT - MH AT COBOURG AV TO 1ST MH S OF COBOURG AV
05823	GLENWOOD CRESCENT - MH AT CARMEN AV TO MH AT COBOURG AV
05824	GLENWOOD CRESCENT - 1ST MH S OF MARTIN AV TO MH AT CARMEN AV
05825	GLENWOOD CRESCENT - MH AT MARTIN AV TO 1ST MH S OF MARTIN AV
05826	HAZEL DELL AVENUE - 1ST MH W OF ROCH ST TO 2ND MH W OF ROCH ST
05827	HELMSDALE AVENUE - 1ST MH W OF ROCH ST TO 2ND MH W OF ROCH ST
05828	HELMSDALE AVENUE - MH AT ROCH ST TO 1ST MH W OF ROCH ST
05829	LEIGHTON AVENUE - 2ND MH W OF HENDERSON HWY TO 3RD MH W OF HENDERSON HWY
05830	LINDEN AVENUE - MH AT HENDERSON HWY TO 1ST MH W OF HENDERSON HWY
05831	MARTIN AVENUE - 3RD MH E OF BRAZIER ST TO MH AT ROCH ST
05832	McINTOSH AVENUE - 1ST MH W OF BRAZIER ST TO 1ST MH E OF HENDERSON HWY
05833	McINTOSH AVENUE - MH AT BRAZIER ST TO 1ST MH W OF BRAZIER ST
05834	McINTOSH AVENUE - 1ST MH E OF BRAZIER ST TO MH AT BRAZIER ST
05855	RIVERTON AVENUE - MH AT ALLAN ST TO 1ST MH W OF ALLAN ST
05856	RIVERTON AVENUE - 1ST MH W OF WATT ST TO MH AT ALLAN ST
05857	UNION AVENUE W. 4TH MH W OF GATEWAY RD TO MH AT WATT ST

LEGEND

- 05810 REFERENCE CITY DRAWING NUMBER (LOCATION OF CONSTRUCTION)
- LIMITS OF CONTRACT 16 - BID OPPORTUNITY NO. 273-2006