

A1 SIZE 23.4" x 33.1" (594mm x 841mm)

PLOT: 06/06/20 11:43:35 AM

UMA FILE NAME: 0265-384-00\_01-CT1003\_RX.dwg Saved By: ddszpd

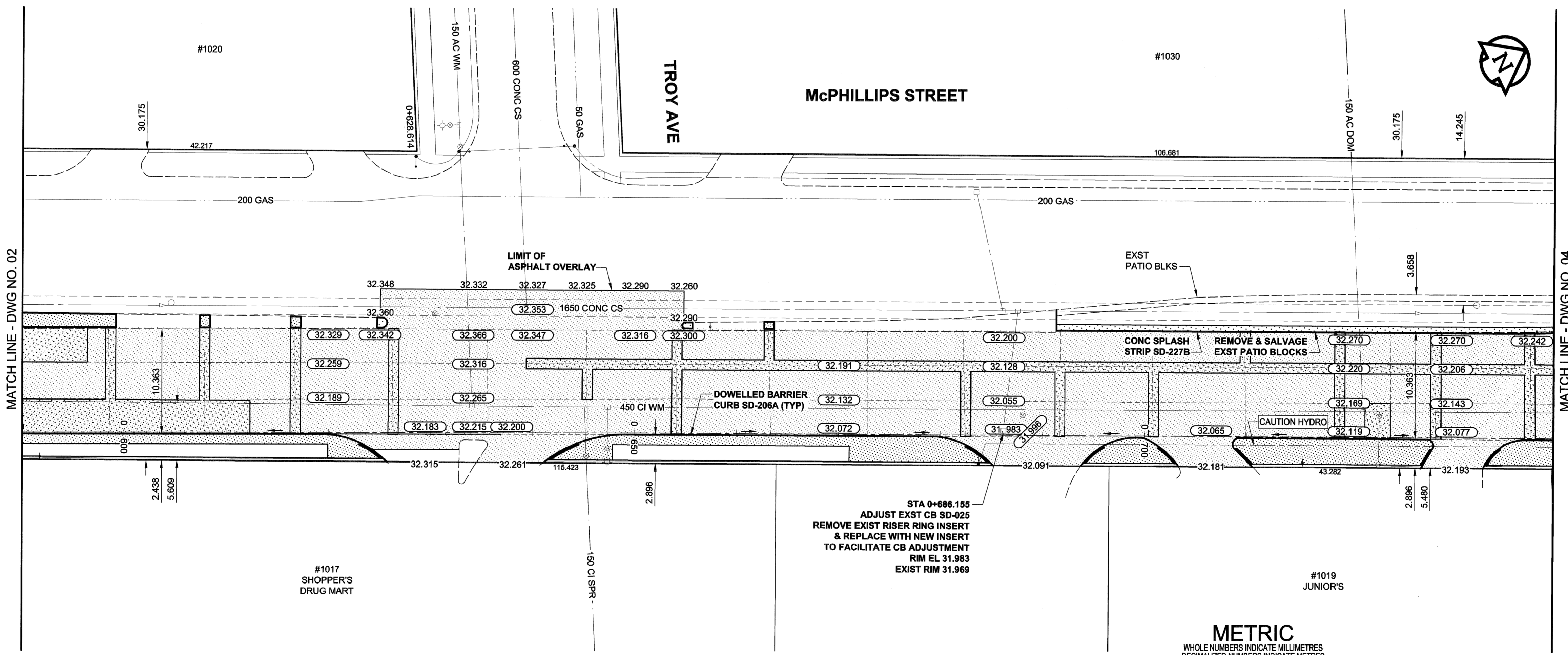
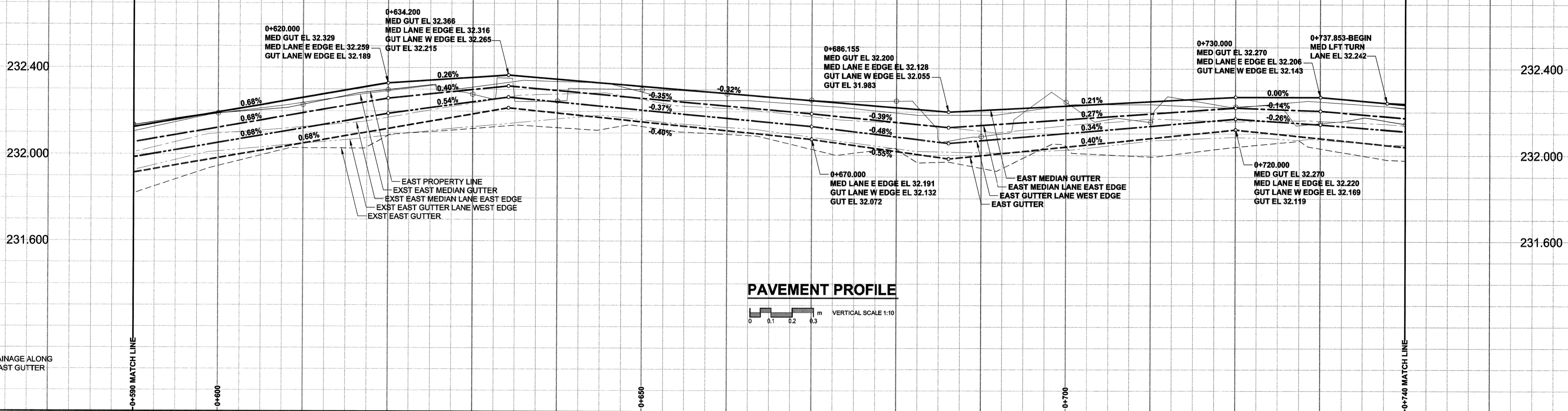

- NOTES**
1. ADJUST MH AND CB RIMS TO NEW GRADES.
  2. LAMP STANDARDS, HYDRO POLES, AND ANCHORS MAY REQUIRE TEMPORARY SUPPORT/REMOVAL OR REPLACEMENT AT THE CONTRACTOR'S EXPENSE.
  3. CONTRACTOR SHALL TAKE PRECAUTIONARY STEPS TO AVOID DAMAGE FROM CONSTRUCTION ACTIVITIES TO EXISTING BOULEVARD TREES WITHIN THE LIMITS OF CONSTRUCTION AS OUTLINED IN THE SPECIFICATIONS.
  4. CONTRACTOR SHALL REGRADE EXST. PRIVATE SIDEWALKS. LIMITS TO BE DETERMINED.
  5. THE LOCATION OF ALL SERVICES TO BE CONFIRMED IN THE FIELD BY THE CONTRACTOR.
  6. ADD 200.000m TO ABBREVIATED ELEVATIONS TO OBTAIN GEODETIC ELEVATIONS.

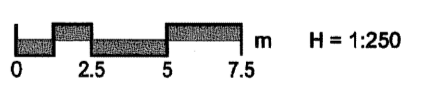

**APCON**  
Certificate of Authorization  
UMA Engineering Ltd.  
No. 256 Expiry: April 30, 2007

BID OPPORTUNITY NO. 298-2006

NATURAL GAS	○	MANHOLE	●
COMMUNICATION	□	CATCH BASIN / CATCH PIT	■
HYDRO	△	C & G INLET WITH BOX	■
CATV	○	TREE	○
TRAFFIC SIGNALS	TH-12	TEST HOLE	○
LAND DRAINAGE SEWER	—	PROPERTY LINE	—
SANITARY/COMBINED SEWER	—	SURVEY BAR	—
CATCHBASIN LEAD	—	FENCE	—
WATERMAIN	—	BOC/EOPAVT	—
SUBDRAIN	—	ELEVATION	(33.100)
DITCH	—		
EXISTING	LEGEND - PLAN	NEW	EXISTING
LEGEND - PLAN	NEW	EXISTING	LEGEND - PLAN
NEW	LEGEND - PLAN	NEW	EXISTING
LEGEND - PLAN	NEW	EXISTING	LEGEND - PLAN
NEW	LEGEND - PLAN	NEW	EXISTING

**LOCATION APPROVED UNDERGROUND STRUCTURES**

DATE

NOTE:  
LOCATION OF UNDERGROUND STRUCTURES AS SHOWN ARE BASED ON THE BEST INFORMATION AVAILABLE. BUT NO GUARANTEE IS GIVEN THAT ALL EXISTING UTILITIES ARE SHOWN OR THAT THE GIVEN LOCATIONS ARE EXACT. CONFIRMATION OF EXISTENCE AND EXACT LOCATION OF ALL SERVICES MUST BE OBTAINED FROM THE INDIVIDUAL UTILITIES BEFORE PROCEEDING WITH CONSTRUCTION.

BM 24-036	ELEV 232.215m		
NO.	ISSUED FOR CONSTRUCTION	06/06/20	DID
NO.	REVISIONS	YYMMDD	BY

DESIGNED BY	WRJ	CHECKED BY	RPH
DRAWN BY	DID, KLC	APPROVED BY	BWB
HOR. SCALE	1:250	RELEASED FOR CONSTRUCTION	Steve Deane
VERT. SCALE	AS SHOWN	DATE	JUNE 20/2006
DATE	06/06/20		

PROFESSIONAL'S SEAL

PROVINCE OF MANITOBA

R. P. BRUCE

REGISTERED PROFESSIONAL ENGINEER

CONSULTANT DRAWING NO. 0265-384-00\_01-CT1003\_RX.dwg

**THE CITY OF WINNIPEG**  
PUBLIC WORKS DEPARTMENT  
ENGINEERING DIVISION

**McPhillips Street Northbound**  
COLLEGE AVENUE TO  
MAPLEGLN DRIVE  
STREET RENEWAL  
HORIZONTAL AND VERTICAL ALIGNMENT  
FROM STA 0+590 TO STA 0+740

CITY DRAWING NUMBER P-3268-03  
SHEET 3 OF 11  
DRAWING No. 03  
REV 0