

PAVEMENT PROFILE

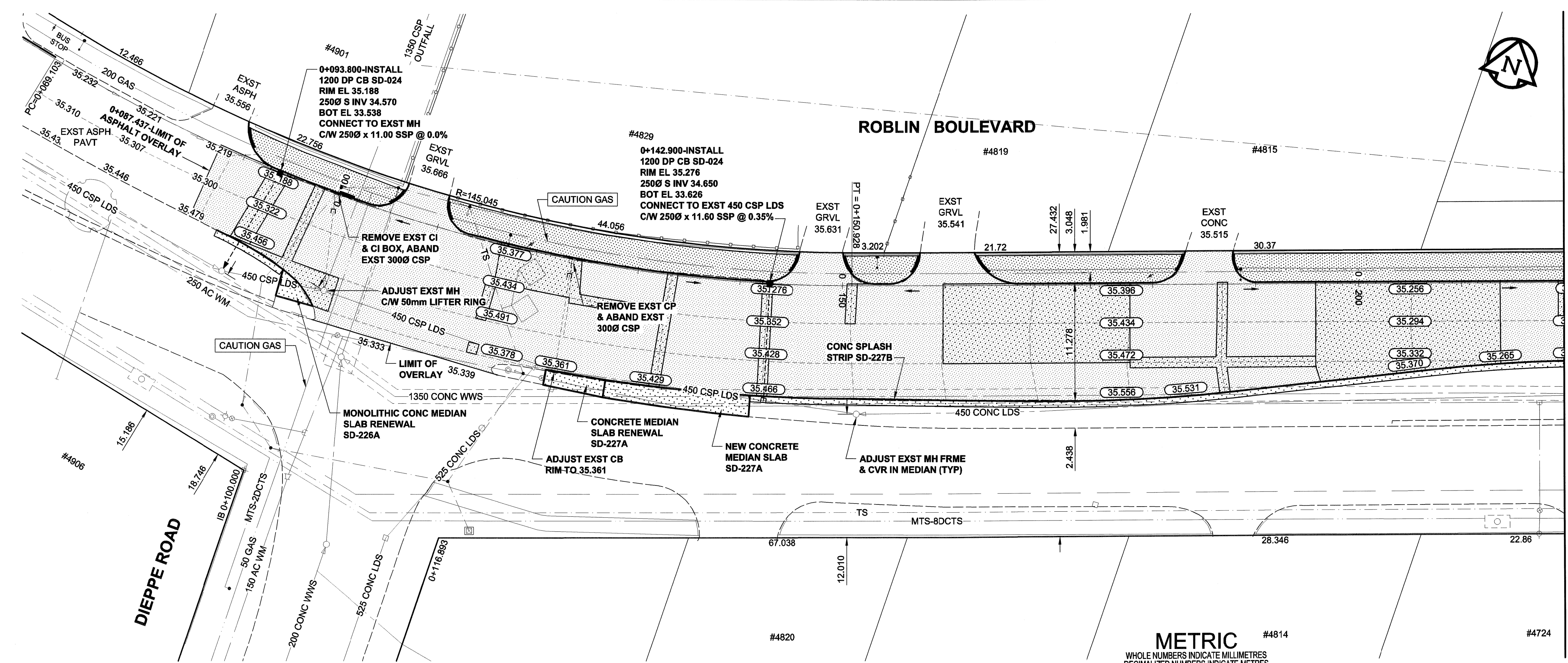

- NOTES**
1. ADJUST MH AND CB RIMS TO NEW GRADES.
 2. LAMP STANDARDS, HYDRO POLES, AND ANCHORS MAY REQUIRE TEMPORARY SUPPORT/REMOVAL OR REPLACEMENT AT THE CONTRACTOR'S EXPENSE.
 3. CONTRACTOR SHALL TAKE PRECAUTIONARY STEPS TO AVOID DAMAGE FROM CONSTRUCTION ACTIVITIES TO EXISTING BOULEVARD TREES WITHIN THE LIMITS OF CONSTRUCTION AS OUTLINED IN THE SPECIFICATIONS.
 4. CONTRACTOR SHALL REGRADE EXST. PRIVATE SIDEWALKS. LIMITS TO BE DETERMINED.
 5. THE LOCATION OF ALL SERVICES TO BE CONFIRMED IN THE FIELD BY THE CONTRACTOR.
 6. ADD 200.000m TO ABBREVIATED ELEVATIONS TO OBTAIN GEODETIC ELEVATIONS.
 7. THE AVERAGE ASPHALT THICKNESS TO BE PLACED ON THIS PROJECT IS 80mm (2-LIFTS).

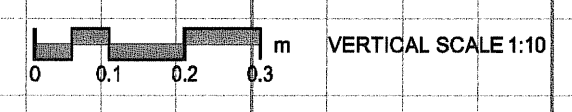
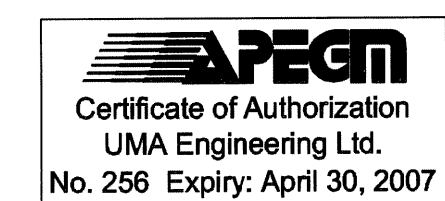
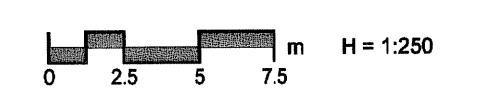

BID OPPORTUNITY NO. 298-2006

EXISTING	LEGEND - PLAN	NEW	EXISTING	LEGEND - PLAN	NEW	EXISTING	LEGEND - PLAN	NEW
---	NATURAL GAS	○	●	MANHOLE	---	CONCRETE PAVEMENT	---	LOCATION APPROVED
---	COMMUNICATION	□	■	CATCH BASIN / CATCH PIT	---	ASPHALT PAVEMENT	---	UNDERGROUND STRUCTURES
---	HYDRO	△	□	C & G INLET WITH BOX	---	CONC. SIDEWALK/MEDIAN	---	BM 49-015
---	CATV	○	○	TREE	---	PAVING STONE	---	ELEV 238.012m
---	TRAFFIC SIGNALS	⬇	⬇	TEST HOLE	---	GRAVEL	---	
---	LAND DRAINAGE SEWER	---	---	PROPERTY LINE	---	CURB RAMP	---	
---	SANITARY/COMBINED SEWER	---	---	SURVEY BAR	---	PLANING	---	
---	CATCH-BASIN LEAD	---	---	FENCE	---		---	
---	WATERMAIN	---	---	BOC/EOPAVT	---		---	
---	SUBDRAIN	---	---	ELEVATION	---		---	
---	DITCH	---	---		---		---	

LOCATION APPROVED
UNDERGROUND STRUCTURES

SUPR. U/G STRUCTURES DATE COMMITTEE

NOTE:
LOCATION OF UNDERGROUND STRUCTURES AS SHOWN ARE BASED ON THE BEST INFORMATION AVAILABLE. BUT NO GUARANTEE IS GIVEN THAT ALL EXISTING UTILITIES ARE SHOWN OR THAT THE GIVEN LOCATIONS ARE EXACT. CONFIRMATION OF EXISTENCE AND EXACT LOCATION OF ALL SERVICES MUST BE OBTAINED FROM THE INDIVIDUAL UTILITIES BEFORE PROCEEDING WITH CONSTRUCTION.

0	ISSUED FOR CONSTRUCTION	06/06/20	DID
NO.	REVISIONS	YY/MM/DD	BY

UMA | AECOM

© 2006 UMA ENGINEERING LTD. ALL RIGHTS RESERVED.

DESIGNED BY	RPB	CHECKED BY	WRS
DRAWN BY	DID	APPROVED BY	Burb
HOR. SCALE	AS SHOWN	RELEASED FOR CONSTRUCTION	Steve Pearce
VERT. SCALE	1:250	DATE	JUNE 20/2006

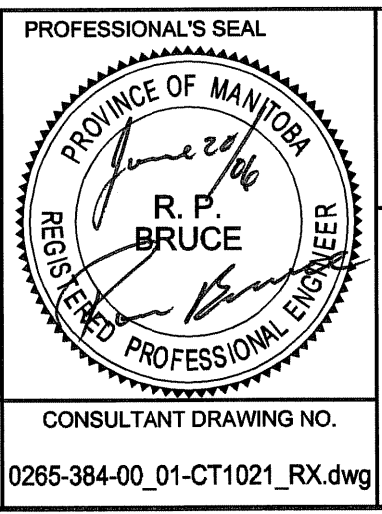

THE CITY OF WINNIPEG
PUBLIC WORKS DEPARTMENT
ENGINEERING DIVISION

**ROBLIN BOULEVARD/GRANT AVENUE
DIEPPE ROAD TO FAIRMONT ROAD
STREET RENEWAL**
HORIZONTAL AND VERTICAL ALIGNMENT
FROM DIEPPE ROAD TO STA 0+220

CITY DRAWING NUMBER	P-3269-02
SHEET	2 OF 6
DRAWING No.	02
REV	0