

**NOTE:**  
STATIONING ALONG NORTH BACK  
OF CURB OF NESS AVENUE

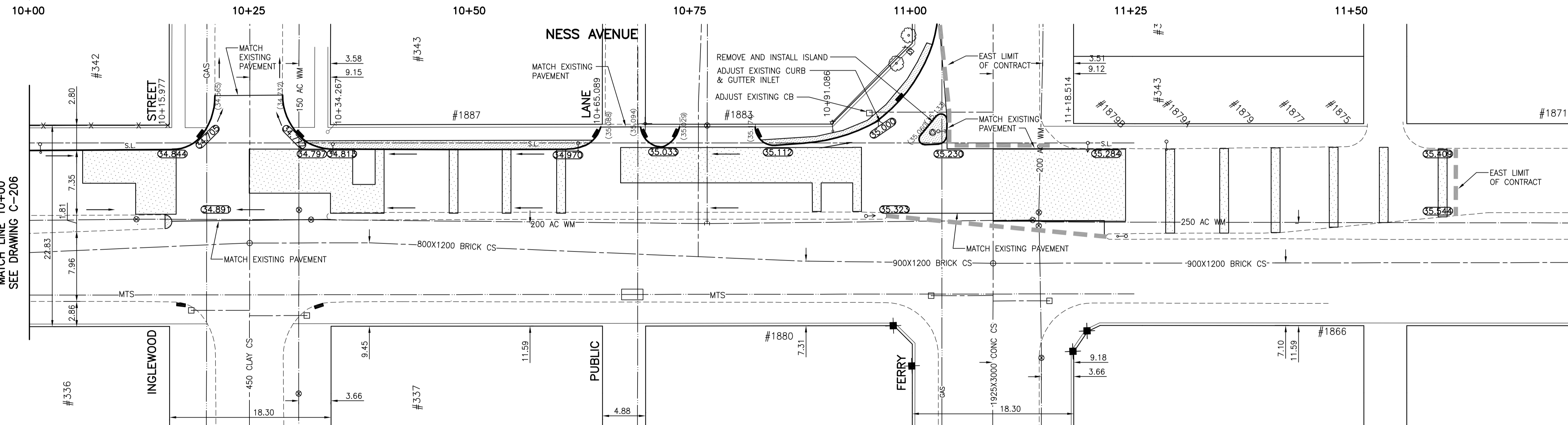
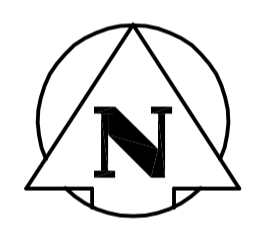

**WARNING**

IF POWER EQUIPMENT OR EXPLOSIVES ARE TO BE USED FOR EXCAVATION ON THIS PROJECT THE CONTRACTOR MUST:  
1) NOTIFY THE GAS COMPANY OF THE PROPOSED LOCATION OF EXCAVATION.  
2) TAKE PRECAUTION TO AVOID DAMAGE TO GAS COMPANY INSTALLATIONS.  
SEE PROVINCIAL REGULATION 140/92 FOR DETAILS

**METRIC**

WHOLE NUMBERS INDICATE MILLIMETRES  
DECIMALIZED NUMBERS INDICATE METRES

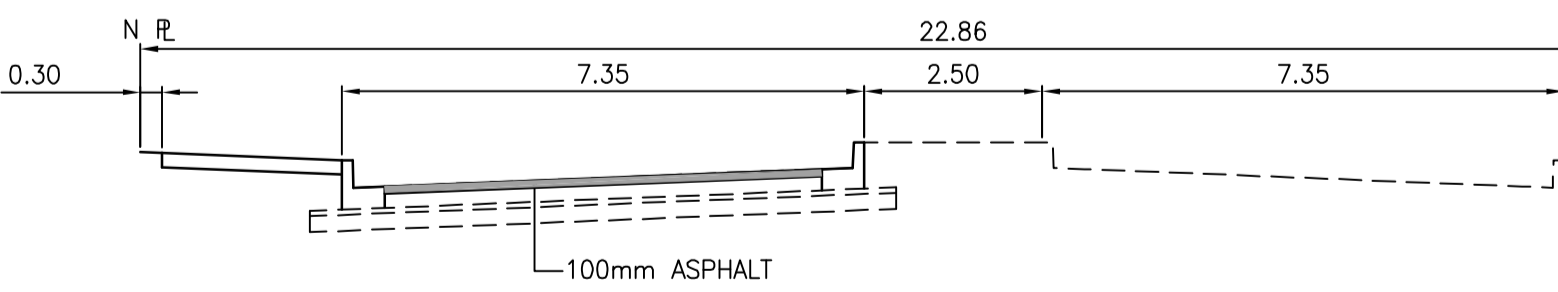

TYPICAL CROSS SECTION

BENCH MARK: 83R621 - N.E. COR. NESS AVE. & WOODLAWN ST., TBLT. ON TOP OF 0.05m DIA. x 2.4m IRON PIPE, ON N.L. OF NESS AVE. & 1.2m W. OF E.L. OF WOODLAWN ST.

**PRELIMINARY**  
NOT FOR CONSTRUCTION

**APEGM**  
Certificate of Authorization  
Stantec Consulting Ltd.  
No. 1301 Expiry: April 30, 2007

EXISTING	LEGEND-PLAN	PROPOSED	EXISTING	LEGEND-PLAN	PROPOSED	EXISTING	LEGEND-PROFILE	PROPOSED
150 WM	WATERMAIN	150 WM	HYDRO	HYDRO	150 WM	WATERMAIN	150 WM	WATERMAIN
HYDRANT	HYDRANT	HYDRANT	M.T.S.	M.T.S.	HYDRANT, VALVE	HYDRANT, VALVE	HYDRANT, VALVE	HYDRANT, VALVE
VALVE	VALVE	VALVE	CONCRETE	CONCRETE	LAND DRAINAGE SEWER	LAND DRAINAGE SEWER	LAND DRAINAGE SEWER	LAND DRAINAGE SEWER
300 LDS	LAND DRAINAGE SEWER	300 LDS	ASPHALT	ASPHALT	250 WWS	WASTE WATER SEWER	250 WWS	WASTE WATER SEWER
250 WWS	WASTE WATER SEWER	250 WWS	SIDEWALK	SIDEWALK	C PROFILE	C PROFILE	C PROFILE	C PROFILE
MANHOLE	MANHOLE	MANHOLE	PROPERTY LINE	PROPERTY LINE	NORTH OR WEST GUTTER	NORTH OR WEST GUTTER	NORTH OR WEST GUTTER	NORTH OR WEST GUTTER
CATCH BASIN	CATCH BASIN	CATCH BASIN	SURVEY BAR	SURVEY BAR	SOUTH OR EAST GUTTER	SOUTH OR EAST GUTTER	SOUTH OR EAST GUTTER	SOUTH OR EAST GUTTER
CURB INLET	CURB INLET	CURB INLET	DITCH	DITCH	NORTH OR WEST P	NORTH OR WEST P	NORTH OR WEST P	NORTH OR WEST P
JUNCTIONS	JUNCTIONS	JUNCTIONS	ELEVATION	ELEVATION	SOUTH OR EAST P	SOUTH OR EAST P	SOUTH OR EAST P	SOUTH OR EAST P
CULVERT	CULVERT	CULVERT	SIDEWALK RAMP	SIDEWALK RAMP	NORTH OR WEST DITCH	NORTH OR WEST DITCH	NORTH OR WEST DITCH	NORTH OR WEST DITCH
GAS	GAS	GAS			SOUTH OR EAST DITCH	SOUTH OR EAST DITCH	SOUTH OR EAST DITCH	SOUTH OR EAST DITCH

**LOCATION APPROVED UNDERGROUND STRUCTURES**

SUPV. U/G STRUCTURES COMMITTEE DATE  
NOTE: LOCATION OF UNDERGROUND STRUCTURES AS SHOWN ARE BASED ON THE BEST INFORMATION AVAILABLE BUT NO GUARANTEE IS GIVEN THAT ALL EXISTING UTILITIES ARE SHOWN OR THAT THE GIVEN LOCATIONS ARE EXACT. CONFIRMATION OF EXISTENCE AND EXACT LOCATION OF ALL SERVICES MUST BE OBTAINED FROM THE INDIVIDUAL UTILITIES BEFORE PROCEEDING WITH CONSTRUCTION.

NO.	REVISIONS	DATE	BY
A	ISSUED FOR CLIENT REVIEW	06.06.07	A.M.

**Stantec Consulting Ltd.**  
905 Waverley Street, Winnipeg, Manitoba  
Tel 204-489-5900 Fax 204-453-9012

DESIGNED BY: A.M.	CHECKED BY: V.M.M.
DRAWN BY: T.G.	APPROVED BY: A.M.

HOR. SCALE: 1:250  
VERTICAL: 1:10

RELEASED FOR CONSTRUCTION: \_\_\_\_\_

ENGINEER'S SEAL  
PROVINCE OF MANITOBA  
REGISTERED PROFESSIONAL ENGINEER  
A. MALBASA  
MEMBER 23212  
CONSULTANT DRAWING NO. C-207

**THE CITY OF WINNIPEG**  
Winnipeg ENGINEERING DIVISION

**NESS AVENUE**  
BELVIDERE STREET TO FERRY ROAD  
STA 10+00 TO FERRY ROAD  
2006 ASPHALT RESURFACING

SHEET 7 OF 7  
CAD FILE DRAWING NUMBER 04400C-201675.dwg  
CITY DRAWING NUMBER P3270

V:\1177\winn\11770400\ROAD\DRAWING\_SET\04400C-201675.dwg  
2006-06-07 09:22:21  
04400C-201675.dwg