

ALLEY PAVEMENT PROFILE
SCALE: 1:250 HOR
1:10 VER

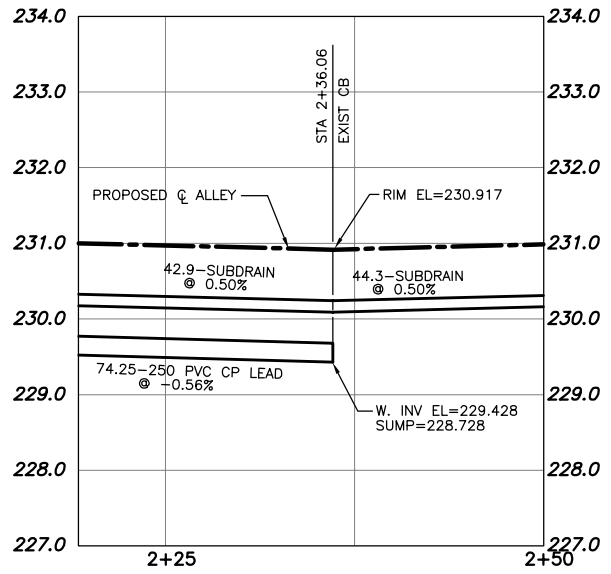

CATCH PIT & CATCH PIT LEAD PROFILE
SCALE: 1:250 HOR
1:50 VER

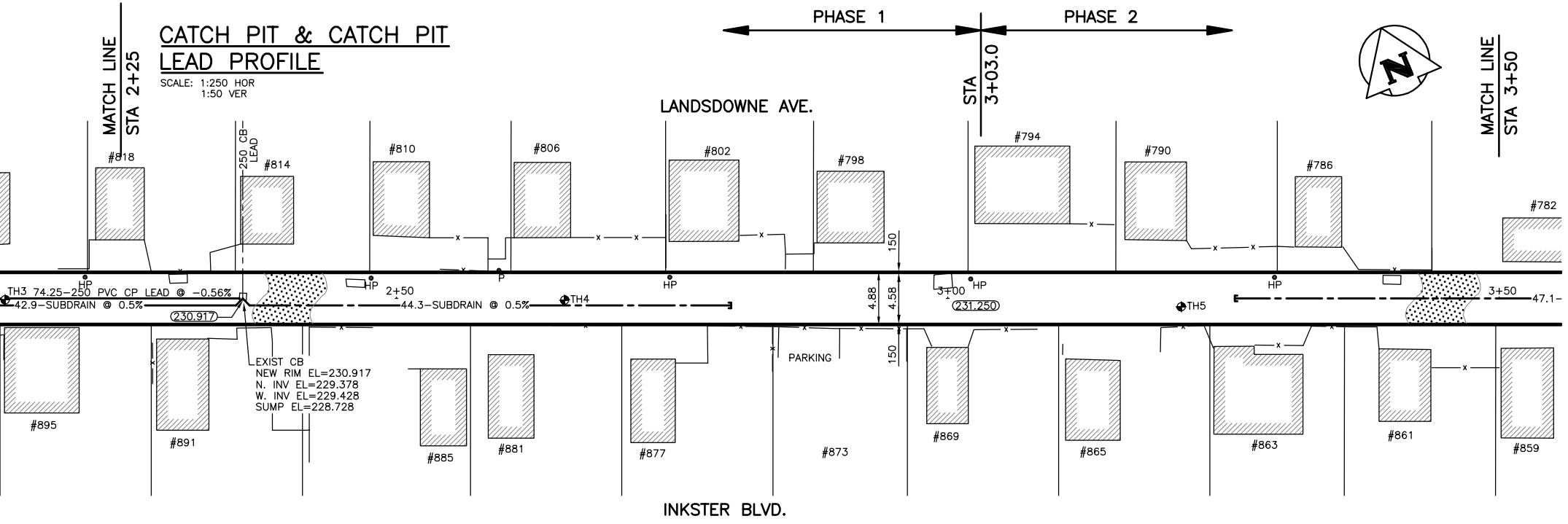

ALLEY PAVEMENT PLAN
SCALE: 1:250

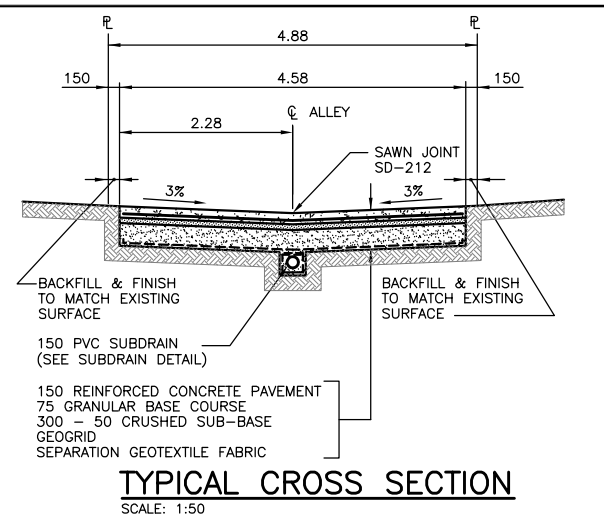

TYPICAL CROSS SECTION
SCALE: 1:50

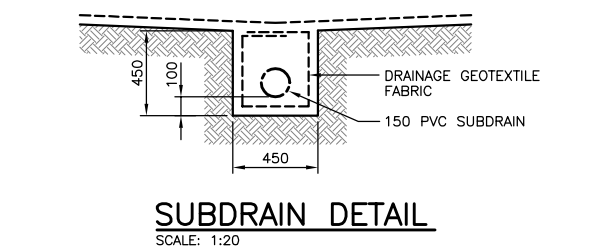

SUBDRAIN DETAIL
SCALE: 1:20

- NOTE:
1. STATION CHAINAGE IS BASED ON CENTERLINE OF ALLEY RIGHT OF WAY.
 2. ADJUST MH AND CB RIMS TO NEW GRADES.
 3. PLUG SUBDRAINS AT TERMINAL ENDS.
 4. REGRADE EXISTING PRIVATE SIDEWALKS AS REQUIRED.
 5. INSTALLATION OF LIP CURBS AND THEIR EXTENTS TO BE DETERMINED BY THE CONTRACT ADMINISTRATOR
 6. LIGHT STANDARDS, HYDRO POLES AND ANCHORS MAY REQUIRE TEMPORARY SUPPORT/REMOVAL OR REPLACEMENT AT THE CONTRACTOR'S EXPENSE.
 7. ISOLATE ALL POLES, BASES AND PILES WITHIN ALLEY RIGHT OF WAY (SD-228C)
 8. AVOID DAMAGE TO EXISTING TREES WITHIN THE LIMITS OF CONSTRUCTION.

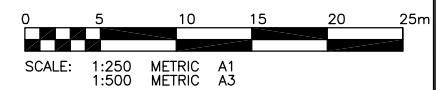

WARNING

IF POWER EQUIPMENT OR EXPLOSIVES ARE TO BE USED FOR EXCAVATION ON THIS PROJECT THE CONTRACTOR MUST:
1) NOTIFY THE GAS COMPANY OF THE PROPOSED LOCATION OF EXCAVATION.
2) TAKE PRECAUTION TO AVOID DAMAGE TO GAS COMPANY INSTALLATIONS.
SEE PROVINCIAL REGULATION 210/72 FOR DETAILS.

METRIC

WHOLE NUMBERS INDICATE MILLIMETRES
DECIMALIZED NUMBERS INDICATE METRES

APEGM
Certificate of Authorization
KGS Group
No. 245 Expiry: April 30, 2007

300 LBS	LAND DRAINAGE SEWER	300 LBS		TEST HOLE	
250 WWS	WASTE WATER SEWER	250 WWS		GUY WIRE	
---	GAS	---		LIGHT STANDARD	
---	HYDRO	---		BACK OF CURB	
---	M.T.S.	---		CONCRETE	
150 WM	WATERMAIN	150 WM		ASPHALT	
+	HYDRANT	+		SIDEWALK	
o	VALVE	o		PROPERTY LINE	
o	MANHOLE	o		SURVEY BAR	
□	CATCH BASIN	□		GEODETTIC BENCHMARK	
▽	CURB INLET	▽		ELEVATION	
•	POLES	•			
EXISTING	LEGEND-PLAN	PROPOSED	EXISTING	LEGEND-PROFILE	PROPOSED

LOCATION APPROVED UNDERGROUND STRUCTURES
SUPV. U/G STRUCTURES DATE COMMITTEE

NOTE:
LOCATION OF UNDERGROUND STRUCTURES AS SHOWN ARE BASED ON THE BEST INFORMATION AVAILABLE BUT NO GUARANTEE IS GIVEN THAT ALL EXISTING UTILITIES ARE SHOWN OR THAT THE GIVEN LOCATIONS ARE EXACT. CONFIRMATION OF EXISTENCE AND EXACT LOCATION OF ALL SERVICES MUST BE OBTAINED FROM THE INDIVIDUAL UTILITIES BEFORE PROCEEDING WITH CONSTRUCTION.

B.M. 26-003	ELEV. 230.992m	BOLT IN 14.3m CONC. PILE, 2.2m S. OF N.L. OF INKSTER BLVD. ON LINE WITH W.L. OF ARLIES ST.
NO.	REVISIONS	DATE
0	ISSUED FOR TENDER	06/05/25 CR
A	ISSUED FOR REVIEW	06/04/28 CR

KGS GROUP CONSULTING ENGINEERS & PROJECT MANAGERS
WINNIPEG (204) 896-1209
THUNDER BAY (807) 345-2233

DESIGNED BY	RO	CHECKED BY	CR
DRAWN BY	DW	APPROVED BY	
HOR. SCALE:	1:250	RELEASED FOR CONSTRUCTION:	
VERTICAL:	1:50	DATE	09/02/06

ENGINEER'S SEAL
M.C. ROWBOTHAM
REGISTERED PROFESSIONAL ENGINEER

THE CITY OF WINNIPEG
PUBLIC WORKS DEPARTMENT
ENGINEERING SERVICES DIVISION

PROJECT TITLE
2006 ALLEY RENEWAL PROGRAM
INKSTER BLVD/LANSOWNE AVE ALLEY
AIRLIES ST. TO SINCLAIR ST.
STA. 2+25.0 TO STA. 3+50.0

SHEET 10 OF 14
COMPUTER FILE NAME 06-0107-05
CITY DRAWING NUMBER 0010

CONSULTANT DRAWING NO. 06-0107-05

P:\PROJ\2006\06-107-05\MUN\DWGS\INKSTER-LANSOWNE\DWG\SALTER_AIKINS-PLAN.DWG