

ALLEY PAVEMENT PROFILE
SCALE: 1:250 HOR
1:10 VER

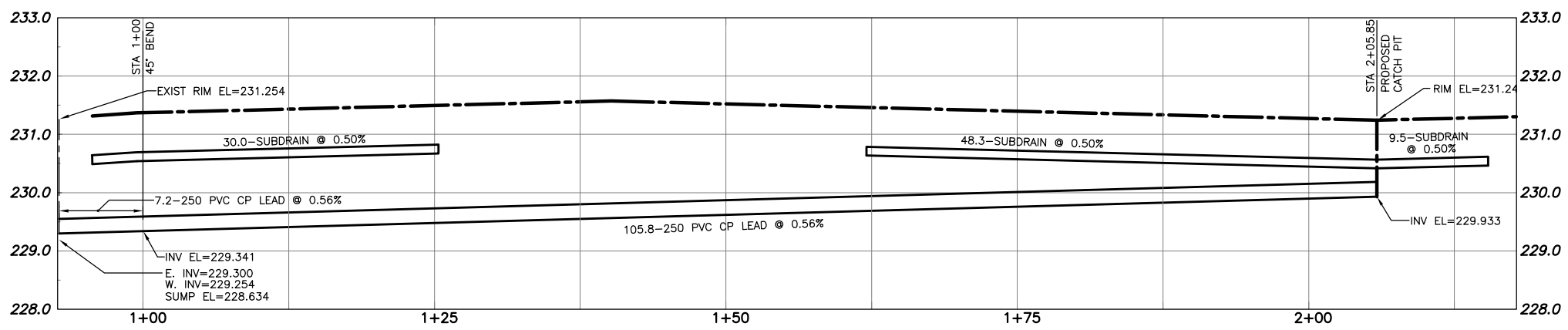

CATCH PIT & CATCH PIT LEAD PROFILE
SCALE: 1:250 HOR
1:50 VER

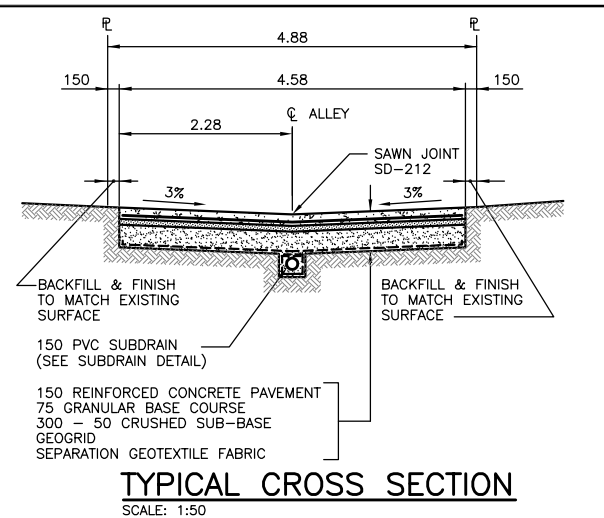

TYPICAL CROSS SECTION
SCALE: 1:50

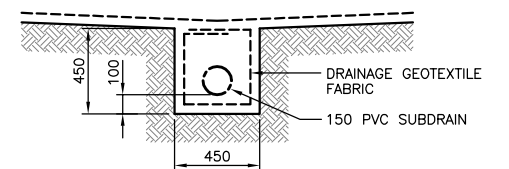

SUBDRAIN DETAIL
SCALE: 1:20

- NOTE:
1. STATION CHAINAGE IS BASED ON CENTERLINE OF ALLEY RIGHT OF WAY.
 2. ADJUST MH AND CB RIMS TO NEW GRADES.
 3. PLUG SUBDRAINS AT TERMINAL ENDS.
 4. REGRADE EXISTING PRIVATE SIDEWALKS AS REQUIRED.
 5. LIGHT STANDARDS, HYDRO POLES AND ANCHORS MAY REQUIRE TEMPORARY SUPPORT/REMOVAL OR REPLACEMENT AT THE CONTRACTOR'S EXPENSE.
 6. ISOLATE ALL POLES, BASES AND PILES WITHIN ALLEY RIGHT OF WAY (SD-228C) INSTALLATIONS.
 7. AVOID DAMAGE TO EXISTING TREES WITHIN THE LIMITS OF CONSTRUCTION.

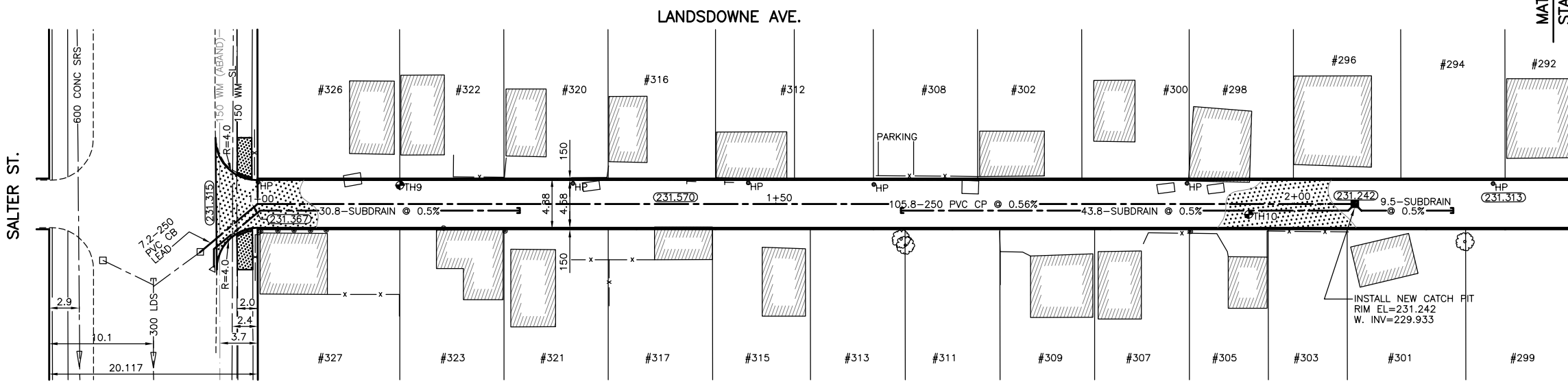
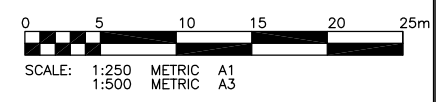

ALLEY PAVEMENT PLAN
SCALE: 1:250

WARNING

IF POWER EQUIPMENT OR EXPLOSIVES ARE TO BE USED FOR EXCAVATION ON THIS PROJECT THE CONTRACTOR MUST:
1) NOTIFY THE GAS COMPANY OF THE PROPOSED LOCATION OF EXCAVATION.
2) TAKE PRECAUTION TO AVOID DAMAGE TO GAS COMPANY INSTALLATIONS.
SEE PROVINCIAL REGULATION 210/72 FOR DETAILS.

METRIC

WHOLE NUMBERS INDICATE MILLIMETRES
DECIMALIZED NUMBERS INDICATE METRES

APEGM
Certificate of Authorization
KGS Group
No. 245 Expiry: April 30, 2007

300 LBS	LAND DRAINAGE SEWER	300 LBS		TEST HOLE			
250 WWS	WASTE WATER SEWER	250 WWS		GUY WIRE			
---	GAS	---		LIGHT STANDARD			
---	HYDRO	---		BACK OF CURB			
---	M.T.S.	---		CONCRETE			
150 WM	WATERMAIN	150 WM		ASPHALT			
+	HYDRANT	+		SIDEWALK			
o	VALVE	o		PROPERTY LINE			
o	MANHOLE	o		SURVEY BAR			
□	CATCH BASIN	□		GEODETIC BENCHMARK			
▽	CURB INLET	▽		ELEVATION			
•	POLES	•	231.334				
EXISTING	LEGEND-PLAN	PROPOSED	EXISTING	LEGEND-PLAN	PROPOSED	EXISTING	LEGEND-PROFILE

LOCATION APPROVED UNDERGROUND STRUCTURES

B.M. 26-003 ELEV. 230.992m

BOLT IN 14.3m CONC. PILE, 2.2m S. OF N.L. OF INKSTER BLVD. ON LINE WITH W.L. OF AIKINS ST.

DESIGNED BY: RO
DRAWN BY: DW
HOR. SCALE: 1:250
VERTICAL: 1:50
DATE: 09/02/06

ENGINEER'S SEAL: M.C. ROWBOTHAM, Member 22679, Registered Professional Engineer, Province of Manitoba

THE CITY OF WINNIPEG PUBLIC WORKS DEPARTMENT ENGINEERING SERVICES DIVISION

PROJECT TITLE: 2006 ALLEY RENEWAL PROGRAM
INKSTER BLVD/LANSDOWNE AVE ALLEY SALTER ST. TO AIKINS ST. STA. 0+95.66 TO STA. 2+25.0

SHEET 12 OF 14
COMPUTER FILE NAME: 06-0107-05
CITY DRAWING NUMBER: 0012

CONSULTING ENGINEERS & PROJECT MANAGERS
KGS GROUP
WINNIPEG (204) 896-1299
THUNDER BAY (807) 345-2233

DESIGNED BY: RO
DRAWN BY: DW
HOR. SCALE: 1:250
VERTICAL: 1:50
DATE: 09/02/06

CHECKED BY: CR
APPROVED BY:
RELEASED FOR CONSTRUCTION:
DATE:

CONSULTANT DRAWING NO. 06-0107-05

P:\PROJ\2006\06-107-05\MUN\DWGS\INKSTER-LANSDOWNE\SALTER.DWG\SALTER_AIKINS-PLT.DWG