

LOCATION PLAN
N.T.S.

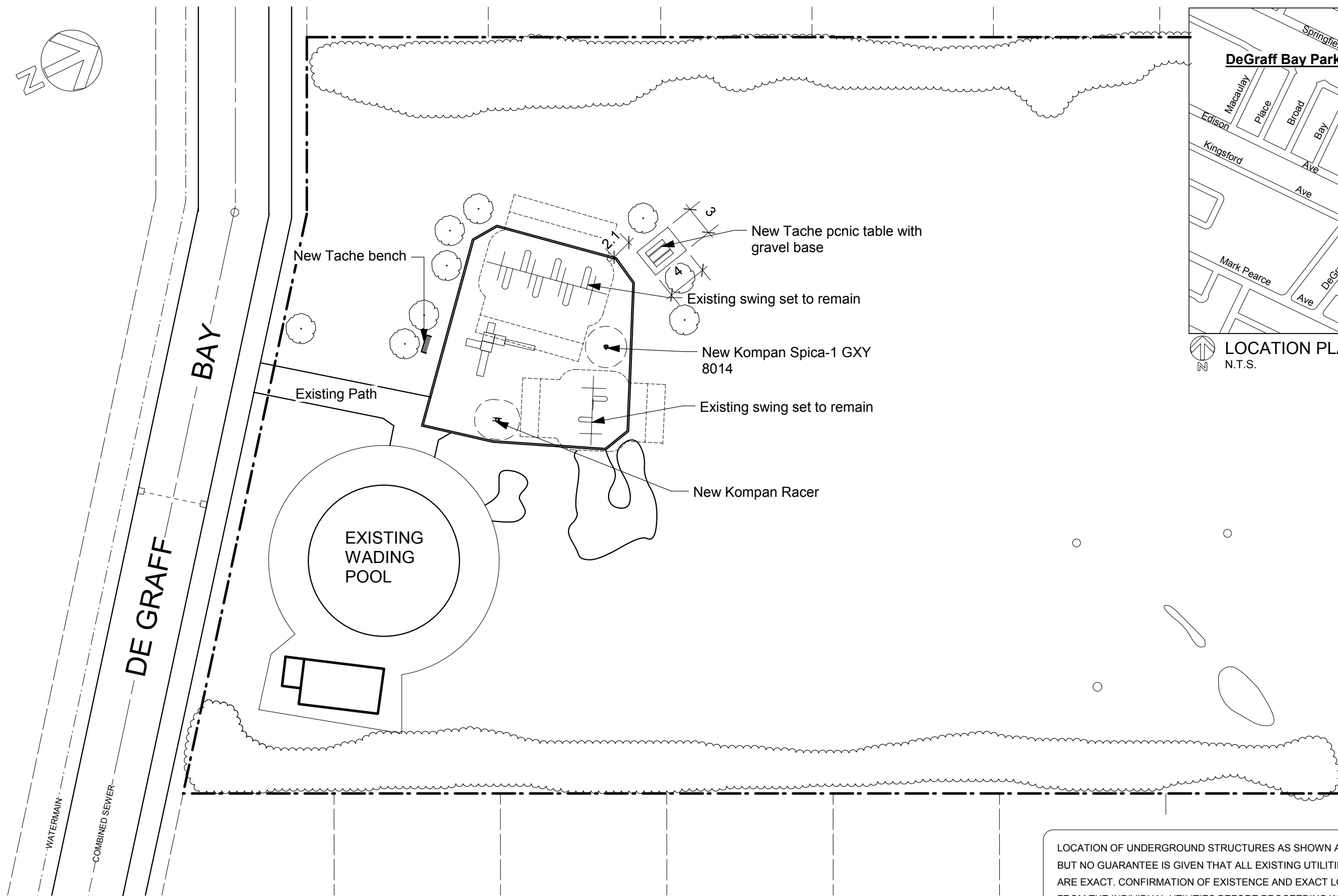

LOCATION OF UNDERGROUND STRUCTURES AS SHOWN ARE BASED ON THE BEST INFORMATION AVAILABLE BUT NO GUARANTEE IS GIVEN THAT ALL EXISTING UTILITIES ARE SHOWN OR THAT THE GIVEN LOCATIONS ARE EXACT. CONFIRMATION OF EXISTENCE AND EXACT LOCATION OF ALL SERVICES MUST BE OBTAINED FROM THE INDIVIDUAL UTILITIES BEFORE PROCEEDING WITH CONSTRUCTION.



THE CITY OF WINNIPEG
Planning, Property and Development Department
Planning and Land Use Division
Unit 15 - 30 Fort Street, Winnipeg, MB, (R3C 4X5)

DESIGNED BY	CHECKED BY	APPROVED BY
DRAWN BY ST	RELEASED FOR CONSTRUCTION	
HORIZ. SCALE VERT. SCALE 1 : 400		
DATE JULY/05	MANAGER, PLANNING AND LAND USE DIVISION	DATE

DRAWING TITLE
**DE GRAFF BAY PARK
Proposed Development**

CAD DRAWING NO.

DRAWING NO.
D-14.B