

**NORTHBOUND OSBORNE FAR SIDE RIVER
STOP 10171 RIVER**

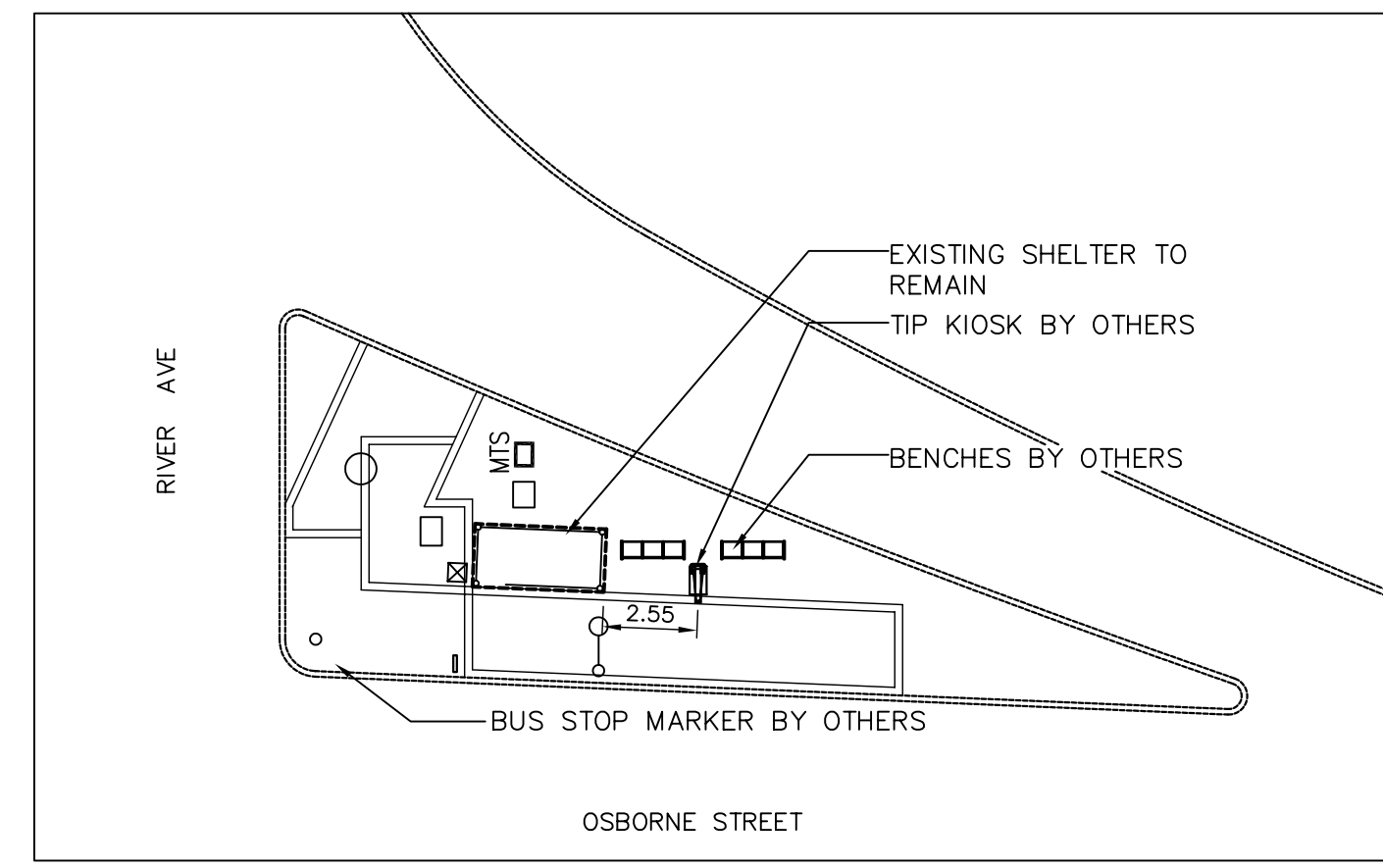

**SOUTHBOUND OSBORNE NEAR SIDE RIVER
STOP 10172 RIVER**

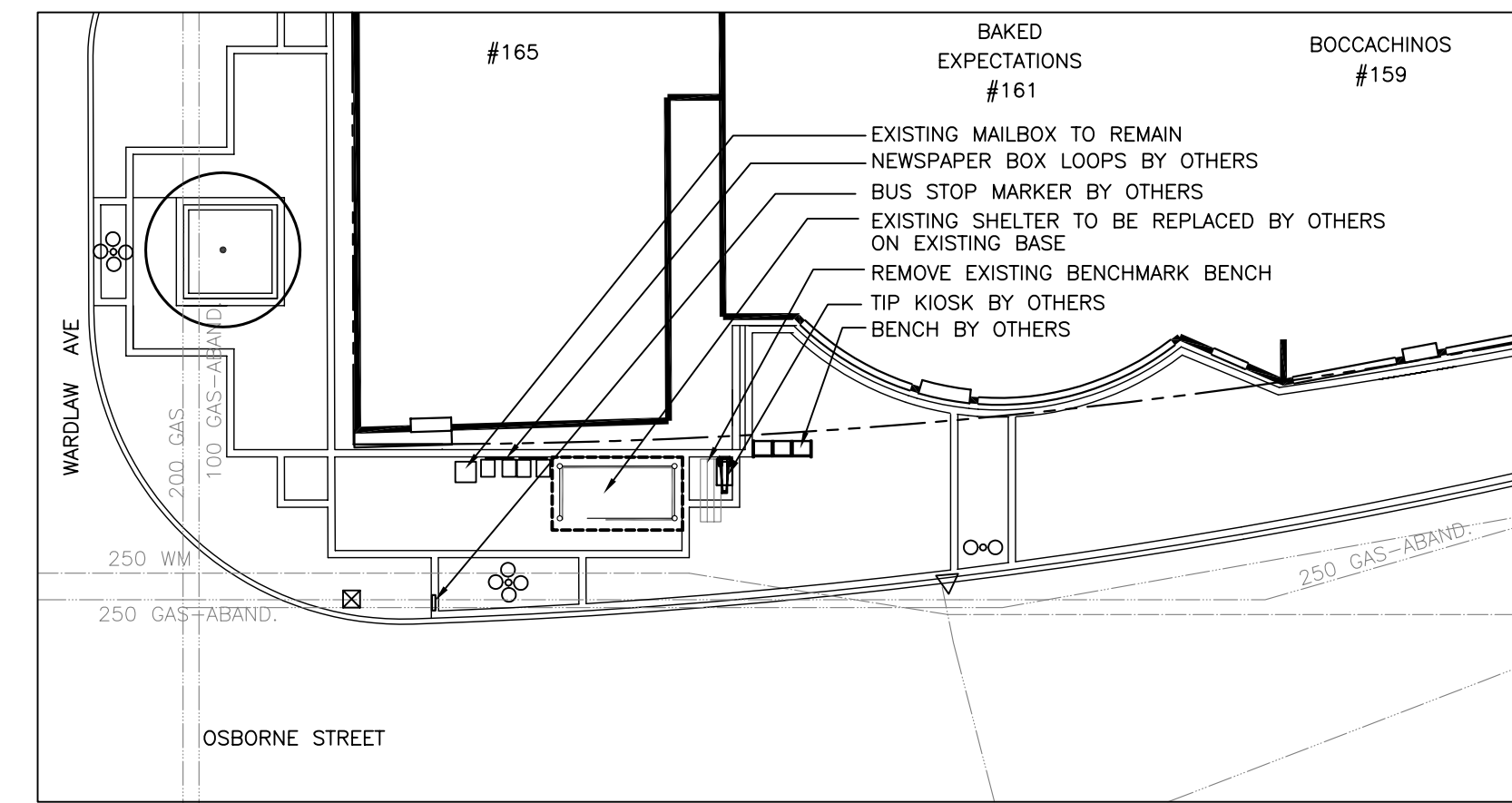

**SOUTHBOUND OSBORNE NEAR SIDE WARDLAW
STOP 10185 WARDLAW**

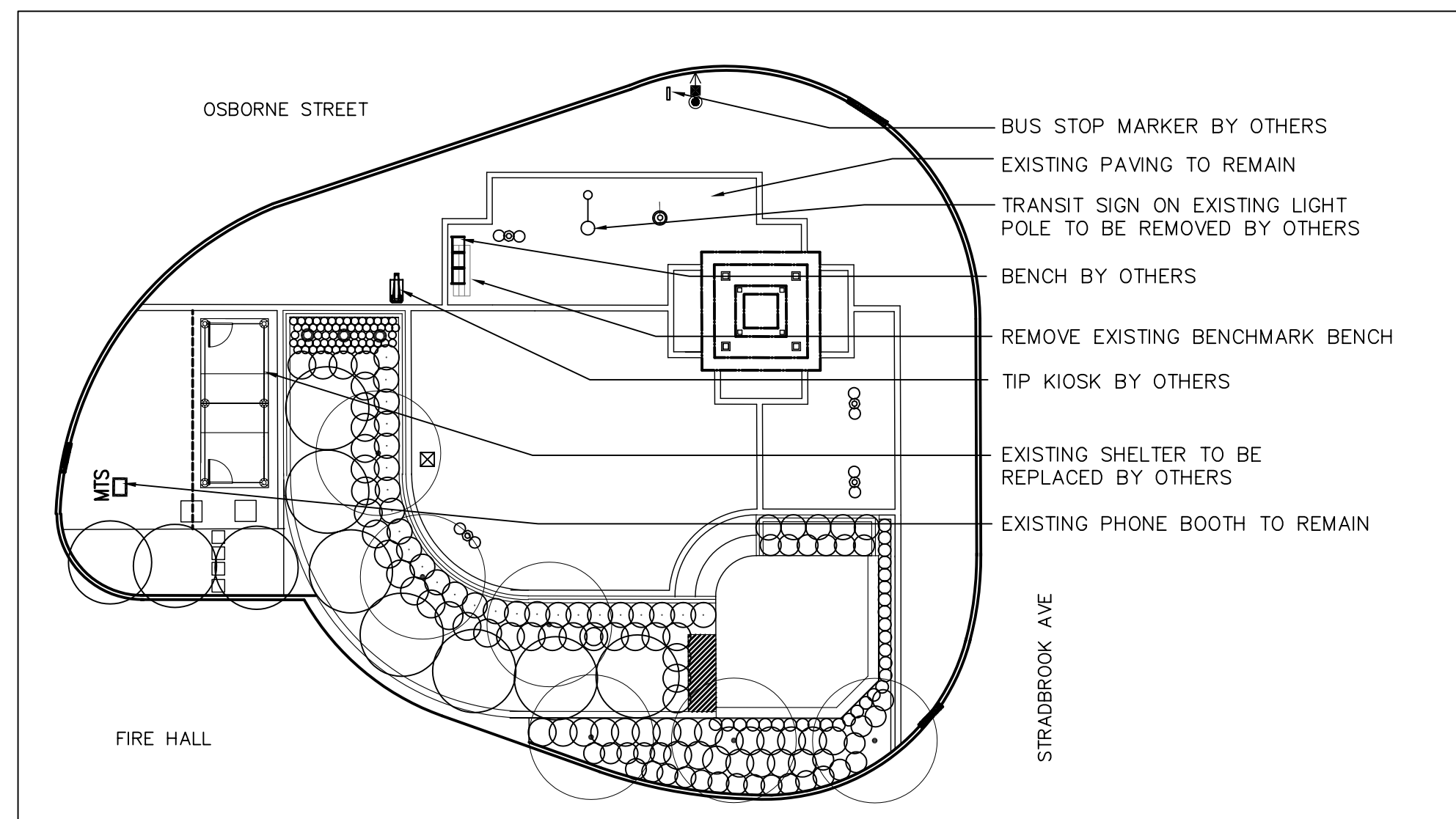

**NORTHBOUND OSBORNE NEAR SIDE STRADBROOK
STOP 10186 STRADBROOK**

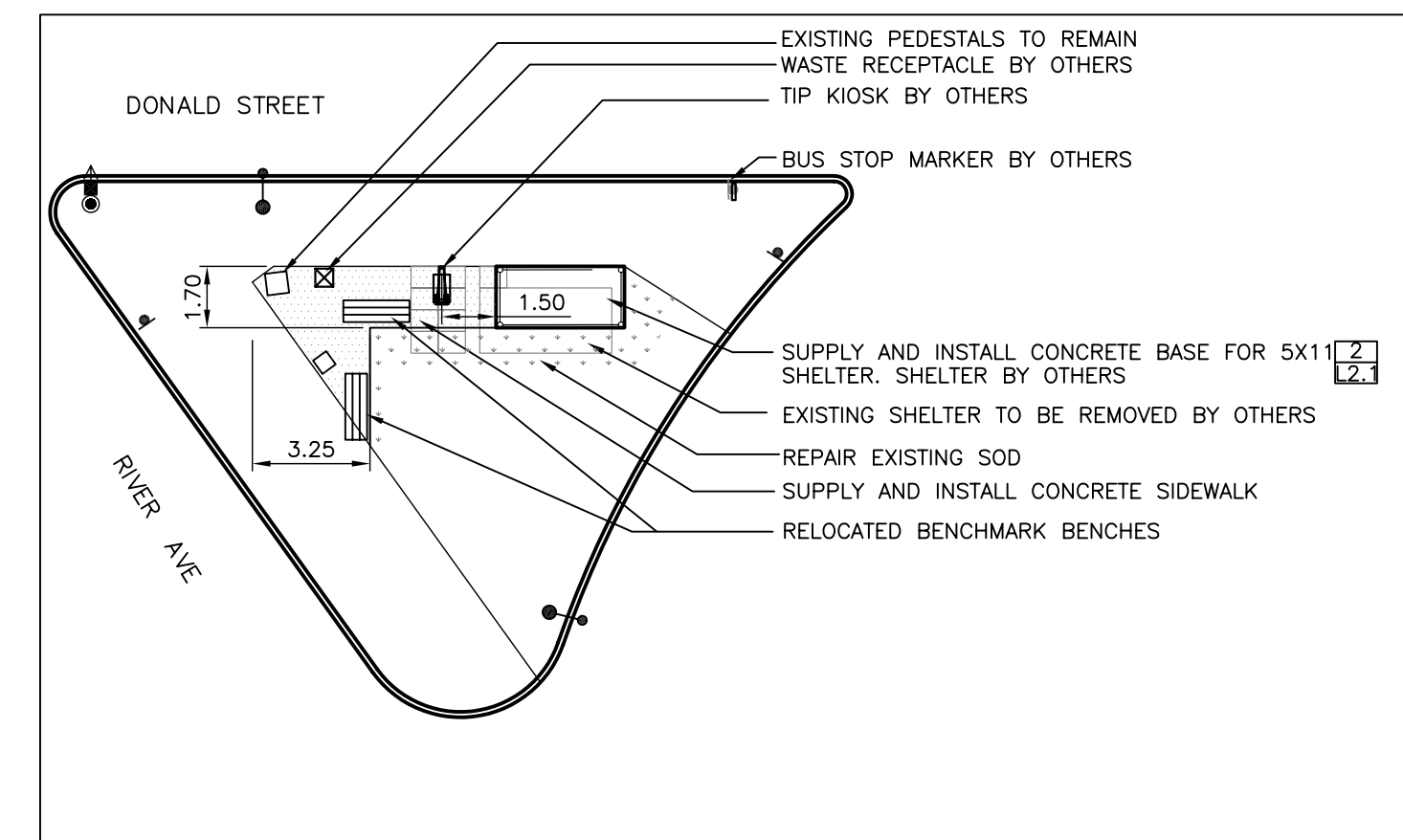

**NORTHBOUND DONALD FAR SIDE RIVER
STOP 10086 RIVER**

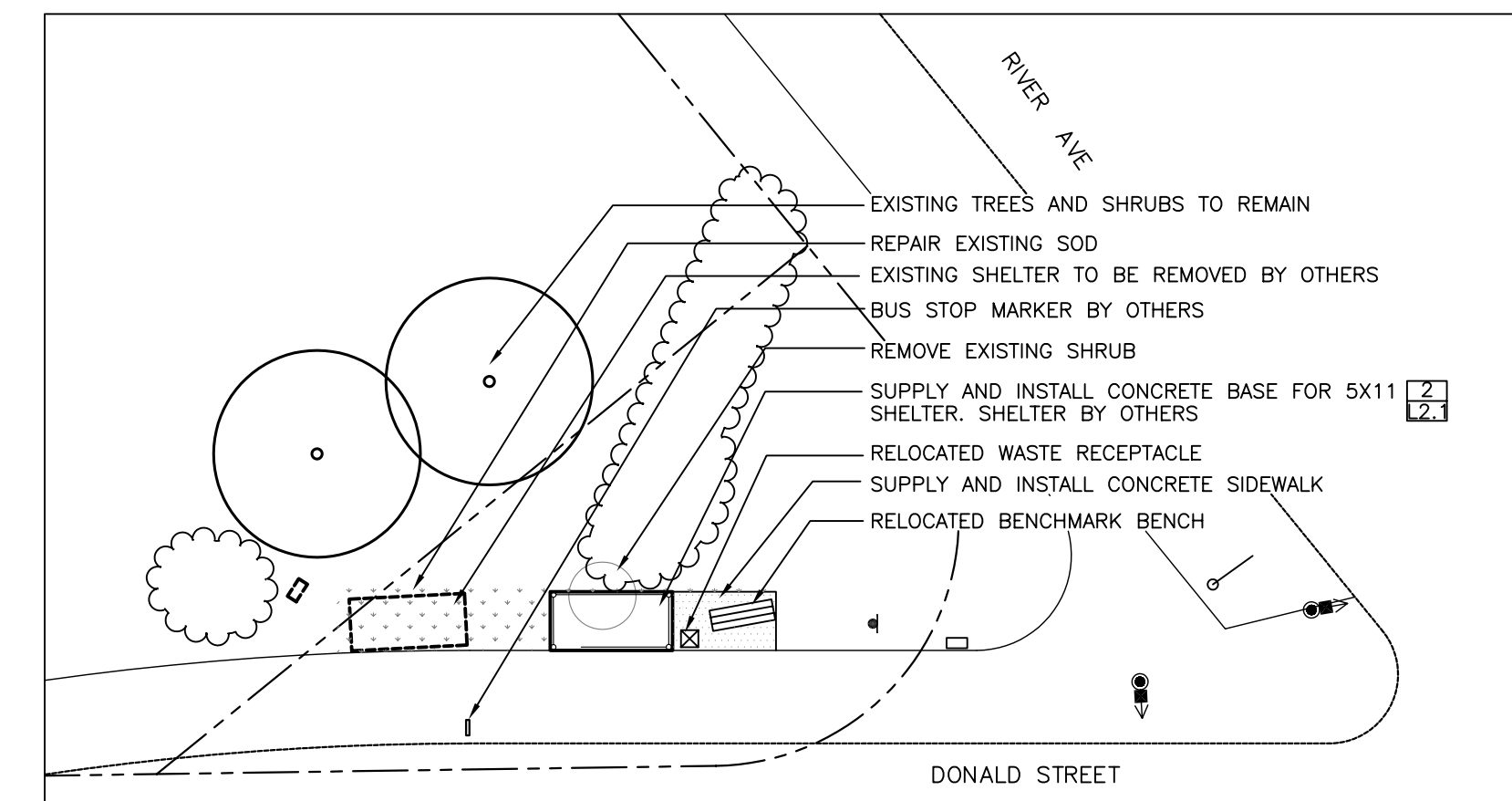

**SOUTHBOUND DONALD FAR SIDE RIVER
STOP 10166 RIVER**



NOTES

1. CONTRACTOR TO VERIFY LOCATION OF ALL UTILITIES PRIOR TO CONSTRUCTION.
2. ALL LAYOUT TO BE APPROVED BY CONTRACT ADMINISTRATOR PRIOR TO CONSTRUCTION.
3. THE CONTRACTOR SHALL PROVIDE A QUALIFIED CREW TO LAYOUT STREETS CAPING ELEMENTS. THE CREW SHALL BE EQUIPPED WITH ALL THE NECESSARY EQUIPMENT TO PROVIDE HORIZONTAL AND VERTICAL LAYOUT IN ACCORDANCE WITH THE PLANS AND SPECIFICATIONS.
4. ALL DIMENSION ARE IN METRIC UNLESS OTHERWISE NOTED. DECIMAL NUMBERS INDICATE METRES AND WHOLE NUMBERS INDICATED MILLIMETRES.
5. CONFIRM ALL DIMENSIONS ON SITE AND HAVE ALL PAVING APPROVED BY CONTRACT ADMINISTRATOR PRIOR TO ANY EXCAVATION OR CONSTRUCTION. REPORT ANY DISCREPANCIES.
6. CONTRACTOR TO PROTECT ALL TREES, POLES, CURBS, AREAWAYS ETC. TO REMAIN TO CITY OF WINNIPEG STANDARDS.
7. CONTRACTOR IS RESPONSIBLE FOR ALL REMOVALS AS REQUIRED TO CONSTRUCT ALL WORKS AS SHOWN ON PLANS AND DETAILS. ALL ITEMS TO BE REMOVED MUST BE DISPOSED OF LEGALLY OFF SITE. ALL REUSABLE PAVING STONE TO BE STOCKPILED FOR REINSTALLATION.
8. REFER ALSO TO WRITTEN SPECIFICATIONS.
9. WHERE CONTRACTOR IS REPAIRING EXISTING SURFACE MATERIALS, ALL BASE COURSES TO MATCH EXISTING CONDITION.
10. CONTRACTOR TO REPAIR AT HIS OWN COST ANY DAMAGE DONE DURING CONSTRUCTION TO CITY OR ADJACENT PROPERTIES TO C.O.W. STANDARDS.
11. CONTRACTOR TO NOTE THAT WORK WILL BE DONE UNDER SEPARATE CONTRACT PRIOR TO, DURING AND FOLLOWING HIS WORK. SPECIFICALLY THE FOLLOWING WORK BY OTHERS WILL BE DONE:
 - WINNIPEG TRANSIT TO REPLACE EXISTING PASSENGER SHELTERS
 - SIGNAGE CONTRACTOR TO SUPPLY AND INSTALL TRANSIT INFORMATION KIOSKS, INCLUDING REINSTALLATION OF UNIT PAVERS AROUND BASES.
 - NEWSPAPER COMPANIES TO REMOVE AND RELOCATE NEWSPAPER BOXES
 - BENCHMARK TO REMOVE EXISTING ADVERTISING BENCH

No.	Revisions	Date	By
Date		Scale	
12-07-07		1:200	
Designed By	Drawn By	Checked By	
JW	JW	SR	

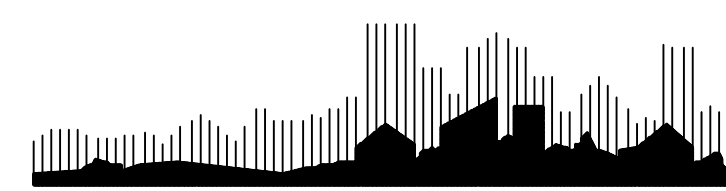

McGOWAN·RUSSELL

Client

WINNIPEG TRANSIT

Project Title

**BUS STOP
UPGRADE PROGRAM
PHASE 1**

Sheet Title

**LAYOUT PLANS
4 of 4**

Project No.

06-029

Drawing No.

L1.4