

1 PLUMBING PLAN
M1.1 SCALE: 1/4" = 1'-0"

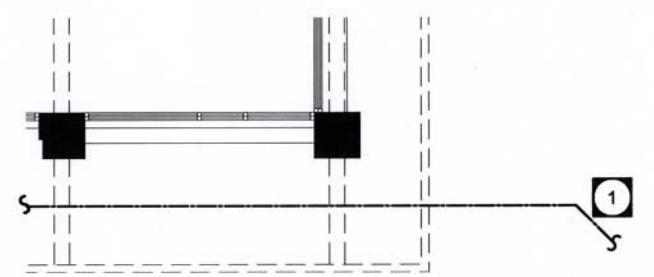

2 DCW SITE CONNECTIONS
M1.1 SCALE: 1/8" = 1'-0"

KEY NOTES

- 1** DCW SUPPLY. SEE M1.2 FOR CONTINUATION.
- 2** SEWAGE LIFT STATION. SEE 2-M1.2 FOR DETAILS.
- 3** DOMESTIC WATER BRANCH LINES SHALL BE ROUTED AT LOWER LEVEL IN PLUMBING WALL.
- 4** RELOCATE NATURAL GAS METER AS SHOWN. PIPE GAS LINE TO INFRARED HEATERS IN LOUNGE AREA AT HIGH LEVEL. LOCATE AS INDICATED ON ARCHITECTURAL. G.C. TO CORE HOLES THROUGH GLULAM BEAMS.
- 5** PROVIDE ACCESS HATCHES FOR ALL COMPONENTS OF PLUMBING SYSTEM THAT WILL REQUIRE ACCESS.
- 6** REFER TO HOT WATER TANK DETAIL (M1.3) FOR VALVE CONFIGURATION. PLUMB MIXING VALVE AS PER MANUFACTURERS RECOMMENDATIONS.
- 7** 3" BUILDING VENT UP THROUGH ROOF. COLLECT ALL OTHER VENTING TO THIS POINT.
- 8** DIV. 16 SHALL INSTALL PUMP CONTROLLER ENCLOSURE IN MECHANICAL ROOM AND CONNECT TO LIFT STATION PUMPS.
- 9** 3" VENT FROM LIFT STATION. RISE TO HIGH LEVEL AND CONNECT TO MAIN BLDG VENT.
- 10** RUN 3" SEWER FORCE MAIN BELOW FLOOR SLAB. CONNECT TO EXISTING 3" LINE. SEE M1.2 FOR CONTINUATION.
- 11** REMOTE ALARM PANEL FOR LIFT STATION HIGH LEVEL, C/W LAMACOID LABEL READING: "SEWAGE PUMP HIGH LEVEL ALARM. PHONE 986-2351 TO REPORT"



epp siepman engineering inc.
mechanical engineers
303-100 Osborne St. South
Winnipeg, MB
R3L 1Y5
p 204.453.1080
f 204.453.1335
ese@eppsiepman.com

APEGM
Certificate of Authorization
Epp Siepman Engineering Inc.
No. 4035 Expiry: April 30, 2007

