

NOTE: CHAINAGES SHOWN ARE ALONG N R OF #108 RIVER RD

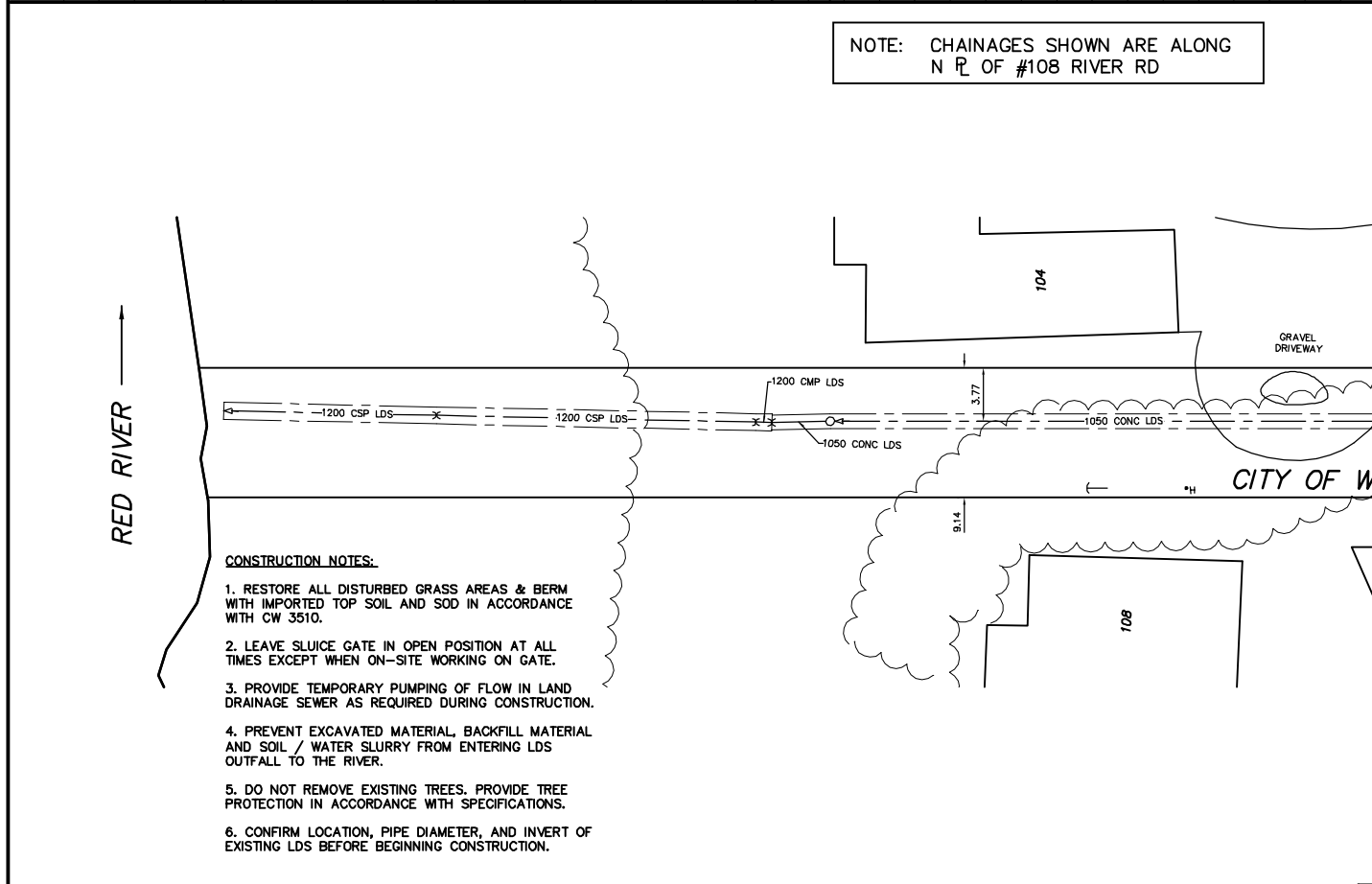

- CONSTRUCTION NOTES:**
- RESTORE ALL DISTURBED GRASS AREAS & BERM WITH IMPORTED TOP SOIL AND SOD IN ACCORDANCE WITH CW 3510.
 - LEAVE SLUICE GATE IN OPEN POSITION AT ALL TIMES EXCEPT WHEN ON-SITE WORKING ON GATE.
 - PROVIDE TEMPORARY PUMPING OF FLOW IN LAND DRAINAGE SEWER AS REQUIRED DURING CONSTRUCTION.
 - PREVENT EXCAVATED MATERIAL, BACKFILL MATERIAL AND SOIL / WATER SLURRY FROM ENTERING LDS OUTFALL TO THE RIVER.
 - DO NOT REMOVE EXISTING TREES. PROVIDE TREE PROTECTION IN ACCORDANCE WITH SPECIFICATIONS.
 - CONFIRM LOCATION, PIPE DIAMETER, AND INVERT OF EXISTING LDS BEFORE BEGINNING CONSTRUCTION.

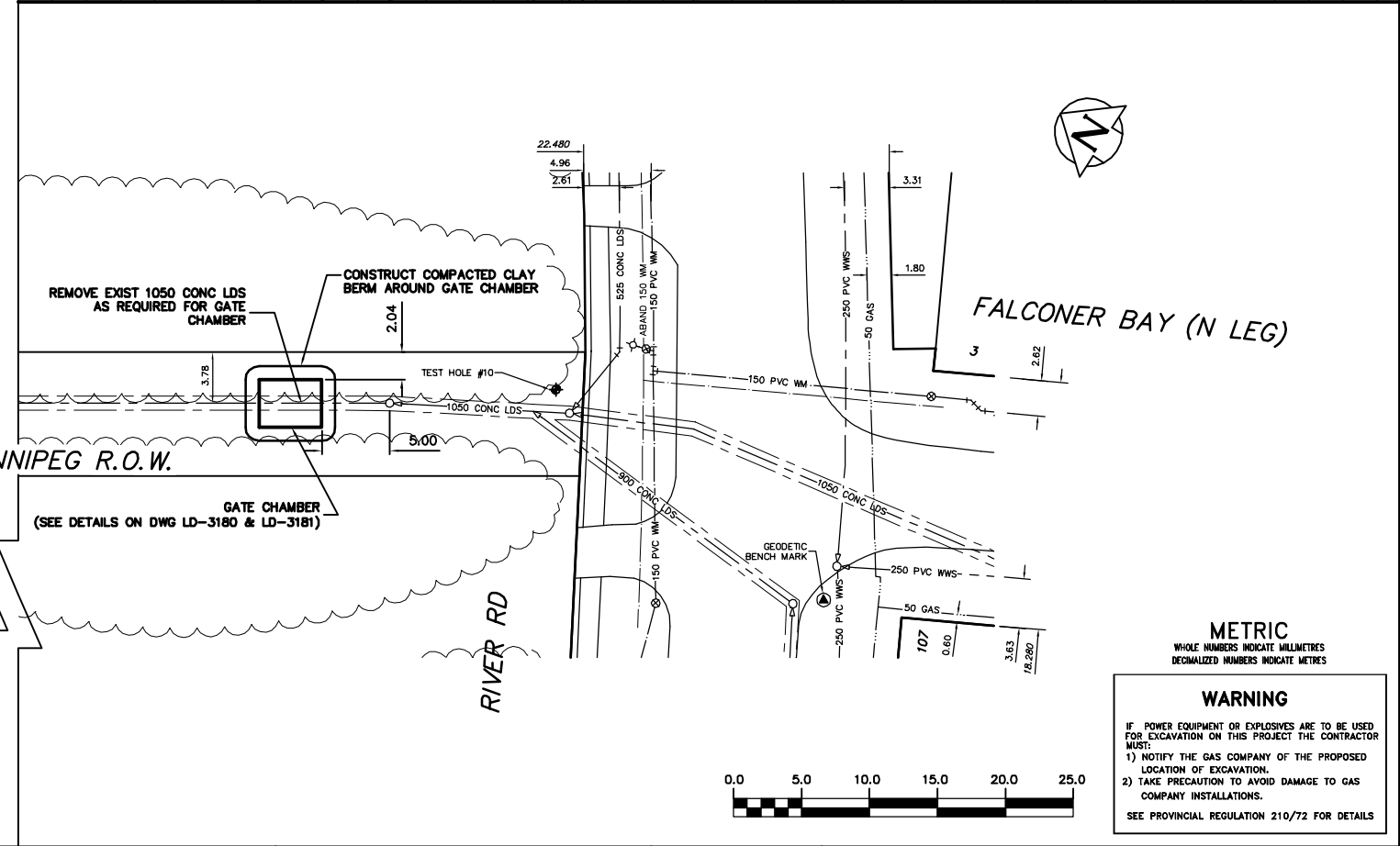

METRIC
WHOLE NUMBERS INDICATE MILLIMETRES
DECIMALIZED NUMBERS INDICATE METRES

WARNING
IF POWER EQUIPMENT OR EXPLOSIVES ARE TO BE USED FOR EXCAVATION ON THIS PROJECT THE CONTRACTOR MUST:
1) NOTIFY THE GAS COMPANY OF THE PROPOSED LOCATION OF EXCAVATION.
2) TAKE PRECAUTION TO AVOID DAMAGE TO GAS COMPANY INSTALLATIONS.
SEE PROVINCIAL REGULATION 210/72 FOR DETAILS

| 200 WM | WATERMAIN | 200 WM | SL, HYDRO | 150 WM | WATERMAIN | 150 WM |
|----------|---------------------|----------|-------------------|----------------|------------------------|----------|
| ⊕ | HYDRANT | ⊕ | MTS | ⊕ | HYDRANT | ⊕ |
| ⊙ | VALVE | ⊙ | TRAFFIC SIGNALS | ⊙ | VALVE | ⊙ |
| 525 LDS | LAND DRAINAGE SEWER | 525 LDS | GAS | 300 LDS | LAND DRAINAGE SEWER | 300 LDS |
| 375 WWS | WASTEWATER SEWER | 375 WWS | SURVEY BAR | 250 WWS | WASTEWATER SEWER | 250 WWS |
| ○ | MANHOLE | ○ | FENCE | ⊕ | PROFILE | ⊕ |
| □ | CATCH BASIN | □ | POLE - HYDRO, MTS | ⊕ | GROUND ABOVE PIPE | ⊕ |
| ▽ | CURB INLET | ▽ | CURB STOP | ⊕ | ? DITCH (SOUTH & EAST) | ⊕ |
| ⊕ | JUNCTIONS | ⊕ | GUY ANCHOR | ⊕ | GUTTER (NORTH & WEST) | ⊕ |
| ⊕ | CULVERT | ⊕ | LIGHT STANDARD | ⊕ | | ⊕ |
| ⊕ | ANODE | ⊕ | TREE | ⊕ | | ⊕ |
| EXISTING | LEGEND-PLAN | PROPOSED | EXISTING | LEGEND-PLAN | PROPOSED | EXISTING |
| | | | | LEGEND-PROFILE | PROPOSED | |

LOCATION APPROVED UNDERGROUND STRUCTURES

SUPV. U/G STRUCTURES COMMITTEE DATE

NOTE: LOCATION OF UNDERGROUND STRUCTURES AS SHOWN ARE BASED ON THE BEST INFORMATION AVAILABLE BUT NO GUARANTEE IS GIVEN THAT ALL EXISTING UTILITIES ARE SHOWN OR THAT THE GIVEN LOCATIONS ARE EXACT. CONFIRMATION OF EXISTENCE AND EXACT LOCATION OF ALL SERVICES MUST BE OBTAINED FROM THE INDIVIDUAL UTILITIES BEFORE PROCEEDING WITH CONSTRUCTION.

B.M. ELEV. FIELD BOOK #

POSTED TO LIS

CITY OF WINNIPEG WATER AND WASTE ENGINEERING DIVISION

DESIGNED BY DCS CHECKED BY TW

DRAWN BY PB APPROVED BY KZ

HOR. SCALE 1:250

VERTICAL SCALE 1:50

RELEASED FOR CONSTRUCTION

ENGINEER'S SEAL

ORIGINAL SIGNED BY K.R. ZUREK 06/07/28

THE CITY OF WINNIPEG WATER AND WASTE DEPARTMENT

2006 OUTFALL GATE CHAMBER CONSTRUCTION

FALCONER BAY

LDS OUTFALL GATE CHAMBER SITE PLAN

SHEET 1 OF 12

CITY DRAWING NUMBER

LD-3179

BID OPPORTUNITY: 505-2006

FILENAME: LD-3179.dwg

PLOT DATE: 2006 07 27