

CHURCH AVE

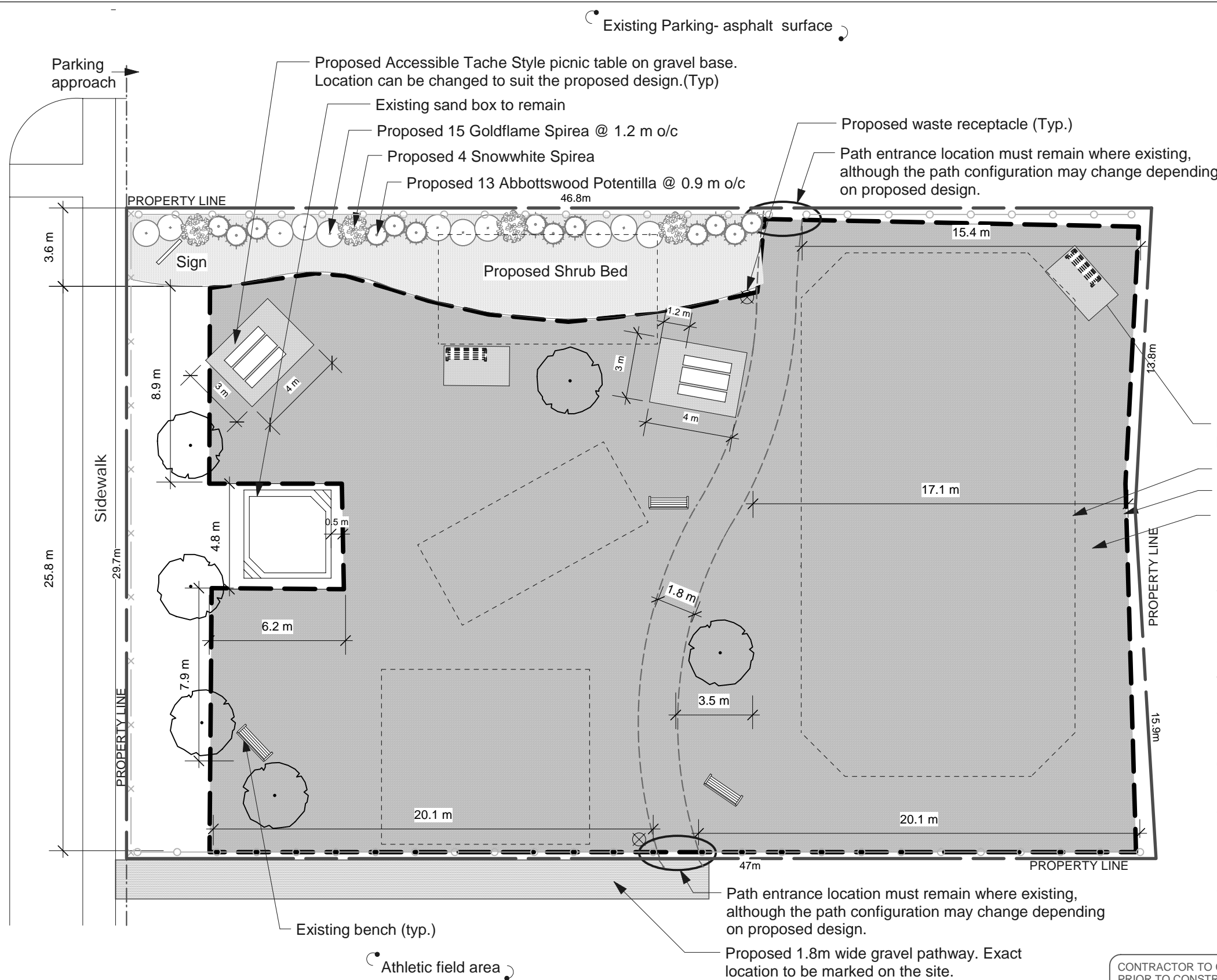

**LEGEND**

- Existing Tree (All trees to remain)
- Existing Bench (Benches can remain or be relocated dependent on the proposed design.)
- Proposed Tache Style Bench (Location to suit the proposed design.)
- Proposed Waste Receptacle
- Proposed Picnic Table on Gravel Base
- Proposed Goldflame Spirea
- Proposed Abbottswood Potentilla
- Proposed Snowwhite Spirea

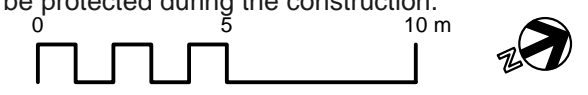

CONTRACTOR TO CONFIRM ALL DIMENSIONS AND REPORT ANY DISCREPANCIES TO CONTRACT ADMINISTRATOR PRIOR TO CONSTRUCTION. LOCATION OF UNDERGROUND STRUCTURES AS SHOWN ARE BASED ON THE BEST INFORMATION AVAILABLE BUT NO GUARANTEE IS GIVEN THAT ALL EXISTING UTILITIES ARE SHOWN OR THAT THE GIVEN LOCATIONS ARE EXACT. CONFIRMATION OF EXISTENCE AND EXACT LOCATION OF ALL SERVICES MUST BE OBTAINED FROM THE INDIVIDUAL UTILITIES BEFORE PROCEEDING WITH CONSTRUCTION.

THE CITY OF WINNIPEG  
 Planning, Property and Development Department  
 Planning and Land Use Division  
 Unit 15 - 30 Fort Street, Winnipeg, MB, (R3C 4X5)

DESIGNED BY	BB/DB	CHECKED BY	DB
DRAWN BY	BB	APPROVED BY	
HORIZ. SCALE	1:200		
VERT. SCALE			
DATE	Feb 21, 2006		

MANAGER,  
PARK AND OPEN SPACES

DATE

MANAGER,  
PLANNING AND LAND USE DIVISION

DATE

DRAWING TITLE  
**JOHN SHALEY PLAYGROUND (Sinclair C.C.)**

DRAWING NO.  
**J.19-B**

Proposed Development

SITE ADDRESS 490 Sinclair Street

BID OPPORTUNITY NO.  
**557-2006**