

D SIZE 22" x 34" (559mm x 864mm)

PLOT: 06/09/12 11:48:11 AM

ENG: J. J. ID: 2004 NAME: 0265-388-00_00-L-1003_RX.dwg Saved By: jhbberg

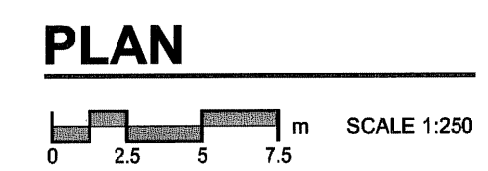
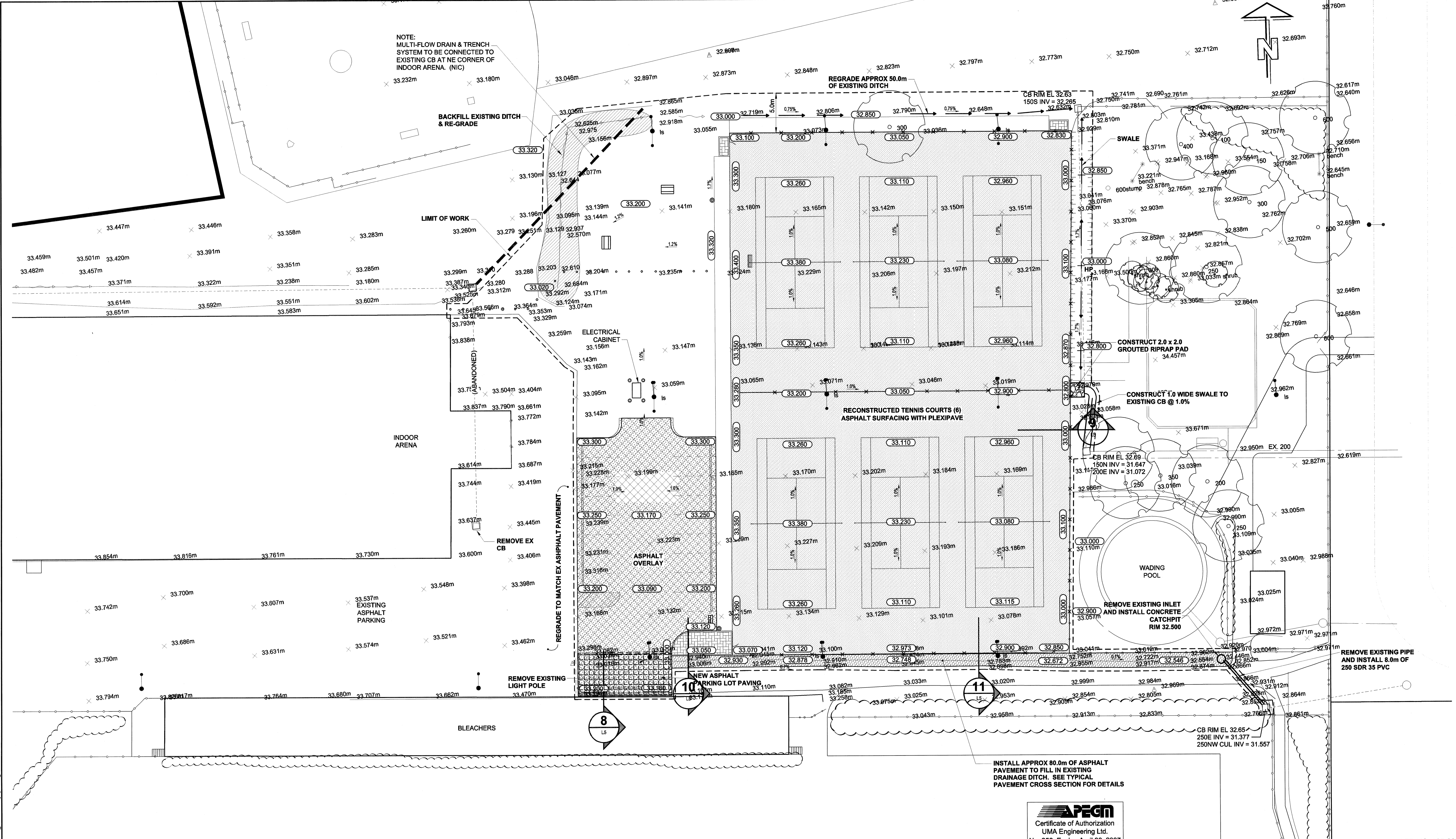

LOCATION APPROVED UNDERGROUND STRUCTURES

NO.	REVISIONS	DATE	BY
0	ISSUED FOR CONSTRUCTION	06/09/11	LJV
A	ISSUED FOR REVIEW	06/08/08	LJV

NOTE:
LOCATION OF UNDERGROUND STRUCTURES AS SHOWN ARE BASED ON THE BEST INFORMATION AVAILABLE. BUT NO GUARANTEE IS GIVEN THAT ALL EXISTING UTILITIES ARE SHOWN OR THAT THE GIVEN LOCATIONS ARE EXACT. CONFIRMATION OF EXISTENCE AND EXACT LOCATION OF ALL SERVICES MUST BE OBTAINED FROM THE INDIVIDUAL UTILITIES BEFORE PROCEEDING WITH CONSTRUCTION.

NO.	REVISIONS	DATE	BY

UMA | AECOM

© 2006 UMA ENGINEERING LTD. ALL RIGHTS RESERVED.

DESIGNED BY	WJ	CHECKED BY	[Signature]
DRAWN BY	LJV	APPROVED BY	[Signature]
HOR. SCALE	1:250	RELEASED FOR CONSTRUCTION	
VERT. SCALE			
DATE	06/09/11	DATE	

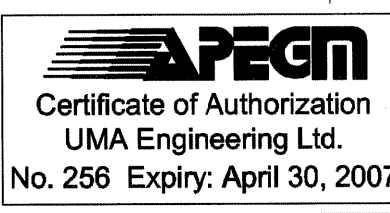

CONSULTANT DRAWING NO. 003
0265-388-00

THE CITY OF WINNIPEG PUBLIC WORKS DEPARTMENT

CINDY KLASSEN RECREATION COMPLEX TENNIS COURTS REDEVELOPMENT

SITE GRADING PLAN

CITY DRAWING NUMBER	
SHEET	3 OF 7
REV	L3 0

TENDER NO. 585-2006