

TEST HOLE #2 DETAIL  
SCALE NTS

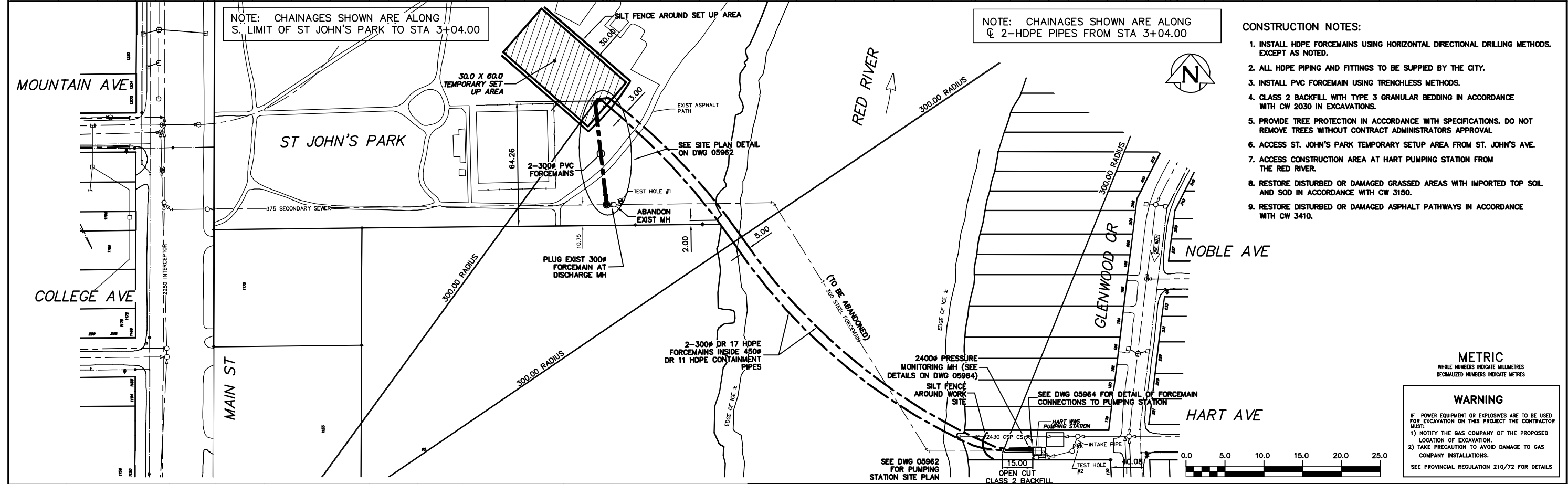

- CONSTRUCTION NOTES:**
1. INSTALL HDPE FORCEMAINS USING HORIZONTAL DIRECTIONAL DRILLING METHODS, EXCEPT AS NOTED.
  2. ALL HDPE PIPING AND FITTINGS TO BE SUPPLIED BY THE CITY.
  3. INSTALL PVC FORCEMAIN USING TRENCHLESS METHODS.
  4. CLASS 2 BACKFILL WITH TYPE 3 GRANULAR BEDDING IN ACCORDANCE WITH CW 2030 IN EXCAVATIONS.
  5. PROVIDE TREE PROTECTION IN ACCORDANCE WITH SPECIFICATIONS. DO NOT REMOVE TREES WITHOUT CONTRACT ADMINISTRATORS APPROVAL.
  6. ACCESS ST. JOHN'S PARK TEMPORARY SETUP AREA FROM ST. JOHN'S AVE.
  7. ACCESS CONSTRUCTION AREA AT HART PUMPING STATION FROM THE RED RIVER.
  8. RESTORE DISTURBED OR DAMAGED GRASSED AREAS WITH IMPORTED TOP SOIL AND SOD IN ACCORDANCE WITH CW 3150.
  9. RESTORE DISTURBED OR DAMAGED ASPHALT PATHWAYS IN ACCORDANCE WITH CW 3410.

**METRIC**  
WHOLE NUMBERS INDICATE MILLIMETRES  
DECIMALIZED NUMBERS INDICATE METRES

**WARNING**  
IF POWER EQUIPMENT OR EXPLOSIVES ARE TO BE USED FOR EXCAVATION ON THIS PROJECT THE CONTRACTOR MUST:  
1) NOTIFY THE GAS COMPANY OF THE PROPOSED LOCATION OF EXCAVATION.  
2) TAKE PRECAUTION TO AVOID DAMAGE TO GAS COMPANY INSTALLATIONS.  
SEE PROVINCIAL REGULATION 210/72 FOR DETAILS

200 WM	WATERMAIN	200 WM	SL, HYDRO	150 WM	WATERMAIN	150 WM	LOCATION APPROVED	B.M. ELEV.	FIELD BOOK #:	<b>CITY OF WINNIPEG</b> <b>WATER AND WASTE</b> <b>ENGINEERING DIVISION</b>	ENGINEER'S SEAL	<b>THE CITY OF WINNIPEG</b> <b>WATER AND WASTE DEPARTMENT</b>	<b>2006 RENEWAL OF THE HART WASTEWATER PUMPING STATION FORCEMAIN RED RIVER CROSSING AND STATION PIPING MODIFICATIONS</b>	SHEET 1 OF 5 CITY DRAWING NUMBER <b>05961</b>
525 LDS	LAND DRAINAGE SEWER	525 LDS	TRAFFIC SIGNALS	300 LDS	LAND DRAINAGE SEWER	300 LDS	UNDERGROUND STRUCTURES	POSTED TO LBS			DESIGNED BY TW			
375 WWS	WASTEWATER SEWER	375 WWS	GAS	250 WWS	WASTEWATER SEWER	250 WWS	DATE			DRAWN BY C.J.H.	APPROVED BY K.Z.			
	MANHOLE		SURVEY BAR		PROFILE		NOTE:							
	CATCH BASIN		FENCE		GROUND ABOVE PIPE		LOCATION OF UNDERGROUND STRUCTURES AS SHOWN ARE BASED ON THE BEST INFORMATION AVAILABLE BUT NO GUARANTEE IS GIVEN THAT ALL EXISTING UTILITIES ARE SHOWN OR THAT THE GIVEN LOCATIONS ARE EXACT. CONFIRMATION OF EXISTENCE AND EXACT LOCATION OF ALL SERVICES MUST BE OBTAINED FROM THE INDIVIDUAL UTILITIES BEFORE PROCEEDING WITH CONSTRUCTION.							
	CURB INLET		POLE - HYDRO, MTS		☉ DITCH (NORTH & WEST)									
	JUNCTIONS		CURB STOP		☉ DITCH (SOUTH & EAST)									
	CULVERT		GUY ANCHOR		☉ GUTTER (NORTH & WEST)									
	ANODE		LIGHT STANDARD		☉ GUTTER (SOUTH & EAST)									
EXISTING	LEGEND-PLAN	PROPOSED	EXISTING	LEGEND-PLAN	PROPOSED	EXISTING	LEGEND-PROFILE	PROPOSED						