

NOTES:
 1. CONTRACTOR TO VERIFY LIMITS OF SEWER REPAIRS PRIOR TO EXCAVATION BY MEANS OF VIDEO INSPECTION.
 2. CONTRACTOR TO PROVIDE VIDEO INSPECTION OF SEWER SERVICES WITHIN LIMITS OF REPAIR IN PRESENCE OF CONTRACT ADMINISTRATOR TO DETERMINE IF SERVICE RENEWAL IS REQUIRED.

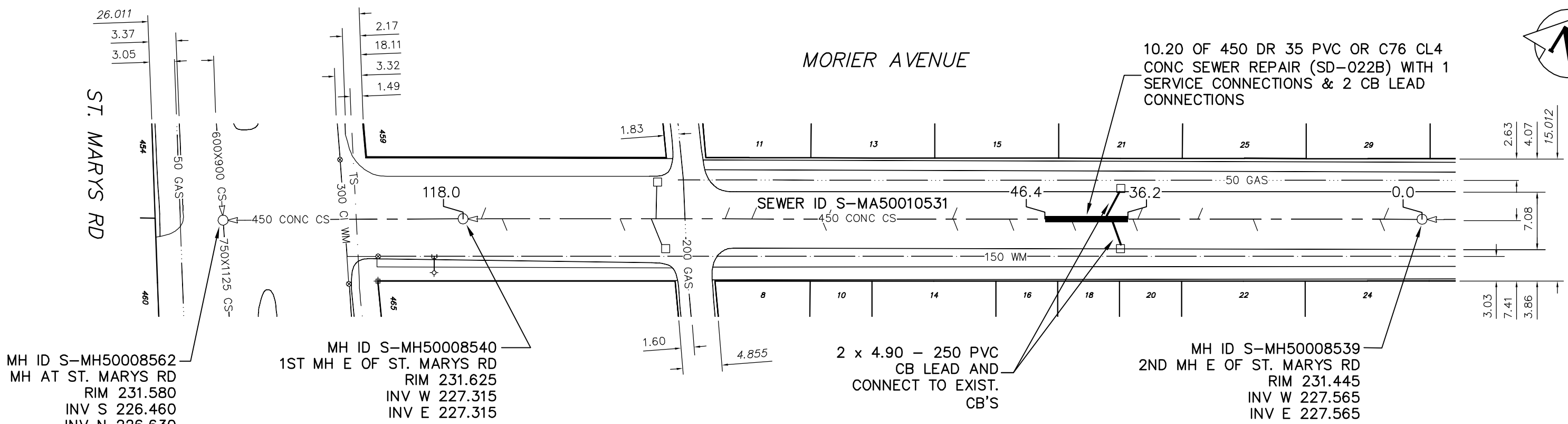

MH ID S-MH50008562
 MH AT ST. MARYS RD
 RIM 231.580
 INV S 226.460
 INV N 226.630
 INV E UNKNOWN

MH ID S-MH50008540
 1ST MH E OF ST. MARYS RD
 RIM 231.625
 INV W 227.315
 INV E 227.315

2 x 4.90 - 250 PVC
 CB LEAD AND
 CONNECT TO EXIST.
 CB'S

MH ID S-MH50008539
 2ND MH E OF ST. MARYS RD
 RIM 231.445
 INV W 227.565
 INV E 227.565

SEWER JUNCTION INFORMATION
 FROM SEWER VIDEO INSPECTION
 S-MA50010531

DISTANCE FROM MH ID S-MH50008539				
35.00	W	150ø	NORTH	21 MORIER AVE
35.60	W	150ø	SOUTH	20 MORIER AVE
39.50	W	150ø	SOUTH	CB LEAD
40.30	W	150ø	NORTH	CB LEAD
43.20	W	150ø	SOUTH	18 MORIER AVE

SEWER SERVICE INFORMATION		
ADDRESS	SIZE	R DIST JUNCTION TIE
18 MORIER AVE RESIDENTIAL	150	- 43.2 W 2ND MH E OF ST. MARYS
20 MORIER AVE RESIDENTIAL	150	- 35.6 W 2ND MH E OF ST. MARYS
21 MORIER AVE RESIDENTIAL	150	- 35.0 W 2ND MH E OF ST. MARYS

ENGINEER'S SEAL

ORIGINAL SIGNED BY
 K.R. ZUREK
 10/20/06

BID OPPORTUNITY No: 638-2006
 FILENAME : 05977.dwg
 PLOT DATE : 2006 10 23

LEGEND:
 52.0 | MEASUREMENT TO REPAIR FROM REFERENCE MH SHOWN THUS...

METRIC
 WHOLE NUMBERS INDICATE MILLIMETRES
 DECIMALIZED NUMBERS INDICATE METRES

B.M. ELEV.	FIELD BOOK #:	CITY OF WINNIPEG WATER AND WASTE ENGINEERING DIVISION	THE CITY OF WINNIPEG WATER AND WASTE DEPARTMENT	2006 COMBINED SEWER RENEWALS AND SEWER REPAIRS MORIER AVENUE 1ST MH W OF DES MEURONS TO 1ST MH E OF ST. MARYS ROAD	SHEET 11 OF 17 CITY DRAWING NUMBER 05977
POSTED TO LIS					
DESIGNED BY: NC	CHECKED BY: TW				
DRAWN BY: CJH	APPROVED BY: KZ				
HOR. SCALE 1:500	RELEASED FOR CONSTRUCTION				
VERTICAL					
NO. REVISIONS	DATE BY	DATE 2006 10 20			