

NOTES:

1. CONTRACTOR TO VERIFY LIMITS OF SEWER REPAIRS PRIOR TO EXCAVATION BY MEANS OF VIDEO INSPECTION.
2. CONTRACTOR TO PROVIDE VIDEO INSPECTION OF SEWER SERVICES WITHIN LIMITS OF REPAIR IN PRESENCE OF CONTRACT ADMINISTRATOR TO DETERMINE IF SERVICE RENEWAL IS REQUIRED.

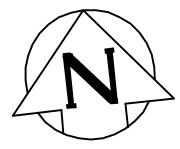
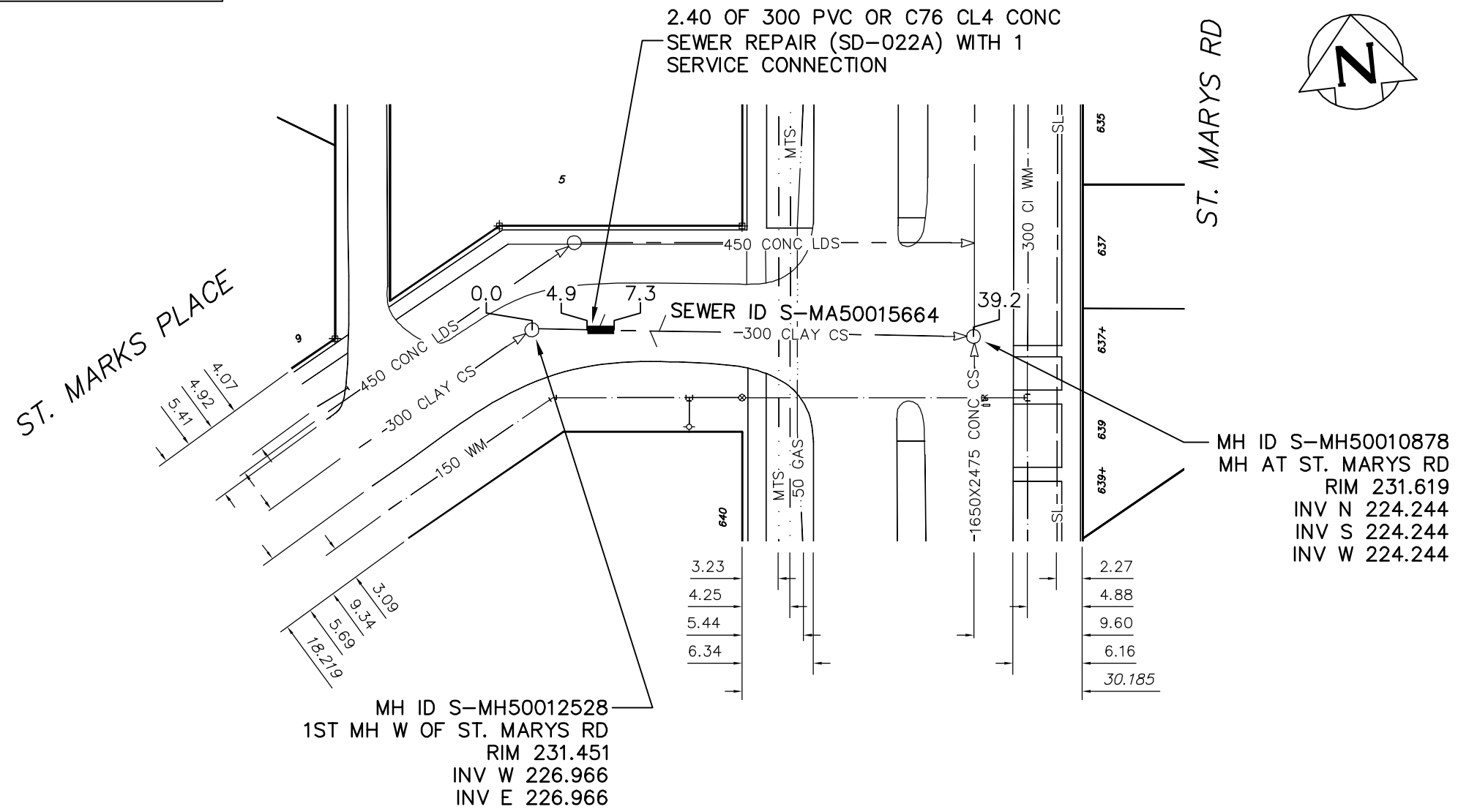

SEWER JUNCTION INFORMATION FROM SEWER VIDEO INSPECTION S-MA50015664				
DISTANCE FROM MH ID S-MH50012528				
5.90	E	150Ø	NORTH	5 ST. MARKS
10.50	E	150Ø	SOUTH	640 ST. MARYS
11.30	E	150Ø	NORTH	5 ST. MARKS

MH ID S-MH50012528
1ST MH W OF ST. MARYS RD
RIM 231.451
INV W 226.966
INV E 226.966

MH ID S-MH50010878
MH AT ST. MARYS RD
RIM 231.619
INV N 224.244
INV S 224.244
INV W 224.244

SEWER SERVICE INFORMATION		
ADDRESS	SIZE	R DIST JUNCTION TIE
5 ST. MARKS PL COMMERCIAL	150	-
5 ST. MARKS PL COMMERCIAL	150	5.9 E 1ST MH W OF ST. MARYS
640 ST. MARYS RD RESIDENTIAL	150	11.3 E 1ST MH W OF ST. MARYS
		10.5 E 1ST MH W OF ST. MARYS

ENGINEER'S SEAL

ORIGINAL SIGNED BY
K.R. ZUREK
10/20/06

BID OPPORTUNITY No: 638-2006
FILENAME : 05980.dwg
PLOT DATE : 2006 10 23

LEGEND:

52.0 | MEASUREMENT TO REPAIR FROM REFERENCE MH SHOWN THUS...

METRIC
WHOLE NUMBERS INDICATE MILLIMETRES
DECIMALIZED NUMBERS INDICATE METRES

B.M. ELEV.	FIELD BOOK #:	CITY OF WINNIPEG WATER AND WASTE ENGINEERING DIVISION		THE CITY OF WINNIPEG WATER AND WASTE DEPARTMENT	
POSTED TO LIS		DESIGNED BY: NC	CHECKED BY: TW	2006 COMBINED SEWER RENEWALS AND SEWER REPAIRS	
		DRAWN BY: CJH	APPROVED BY: KZ	ST. MARKS PLACE	
		HOR. SCALE: 1:500	RELEASED FOR CONSTRUCTION	1ST MH W OF ST. MARY'S ROAD TO MH AT ST. MARY'S ROAD	
NO. REVISIONS	DATE BY	DATE: 2006 10 20	DATE	SHEET 14 OF 17 CITY DRAWING NUMBER: 05980	