

NOTES:
 1. CONTRACTOR TO VERIFY LIMITS OF SEWER REPAIRS PRIOR TO EXCAVATION BY MEANS OF VIDEO INSPECTION.
 2. CONTRACTOR TO PROVIDE VIDEO INSPECTION OF SEWER SERVICES WITHIN LIMITS OF REPAIR IN PRESENCE OF CONTRACT ADMINISTRATOR TO DETERMINE IF SERVICE RENEWAL IS REQUIRED.

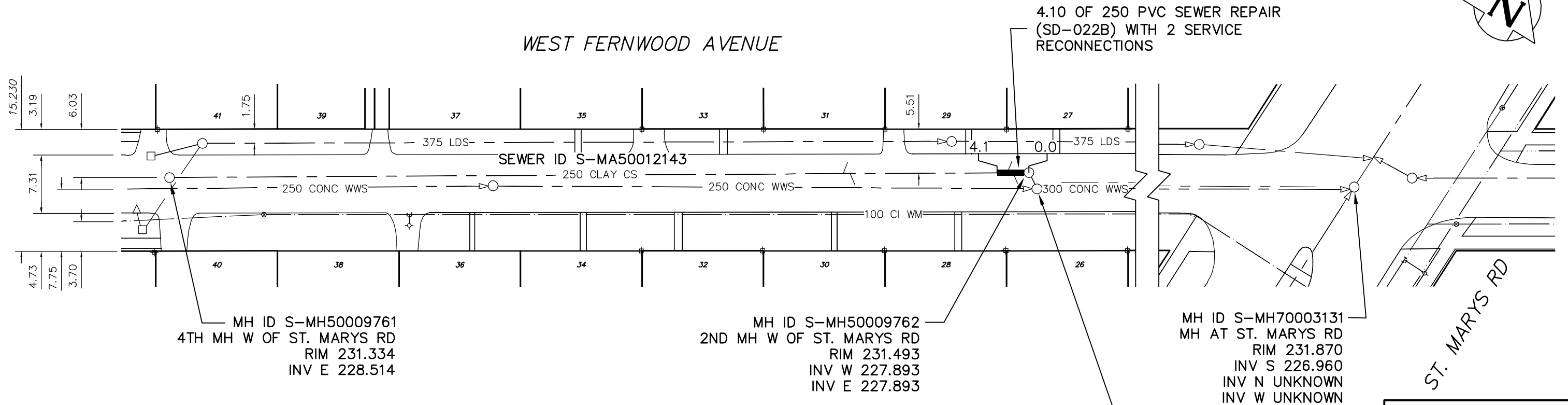

MH ID S-MH50009761
 4TH MH W OF ST. MARYS RD
 RIM 231.334
 INV E 228.514

MH ID S-MH50009762
 2ND MH W OF ST. MARYS RD
 RIM 231.493
 INV W 227.893
 INV E 227.893

MH ID S-MH50009633
 1ST MH W OF ST. MARYS RD
 RIM 231.520(R)
 INV W 227.200(R)
 INV E 227.200(R)

MH ID S-MH70003131
 MH AT ST. MARYS RD
 RIM 231.870
 INV S 226.960
 INV N UNKNOWN
 INV W UNKNOWN

SEWER JUNCTION INFORMATION FROM SEWER VIDEO INSPECTION S-MA50012143				
DISTANCE FROM MH ID S-MH50009633				
2.00	W	150ø	SOUTH	28 WEST FERNWOOD
2.70	W	150ø	NORTH	29 WEST FERNWOOD

SEWER SERVICE INFORMATION		
ADDRESS	SIZE	PL DIST JUNCTION TIE
28 WEST FERNWOOD AVE RESIDENTIAL		CONNECTED TO 250 CLAY CS 2.0 W 1ST MH W OF ST. MARYS RD
29 WEST FERNWOOD AVE RESIDENTIAL		CONNECTED TO 250 CLAY CS 2.7 W 1ST MH W OF ST. MARYS RD

ENGINEER'S SEAL

ORIGINAL SIGNED BY
 K.R. ZUREK
 10/20/06

BID OPPORTUNITY No: 638-2006
 FILENAME : 05982.dwg
 PLOT DATE : 2006 10 23

LEGEND:
 52.0 | MEASUREMENT TO REPAIR FROM REFERENCE MH SHOWN THUS...

METRIC
 WHOLE NUMBERS INDICATE MILLIMETRES
 DECIMALIZED NUMBERS INDICATE METRES

B.M. ELEV.	FIELD BOOK #:	CITY OF WINNIPEG WATER AND WASTE ENGINEERING DIVISION		THE CITY OF WINNIPEG WATER AND WASTE DEPARTMENT	
POSTED TO LBIS		DESIGNED BY: NC	CHECKED BY: TW	2006 COMBINED SEWER RENEWALS AND SEWER REPAIRS	
		DRAWN BY: CJH	APPROVED BY: KZ	WEST FERNWOOD AVENUE	
		HOR. SCALE: 1:500	RELEASED FOR CONSTRUCTION	2ND MH W OF ST. MARYS ROAD TO 1ST MH W OF ST. MARYS ROAD	
		VERTICAL		SHEET 16 OF 17	
NO.	REVISIONS	DATE	BY	CITY DRAWING NUMBER	
		2006 10 20		05982	