

SYMBOL SCHEDULE	
	Panelboard Surface Mounted
	Panelboard flush mounted
	Generator
	Automatic Transfer Switch
	Luminaire Wall Mounted
	Receptacle 120V
	Receptacle 208V
	Surface Luminaire 1x4
	Circuit Breaker
	Switch
	New
	Existing to Remain
	Deleted
	Existing to be relocated
	Relocated device/equipment

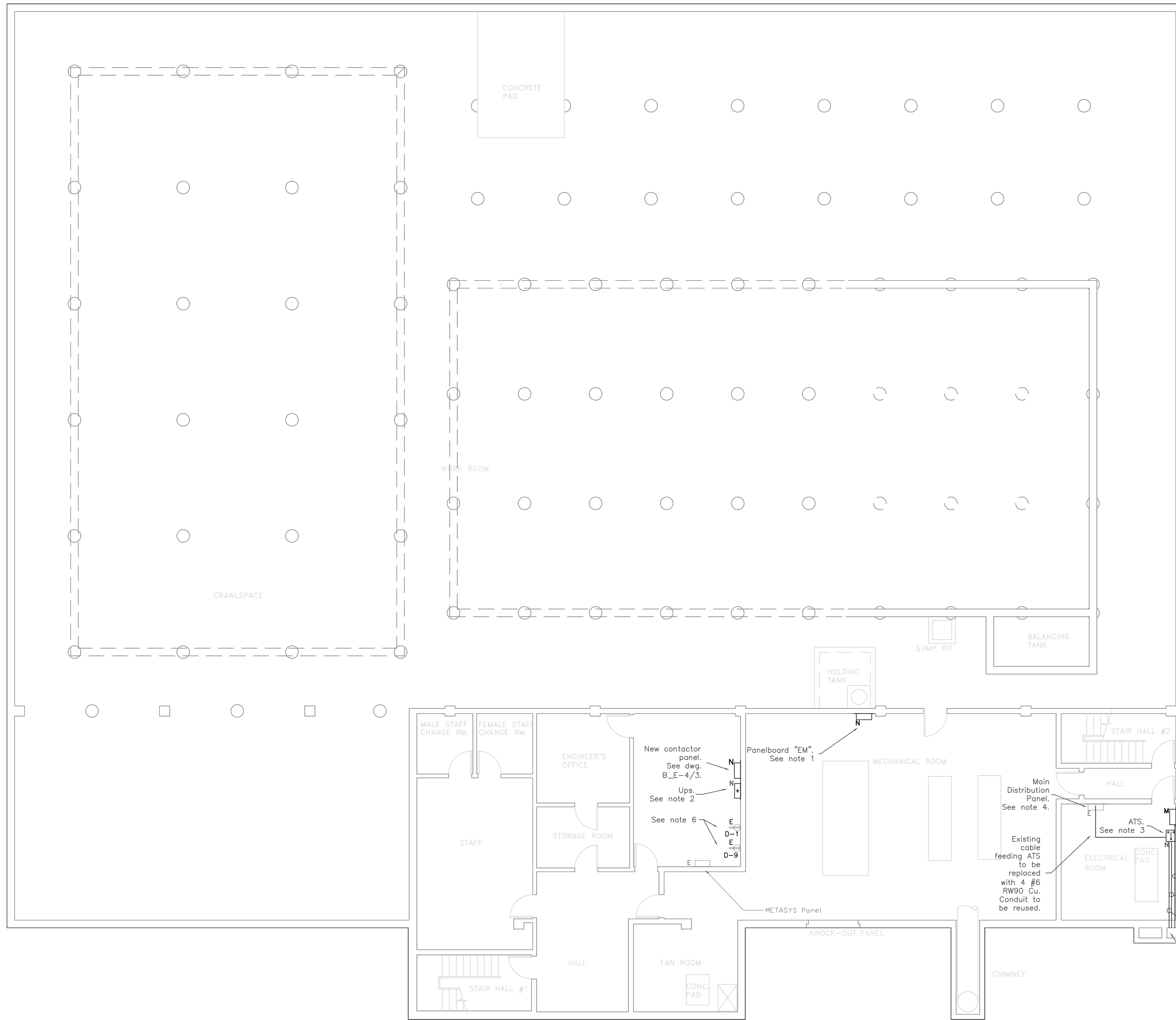

Notes:

1. Replace existing Panelboard "EM" with new Panelboard "EM". New Panelboard "EM" to be 120/208/3 $\phi$ /4w 24ccts, 100A mains, 18kA, c/w bolt-on breakers and typewritten directory. See dwg. B\_E-4/4. Label as: "Emergency Panel "EM" 120/208/3 $\phi$ /4w Fed From ATS". Rename and relocate existing panel as indicated (see note 5).
2. Emergency supply battery unit (UPS) to be wall mounted stand-by BCPRO600-TripLite or approved equal. Minimum half load backup time is 15min. Refer to dwg. B\_E-4/3. Label as: "Emergency UPS 600VA For SW Pool Emergency Lights, Input 120V Output 120V Fed From Panelboard "EM"".
3. Replace existing Automatic Transfer Switch (ATS) with new one. See dwg. B\_E-4/2 and E-5 for specifications. ATS to be drip shield protected.
4. Replace 208V 40 3p breaker feeding existing panel "EM" with 60A-3p 22kA breaker. Provide new 60A-3p 22kA breaker to feed panel "D". See dwg. B\_E-4/2.
5. Reuse old Panelboard "EM" (see note 1) c/w breakers. Rename as Panelboard "D". Provide drip shield, new typewritten directory and lamacoid. Lamacoid to read: "Panel "D" 120/208/3 $\phi$ /4w Fed From Main Distribution". See dwg. B\_E-4/4.
6. Existing 208/1 $\phi$  and 208/3 $\phi$  receptacles fed from panel "E" (See dwg. B\_E-2 for location) to be rewired to feed from panel "D" in electrical room. Wiring and conduit to match existing.

- 27mm EMT conduit and 3 ccts from panel "D" to Genset for black heater, space heater and receptacles. Wiring to be #12 RWU90 Cu.
- 35mm EMT conduit with 4#6 RWU 90 Cu for emergency power from generator.
- 16mm EMT conduit with 2#12 RWU 90 Cu from ATS to generator control panel (Generator start signal).
- Existing exhaust line wall section to be used for conduit passageway. New conduit trough section to be waterproof sealed.

Rev:	By:	DATE:
Rev:	By:	DATE:
Rev:	By:	DATE:

THE CITY OF WINNIPEG  
 PUBLIC WORKS DEPARTMENT  
 BUILDING SERVICES DIVISION  
 100 MAIN STREET, MAIN FLOOR  
 WPG, MB, R3C 1A4  
 (204) 986-7266

PROJECT:  
 Emergency System Upgrade  
 Bonivital Pool, 1215 Archibald St.

SHEET TITLE:  
 Basement Floor Plan, Electrical & Lighting

PROJECT NO:  
 663-2006

ENGINEER:  
 G.W. ALCOCK  
 REGISTERED PROFESSIONAL ENGINEER

SCALE:  
 1:100

DATE:  
 24 October, 2006

DWG. NO.:  
 B\_E-3

REV:  
 0