

**GENERAL NOTES:**  
 A. BASE LINE IS CENTERLINE OF 750 SUPERNATANT LINE  
 B. LOCATION OF UNDERGROUND STRUCTURES AS SHOWN ARE BASED ON THE BEST INFORMATION AVAILABLE, BUT NO GUARANTEE IS GIVEN THAT ALL EXISTING UTILITIES ARE SHOWN OR THAT THE GIVEN LOCATIONS ARE EXACT. CONFIRMATION OF EXISTENCE AND EXACT LOCATION OF ALL SERVICES MUST BE OBTAINED FROM THE INDIVIDUAL UTILITIES BEFORE PROCEEDING WITH CONSTRUCTION.

**BENCHMARK NOTES:**  
 DRAWING COORDINATES ARE UTM NAD83 - SCALE FACTOR 0.99983

| B.M. No. | NORTHING    | EASTING    | ELEVATION |
|----------|-------------|------------|-----------|
| PILE 136 | 5523873.734 | 647764.406 | 236.242   |
| PILE 133 | 5523256.606 | 647782.387 | 236.056   |

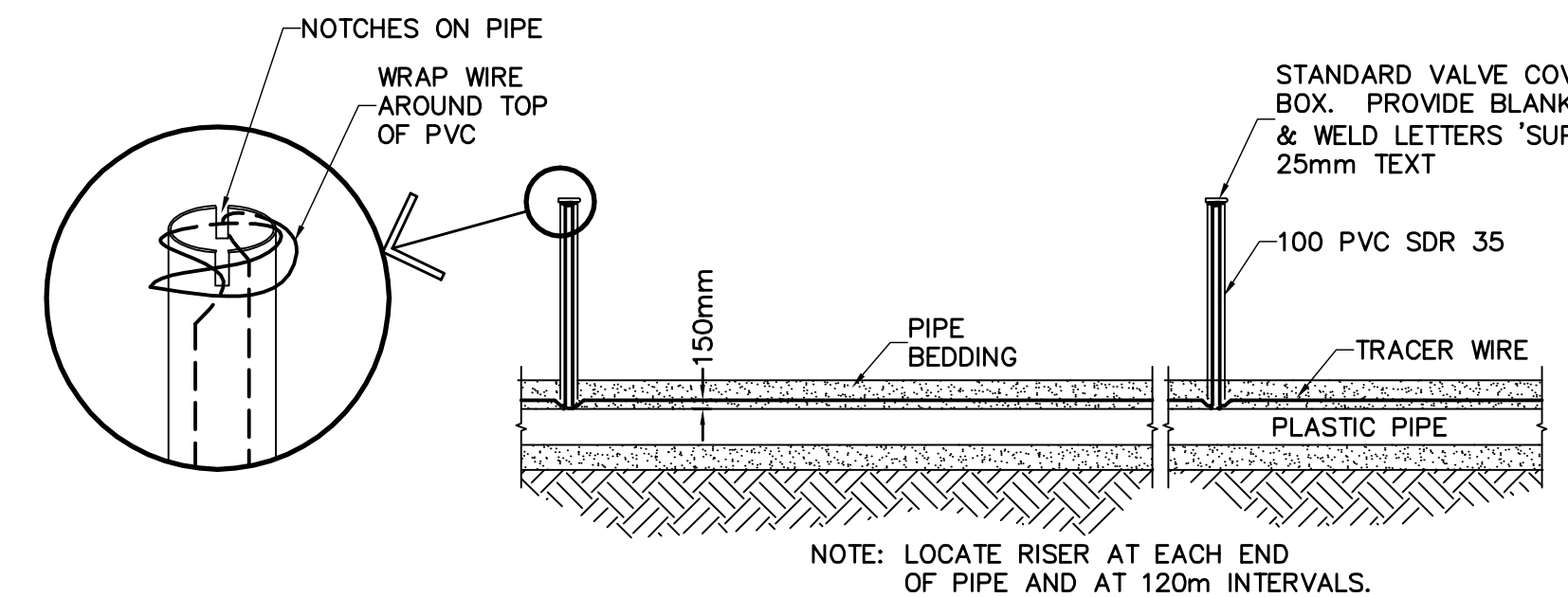

**1 TRACER WIRE DETAIL**  
 SCALE NTS

| COORDINATE TABLE                   |             |            |
|------------------------------------|-------------|------------|
| DESCRIPTION                        | NORTHING    | EASTING    |
| 750 CONNECTION STA. 1+02.104       | 5524054.091 | 647844.571 |
| 750x750x750 TEE STA. 1+08.524      | 5524057.486 | 647839.124 |
| 750-22.5" BEND STA. 1+39.200       | 5524031.455 | 647822.896 |
| 750-22.5" BEND STA. 1+69.994       | 5524001.078 | 647817.846 |
| 750-22.5" VERT. BEND STA. 1+73.676 | 5523997.613 | 647816.592 |
| 750 CONNECTION STA. 1+94.635       | 5523977.905 | 647809.460 |
| 750 CONNECTION TO 2100 OVERFLOW    | 5524061.189 | 647833.185 |
| 150 SLUDGE FM. 45" BEND            | 5524005.652 | 647819.417 |
| 150 SLUDGE FM. TEMP. PLUG          | 5524003.991 | 647820.531 |
| CONNECTION TO AQUEDUCT             | 5523979.197 | 647809.928 |

| JOINT RESTRAINTS   |           |          |
|--|-----------|----------|
| ALL JOINTS WITHIN THE FOLLOWING AREAS SHALL BE RESTRAINED WITH JOINTS RESTRAINT HARNESSSES |           |          |
| PIPE   | FROM STA. | TO STA.  |
| 150 SLUDGE FORCEMAIN   | 1+06.276  | 1+15.585 |
|  | 1+37.041  | 1+41.041 |
|  | 1+63.218  | 1+67.218 |
| 750 SUPERNATANT  | 1+35.200  | 1+43.200 |
|  | 1+65.994  | 1+82.256 |

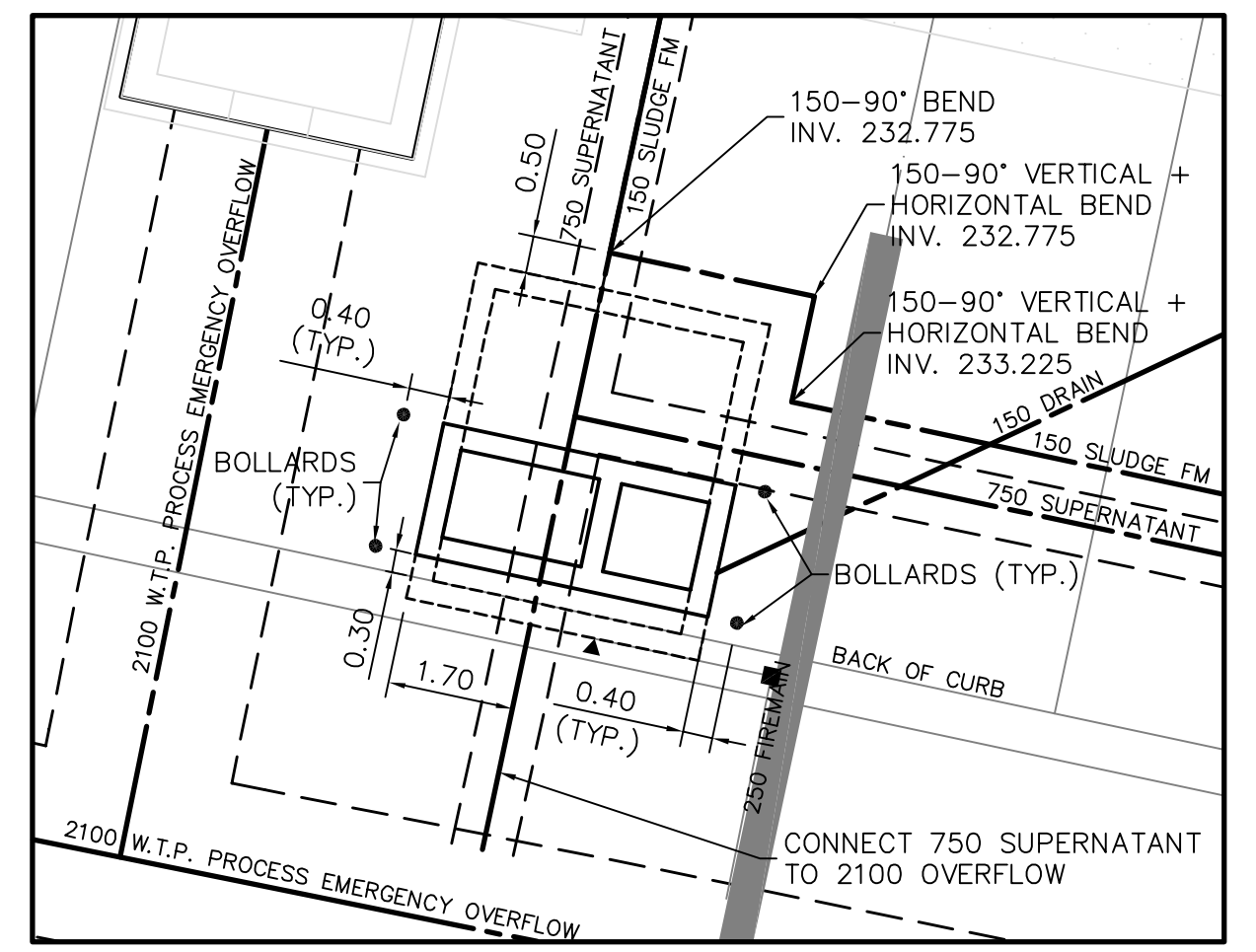
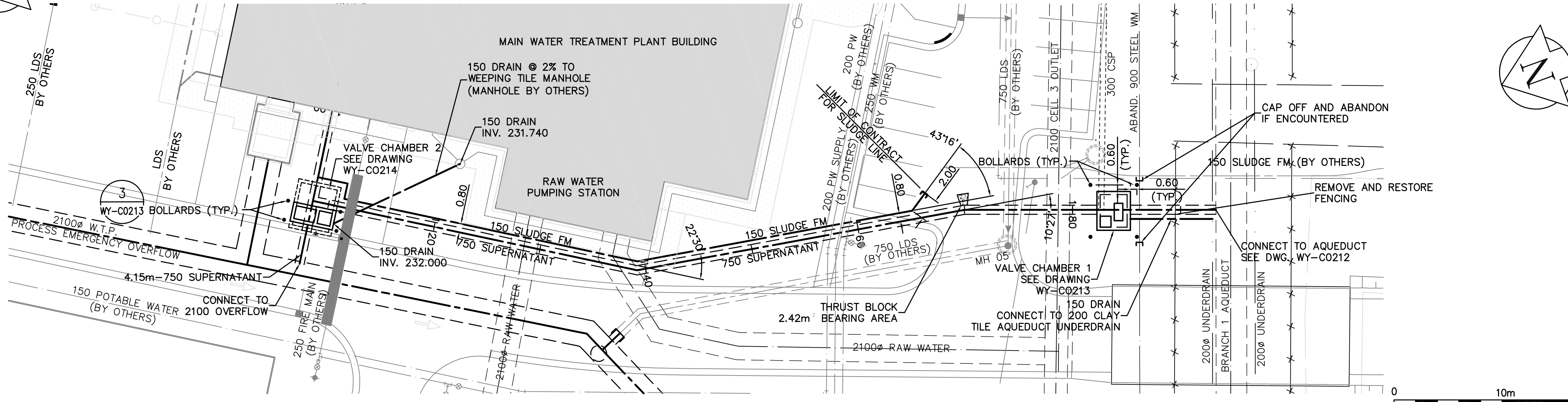
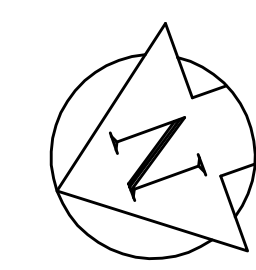

**VALVE CHAMBER 2 SITE DETAIL**  
 SCALE 1:100

| 150 mm W.W. | WATERMAIN   | 150 mm W.W. | HYDRO         | 200 mm W.W. | WATERMAIN | 200 mm W.W. | HYDRO         | 300 mm W.W. | WATERMAIN     | 300 mm W.W. | HYDRO      | 400 mm W.W. | WATERMAIN | 400 mm W.W. | HYDRO         | 500 mm W.W. | WATERMAIN         | 500 mm W.W. | HYDRO             | 600 mm W.W. | WATERMAIN     | 600 mm W.W. | HYDRO         | 750 mm W.W. | WATERMAIN | 750 mm W.W. | HYDRO         | 1000 mm W.W. | WATERMAIN     | 1000 mm W.W. | HYDRO    | 1500 mm W.W. | WATERMAIN     | 1500 mm W.W. | HYDRO         |   |          |
|-------------|-------------|-------------|---------------|-------------|-----------|-------------|---------------|-------------|---------------|-------------|------------|-------------|-----------|-------------|---------------|-------------|-------------------|-------------|-------------------|-------------|---------------|-------------|---------------|-------------|-----------|-------------|---------------|--------------|---------------|--------------|----------|--------------|---------------|--------------|---------------|---|----------|
| ---         | WATERMAIN   | ---         | HYDRO         | ---         | WATERMAIN | ---         | HYDRO         | ---         | WATERMAIN     | ---         | HYDRO      | ---         | WATERMAIN | ---         | HYDRO         | ---         | WATERMAIN         | ---         | HYDRO             | ---         | WATERMAIN     | ---         | HYDRO         | ---         | WATERMAIN | ---         | HYDRO         | ---          | WATERMAIN     | ---          | HYDRO    | ---          | WATERMAIN     | ---          | HYDRO         |   |          |
| +           | HYDRANT     | +           | M.T.S.        | +           | CONCRETE  | +           | ASPHALT       | +           | PROPERTY LINE | +           | SURVEY BAR | +           | ELEVATION | +           | TREE          | +           | ANODE             | +           | CONCRETE SIDEWALK | +           | FENCE         | +           | LEGEND - PLAN | +           | PROPOSED  | +           | EXISTING      | +            | LEGEND - PLAN | +            | PROPOSED | +            | EXISTING      | +            | LEGEND - PLAN | + | PROPOSED |
| o           | VALVE       | o           | CONCRETE      | o           | ASPHALT   | o           | PROPERTY LINE | o           | SURVEY BAR    | o           | ELEVATION  | o           | TREE      | o           | ANODE         | o           | CONCRETE SIDEWALK | o           | FENCE             | o           | LEGEND - PLAN | o           | PROPOSED      | o           | EXISTING  | o           | LEGEND - PLAN | o            | PROPOSED      | o            | EXISTING | o            | LEGEND - PLAN | o            | PROPOSED      |   |          |
| o           | MANHOLE     | o           | CONCRETE      | o           | ASPHALT   | o           | PROPERTY LINE | o           | SURVEY BAR    | o           | ELEVATION  | o           | TREE      | o           | ANODE         | o           | CONCRETE SIDEWALK | o           | FENCE             | o           | LEGEND - PLAN | o           | PROPOSED      | o           | EXISTING  | o           | LEGEND - PLAN | o            | PROPOSED      | o            | EXISTING | o            | LEGEND - PLAN | o            | PROPOSED      |   |          |
| o           | CATCH BASIN | o           | CONCRETE      | o           | ASPHALT   | o           | PROPERTY LINE | o           | SURVEY BAR    | o           | ELEVATION  | o           | TREE      | o           | ANODE         | o           | CONCRETE SIDEWALK | o           | FENCE             | o           | LEGEND - PLAN | o           | PROPOSED      | o           | EXISTING  | o           | LEGEND - PLAN | o            | PROPOSED      | o            | EXISTING | o            | LEGEND - PLAN | o            | PROPOSED      |   |          |
| o           | CURB INLET  | o           | CONCRETE      | o           | ASPHALT   | o           | PROPERTY LINE | o           | SURVEY BAR    | o           | ELEVATION  | o           | TREE      | o           | ANODE         | o           | CONCRETE SIDEWALK | o           | FENCE             | o           | LEGEND - PLAN | o           | PROPOSED      | o           | EXISTING  | o           | LEGEND - PLAN | o            | PROPOSED      | o            | EXISTING | o            | LEGEND - PLAN | o            | PROPOSED      |   |          |
| o           | JUNCTIONS   | o           | CONCRETE      | o           | ASPHALT   | o           | PROPERTY LINE | o           | SURVEY BAR    | o           | ELEVATION  | o           | TREE      | o           | ANODE         | o           | CONCRETE SIDEWALK | o           | FENCE             | o           | LEGEND - PLAN | o           | PROPOSED      | o           | EXISTING  | o           | LEGEND - PLAN | o            | PROPOSED      | o            | EXISTING | o            | LEGEND - PLAN | o            | PROPOSED      |   |          |
| o           | CULVERT     | o           | CONCRETE      | o           | ASPHALT   | o           | PROPERTY LINE | o           | SURVEY BAR    | o           | ELEVATION  | o           | TREE      | o           | ANODE         | o           | CONCRETE SIDEWALK | o           | FENCE             | o           | LEGEND - PLAN | o           | PROPOSED      | o           | EXISTING  | o           | LEGEND - PLAN | o            | PROPOSED      | o            | EXISTING | o            | LEGEND - PLAN | o            | PROPOSED      |   |          |
| o           | GAS         | o           | CONCRETE      | o           | ASPHALT   | o           | PROPERTY LINE | o           | SURVEY BAR    | o           | ELEVATION  | o           | TREE      | o           | ANODE         | o           | CONCRETE SIDEWALK | o           | FENCE             | o           | LEGEND - PLAN | o           | PROPOSED      | o           | EXISTING  | o           | LEGEND - PLAN | o            | PROPOSED      | o            | EXISTING | o            | LEGEND - PLAN | o            | PROPOSED      |   |          |
| o           | EXISTING    | o           | LEGEND - PLAN | o           | PROPOSED  | o           | EXISTING      | o           | LEGEND - PLAN | o           | PROPOSED   | o           | EXISTING  | o           | LEGEND - PLAN | o           | PROPOSED          | o           | EXISTING          | o           | LEGEND - PLAN | o           | PROPOSED      | o           | EXISTING  | o           | LEGEND - PLAN | o            | PROPOSED      | o            | EXISTING | o            | LEGEND - PLAN | o            | PROPOSED      |   |          |

**APECA**  
 Certificate of Authorization  
 Earth Tech Canada Inc.  
 No. 730 Expiry: April 30, 2007

B.M. ELEV.

|     |                   |          |     |
|-----|-------------------|----------|-----|
| 00  | ISSUED FOR TENDER | 07/01/26 | GSK |
| NO. | REVISIONS         | DATE     | BY  |

**CH2M HILL**  
 Frederickson Cooper  
 ARCHITECTS

**EarthTech**  
 A Tyco International Ltd. Company

|             |                       |                               |               |
|-------------|-----------------------|-------------------------------|---------------|
| DESIGNED BY | GSK                   | CHECKED BY                    | KF            |
| DRAWN BY    | JBC                   | APPROVED BY                   | AHL           |
| SCALE:      | 1:250 HOR<br>1:50 VER | RELEASED FOR CONSTRUCTION BY: | R. SOROKOWSKI |
| DATE        | 2005/11/21            | DATE                          | 2006/01/26    |

ENGINEER'S SEAL

ORIGINAL SIGNED BY  
 F.W. FITCHETT

2007/01/26

CONSULTANT DRAWING NO.  
 WY-C0211

**THE CITY OF WINNIPEG**  
 WATER AND WASTE DEPARTMENT  
 ENGINEERING DIVISION

WATER TREATMENT PLANT  
 WTP OVERFLOW SUPERNATANT LINE

CIVIL  
 750 SUPERNATANT LINE / 150 SLUDGE FORCEMAIN  
 WTP MAIN BUILDING TO AQUEDUCT

CITY FILE NUMBER

SHEET OF

CITY DRAWING NUMBER  
 1-0601Y-C-0211-001-000

2007/01/26

CONSULTANT DRAWING NO.  
 WY-C0211