

S1

1
WS-S0201

S2

5
WS-S0201

8
WS-S0203

7
WS-S0202

3
WS-S0202

S4

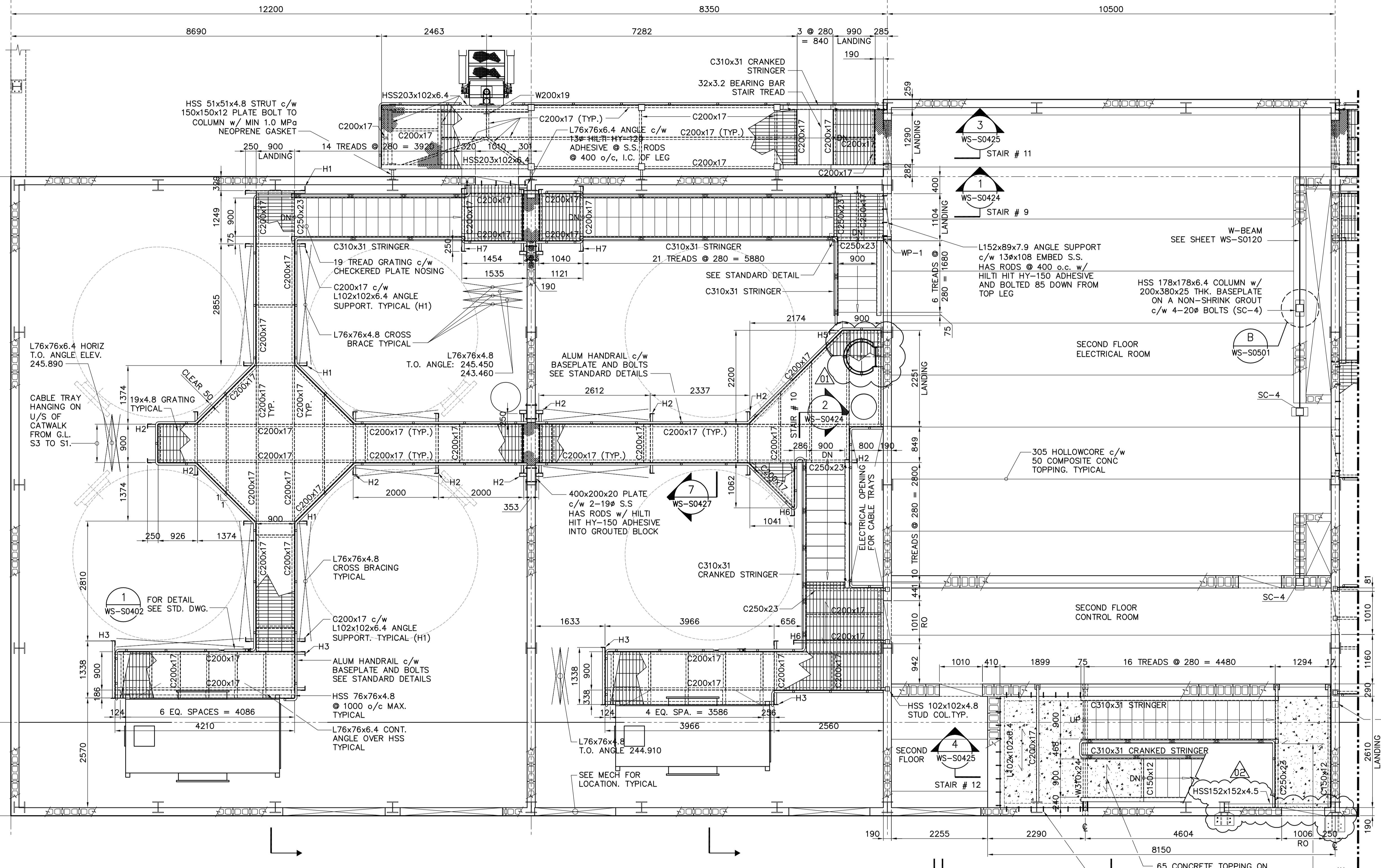

PARTIAL PLAN VIEW - CATWALK # 1
1:50

DESIGN LOADS:

1. DEAD LOADS:	.1) STRUCTURE SELF WEIGHT	0.5 kPa
	.2) ELECT CABLE TRAY AS NOTED SEE THIS PLAN	3.0 kN/m
2. LIVE LOADS	.1) OCCUPANCY	4.8 kPa

- DRAWING NOTES:**
- COORDINATE REQUIREMENTS OF CATWALK AND MECHANICAL EQUIPMENT WITH JOIST SUPPLIER.
 - FOR PIPE LOCATION AND PENETRATION SEE MECHANICAL.
 - REFER TO DRAWINGS WS-S0425 TO WS-S0427 FOR STAIR DETAIL.
 - REFER TO WS-S0402 FOR REMOVABLE GUARDRAIL FOR CATWALK.
 - FOR HANGER SUPPORT DETAILS AND BRACKETS SEE DWG. WS-S0128

NOTE:
ALL STAIR STRINGERS REVISED TO C310x31

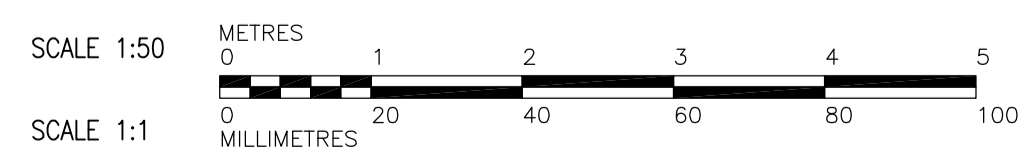

B.M. ELEV.		CH2M HILL Frederickson Cooper ARCHITECTS		EarthTech A Type International Ltd. Company	
DESIGNED BY	ARA	CHECKED BY	AP	ENGINEER'S SEAL	
DRAWN BY	WDB	APPROVED BY	AHL	ORIGINAL SIGNED BY A. POCHANART 2007/01/31	
SCALE:	AS NOTED	RELEASED FOR CONSTRUCTION BY:	R. SOROKOWSKI	CONSULTANT DRAWING NO. WS-S0126	
NO. REVISIONS	DATE	BY	DATE	2006/09/10	

THE CITY OF WINNIPEG
WATER AND WASTE DEPARTMENT
ENGINEERING DIVISION

WATER TREATMENT PLANT
BULK CHEMICAL BUILDING
SODIUM HYPOCHLORITE AND CHEMICAL STORAGE BUILDING

STRUCTURAL
PARTIAL CATWALK STAIRS AND PLATFORMS PLAN

CITY FILE NUMBER
SHEET OF
CITY DRAWING NUMBER
1-06015-A-S0126-001-02D