

DWG NORTH

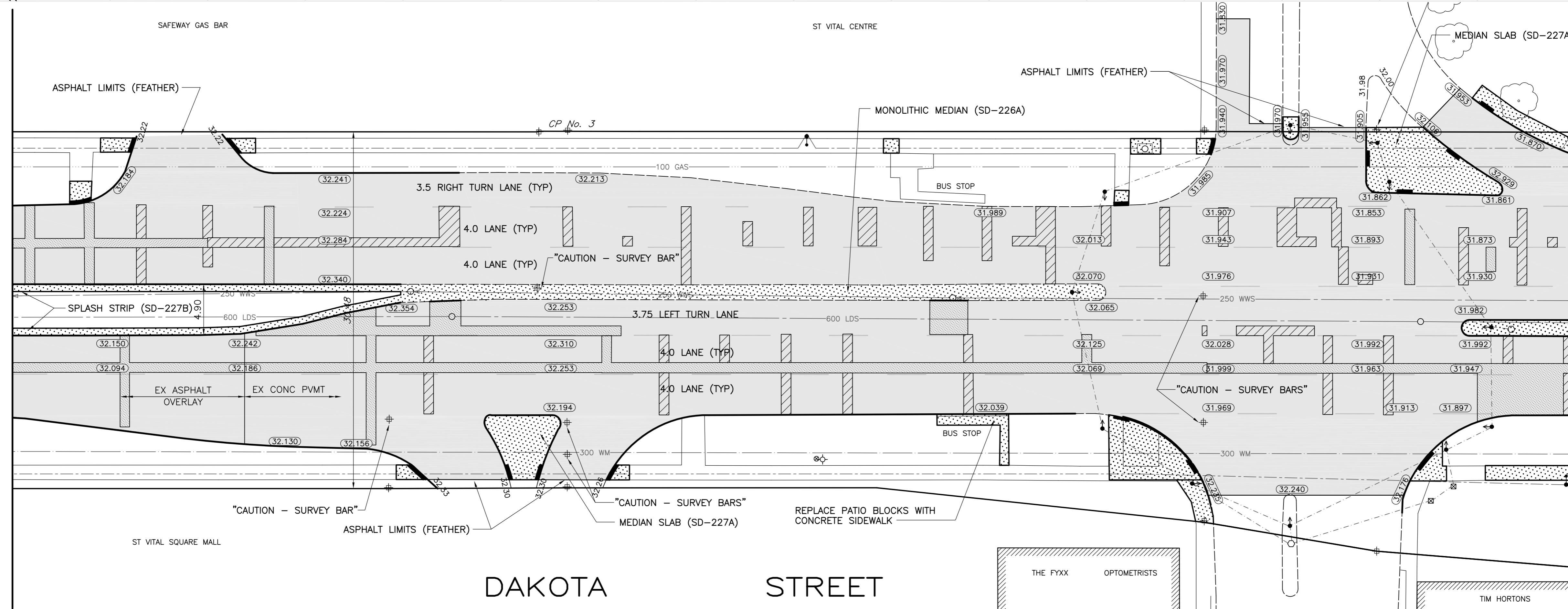
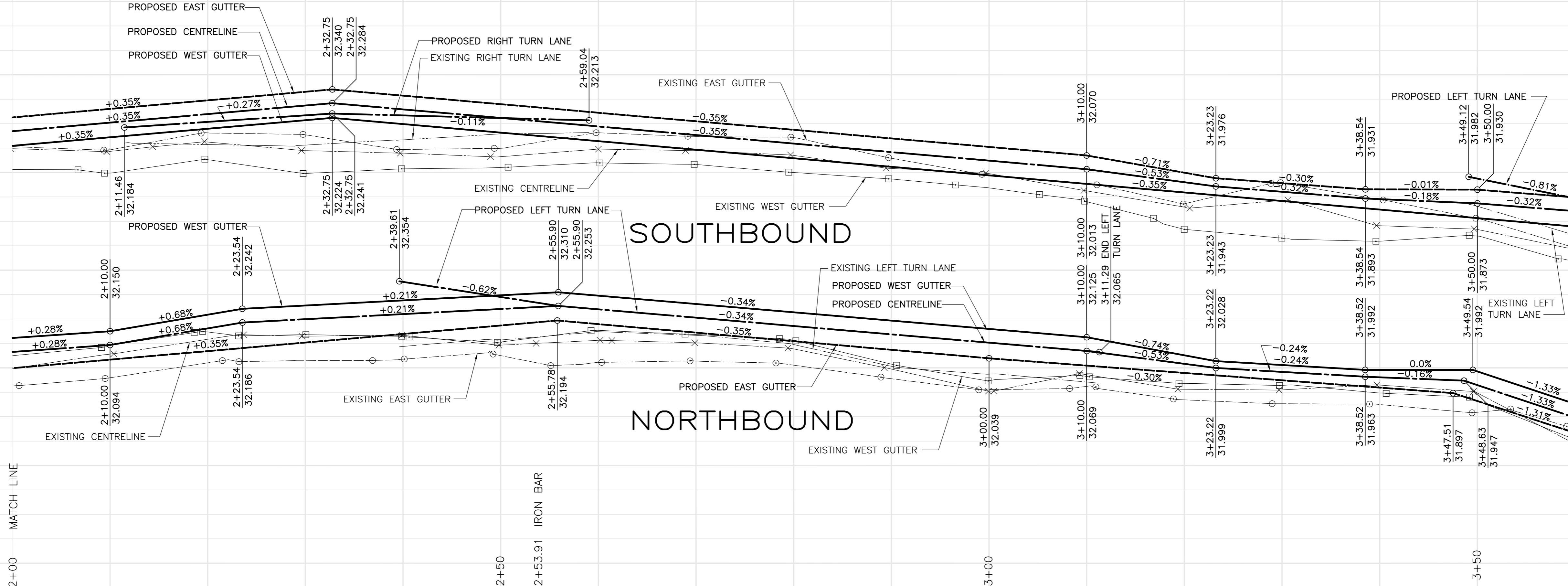
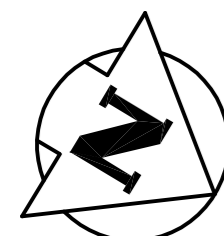

DAKOTA STREET

APEGM
 Certificate of Authorization
 Wardrop Engineering Inc.
 No. 195 Expiry: April 30, 2007

150 WM	WATERMAIN	150 WM	○	MANHOLE	●	GAS	—
400 FM	FEEDERMAIN	400 FM	□	CATCHBASIN	■	HYDRO	—
300 LDS	LAND DRAINAGE SEWER	300 LDS	▽	CURB INLET	▼	MTS	—
250 WWS	WASTEWATER SEWER	250 WWS	•	HYDRO POLE	○	SIGNALS MANHOLE	—
300 CS	COMBINED SEWER	300 CS	••	LIGHT STANDARD	×31.175	ELEVATION	(32.000)
200 FCM	FORCEMAIN	200 FCM	←	ANCHOR	—	SIDEWALK	—
JUNCTIONS			⊕	TREE	—	CURB	—
HYDRANT		15.240	⊕	LEGAL DIMENSION	—	ASPHALT	—
VALVE			⊕	SURVEY BAR	—	CONCRETE	—
CURB STOP			⊕	TRAFFIC SIGNAL	—	MILLING/PATCHING	—
EXISTING	LEGEND-PLAN	PROPOSED	EXISTING	LEGEND-PLAN	PROPOSED	EXISTING	LEGEND-PLAN

LOCATION APPROVED UNDERGROUND STRUCTURES

SUPV. U/G STRUCTURES	DATE
COMMITTEE	

NOTE:
 LOCATION OF UNDERGROUND STRUCTURES AS SHOWN ARE BASED ON THE BEST INFORMATION AVAILABLE. BUT NO GUARANTEE IS GIVEN THAT ALL EXISTING UTILITIES ARE SHOWN OR THAT THE GIVEN LOCATIONS ARE EXACT. CONFIRMATION OF EXISTENCE AND EXACT LOCATION OF ALL SERVICES MUST BE OBTAINED FROM THE INDIVIDUAL UTILITIES BEFORE PROCEEDING WITH CONSTRUCTION.

B.M. ELEV.	F.B. 2153		
00	ISSUED FOR TENDER	07.03.06	DAL
A	ISSUED FOR APPROVAL	07.02.19	DAL
NO.	REVISIONS	DATE	BY

WARDROP Engineering Inc.

DESIGNED BY	DAL	CHECKED BY	
DRAWN BY	GMD	APPROVED BY	
HOR. SCALE:	1 : 250	RELEASED FOR CONSTRUCTION	
VERTICAL:	1 : 10	DATE	06.12.04

PROVINCE OF MANITOBA
W.J. FUNK
 REGISTERED ENGINEER
 CONSULTANT DRAWING NO.
 0700070300-DWG-C0002-00

THE CITY OF WINNIPEG
 PUBLIC WORKS DEPARTMENT
 ENGINEERING DIVISION

CONCRETE PAVEMENT REPAIRS & ASPHALT OVERLAY

DAKOTA STREET
 100m NORTH OF MEADOWOOD DRIVE TO
 260m NORTH OF MEADOWOOD DRIVE

CITY DRAWING NUMBER
P-3275-2
 SHEET OF
 2 OF 5
C0002