

1 MAIN FLOOR RENOVATION PLUMBING PLAN  
SCALE: 1:100

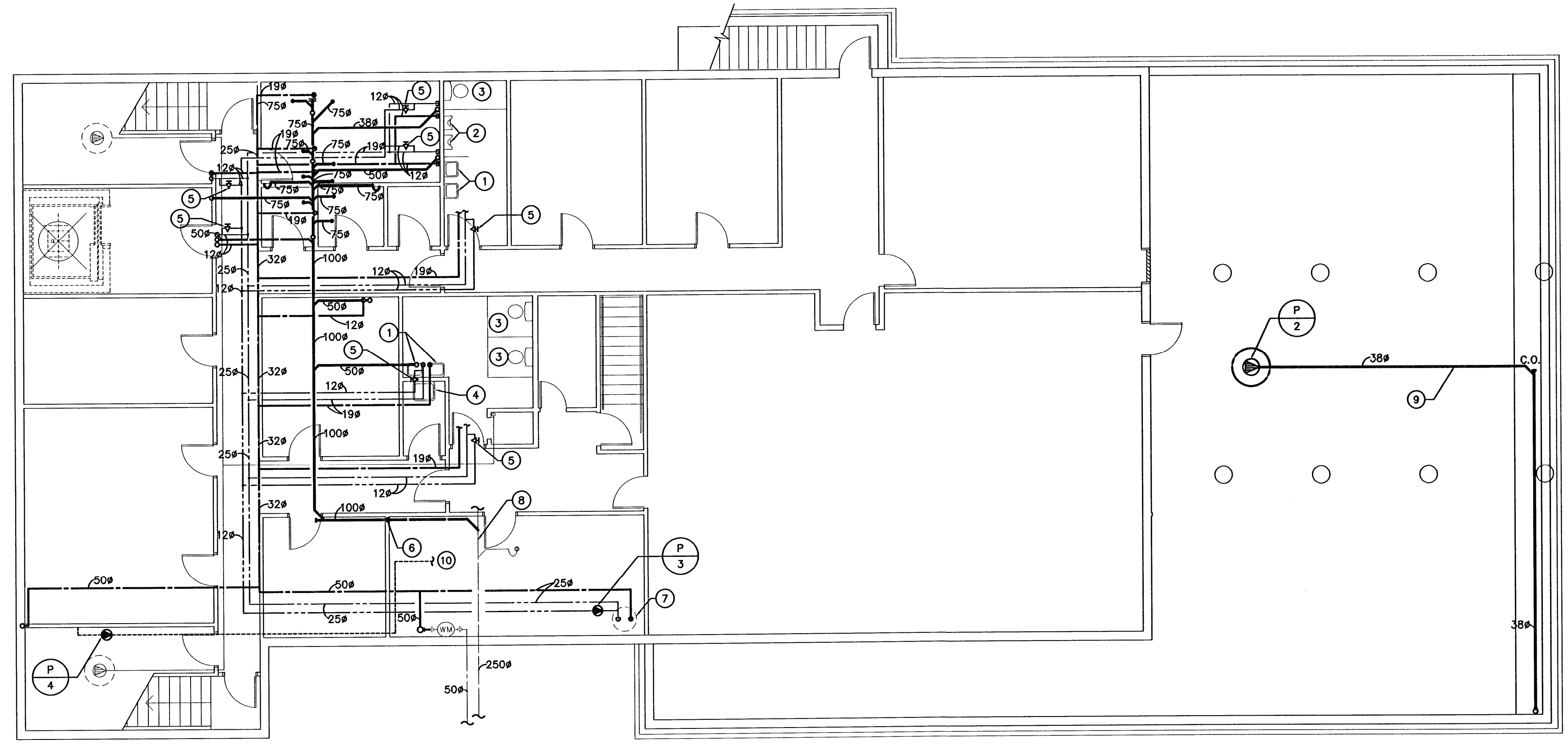

2 BASEMENT FLOOR RENOVATION PLUMBING PLAN  
SCALE: 1:100

LEGEND

---	NEW VENT LINE
---RWL---	NEW STORM WATER LINE
---	NEW SANITARY BELOW GRADE
---	NEW COLD WATER LINE
---	NEW HOT WATER LINE
---	NEW HOT WATER RECIRC. LINE
---	CLEAN OUT

MAIN FLOOR GENERAL NOTES:

1. THIS DRAWING IS DIAGRAMMATIC ONLY. ALL FINAL PLUMBING LOCATIONS TO BE COORDINATED ON SITE BY MECHANICAL CONTRACTOR.

MAIN FLOOR DRAWING NOTES:

- ① RELOCATED BARRIER FREE WATER CLOSET TO BE REINSTALLED. RECONNECT SERVICES AS SHOWN.
- ② RELOCATED MOP SINK TO BE REINSTALLED. RECONNECT SERVICES AS SHOWN.
- ③ NEW WALL HUNG URINAL. RECONNECT SERVICES AS SHOWN.
- ④ NEW STAINLESS STEEL COUNTER MOUNTED LAVATORIES. RECONNECT SERVICES AS SHOWN.
- ⑤ RELOCATED THREE COMPARTMENT SINK. RECONNECT SERVICES AS SHOWN.
- ⑥ RELOCATED WATER CLOSET TO BE REINSTALLED. RECONNECT SERVICES TO CODE.
- ⑦ PROVIDE 150X150 TRANSFER AIR GRILLES AT HIGH AND LOW LOCATIONS ON ARCHITECTURAL ENCLOSURE.
- ⑧ 150# RWL TO DROP DOWN IN ARCHITECTURAL ENCLOSURE TO SPLASH PAD.
- ⑨ SPLASH PAD BY GENERAL CONTRACTOR.
- ⑩ NEW FLOOR MOUNTED FLUSH TANK WATER CLOSET.
- ⑪ NEW MALE CAM LOCK CONNECTOR.
- ⑫ NEW WEEPING TILE PIT DISCHARGE TO RISE UP IN WALL TO SPLASH PAD. SPLASH PAD BY GENERAL CONTRACTOR.

PLUMBING SPECIFICATION

- (RD)** FLOOR DRAINS - FINISHED AREAS (ROUND STRAINER)  
SMITH SERIES 2005A-PO50 FLOOR DRAIN, ALL DUCCO COATED CAST IRON BODY, REVERSIBLE FLASHING CLAMP WITH SEEPAGE OPENINGS AND ADJUSTABLE 5" (127MM) DIAMETER NICKEL BRONZE 1/4" (6.35MM) THICK STRAINER, SECURED WITH S.S. SCREWS, 4" (100MM) THROAT ON STRAINER, TRAP PRIMER CONNECTION.
- (UR)** URINAL - WALL HUNG EXPOSED FLUSH VALVE - HARD-WIRED ELECTRONIC 'NO TOUCH' UNIT  
AMERICAN STANDARD #6501.010 'WASHROOM' LOW CONSUMPTION URINAL, WALL HUNG, VITREOUS CHINA, WASHDOWN FLUSH ACTION 3.8L (1.0 GAL) FLUSH, EXTENDED SIDES FOR PRIVACY, INTEGRAL FLUSH SPREADER, OUTLET CONNECTION, LESS STRAINER, 3/4" (19MM) TOP SPUD, WALL HANGERS, OPEN TRAP, FOR USE WITH FLUSH VALVE. AMERICAN STANDARD #4070S-0070A STRAINER, REMOVABLE STAINLESS STEEL, 2" (50MM) OUTLET, CONNECTING FLANGE WITH GASKET AND BOLTS. SLOAN #186-0.5 ES-S 'REGAL OPTIMA' ELECTRONIC 'NO-TOUCH' FLUSH VALVE UNIT, C.P. LOW CONSUMPTION, 1.9 LPF (1.0 GPF) FACTORY SET FLOW, QUIET ACTION, DIAPHRAGM TYPE, WITH FILTERED BY-PASS INFRARED PROXIMITY SENSOR, SOLENOID FLUSH CONTROLLER, CIRCUITRY, IN S.S. WALL ACCESS PLATE, VACUUM BREAKER AND BACK-CHECK ANGLE STOP. (PROVIDE 4" (102MM) SQ. ELECT. BOX - IN-WALL FOR SENSOR MOUNTING). JAY R. SMITH #S04-1819 URINAL WALL ACCESS CLEANOUT, WITH ROUND STAINLESS STEEL FACE AND V.P. SCREW. JAY R. SMITH #0637 URINAL CARRIER, WITH STEEL PIPE LEGS, BLOCK BASE FEET SUPPORTS AND BEARING PLATES.
- (RD)** ROOF DRAIN  
ZURN SERIES MODEL # Z-10015 ROOF DRAIN, DURA-COATED CAST IRON BODY WITH COMBINATION MEMBRANE FLASHING CLAMP/GRAVEL GUARD AND POLY-DOME.
- (VF)** DRINKING FOUNTAINS HI-LO - DOUBLE UNIT - WALL HUNG BEVELED FRONT S.S. (BARRIER FREE DESIGN & GENERAL USE)  
HANS #1119 HI-LO FOUNTAINS, WALL HUNG, DUAL UNITS, STAINLESS STEEL, 18 GAUGE (1.2MM) WITH #4 SATIN FINISH, BEVELED FRONT 18" (457MM) RECEPTORS, LEAD-FREE, 'SOFT TOUCH VALVE' FORGED BRASS CONTROL BUBBLER HEADS, SELF CLOSING VALVES, AUTOMATIC VOLUME REGULATORS, 100 MICRON IN-LINE FILTER, VANDAL-RESISTANT OPEN GRID STRAINER, TAILPIECE, #8700.4 MOUNTING PLATE, AND S.S. COVER PLATE. MCGUIRE #8872C 'P' TRAPS, C.P. POLISHED, CAST BRASS 1 1/4" (32MM) WITH CLEANOUTS AND ESCUTCHEONS. SMITH SERIES #0823-2 CARRIER, WITH STEEL PIPE LEGS, BLOCK BASE FEET SUPPORT AND DOUBLE PLATE.
- (WC)** TOILET - FLOOR MOUNTED PRESSURE-ASSIST TANK (BARRIER FREE DESIGN)  
AMERICAN STANDARD 'CADET ELONGATED 16-1/2" (420MM) HIGH' #2377.100 'PRESSURE-ASSIST LOW CONSUMPTION' TANK TOILET, FLOOR MOUNTED, VITREOUS CHINA, ELONGATED SIPHON JET FLUSH ACTION BOWL, FULLY GLAZED 2" (50MM) BALL PASS INTERNAL TRAP WAY, 10" X 12" (254MM X 304MM) LARGE WATER SURFACE, 'SPEED CONNECT' P.A. TANK COMPLETE, 1.3 GAL. (5L) FLUSH, WITH CAST SANITARY GUARD ON BOWL FOR CHINA TO CHINA TANK ASSEMBLY, BOLT CAPS. PROVIDE FLOOR FLANGE, FLANGE BOLTS AND GASKET, CENTICO #2025TS SEAT, ELONGATED HEAVY DUTY SOLID PLASTIC OPEN FRONT WITH COVER, STAINLESS STEEL CHECK HINGE, POSTS, WASHERS AND NUTS, MCGUIRE #H172BV SUPPLY, C.P., POLISHED, RIGID HORIZONTAL INTEGRAL SWEAT TUBE WITH V.P. COMBINATION WHEEL HANDLE/LOOSE KEY BALL VALVE ANGLE STOP, ESCUTCHEON AND FLEXIBLE RISER.
- (LV)** BASIN - COUNTER MOUNTED (STAINLESS STEEL)(HARD-WIRED ELECTRONIC 'NO TOUCH' FAUCET) (RECESSED BOX)  
FRANKE 'WASHROOM SYSTEMS' #0V1821-5-1 BASIN, CENTER HOLE, 21" X 18" X 5" (530MM X 460MM X 127MM) DEEP, COUNTER MOUNTED, GRADE 18-10 TYPE 304 STAINLESS STEEL, FRONT OVERFLOW, MIRROR FINISHED RIM, SATIN FINISHED BOWL, SELF-RIMMING-SLOAN #ET-700-FC-VFB-MIX70-A 'OPTIMA' ELECTRONIC 'NO TOUCH' FAUCET, C.P. SINGLE HOLE C.C., SOLID CAST BRASS GOOSENECK SPOUT WITH INTEGRAL PROXIMITY SENSOR, WITH INTEGRAL 7.8 LPM (2.0 GPM) LAMINAR (NON AERATING) FLOW OUTLET, CONTROL MODULE, SOLENOID, STRAINER, TEMPERED WATER SUPPLIED BY THERMOSTATIC MIXING VALVE WITH BACK CHECK AND STOPS HOUSED IN 12" (305MM) SQ. RECESSED METAL BOX WITH 13" (330MM) SQ. V.P., S.S. FACE, LOCATED IN WALL UNDER BASIN, FLEXIBLE CONDUIT TO FAUCET AND SOLENOID PROVIDED. SLOAN #EL-154 120/24VAC SOVA TRANSFORMER (15VA POWER REQUIRED FOR EACH FAUCET). MCGUIRE #155A BASIN DRAIN, CHROME PLATED, CAST BRASS 1 PC. TOP, OPEN GRID WITH 17GA. (1.5MM), 1-1/4" (32MM) TAILPIECE. PROVIDE S.S. BRAIDED SUPPLY WITH ESCUTCHEON (CONNECTING BOX TO FAUCET). MCGUIRE #8872C-17T 'P' TRAP, C.P. BRASS ADJUSTABLE BODY, 17 GAUGE (1.5MM), 1-1/4" (32MM) AND ESCUTCHEON.
- (LV)** BASIN - COUNTER MOUNTED BARRIER FREE (STAINLESS STEEL)(HARD-WIRED ELECTRONIC 'NO TOUCH' FAUCET) (EXPOSED MODULE)  
FRANKE 'WASHROOM SYSTEMS' #0V1721A-3MO BASIN, 4" (102MM) CENTRES, 21" X 18" X 5" (530MM X 460MM X 127MM) DEEP, COUNTER MOUNTED, GRADE 18-10 TYPE 304 STAINLESS STEEL, FRONT OVERFLOW, MIRROR FINISHED RIM, SATIN FINISHED BOWL, SELF-RIMMING-SLOAN #ET-600-A-MIX70-A 'OPTIMA' ELECTRONIC 'NO TOUCH' FAUCET, C.P. 4" (102MM) C.C., SOLID CAST BRASS BODY WITH INTEGRAL PROXIMITY SENSOR, WITH VANDAL-RESISTANT 1.9 LPM (0.5 GPM) FLOW SPRAY OUTLET, CONTROL MODULE, SOLENOID, STRAINER, CIRCUITRY, HOUSED IN EXPOSED METAL BOX MODULE LOCATED UNDER BASIN. TEMPERED WATER SUPPLIED BY THERMOSTATIC MIXING VALVE WITH BACK CHECKS AND STOPS LOCATED UNDER MODULE. PROVIDE TEE, ADAPTORS AND FLEX. COPPER TUBING TO SUIT. FLEXIBLE CONDUIT FROM CONTROL MODULE TO FAUCET AND SOLENOID PROVIDED. (PROVIDE TEE, ADAPTORS AND FLEXIBLE COPPER TUBING TO SUIT). SLOAN #EL-154 120/24VAC SOVA TRANSFORMER (15VA POWER REQUIRED FOR EACH FAUCET). MCGUIRE #155WC BASIN DRAIN, C.P., CAST BRASS IPC, TOP, OFFSET OPEN GRID WITH 17GA. (1.5MM), 1-1/4" (32MM) TAILPIECE. MCGUIRE #H170BVR-LR BASIN SUPPLIES, C.P., POLISHED BRASS, RIGID HORIZONTAL INTEGRAL COPPER SWEAT TUBE NIPPLE, 1/2" (12MM) I.D. X 5" (127MM) LONG, ALL BRASS 1/4 TURN BALL VALVE ANGLE STOP WITH COMBINATION V.P. LOOSE KEY AND HANDLE, ESCUTCHEON LESS S.S. BRAIDED FLEXIBLE RISERS. MCGUIRE #8872C-17T 'P' TRAP, C.P. BRASS ADJUSTABLE BODY, 17 GAUGE (1.5MM), 1-1/4" (32MM) AND ESCUTCHEON. MCGUIRE #W2000WC 'PROWRAP' SANITARY COVERING, OF PVC, VANDAL-RESISTANT FLEXIBLE SEAMLESS CONSTRUCTION, ANTI-MICROBIAL TO EXPOSED PIPING (TO PROTECT AGAINST HEAT/CONTUSIONS) AS PER LOCAL CODES.

BASEMENT GENERAL NOTES:

1. THIS DRAWING IS DIAGRAMMATIC ONLY. ALL FINAL PLUMBING LOCATIONS TO BE COORDINATED ON SITE BY MECHANICAL CONTRACTOR.

BASEMENT DRAWING NOTES:

- ① EXISTING LAVATORY. MODIFY/EXTEND EXISTING PLUMBING LINES TO ACCOMMODATE NEW SUPPLY LINE LAYOUT.
- ② EXISTING URINAL. MODIFY/EXTEND EXISTING PLUMBING LINES TO ACCOMMODATE NEW SUPPLY LINE LAYOUT.
- ③ EXISTING WATER CLOSET. MODIFY/EXTEND EXISTING PLUMBING LINES TO ACCOMMODATE NEW SUPPLY LINE LAYOUT.
- ④ EXISTING MOP SINK. MODIFY/EXTEND EXISTING PLUMBING LINES TO ACCOMMODATE NEW SUPPLY LINE LAYOUT.
- ⑤ NEW BALANCING VALVE (0.5 GPM). TYPICAL OF ALL.
- ⑥ NEW 100# SANITARY LINE TO DROP DOWN AND CONNECT TO EXISTING SANITARY LINE UNDER SLAB. MECHANICAL CONTRACTOR TO COORDINATE SCANNING OF FLOOR FOR EXACT LOCATION OF EXISTING SANITARY LINE.
- ⑦ EXISTING HOT WATER TANK.
- ⑧ NEW 100# SANITARY LINE TO CONNECT TO EXISTING SANITARY LINE BELOW SLAB @ THIS APPROXIMATE LOCATION. MECHANICAL CONTRACTOR TO COORDINATE SCANNING OF FLOOR FOR EXACT LOCATION OF EXISTING SANITARY LINE.
- ⑨ NEW WEEPING TILE PIT TO CONNECT TO NEW MITSUBISHI TIE AROUND ELEVATOR SHAFT. SEE DETAIL #8/M-4.
- ⑩ PUMPED CONDENSATE LINE FOR NEW MITSUBISHI UNIT IN COMPUTER ROOM. MECHANICAL CONTRACTOR TO COORDINATE FINAL PIPE ROUTING ON SITE.

- 3 ISSUED FOR TENDER SR 2007.11.14
- 2 ISSUED FOR 100% REVIEW DG 2007.07.06
- 1 ISSUED FOR 99% REVIEW DG 2007.06.29

revisions

This drawing must not be scaled.

The general Contractor must verify all dimensions, details and levels prior to commencement of work. All errors and omissions must be reported immediately to the Architect.

Variations and modifications to work shown on this drawing shall not be carried out without written permission from the Architect.

This drawing is the exclusive property of the Architect and cannot be reproduced without written permission of the Architect. Reconstruction must bear the name of the Architect. Copyright © 2006.

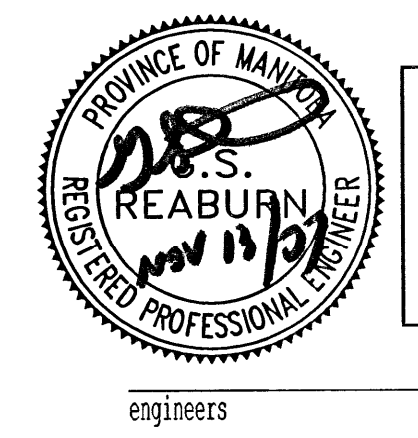

**APECA**  
Certificate of Authorization  
MCWAGE Consulting  
Professional Engineers  
No. 589 Expiry: April 30, 2008

**MCW / AGE**  
Consulting Professional Engineers  
210-1821 Wellington Avenue  
Winnipeg, Manitoba R3H 0G4  
Phone: (204) 778-2909 Fax: (204) 778-1119  
E-Mail: mcw\_age@mcw-ages.com

architect  
**HAROLD FUNK ARCHITECT INC.**  
#320-55 Donald Street  
Winnipeg, Manitoba  
Canada R3C 1J8  
Tel: 204 943 5087  
Fax: 204 949 9271  
E-mail: funkarch@chnts.net

project  
**VALOUR COMMUNITY CENTRE  
GYMNASIUM ADDITION AND  
RENOVATIONS**  
715 Telfer St. North, Winnipeg, Manitoba

sheet title  
**MAIN & BASEMENT  
PLUMBING RENOVATION  
LAYOUT**  
project no. 5603 sheet no.  
scale :AS SHOWN  
drawn by: RK  
approved by: SR  
date July 6, 2007

M-2