

WATER SERVICE INFORMATION				
ADDRESS	SIZE(mm) & TYPE (STREET)	SIZE(mm) & TYPE (PRDP)	SHORT & LONG MEASUREMENT	CORP. LOCATION
300 EDWARD AVE E	-	20	1.95 EEL HSE	-
RESIDENTIAL	-	COPPER	9.78 EEL WABASHA	-
301 EDWARD AVE E	-	20	5.59 WEL HSE	-
RESIDENTIAL	-	COPPER	11.13 EEL WABASHA	-
304 EDWARD AVE E	-	20	4.23 WEL HSE	-
RESIDENTIAL	-	COPPER	10.04 WEL ST. CLAIRE	-
305 EDWARD AVE E	-	20	1.44 WEL HSE	-
RESIDENTIAL	-	COPPER	26.34 EEL WABASHA	-
307 EDWARD AVE E	20	20	1.70 WEL HSE	1.24 E OF S/C
RESIDENTIAL	COPPER	COPPER	30.06 EEL WABASHA	-
311 EDWARD AVE E	20	20	2.41 WEL HSE	1.52 E OF S/C
RESIDENTIAL	COPPER	COPPER	53.60 EEL WABASHA	-
315 EDWARD AVE E	-	20	4.27 WEL HSE	-
RESIDENTIAL	-	COPPER	10.14 EEL ST. CLAIRE	-
317 EDWARD AVE E	-	20	7.06 WEL HSE	-
RESIDENTIAL	-	COPPER	23.05 EEL ST. CLAIRE	-
318 EDWARD AVE E	-	20	6.30 EWL HSE	-
RESIDENTIAL	-	COPPER	24.88 EEL ST. CLAIRE	-
321 EDWARD AVE E	-	20	6.52 WEL HSE	-
RESIDENTIAL	-	COPPER	38.73 EEL ST. CLAIRE	-
322 EDWARD AVE E	-	20	3.30 EWL HSE	-
RESIDENTIAL	-	COPPER	36.52 EEL ST. CLAIRE	-
323 EDWARD AVE E	20	20	1.88 EEL HSE	1.60 W OF S/C
COMMERCIAL	COPPER	COPPER	56.04 EEL ST. CLAIRE	-
324 EDWARD AVE E	-	20	5.31 WEL HSE	-
RESIDENTIAL	-	COPPER	55.96 EEL ST. CLAIRE	-
T ST. CLAIRE BV	-	20	2.95 WEL HSE	-
RESIDENTIAL	-	COPPER	8.95 EEL ST. CLAIRE	-

NOTE: CHAINAGES SHOWN ARE ALONG S E OF EDWARD AVE E

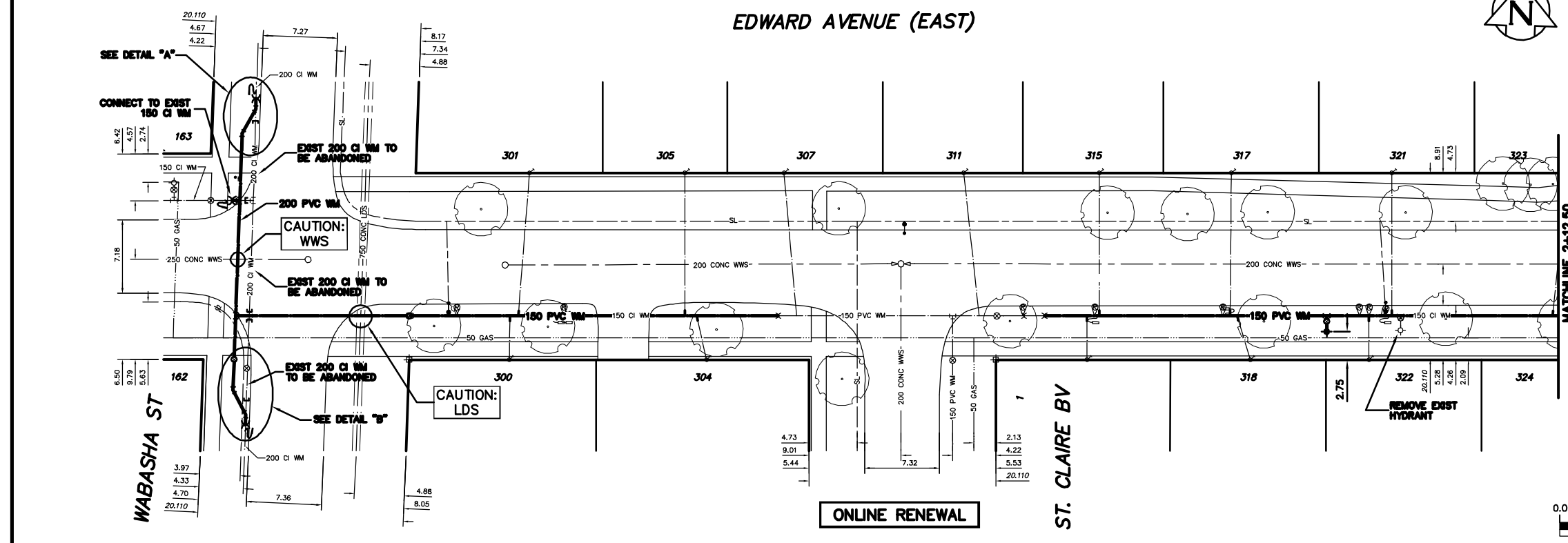

* SERVICES TO BE RENEWED TO R. ALL OTHERS TO BE RECONNECTED

- CONSTRUCTION NOTES**
1. EXPOSE EXISTING WATERMAIN & CONFIRM INVERTS PRIOR TO CONSTRUCTION.
 2. CONFIRM LOCATION OF ALL SERVICES IN THE FIELD.
 3. INSTALL WATERMAIN BY TRENCHLESS METHODS.
 4. TRENCHES AND EXCAVATIONS WITHIN 1 METRE OF A PAVED AREA INCLUDING SIDEWALKS SHALL BE CLASS 3 BACKFILL.
 5. ALL MATERIALS SHALL CONFORM TO THE CITY OF WINNIPEG STANDARD CONSTRUCTION SPECIFICATIONS.
 6. MINIMUM COVER TO TOP OF WATERMAIN SHALL BE 2.4 m.
 7. REPLACE ALL EXISTING LEAD SERVICES FROM PROPOSED WATERMAIN TO R.
 8. NOTIFY ALL AFFECTED RESIDENTS AND BUSINESSES 24 HOURS IN ADVANCE OF ANY WATER SHUTDOWNS OR DISRUPTION OF SERVICE.
 9. EXCAVATIONS TO BE LOCATED AWAY FROM EXISTING TREE'S.

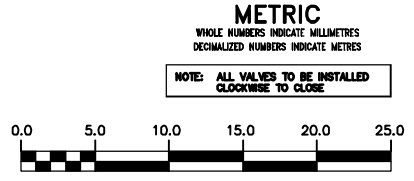

200 WM	WATERMAIN	200 WM	SL, HYDRO	150 WM	WATERMAIN	150 WM
⊕	HYDRANT	⊕	MTS	⊕	HYDRANT	⊕
⊙	VALVE	⊙	TRAFFIC SIGNALS	⊙	VALVE	⊙
525 LDS	LAND DRAINAGE SEWER	525 LDS	GAS	50 GAS	300 LDS	LAND DRAINAGE SEWER
375 WWS	WASTEWATER SEWER	375 WWS	SURVEY BAR	250 WWS	250 WWS	WASTEWATER SEWER
○	MANHOLE	○	FENCE	⊕	PROFILE	⊕
□	CATCH BASIN	□	POLE - HYDRO, MTS	⊕	GROUND ABOVE PIPE	⊕
▽	CURB INLET	▽	CURB STOP	⊕	DITCH (NORTH & WEST)	⊕
△	REDUCER	△	GUY ANCHOR	⊕	DITCH (SOUTH & EAST)	⊕
X	COUPLER	X	LIGHT STANDARD	⊕	GUTTER (NORTH & WEST)	⊕
⊕	ANODE	⊕	TREE	⊕	GUTTER (SOUTH & EAST)	⊕
EXISTING	LEGEND-PLAN	PROPOSED	EXISTING	LEGEND-PLAN	PROPOSED	EXISTING
EXISTING	LEGEND-PROFILE	PROPOSED	EXISTING	LEGEND-PROFILE	PROPOSED	EXISTING

LOCATION APPROVED UNDERGROUND STRUCTURES

NO. REVISIONS: _____ DATE: _____ BY: _____

FIELD BOOK # _____

POSTED TO LIS: _____

CITY OF WINNIPEG WATER AND WASTE ENGINEERING DIVISION

DESIGNED BY: SC CHECKED BY: TW

DRAWN BY: CJH APPROVED BY: KZ

HOR. SCALE: 1:250

VERTICAL: 1:50

RELEASED FOR CONSTRUCTION: _____

DATE: 2007 04 25

ENGINEER'S SEAL

ORIGINAL SIGNED BY S.R.J. COURNOYER 07/04/25

THE CITY OF WINNIPEG WATER AND WASTE DEPARTMENT

2007 WATERMAIN RENEWALS CONTRACT 3

EDWARD AVENUE (EAST)

WABASHA STREET TO 55 E OF EL. ST. CLAIRE BOULEVARD

SHEET 1 OF 6

CITY DRAWING NUMBER D-9156

BID OPPORTUNITY 318-2007

FILENAME: D-9156.dwg

PLOT DATE: 2007 04 25