

WATER SERVICE INFORMATION				
ADDRESS	SIZE(mm) & TYPE (STREET)	SIZE(mm) & TYPE (PROP)	SHORT & LONG MEASUREMENT	CORR. LOCATION
28 MORTIMER PL RESIDENTIAL	20 COPPER	20 COPPER	2.95 EWL HSE	0.05 E OF S/C
31 MORTIMER PL RESIDENTIAL	20 COPPER	20 COPPER	4.58 EWL HSE	0.4 E OF S/C
32 MORTIMER PL RESIDENTIAL	20 COPPER	20 COPPER	40.40 WML ST CROSS	1.2 W OF S/C
35 MORTIMER PL RESIDENTIAL	20 COPPER	20 COPPER	59.32 WML ST CROSS	OPP S/C
37 MORTIMER PL RESIDENTIAL	20 COPPER	20 COPPER	4.72 WEL HSE	OPP S/C
38 MORTIMER PL RESIDENTIAL	20 COPPER	20 COPPER	61.46 WML ST CROSS	OPP S/C
39 MORTIMER PL RESIDENTIAL	20 COPPER	20 COPPER	4.72 WEL HSE	OPP S/C
46 MORTIMER PL RESIDENTIAL	20 COPPER	20 COPPER	81.46 WML ST CROSS	OPP S/C
50 MORTIMER PL RESIDENTIAL	20 COPPER	20 COPPER	0.92 WEL HSE	0.4 W OF S/C
60 MORTIMER PL RESIDENTIAL	20 COPPER	20 COPPER	73.65 WML ST CROSS	0.6 E OF S/C
66 MORTIMER PL RESIDENTIAL	20 COPPER	20 COPPER	82.64 WML ST CROSS	0.6 E OF S/C
68 MORTIMER PL COMMERCIAL	20 COPPER	20 COPPER	1.98 EWL HSE	0.45 W OF S/C
71 ST CROSS ST RESIDENTIAL	20 COPPER	20 COPPER	105.29 WML ST CROSS	0.92 E OF S/C
74 ST CROSS ST RESIDENTIAL	20 COPPER	20 COPPER	111.05 WML ST CROSS	RENEW TO R/W/20 COPPER
75 ST CROSS ST RESIDENTIAL	20 COPPER	20 COPPER	4.35 NML HSE	1.5 N OF S/C
77 ST CROSS ST COMMERCIAL	20 COPPER	20 COPPER	61.79 SSL MACHRAY	0.95 N OF S/C
78 ST CROSS ST COMMERCIAL	20 COPPER	20 COPPER	2.43 SNL HSE	0.8 S OF S/C
79 ST CROSS ST RESIDENTIAL	20 COPPER	20 COPPER	44.45 SSL MACHRAY	OPP S/C
80 ST CROSS ST COMMERCIAL	20 COPPER	20 COPPER	0.92 WEL HSE	0.4 W OF S/C
81 ST CROSS ST COMMERCIAL	20 COPPER	20 COPPER	12.07 SSL MORTIMER	0.42 N OF S/C
82 ST CROSS ST COMMERCIAL	20 COPPER	20 COPPER	5.22 SNL HSE	0.65 E OF S/C
83 ST CROSS ST COMMERCIAL	20 COPPER	20 COPPER	4.90 NML MORTIMER	RENEW TO R/W/20 COPPER
84 ST CROSS ST COMMERCIAL	20 COPPER	20 COPPER	1.86 WEL HSE	0.42 N OF S/C
85 ST CROSS ST COMMERCIAL	20 COPPER	20 COPPER	10.12 WML ST CROSS	0.42 N OF S/C
86 ST CROSS ST COMMERCIAL	20 COPPER	20 COPPER	2.19 SNL HSE	0.42 N OF S/C
87 ST CROSS ST COMMERCIAL	20 COPPER	20 COPPER	1.80 NML MORTIMER	0.42 N OF S/C
88 ST CROSS ST COMMERCIAL	20 COPPER	20 COPPER	29.71 EEL BLDG	0.65 E OF S/C
89 ST CROSS ST COMMERCIAL	20 COPPER	20 COPPER	35.29 SSL MORTIMER (S LEG)	0.65 E OF S/C

\* SERVICES TO BE RENEWED TO R. ALL OTHERS TO BE RECONNECTED

NOTE: CHAINAGES SHOWN ARE ALONG S. R. OF MORTIMER PL (S LEG)

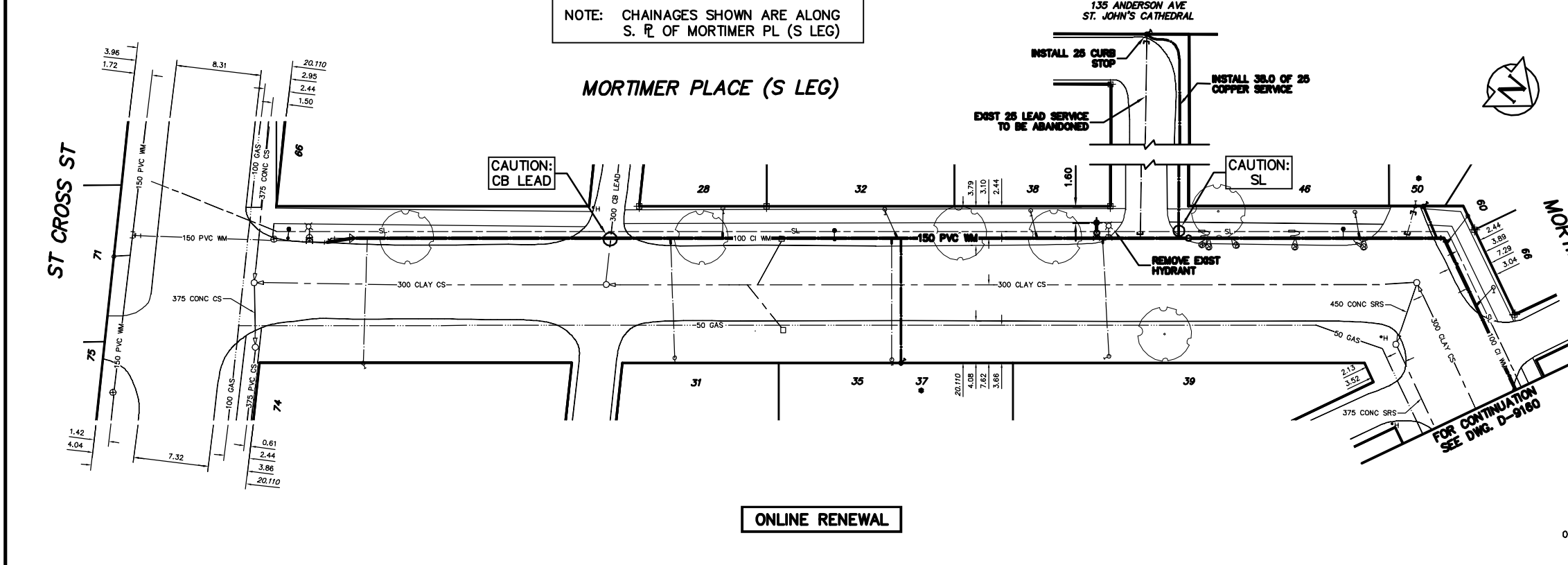

FOR CONSTRUCTION NOTES: SEE DRAWING D-9160

**METRIC**  
WHOLE NUMBERS INDICATE MILLIMETRES  
DECIMAL NUMBERS INDICATE METRES

NOTE: ALL VALUES TO BE INSTALLED COUNTERCLOCKWISE TO CLOSE

**WARNING**  
IF POWER EQUIPMENT OR EXPLOSIVES ARE TO BE USED FOR EXCAVATION ON THIS PROJECT THE CONTRACTOR MUST:  
1) NOTIFY THE GAS COMPANY OF THE PROPOSED LOCATION OF EXCAVATION.  
2) TAKE PRECAUTION TO AVOID DAMAGE TO GAS COMPANY INSTALLATIONS.  
SEE PROVINCIAL REGULATION 210/72 FOR DETAILS

200 WM	WATERMAIN	200 WM	SL, HYDRO	150 WM	WATERMAIN	150 WM
⊕	HYDRANT	⊕	MTS	⊕	HYDRANT	⊕
⊙	VALVE	⊙	TRAFFIC SIGNALS	⊙	VALVE	⊙
525 LDS	LAND DRAINAGE SEWER	525 LDS	GAS	300 LDS	LAND DRAINAGE SEWER	300 LDS
375 WWS	WASTEWATER SEWER	375 WWS	SURVEY BAR	250 WWS	WASTEWATER SEWER	250 WWS
○	MANHOLE	○	FENCE	⊕	PROFILE	⊕
□	CATCH BASIN	□	POLE - HYDRO, MTS	⊕	GROUND ABOVE PIPE	⊕
▽	CURB INLET	▽	CURB STOP	⊕	DITCH (NORTH & WEST)	⊕
△	REDUCER	△	GUY ANCHOR	⊕	DITCH (SOUTH & EAST)	⊕
X	COUPLER	X	LIGHT STANDARD	⊕	GUTTER (NORTH & WEST)	⊕
⊕	ANODE	⊕	TREE	⊕	GUTTER (SOUTH & EAST)	⊕
EXISTING	LEGEND-PLAN	PROPOSED	EXISTING	LEGEND-PLAN	PROPOSED	EXISTING

LOCATION APPROVED UNDERGROUND STRUCTURES

NOTE: LOCATION OF UNDERGROUND STRUCTURES AS SHOWN ARE BASED ON THE BEST INFORMATION AVAILABLE BUT NO GUARANTEE IS GIVEN THAT ALL EXISTING UTILITIES ARE SHOWN OR THAT THE GIVEN LOCATIONS ARE EXACT. CONFIRMATION OF EXISTENCE AND EXACT LOCATION OF ALL SERVICES MUST BE OBTAINED FROM THE INDIVIDUAL UTILITIES BEFORE PROCEEDING WITH CONSTRUCTION.

DESIGNED BY: SC  
CHECKED BY: TW  
DRAWN BY: CJH  
APPROVED BY: KZ  
HOR. SCALE: 1:250  
VERTICAL: 1:50  
RELEASED FOR CONSTRUCTION: 2007 04 24

ENGINEER'S SEAL: ORIGINAL SIGNED BY S.R.J. COURNOYER 07/04/25

BID OPPORTUNITY: 318-2007  
FILENAME: D-9159.dwg  
PLOT DATE: 2007 04 24

**THE CITY OF WINNIPEG**  
WATER AND WASTE DEPARTMENT

2007 WATERMAIN RENEWALS  
CONTRACT 3  
MORTIMER PLACE (S LEG)  
ST CROSS STREET TO  
MORTIMER PLACE (W LEG)

SHEET 4 OF 6  
CITY DRAWING NUMBER  
D-9159