

HAMILTON AVENUE NORTH-WEST MEDIAN CONTROL				
DESCRIPTION	STATION	O/S FROM ALIGNMENT	NORTHING	EASTING
POT	0+050.000	0.000	9606.748	9681.675
PC	0+204.720	0.000	9614.167	9836.217
PCC	0+344.878	0.000	9667.291	9962.851
PT	0+371.884	0.000	9686.860	9981.376
PC	0+376.795	0.000	9690.673	9984.535
PT	0+407.898	0.000	9717.303	10000.360
PC	0+411.935	0.000	9721.050	10001.860
PT	0+468.688	0.000	9776.613	10010.965
PI	0+668.942	0.000	9976.554	9999.783
PI	0+669.004	7.620L	9976.067	9992.178
PI	0+699.594	0.000	10007.127	9997.572
PI	0+699.656	7.620L	10006.639	9989.967
POT	0+750.190	0.000	10057.644	9994.747

HAMILTON AVENUE PROPOSED SIDEWALK CONTROL				
DESCRIPTION	STATION	O/S FROM ALIGNMENT	NORTHING	EASTING
POT	0+203.202	0.000	9627.299	9834.067
PI	0+213.936	0.000	9627.813	9844.788
PC	0+227.699	0.000	9630.240	9858.336
PRC	0+305.704	0.000	9659.212	9930.166
PRC	0+314.808	0.000	9662.800	9938.479
PCC	0+326.553	0.000	9667.970	9948.905
PCC	0+330.706	0.000	9670.665	9952.065
PCC	0+336.334	0.000	9674.425	9956.252
PT	0+362.012	0.000	9693.058	9973.892
PC	0+366.963	0.000	9696.871	9977.051
PCC	0+372.263	0.000	9701.050	9980.310
PCC	0+374.567	0.000	9702.925	9981.649
PRC	0+385.880	0.000	9713.337	9985.822
PRC	0+394.843	0.000	9721.758	9988.746
PT	0+437.543	0.000	9762.786	9998.301
POT	0+704.030	0.000	10028.857	9983.421

FOR CLEARANCE OF EXISTING WATER AND WASTE PLANT CONTACT THE CUSTOMER TECHNICAL SERVICES BRANCH 48 HOURS PRIOR TO CONSTRUCTION AT 986-3322

**CAUTION: FEEDERMAIN**  
DO NOT OPERATE HEAVY OR VIBRATORY EQUIPMENT OVER OR WITHIN 3.0m OF CENTRE LINE OF FEEDERMAIN.

CONTACT THE WATER AND WASTE DEPARTMENT CONSTRUCTION SERVICES COORDINATOR AT 986-3823 A MINIMUM OF SEVEN DAYS PRIOR TO CROSSING OR WORKING ADJACENT TO FEEDERMAINS TO ARRANGE FOR INSPECTION.

CIRCULAR CURVE TABLE				
CURVE	LENGTH	RADIUS	DELTA	TANGENT
C1	140.157	200.656	40°01'15"	73.074
C2	27.169	204.874	7°35'53"	13.604
C3	23.849	100.000	13°39'53"	11.982
C4	69.746	137.000	29°10'09"	35.646
C5	140.157	200.656	40°01'15"	73.074
C6	26.966	203.350	7°35'53"	13.503
C7	31.103	100.000	17°49'14"	15.678
C8	56.753	130.000	25°00'48"	28.836
C9	78.005	189.172	23°37'33"	39.565
C10	9.104	25.000	20°51'52"	4.603
C11	11.746	25.000	26°55'09"	5.983
C12	4.153	190.938	1°14'46"	2.076
C13	5.628	190.938	1°41'20"	2.814
C14	25.678	193.632	7°35'53"	12.858
C15	5.300	90.282	3°21'50"	2.651
C16	2.303	90.282	1°27'43"	1.152
C17	11.314	25.000	25°55'45"	5.755
C18	8.963	25.000	20°32'29"	4.530
C19	42.700	75.000	32°37'14"	21.946
C20	19.946	17.500	65°18'19"	11.214
C21	25.900	75.000	19°47'09"	13.080
C22	29.308	13.500	124°23'17"	25.599
C23	14.830	50.000	16°59'37"	7.470

HAMILTON AVENUE SOUTH-EAST MEDIAN CONTROL				
DESCRIPTION	STATION	O/S FROM ALIGNMENT	NORTHING	EASTING
POT	0+050.000	0.000	9603.704	9681.821
PC	0+203.460	0.000	9611.062	9835.105
PT	0+343.618	0.000	9664.186	9961.738
PC	0+346.543	0.000	9666.172	9963.886
PT	0+373.711	0.000	9685.888	9982.550
PC	0+380.833	0.000	9691.373	9987.093
PT	0+404.683	0.000	9711.372	9999.982
PC	0+405.263	0.000	9711.893	10000.236
PT	0+475.009	0.000	9779.532	10013.854
PI	0+662.715	0.000	9966.945	10003.373
PI	0+662.763	7.620R	9967.322	10010.984
PI	0+702.317	0.000	10006.510	10001.661
PI	0+702.365	7.620R	10006.887	10009.272
POT	0+753.757	0.000	10057.870	9998.788

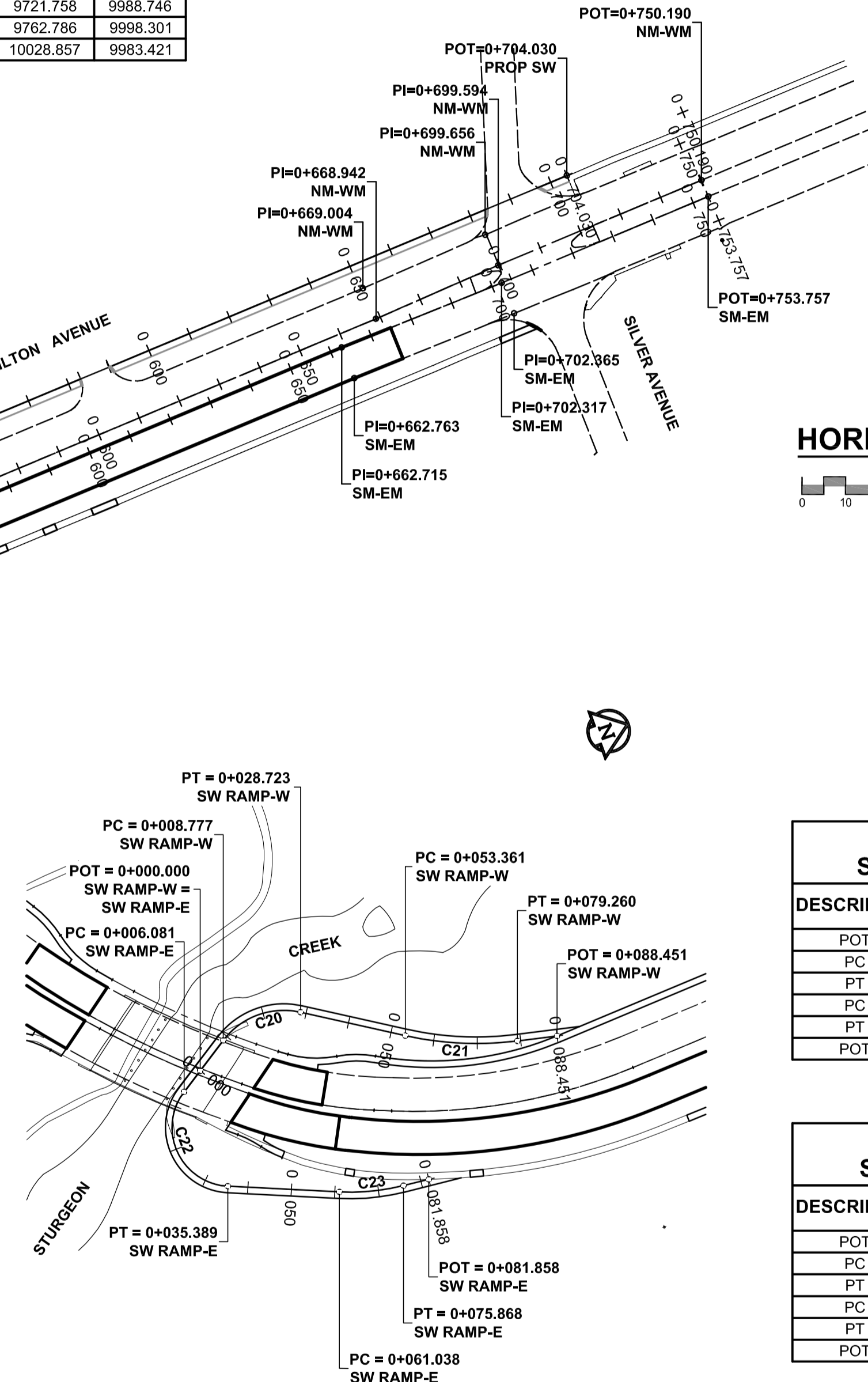

**HORIZONTAL GEOMETRY**  
SCALE 1:1000

**SIDEWALK RAMP DETAIL**  
SCALE 1:1000

HAMILTON AVENUE SIDEWALK RAMP-WEST CONTROL				
DESCRIPTION	STATION	O/S FROM ALIGNMENT	NORTHING	EASTING
POT	0+000.000	0.000	9682.668	9978.486
PC	0+006.081	0.000	9677.579	9981.815
PT	0+035.389	0.000	9679.820	10005.592
PC	0+061.038	0.000	9703.530	10015.375
PT	0+075.868	0.000	9717.872	10018.931
POT	0+081.858	0.000	9723.835	10019.497

HAMILTON AVENUE SIDEWALK RAMP-EAST CONTROL				
DESCRIPTION	STATION	O/S FROM ALIGNMENT	NORTHING	EASTING
POT	0+000.000	0.000	9682.668	9978.486
PC	0+008.777	0.000	9690.013	9973.682
PT	0+028.723	0.000	9708.896	9973.504
PC	0+053.361	0.000	9729.764	9986.602
PT	0+079.260	0.000	9753.620	9996.349
POT	0+088.451	0.000	9762.599	9998.311

**METRIC**  
WHOLE NUMBERS INDICATE MILLIMETRES  
DECIMALIZED NUMBERS INDICATE METRES

LOCATION APPROVED  
UNDERGROUND STRUCTURES  
SUPR. UG STRUCTURES COMMITTEE  
DATE: May 10/07

NOTE:  
LOCATION OF UNDERGROUND STRUCTURES AS SHOWN ARE BASED ON THE BEST INFORMATION AVAILABLE. BUT NO GUARANTEE IS GIVEN THAT ALL EXISTING UTILITIES ARE SHOWN OR THAT THE GIVEN LOCATIONS ARE EXACT. CONFIRMATION OF EXISTENCE AND EXACT LOCATION OF ALL SERVICES MUST BE OBTAINED FROM THE INDIVIDUAL UTILITIES BEFORE PROCEEDING WITH CONSTRUCTION.

BM 40-012 ELEV 238.149m	ISSUED FOR CONSTRUCTION	07/05/10	KLC
	NO. REVISIONS	YYMMDD	BY

DESIGNED BY: WRJ		CHECKED BY: JGK	
DRAWN BY: KLC		APPROVED BY: [Signature]	
HOR. SCALE: 1:1000		RELEASED FOR CONSTRUCTION: [Signature]	
VERT. SCALE: N/A		DATE: 07/05/10	

PROFESSIONAL'S SEAL  
PROVINCE OF MANITOBA  
R. P. BRUCE  
REGISTERED PROFESSIONAL ENGINEER  
CONSULTANT DRAWING NO. 0265-397-00\_01-CT1007\_RX.dwg

**THE CITY OF WINNIPEG**  
PUBLIC WORKS DEPARTMENT  
TRANSPORTATION ENGINEERING DIVISION

**HAMILTON AVENUE  
NORTHBOUND STREET  
REHABILITATION FROM  
VIMY ROAD TO SILVER AVENUE  
HORIZONTAL GEOMETRY**

CITY DRAWING NUMBER: B133-07-24  
SHEET 24 OF 30  
DRAWING No. 24  
REV 0

BID OPPORTUNITY NO. 349-2007