

**CONSTRUCTION NOTES:**

1. ALL PIPE SHALL HAVE CLASS B - TYPE 2 BEDDING
2. INSTALL SEWER BY TRENCHLESS METHODS.
3. CONFIRM THE LOCATION OF ALL SEWER SERVICES.
4. BACKFILL UNDER PAVEMENT, IN SIDEWALKS, & WITHIN 1.0 OF PAVEMENT TO BE CLASS 3.
5. BACKFILL IN BOULEVARD TO BE CLASS 5.

NOTE: CHAINAGES SHOWN ARE ALONG S. R. OF DUGALD RD.

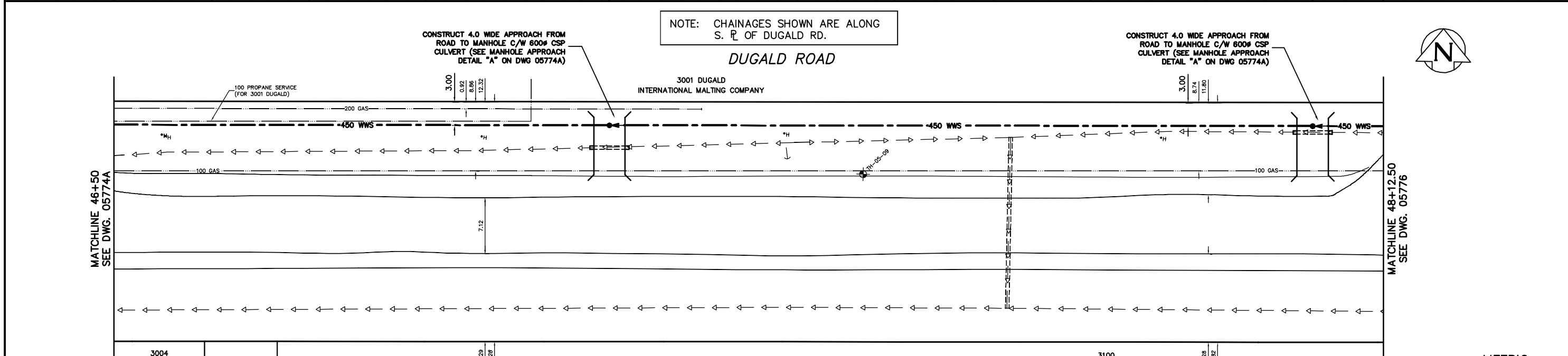

**SEWER SERVICE INFORMATION**

ADDRESS	SIZE	R. DIST	JUNCTION TIE
3100 DUGALD RD			NO SERVICE

CAUTION: OVERHEAD HYDRO, MTS

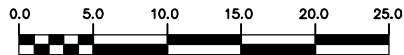

**WARNING**

IF POWER EQUIPMENT OR EXPLOSIVES ARE TO BE USED FOR EXCAVATION ON THIS PROJECT THE CONTRACTOR

- 1) NOTIFY THE GAS COMPANY OF THE PROPOSED LOCATION OF EXCAVATION.
- 2) TAKE PRECAUTION TO AVOID DAMAGE TO GAS COMPANY INSTALLATIONS.

SEE PROVINCIAL REGULATION 210/72 FOR DETAILS

200 WM	WATERMAIN	200 WM	SL, HYDRO	150 WM	WATERMAIN	150 WM
+	HYDRANT	+	MTS	+	HYDRANT	+
⊙	VALVE	⊙	TRAFFIC SIGNALS	+	VALVE	+
525 LDS	LAND DRAINAGE SEWER	525 LDS	GAS	300 LDS	LAND DRAINAGE SEWER	300 LDS
375 WWS	WASTEWATER SEWER	375 WWS	SURVEY BAR	250 WWS	WASTEWATER SEWER	250 WWS
○	MANHOLE	●	FENCE	⊕	PROFILE	
□	CATCH BASIN	■	POLE - HYDRO, MTS	⊕	GROUND ABOVE PIPE	
▽	CURB INLET	▽	CURB STOP	⊕	⊕ DITCH (NORTH & WEST)	
⊕	JUNCTIONS	⊕	GUY ANCHOR	⊕	⊕ DITCH (SOUTH & EAST)	
⊕	CULVERT	⊕	LIGHT STANDARD	⊕	TOP OF DITCH	
⊕	ANODE	⊕	TREE	⊕	GUTTER (SOUTH & EAST)	
EXISTING	LEGEND-PLAN	PROPOSED	EXISTING	LEGEND-PLAN	PROPOSED	EXISTING
				LEGEND-PROFILE	PROPOSED	

LOCATION APPROVED UNDERGROUND STRUCTURES

SUPV. U/G STRUCTURES COMMITTEE DATE

NOTE: LOCATION OF UNDERGROUND STRUCTURES AS SHOWN ARE BASED ON THE BEST INFORMATION AVAILABLE BUT NO GUARANTEE IS GIVEN THAT ALL EXISTING UTILITIES ARE SHOWN OR THAT THE GIVEN LOCATIONS ARE EXACT. CONFIRMATION OF EXISTENCE AND EXACT LOCATION OF ALL SERVICES MUST BE OBTAINED FROM THE INDIVIDUAL UTILITIES BEFORE PROCEEDING WITH CONSTRUCTION.

NO.	REVISIONS	DATE	BY

**CITY OF WINNIPEG WATER AND WASTE ENGINEERING DIVISION**

DESIGNED BY: SC  
CHECKED BY: TW/KZ

DRAWN BY: CJH  
APPROVED BY: KZ

HOR. SCALE: 1:250  
VERTICAL: 1:50

RELEASED FOR CONSTRUCTION  
K. R. ZUREK  
DATE: 2007 02 14

ENGINEER'S SEAL

ORIGINAL SIGNED BY S.R.J. COURNOYER 07/02/14

FILENAME: 05775.dwg  
PLOT DATE: 2007 02 14

**THE CITY OF WINNIPEG WATER AND WASTE DEPARTMENT**

DUGALD SECONDARY SEWER PHASE II

**DUGALD ROAD**

16 E OF E R. MCFADDEN AVENUE TO 71 W OF W R. NATIONAL AVENUE

SHEET 2 OF 9  
CITY DRAWING NUMBER 05775