

- CONSTRUCTION NOTES:**
1. ALL PVC PIPE SHALL HAVE CLASS B-TYPE 2 BEDDING AND ALL CONCRETE PIPE SHALL HAVE CLASS B-SAND BEDDING.
  2. SEWER TO BE RENEWED BY TRENCHLESS METHODS.
  3. CONFIRM THE LOCATION OF ALL SEWER SERVICES.
  4. RENEW SEWER SERVICES TO PROPERTY LINE.
  5. BACKFILL UNDER PAVEMENT, IN SIDEWALKS, & WITHIN 1.0 OF PAVEMENT TO BE CLASS 3.
  6. BACKFILL IN BOULEVARD TO BE CLASS 5.
  7. CATCHBASIN LEADS TO BE INSTALLED AT MIN. 1.0% SLOPE OR AS DIRECTED BY CONTRACT ADMINISTRATOR.
  8. EXCAVATIONS TO BE LOCATED AWAY FROM EXISTING TREES

**SEWER SERVICE INFORMATION (S-MA50017923) \***

DISTANCE FROM 1ST MH OF ST. MARY'S RD (S-MH50014445)

6.0 W	JUNCTION S
9.0 W	SERVICE CONNECTION S
12.2 W	SERVICE CONNECTION N
21.3 W	SERVICE CONNECTION S
36.6 W	JUNCTION S
46.7 W	JUNCTION S
56.0 W	JUNCTION S
71.5 W	JUNCTION S
82.6 W	SERVICE CONNECTION N
89.4 W	SERVICE CONNECTION S
101.5 W	SERVICE CONNECTION S
102.6 W	SERVICE CONNECTION N
110.0 W	SERVICE CONNECTION S
115.8 W	SERVICE CONNECTION S

\* - INFORMATION FROM SEWER VIDEO INSPECTION

NOTE: CHAINAGES SHOWN ARE ALONG NORTH PL HINDLEY ST.

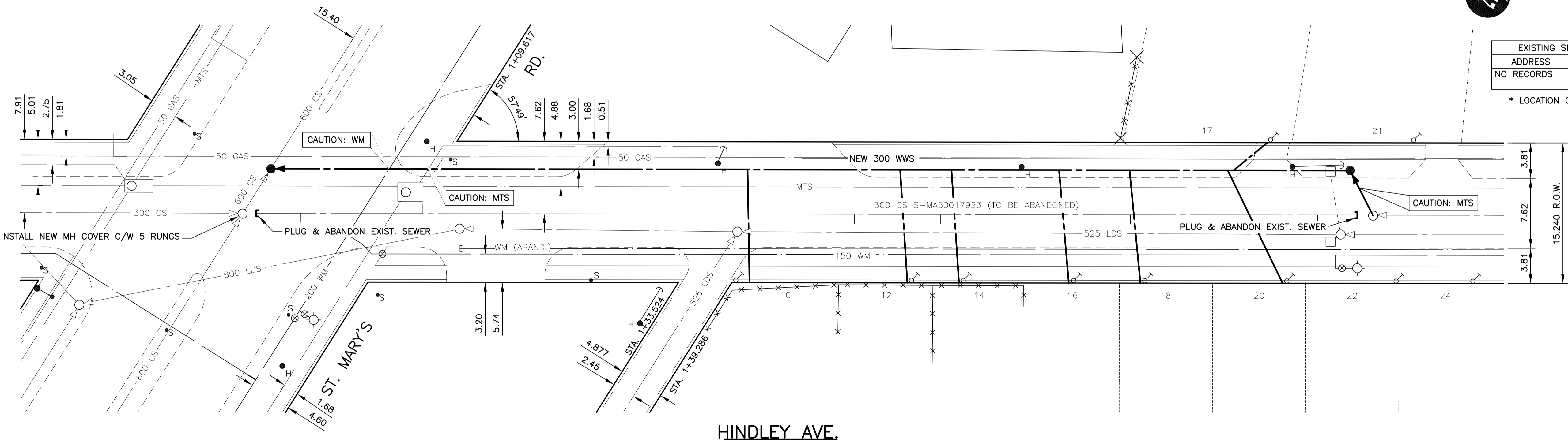

**EXISTING SEWER SERVICE LOCATION RECORDS**

ADDRESS	SIZE/TYPE	SERVICE LOCATION AT PL
NO RECORDS	INFO NOT AVAILABLE	INFO NOT AVAILABLE

\* LOCATION OF SEWER SERVICE AT ? IS ASSUMED

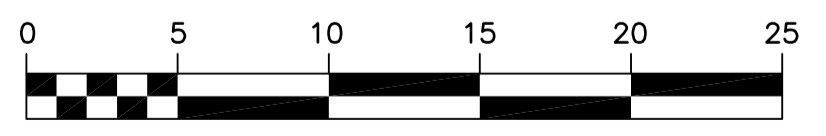

**METRIC**  
WHOLE NUMBERS INDICATE MILLIMETRES  
DECIMALIZED NUMBERS INDICATE METRES

150 mm W.M.	WATERMAIN	150 mm W.M.	HYDRO	150 mm W.M.	WATERMAIN	150 mm W.M.
Hydrant	HYDRANT	Manhole	M.T.S.	Hydrant	HYDRANT	Manhole
Valve	VALVE	Manhole	CONCRETE	Valve	VALVE	Manhole
Land Drainage Sewer	LAND DRAINAGE SEWER	Manhole	ASPHALT	Land Drainage Sewer	LAND DRAINAGE SEWER	Manhole
Waste Water Sewer	WASTE WATER SEWER	Manhole	PROPERTY LINE	Waste Water Sewer	WASTE WATER SEWER	Manhole
Manhole	MANHOLE	Manhole	SURVEY BAR	Manhole	MANHOLE	Manhole
Catch Basin	CATCH BASIN	Manhole	SERVICE VALVE	Manhole	MANHOLE	Manhole
Curb Inlet	CURB INLET	Manhole	TREE	Manhole	MANHOLE	Manhole
Junctions	JUNCTIONS	Manhole	LIGHT STANDARD	Manhole	MANHOLE	Manhole
Culvert	CULVERT	Manhole	FENCE	Manhole	MANHOLE	Manhole
Gas	GAS	Manhole	GUY ANCHOR	Manhole	MANHOLE	Manhole
Existing	LEGEND-PLAN	Proposed	LEGEND-PLAN	Proposed	LEGEND-PROFILE	Proposed

**UNDERGROUND STRUCTURES**

SUPV. U/G STRUCTURES COMMITTEE DATE

NOTE:  
LOCATION OF UNDERGROUND STRUCTURES AS SHOWN ARE BASED ON THE BEST INFORMATION AVAILABLE. BUT NO GUARANTEE IS GIVEN THAT ALL EXISTING UTILITIES ARE SHOWN OR THAT THE GIVEN LOCATIONS ARE EXACT. CONFIRMATION OF EXISTENCE AND EXACT LOCATION OF ALL SERVICES MUST BE OBTAINED FROM THE INDIVIDUAL UTILITIES BEFORE PROCEEDING WITH CONSTRUCTION.

NO.	REVISIONS	DATE	BY
1	ISSUED FOR TENDER	06/28/07	SCC

DESIGNED BY	CLP
DRAWN BY	SKB
CHECKED BY	SCC
APPROVED BY	
HOR. SCALE	1 : 250
VERTICAL	1 : 50
DATE	JUNE 27, 2007

**DILLON CONSULTING**

RELEASED FOR CONSTRUCTION ORIGINAL SIGNED BY KAS ZUREK, P. Eng.

**THE CITY OF WINNIPEG WATER AND WASTE DEPARTMENT**

2007 SEWER RENEWALS  
**HINDLEY AVENUE**  
1ST MH E OF ST. MARY'S RD. TO MH AT ST. MARY'S RD.

CITY DRAWING NUMBER  
**06069**  
SHEET 1 OF 13

BID OPPORTUNITY  
**422-2007**

CONSULTANT PROJECT NO.  
**07-7471-1000**