

- CONSTRUCTION NOTES:**
1. ALL PVC PIPE SHALL HAVE CLASS B-TYPE 2 BEDDING AND ALL CONCRETE PIPE SHALL HAVE CLASS B-SAND BEDDING.
 2. SEWER TO BE RENEWED BY TRENCHLESS METHODS.
 3. CONFIRM THE LOCATION OF ALL SEWER SERVICES.
 4. RENEW SEWER SERVICES TO PROPERTY LINE.
 5. BACKFILL UNDER PAVEMENT, IN SIDEWALKS, & WITHIN 1.0 OF PAVEMENT TO BE CLASS 3.
 6. BACKFILL IN BOULEVARD TO BE CLASS 5.
 7. CATCHBASIN LEADS TO BE INSTALLED AT MIN. 1.0% SLOPE OR AS DIRECTED BY CONTRACT ADMINISTRATOR.
 8. EXCAVATIONS TO BE LOCATED AWAY FROM EXISTING TREES

NOTE: CHAINAGES SHOWN ARE ALONG NORTH PL KENWOOD PL.

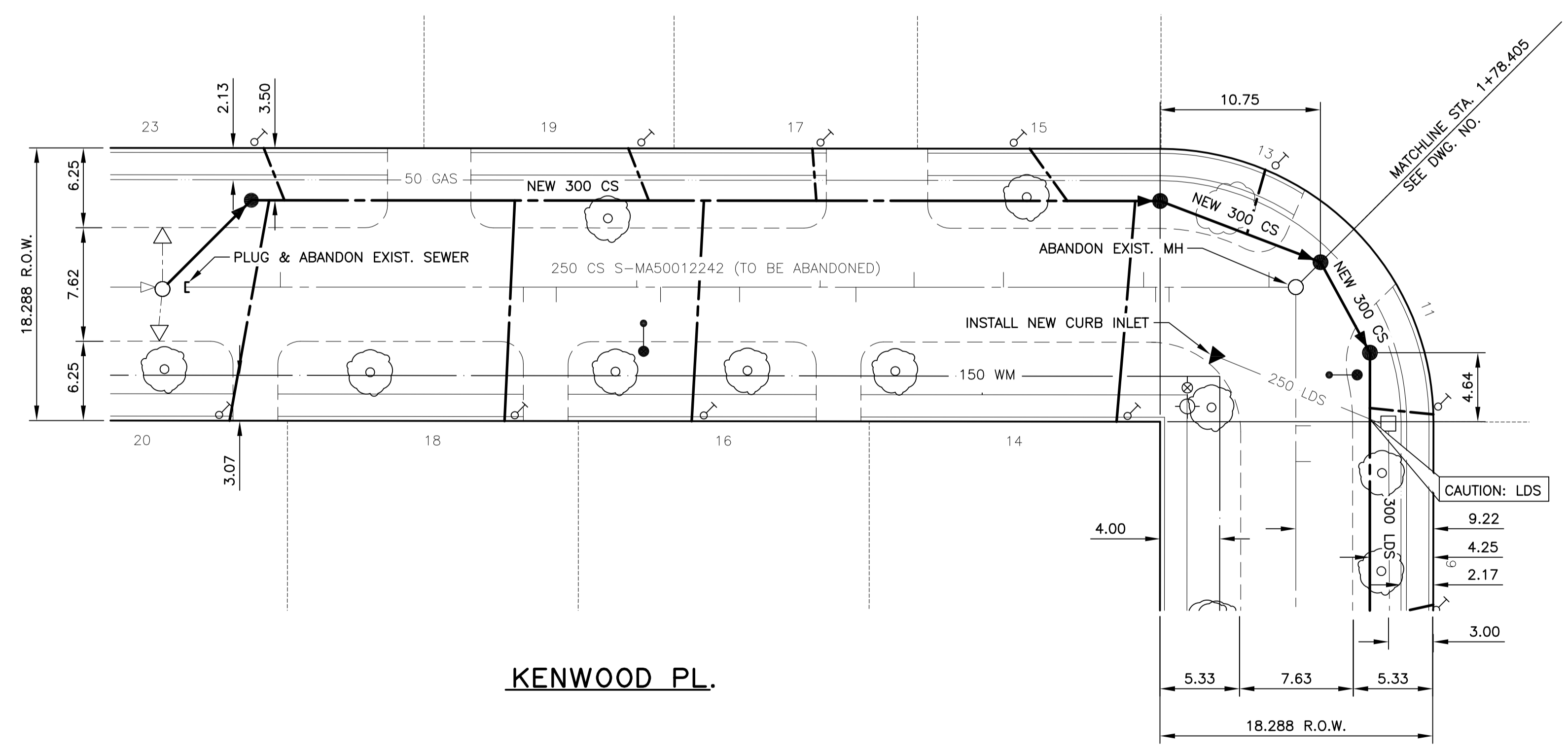

SEWER SERVICE INFORMATION (S-MA50012242) *	
DISTANCE FROM 1ST MH W OF EGERTON RD (S-MH50009838)	
5.6 E	SERVICE CONNECTION S
7.9 E	SERVICE CONNECTION N
24.2 E	SERVICE CONNECTION S
31.8 E	SERVICE CONNECTION N
38.7 E	SERVICE CONNECTION S
44.1 E	SERVICE CONNECTION N
56.4 E	SERVICE CONNECTION S
67.5 E	SERVICE CONNECTION S
74.2 E	SERVICE CONNECTION N

* - INFORMATION FROM SEWER VIDEO INSPECTION

EXISTING SEWER SERVICE LOCATION RECORDS		
ADDRESS NO RECORDS	SIZE/TYPE INFO NOT AVAILABLE	SERVICE LOCATION AT PL INFO NOT AVAILABLE

* LOCATION OF SEWER SERVICE AT ? IS ASSUMED

WARNING

- IF POWER EQUIPMENT OR EXPLOSIVES ARE TO BE USED FOR EXCAVATION ON THIS PROJECT THE CONTRACTOR MUST:
1. NOTIFY THE GAS COMPANY OF THE PROPOSED LOCATION OF EXCAVATION.
 2. TAKE PRECAUTION TO AVOID DAMAGE TO GAS COMPANY INSTALLATIONS SEE PROVINCIAL REGULATION 210/72 FOR DETAILS

METRIC

WHOLE NUMBERS INDICATE MILLIMETRES
DECIMALIZED NUMBERS INDICATE METRES

150 mm W.M.	WATERMAIN	150 mm W.M.	HYDRO	150 mm W.M.	WATERMAIN	150 mm W.M.
Hydrant	HYDRANT	Concrete	M.T.S.	Hydrant	HYDRANT	Hydrant
Valve	VALVE	Concrete	CONCRETE	Valve	VALVE	Valve
Land Drainage Sewer	LAND DRAINAGE SEWER	Asphalt	ASPHALT	Land Drainage Sewer	LAND DRAINAGE SEWER	Land Drainage Sewer
Waste Water Sewer	WASTE WATER SEWER	Property Line	PROPERTY LINE	Waste Water Sewer	WASTE WATER SEWER	Waste Water Sewer
Manhole	MANHOLE	Survey Bar	SURVEY BAR	Manhole	MANHOLE	Manhole
Catch Basin	CATCH BASIN	Service Valve	SERVICE VALVE	Catch Basin	CATCH BASIN	Catch Basin
Curb Inlet	CURB INLET	Tree	TREE	Curb Inlet	CURB INLET	Curb Inlet
Junctions	JUNCTIONS	Light Standard	LIGHT STANDARD	Junctions	JUNCTIONS	Junctions
Culvert	CULVERT	Fence	FENCE	Culvert	CULVERT	Culvert
Gas	GAS	Guy Anchor	GUY ANCHOR	Gas	GAS	Gas
Existing	LEGEND-PLAN	Proposed	LEGEND-PLAN	Existing	LEGEND-PROFILE	Proposed

UNDERGROUND STRUCTURES	B.M. ELEV.	DESIGNED BY	CLP
SUPPLY U/G STRUCTURES COMMITTEE		DRAWN BY	SKB
DATE		CHECKED BY	SCC
NOTE:		APPROVED BY	
LOCATION OF UNDERGROUND STRUCTURES AS SHOWN ARE BASED ON THE BEST INFORMATION AVAILABLE, BUT NO GUARANTEE IS GIVEN THAT ALL EXISTING UTILITIES ARE SHOWN OR THAT THE GIVEN LOCATIONS ARE EXACT. CONFIRMATION OF EXISTENCE AND EXACT LOCATION OF ALL SERVICES MUST BE OBTAINED FROM THE INDIVIDUAL UTILITIES BEFORE PROCEEDING WITH CONSTRUCTION.		HOR. SCALE	1 : 250
		VERTICAL	1 : 50
		RELEASSED FOR CONSTRUCTION ORIGINAL SIGNED BY	KAS ZUREK, P. Eng.
		CONSULTANT PROJECT NO.	07-7471-1000
		DATE	JUNE 27, 2007

DILLON CONSULTING

ENGINEER'S SEAL

PROVINCE OF MANITOBA

D.P. KRAHN

Member 4226

REGISTERED PROFESSIONAL ENGINEER

THE CITY OF WINNIPEG
WATER AND WASTE DEPARTMENT

2007 SEWER RENEWALS
KENWOOD PLACE
1ST MH W OF KENWOOD PL. (E LEG) TO
MH AT KENWOOD PL. (E LEG)

CITY DRAWING NUMBER
06072
SHEET 4 OF 13

BID OPPORTUNITY
422-2007