

1+00 1+25 1+50 1+75

ST. ANDREW ROAD

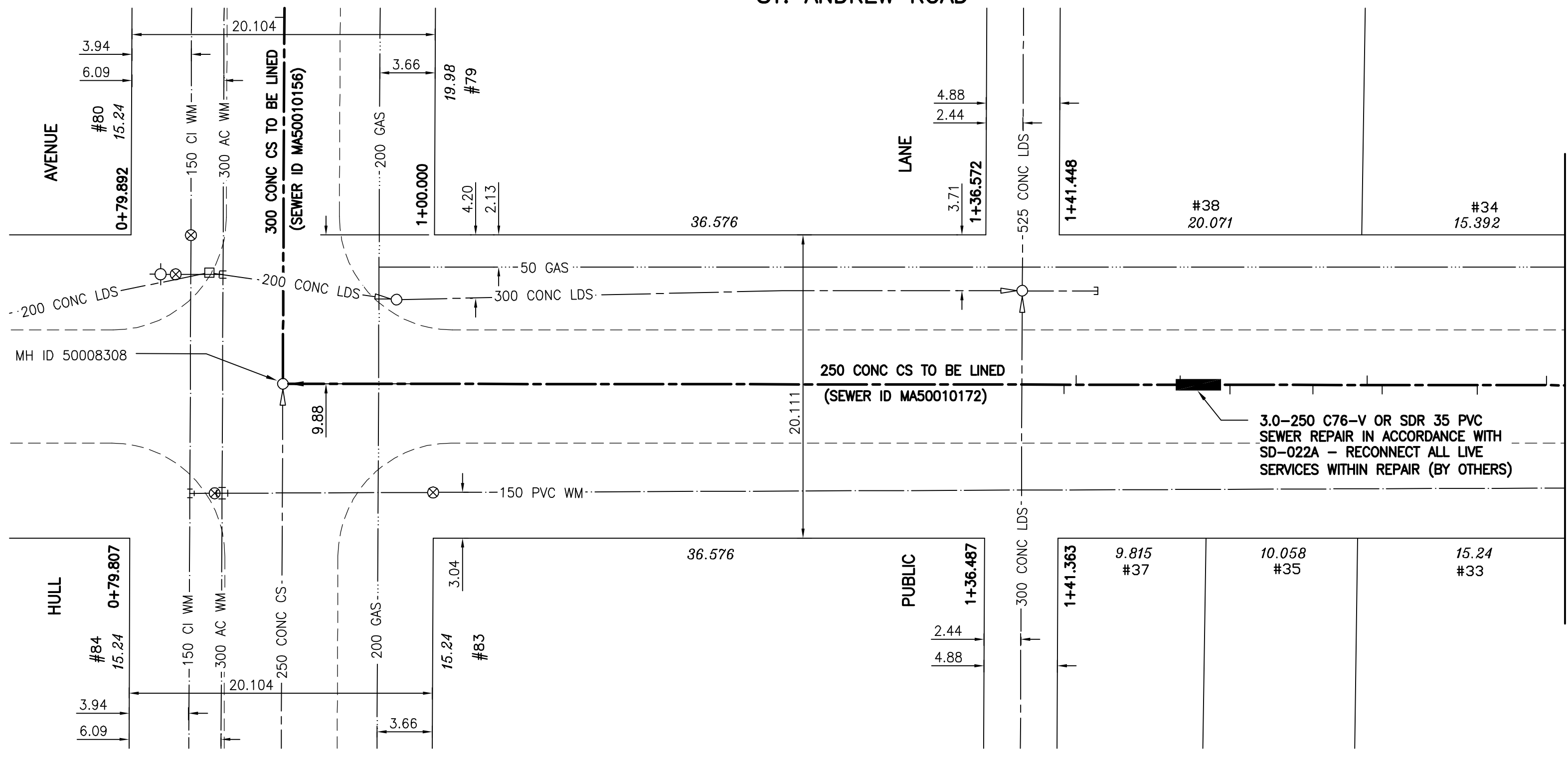

**SEWER JUNCTION INFORMATION (MA50010172)**  
 1ST MH NORTH OF HULL AVE (MHID 70009000) TO  
 MH AT HULL AVENUE (MHID 50008308)  
 DISTANCE FROM 1ST MH NORTH OF HULL AVENUE (MH 70009000) \*

53.4	SOUTH	150 MM DIA.	WEST	JN	LIVE
58.0	SOUTH	150 MM DIA.	EAST	CNI	LIVE
64.3	SOUTH	150 MM DIA.	EAST	JN	CAPPED
65.3	SOUTH	150 MM DIA.	WEST	CNI	CAPPED
68.9	SOUTH	150 MM DIA.	EAST	JN	LIVE
74.4	SOUTH	150 MM DIA.	EAST	CNI	CAPPED
77.7	SOUTH	150 MM DIA.	WEST	CX	LIVE, CRACKED
84.6	SOUTH	150 MM DIA.	WEST	JN	CAPPED
85.4	SOUTH	150 MM DIA.	EAST	JN	

\* Information from Sewer Video Inspection

**WARNING**

IF POWER EQUIPMENT OR EXPLOSIVES ARE TO BE USED FOR EXCAVATION ON THIS PROJECT THE CONTRACTOR MUST:  
 1) NOTIFY THE GAS COMPANY OF THE PROPOSED LOCATION OF EXCAVATION.  
 2) TAKE PRECAUTION TO AVOID DAMAGE TO GAS COMPANY INSTALLATIONS.  
 SEE PROVINCIAL REGULATION 140/92 FOR DETAILS

**METRIC**

WHOLE NUMBERS INDICATE MILLIMETRES  
 DECIMALIZED NUMBERS INDICATE METRES

**NOTE:**  
 STATIONS ALONG W P OF ST. ANDREW RD.

BENCH MARK: 84R735 - N.E. Cor. of Hull Ave. & St. George Rd., Tblt. on top of 0.05 m dia. x 2.4 m iron pipe, 4.3 m S. of N.L. of Hull Ave. & 0.3 m W. of E.L. of St. George Rd.

MATCH LINE 1+75 FOR CONTINUATION SEE DRAWING 06039

**SEWER SERVICE INFORMATION**

ADDRESS	SIZE	PROPERTY LINE LOCATION
79 HULL AVE RESIDENTIAL	150 mm	NO INFO AVAILABLE
80 HULL AVE RESIDENTIAL	150 mm	NO INFO AVAILABLE
83 HULL AVE RESIDENTIAL	150 mm	NO INFO AVAILABLE
84 HULL AVE RESIDENTIAL	150 mm	NO INFO AVAILABLE
33 ST. ANDREW RD RESIDENTIAL	150 mm	1.5 m N of S HL
34 ST. ANDREW RD RESIDENTIAL	150 mm	NO INFO AVAILABLE
35 ST. ANDREW RD RESIDENTIAL	150 mm	NO INFO AVAILABLE
37 ST. ANDREW RD RESIDENTIAL	150 mm	0.5 m N of S HL
38 ST. ANDREW RD RESIDENTIAL	150 mm	NO INFO AVAILABLE

**APEGM**  
 Certificate of Authorization  
 Stantec Consulting Ltd.  
 No. 1301 Expiry: April 30, 2008

BID OPPORTUNITY 449-2007

150 WM	WATERMAIN	150 WM	HYDRO	150 WM	WATERMAIN	150 WM	UNDERGROUND STRUCTURES
+	HYDRANT	+	M.T.S.	+	HYDRANT, VALVE	+	LOCATION APPROVED
o	VALVE	o	CONCRETE	o	LAND DRAINAGE SEWER	o	UNDERGROUND STRUCTURES
- - -	LAND DRAINAGE SEWER	- - -	ASPHALT	- - -	WASTE WATER SEWER	- - -	
- - -	WASTE WATER SEWER	- - -	SIDEWALK	- - -	WASTE WATER SEWER	- - -	
o	MANHOLE	o	PROPERTY LINE	o	NORTH OR WEST GUTTER	o	
o	CATCH BASIN	o	SURVEY BAR	o	SOUTH OR EAST GUTTER	o	
o	CURB INLET	o	DITCH	o	NORTH OR WEST P	o	
o	JUNCTIONS	o	ELEVATION	o	SOUTH OR EAST P	o	
o	CULVERT	o	SIDEWALK RAMP	o	NORTH OR WEST DITCH	o	
o	GAS	o		o	SOUTH OR EAST DITCH	o	
---	EXISTING	---	LEGEND-PLAN	---	LEGEND-PROFILE	---	PROPOSED

**LOCATION APPROVED UNDERGROUND STRUCTURES**

NO.	REVISIONS	DATE	BY

NOTE:  
 LOCATION OF UNDERGROUND STRUCTURES AS SHOWN ARE BASED ON THE BEST INFORMATION AVAILABLE BUT NO GUARANTEE IS GIVEN THAT ALL EXISTING UTILITIES ARE SHOWN OR THAT THE GIVEN LOCATIONS ARE EXACT. CONFIRMATION OF EXISTENCE AND EXACT LOCATION OF ALL SERVICES MUST BE OBTAINED FROM THE INDIVIDUAL UTILITIES BEFORE PROCEEDING WITH CONSTRUCTION.

**Stantec Consulting Ltd.**  
 905 Waverley Street, Winnipeg, Manitoba  
 Tel 204-489-5900 Fax 204-453-9012

DESIGNED BY: J.K.H. CHECKED BY: W.B.  
 DRAWN BY: J.K.H. APPROVED BY: H.A.K.  
 HOR. SCALE: 1:250  
 VERTICAL: 1:50  
 RELEASED FOR CONSTRUCTION: \_\_\_\_\_  
 DATE: 07.05.09

ENGINEER'S SEAL  
 ORIGINAL SEALED BY H.A. KATZ P. ENG. 07.07.17  
 CONSULTANT DRAWING NO. C-214

**THE CITY OF WINNIPEG**  
 WATER AND WASTE DEPARTMENT  
 ENGINEERING DIVISION

**ST. ANDREW ROAD**  
 MH AT HULL AVE TO  
 1ST MH N OF HULL AVE  
 STA 0+90 TO STA. 1+75  
 2007 SEWER RENEWALS BY CIPP LINING

SHEET 14 OF 19  
 CAD FILE DRAWING NUMBER 09720C-214685.dwg  
 CITY DRAWING NUMBER 06038