

TYPICAL 3 ROW PAVING BAND
Paving band at building edge and
back of roadway curb typical for
Portage Ave. at Hargrave St.

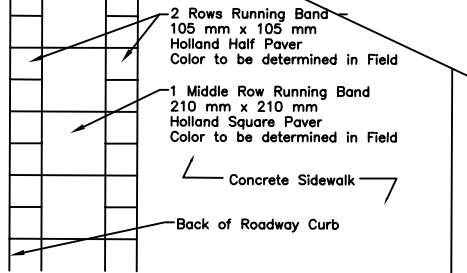

TYPICAL PAVING BAND PATTERN
SCALE: NTS

NOTE:
1. Concrete sidewalk to be 100mm depth as per
CW-SD228A.
2. Reveal to accommodate full pavers. Contractor to
determine reveal widths for 3 row paving bands.
3. Maintain paving bands through pararamps in all
locations.

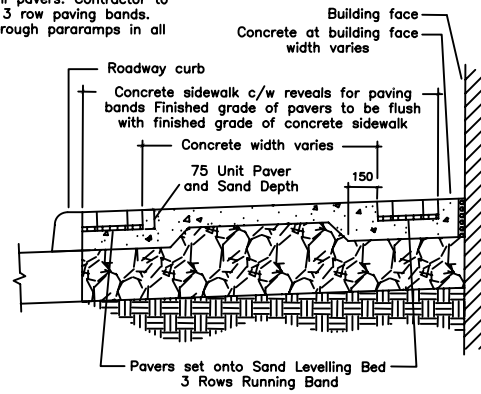

PORTAGE AVE SIDEWALK SECTION
SCALE: NTS

PORTAGE AVE

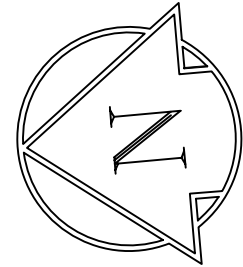

Install Concrete Sidewalk with
Reveals for Paving Bands

Construct New 100 mm Concrete Sidewalk
Renew Existing Concrete Sidewalk

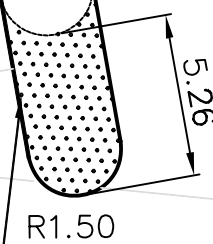

Construct Monolithic Concrete
Median Slab as per SD-226A

14.00
3.50
3.50
3.50
3.50
3.50

R3.00

R392.31

R7.50

ONE WAY

R4.50

R426.70

27.20

Construct New Interlocking
Paving Stone Sidewalk

Renew Existing Interlocking
Paving Stone Sidewalk

HARGRAVE ST

CONSTRUCTION NOTES

- 1) CURB REPLACEMENT AS DIRECTED BY THE CONTRACT ADMINISTRATOR
- 2) ALL STREET RADIUS CURBS UNDER 15M RADIUS SHALL BE REPLACED AS MODIFIED OR AS DIRECTED BY THE CONTRACT ADMINISTRATOR
- 3) PAVEMENT REPAIRS SHOWN ARE ONLY A REPRESENTATIVE SAMPLE OF THE TENDERED QUANTITIES
- 4) ASPHALT TIE-INS TO BE DETERMINED IN THE FIELD BY THE CONTRACT ADMINISTRATOR.
- 5) SIDEWALK REPLACEMENT AS DIRECTED BY THE CONTRACT ADMINISTRATOR.
- 6) BOULEVARD REPLACEMENT AS DIRECTED BY THE CONTRACT ADMINISTRATOR.

WARNING

IF POWER EQUIPMENT OR EXPLOSIVES ARE TO BE USED FOR EXCAVATION ON THIS PROJECT THE CONTRACTOR MUST:
1) OBTAIN CLEARANCE FROM THE GAS UTILITY PRIOR TO EXCAVATION.
2) TAKE PRECAUTION TO AVOID DAMAGE TO GAS UTILITY INSTALLATIONS.

SEE PROVINCIAL REGULATION 210/72 FOR DETAILS

METRIC
WHOLE NUMBERS INDICATE MILLIMETRES
DECIMALIZED NUMBERS INDICATE METRES

BID OPPORTUNITY NO. 491-2007

150 WM	WATERMAIN	150 WM	HYDRO	150 WM	WATERMAIN	150 WM	WATERMAIN	150 WM	WATERMAIN
300 LDS	LAND DRAINAGE SEWER	300 LDS	CONCRETE	300 LDS	SEWER	300 LDS	SEWER	300 LDS	SEWER
250 CS	COMBINED SEWER	250 CS	LIMIT OF ASPHALT	250 CS	SEWER	250 CS	SEWER	250 CS	SEWER
MANHOLE	MANHOLE	MANHOLE	CURB RENEWAL	MANHOLE	SEWER	MANHOLE	SEWER	MANHOLE	SEWER
CATCH BASIN	CATCH BASIN	CATCH BASIN	ASPHALT	CATCH BASIN	SEWER	CATCH BASIN	SEWER	CATCH BASIN	SEWER
CURB INLET	CURB INLET	CURB INLET	ELEVATIONS	CURB INLET	SEWER	CURB INLET	SEWER	CURB INLET	SEWER
WOOD POLES	WOOD POLES	WOOD POLES	PROPERTY LINE	WOOD POLES	SEWER	WOOD POLES	SEWER	WOOD POLES	SEWER
LAMP STANDARD	LAMP STANDARD	LAMP STANDARD	SURVEY BAR	LAMP STANDARD	SEWER	LAMP STANDARD	SEWER	LAMP STANDARD	SEWER
GAS	GAS	GAS	CURB STOP	GAS	SEWER	GAS	SEWER	GAS	SEWER
			RAMP CURB		SEWER		SEWER		SEWER
EXISTING	LEGEND - PLAN	PROPOSED	EXISTING	LEGEND - PLAN	PROPOSED	EXISTING	LEGEND - PROFILE	PROPOSED	EXISTING

LOCATION APPROVED
UNDERGROUND STRUCTURES

SUPR. U/G STRUCTURES	DATE
COMMITTEE	

NOTE:
LOCATION OF UNDERGROUND STRUCTURES AS SHOWN ARE BASED ON THE BEST INFORMATION AVAILABLE. BUT NO GUARANTEE IS GIVEN THAT ALL EXISTING UTILITIES ARE SHOWN OR THAT THE GIVEN LOCATIONS ARE EXACT. CONFIRMATION OF EXISTENCE AND EXACT LOCATION OF ALL SERVICES MUST BE OBTAINED FROM THE INDIVIDUAL UTILITIES BEFORE PROCEEDING WITH CONSTRUCTION.

NO.	REVISIONS	DATE	BY

TRANSPORTATION ENGINEERING DIVISION
TECHNOLOGY SERVICES BRANCH
106 - 1155 PACIFIC AVE

DESIGNED BY	D.B.T. / G.C.	CHECKED BY	D.K.
DRAWN BY	D.B.T. / G.C.	APPROVED BY	K.T.
SCALE:	1 : 250		
DATE	2007/05/11		

ENGINEER'S SEAL
PROVINCE OF MANITOBA
REGISTERED ENGINEER
ORIGINAL SIGNED BY
L.P. DEANE JULY 5, 2007

THE CITY OF WINNIPEG
PUBLIC WORKS DEPARTMENT

HARGRAVE STREET
FROM PORTAGE AVE TO 1ST PUBLIC LANE NORTH
ROADWAY IMPROVEMENTS

CITY DRAWING NUMBER	SE-07-39
SHEET 1 OF 1	
1	